

Orrick

CLIENT STORY

Law Firm
Washington D.C.



Located in Washington D.C.'s bustling Foggy Bottom neighborhood, Orrick, a global law firm specializing in the technology, energy, and finance sectors, has redefined the workplace experience for what has historically been perceived as a traditional field of work. With a keen focus on rebuilding the community of work post-pandemic, Orrick sought to create an inviting destination space designed to entice employees back to the office. By prioritizing connectivity, comfort, and well-being, Orrick has successfully created a highly desirable and functional office environment that embodies their renowned commitment to innovation.

"Orrick's vision was truly progressive," reflects Holly Martin, Senior Principal and Senior Director for OTJ Architects. "Our collaboration was driven by their environmental, social, and governance (ESG) goals and their desire to better connect their work community. Together, we were able to design a space that not only meets rigorous WELL and LEED standards but also cultivates a culture of collaboration and creativity."

Engaging in an extensive workplace strategy exercise with the firm, OTJ met with employees across all levels, gathering invaluable insights that directly shaped the design direction. Understanding that Orrick's overarching aim was to restore the community of work, OTJ established the design themes of centered connectivity, leading with intention, flexible space utilization, and to impress, entice, and inspire occupants. With these guiding principles in hand, the design team seamlessly infused Orrick's brand, culture, and vision into the space, creating a welcoming environment that fosters productivity, enhances team engagement, and celebrates the firm's identity.

Central to the design is the inviting reception area, where a stunning hand-carved Indiana limestone reception desk anchors the space. Surrounding this focal point are carefully curated soft seating areas fostering a warm, energetic atmosphere that promotes interaction and engagement. Here, and in the adjacent café area, individuals have the freedom to work independently or collaborate with colleagues. With views overlooking James Monroe Park, ample daylight floods the space, enhancing mood and productivity while expansive sightlines amplify connectivity.

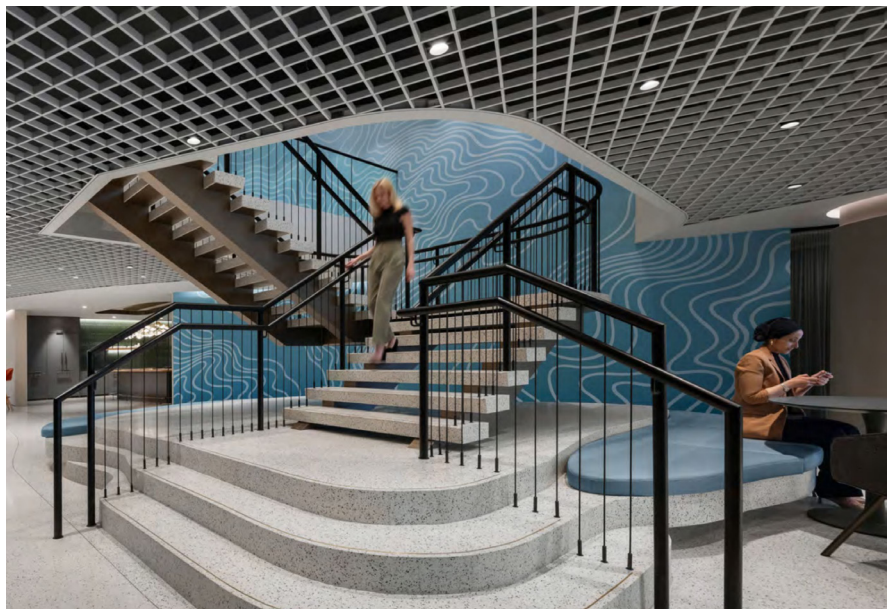



"From the thoughtful furnishings selected to the use of biophilic elements, every design detail was aimed at creating a hospitality-inspired environment that transcends the traditional legal setting. It's this fusion of warmth and functionality that continues to draw Orrick's team back to the office, day after day."

HOLLY MARTIN

— SENIOR PRINCIPAL AND
SENIOR DIRECTOR,
OTJ ARCHITECTS

Biophilic elements, such as abundant greenery and natural materials, further enrich the space, fostering a connection to nature and promoting well-being. This hospitality-inspired design approach extends throughout the office corridors, where soft seating arrangements and engaging artwork create a relaxed yet professional atmosphere for interaction.

The firm's work activities are further supported by assigned and shared private offices equipped with glass walls that allow natural light to filter through while ensuring a secluded environment conducive to focused work. Ergonomic, height-adjustable L-shaped desks with curved corners facilitate seamless movement and postural change and enable partners and associates to comfortably collaborate both in-person and virtually. Here, the use of color on the walls, specifically a dark cobalt blue, creates a warm ambiance and flattering backdrop for virtual meetings, echoing the comforts of home.



PROJECT DETAILS

Allsteel Further™ Workstations
with Corral PET screens and
Radii undermount storage

Gunlocke Silea Veneer
featuring L-shape height
adjustable cantilever
worksurface, Workwall
storage, open metal shelving

Silea Laminate featuring
integrated height adjustable
worksurface and 7 1/2" storage

In crafting Orrick's new workspace, OTJ prioritized not only spaces that fostered connection and well-being but also those showcasing versatility. Designed with adaptability in mind, the multi-purpose room primarily serves as a mock trial space, complete with a stage, appropriate sight lines, and technology to simulate the courtroom experience. However, the furniture within the space can also be easily moved and reconfigured to create a traditional conference room arrangement, a classroom-style training room, or to support theater-style presentations. This flexibility ensures the space can seamlessly accommodate Orrick's diverse functional needs and reinforces the value of in-person collaboration.

Despite compressed schedules and logistical challenges, the new space was completed on time, with occupancy occurring in February 2024. From partners to associates, the response has been unanimously enthusiastic, with attendance exceeding expectations following the move. The notable increase in anticipated occupancy has resulted in more offices being assigned than initially planned, reflecting the overwhelmingly positive reception of the new space.

Says Martin, "The feedback has been incredible. Orrick's team isn't just happy—they're absolutely blown away. From the Impromptu connections and meetings occurring in the reception area and café to the moments of camaraderie happening in the corridors, every interaction brought about by the design of the space perfectly aligns with the organization's vision for a more connected work community."

PROJECT DETAILS

Headquarters

Washington, DC

Partnerships

OTJ Architects



©2024 Allsteel LLC
All registered trademarks and trademarks are the property of Allsteel LLC