

# HON<sup>®</sup>

**Make your space work<sup>®</sup>**

---



## Verse<sup>®</sup>

Panels

# Verse

## The Great Divide

Create more personal space in open areas with the Verse Panel System. Easily connected and endlessly reconfigurable, Verse panels can maintain sightlines or maximize privacy, and keep frequently used items conveniently within reach. It's the smart long-term investment to support short-term work environments that are constantly changing.

### Features



#### PANELS

A variety of Verse panel widths and heights easily connect to one another to form workstations or offer privacy as space dividers. Available in sizes ranging from 24"-72" W and 42"-72" H.

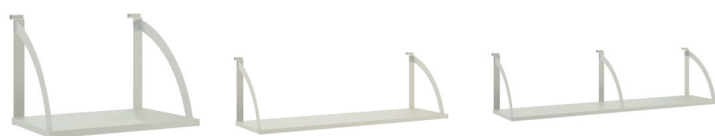

#### SHELVING

Steel hanging shelf hangs off the top of a Verse panel.

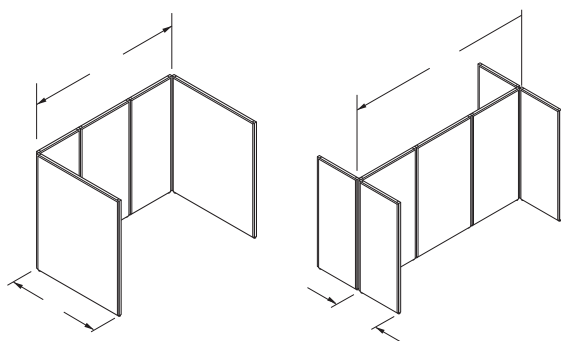

#### CONFIGURATIONS

When using the 'L' configuration the return panel must measure at least 60% of the unsupported run.

When using the 'T' configuration, the return panel must measure at least 20% of the unsupported run.

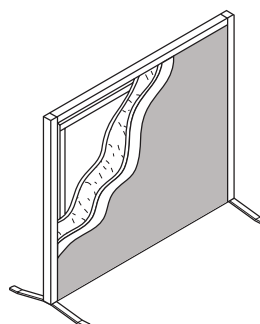

#### INTERNAL STRUCTURE

Consisting of two sheets of  $\frac{1}{8}$ " thick fiberboard mechanically fastened to an internal particleboard frame, Verse provides visible barrier, structural strength, and noise reduction qualities.

# Verse

## Paint

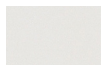

Light Grey

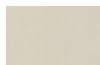

Putty

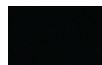

Black

## Panel Fabric

### CONTOURETT



Beach



Buff

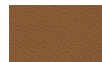

Luggage



Pumpkin



Flame



Safari



Crater



Trunk



Quarry



Taupe



Storm



Red



Bordeaux



Nimbus



Marine



Navy



Ocean



Sage



Steel



Cloud

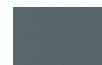

Baltic



Graphite



Iron



Coffee  
Bean

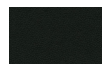

Black

### CENTURION



Ruby



Marsala



Apricot



Goldenrod



Pear



Jade



Peacock



Sapphire



Indigo



Navy



Iris

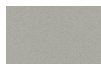

Fog

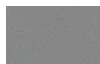

Frost

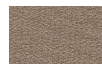

Morel



Bark

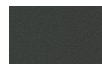

Iron Ore

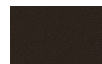

Espresso



Black

### SEAWAY

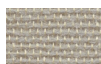

Grey

# HON.

**Make your space work®**

The HON Company  
Muscatine, IA 52761  
800.833.3964 | Check out hon.com

©2025 The HON Company. Form No. H5140 (5/25)  
To view the registered and unregistered trademarks  
owned and used by The HON Company, visit  
[hon.com/protected-marks](https://hon.com/protected-marks). Models, upholstery  
and finishes are subject to change without notice.

For more information, visit [hon.com/cubicles/verse](https://hon.com/cubicles/verse)



SCAN TO  
CHECK OUT  
VERSE ON  
[HON.COM](https://hon.com)

See HON Pricer for complete product information.