

TROUGHS

Trough - Drop In

Model: SPPL.WT.DI.xxxx

SPPL = Stoddart Plumbing Product
 WT = Wash Trough
 DI = Drop In
 xxxx = Nominated length
 eg.: for specification and ordering quote
 Code: SPPL.WT.DI.1800

Features and Benefits:

- Robust, hygienic & safe solution for educational applications
- Multipurpose, versatile trough with left or right hand waste position available
- Radius internal corners for easy cleaning
- 316 grade stainless steel option available
- Customised sizing available

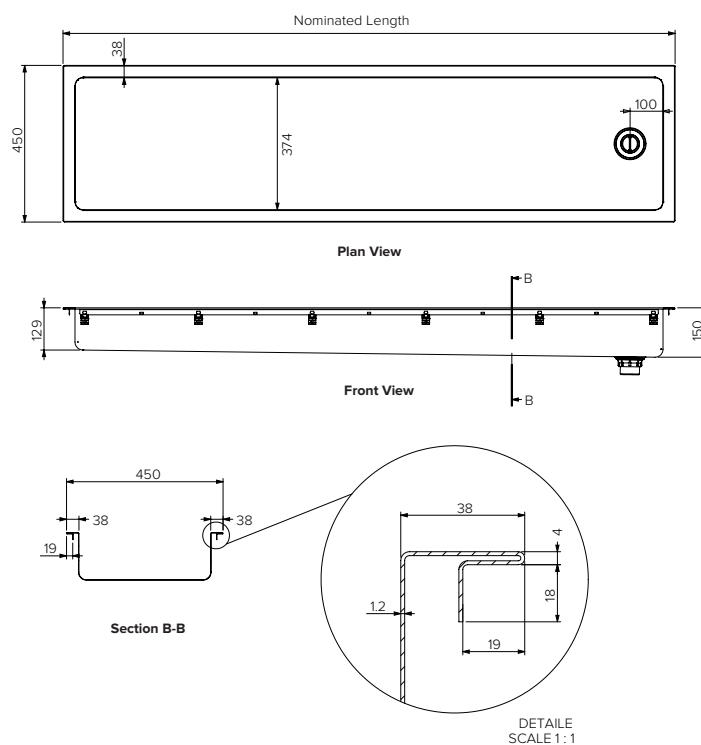

Specifications:

Construction: Fully welded seamless 304 grade 1.2 mm thick stainless steel construction, no.4 satin finish.

Waste Connection: 50mm, PVC waste supplied on end

Unit Fixing: The unit is supplied with benchtop fixing clips

Model No.	L x D x H (mm)
SPPL.WT.DI.xxxx	Nominated x 450 x 150
Custom units available	



Due to continuous product research and development, the information contained herein is subject to change without notice.

Revision: A - 18/06/2021

www.stoddart.com.au
www.stoddart.co.nz

5-10



Proudly Manufactured in Australia