

Low Profile Basin - Wall Hung

Model: SPPL.SE.WB.L.xxx

SPPL = Stoddart Plumbing Product

SE = Safe Ensuite

WB = Wash Basin

L = Low Profile

eg.: for specification and ordering quote

Code: SPPL.SE.WB.L.081

Features and Benefits:

- Ideal for specialist hospitals, clinics, care homes and custodial applications
- Constructed from GRP moulded High Performance impact resistant material with polyester gel coat, formulated to resist chemicals and ultra violet rays
- Polyester gel coat formulated to resist chemicals and ultra violet rays
- Option of 0/1/2 tap holes available
- Vandal and ligature resistant
- Concealed rear waste outlet
- Fixing kit for walls up to 250mm thick provided

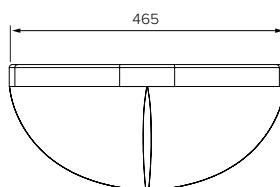

Front View

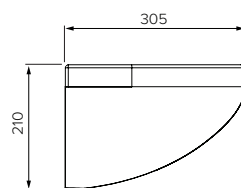

End View

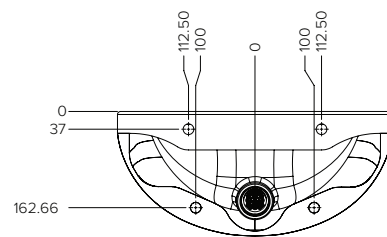

Rear View

Specifications:

- Construction: GRP High Performance Composite material
- Gross Weight: 7.95kg
- Waste Outlet: Rear concealed waste outlet
- Cable Length: 3 metres (8/15m cable P.O.A available upon request)
- Unit Fixing: Secure to wall with provided 4 x 10mm Stainless Steel all thread - to suit 100mm wall thickness. Optional fixing kit is available for fixing the basin on up to 250mm wall thicknesses.

Model No.	Description	L x W x H (mm)
SPPL.SE.WB.L.081	No Tap Holes	465 x 305 x 210
SPPL.SE.WB.L.082	Single Left Hand Tap Hole	465 x 305 x 210
SPPL.SE.WB.L.083	Single Right Hand Tap Hole	465 x 305 x 210
SPPL.SE.WB.L.084	Dual Tap Holes	465 x 305 x 210

Due to continuous product research and development, the information contained herein is subject to change without notice.

Revision: A - 20/05/2021