

## Product Information:

- High quality 304 grade stainless steel construction
- Designed to bridge between benches
- 1.2mm thick, no. 4 finish
- Fully insulated stainless steel ice well, removable drip tray
- Includes Speed Rack
- 2 x stainless integrated rod

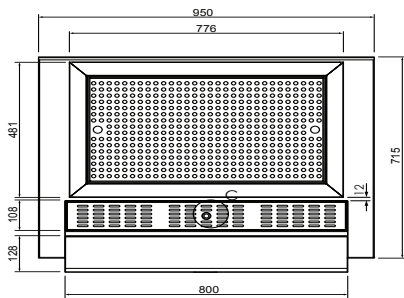

## General Drawing:



PLAN - LARGE ICE WELL

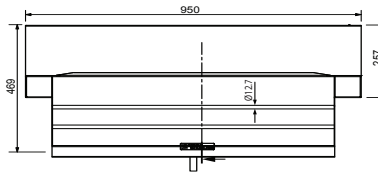

FRONT ELEVATION

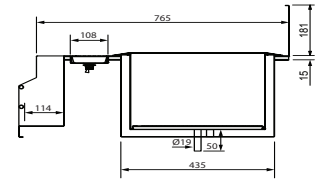

SIDE ELEVATION

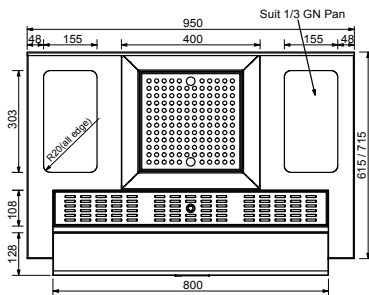

PLAN - SMALL ICE WELL

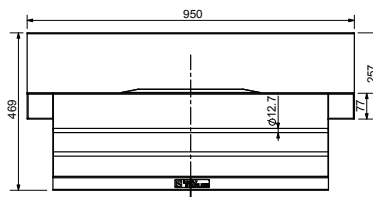

FRONT ELEVATION

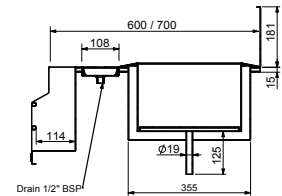

SIDE ELEVATION

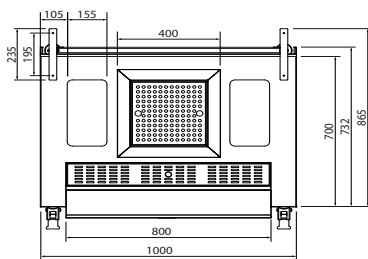

MOBILE ICE WELL- PLAN

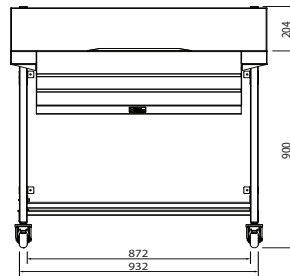

FRONT ELEVATION

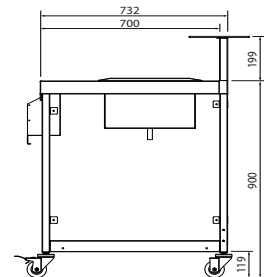

SIDE ELEVATION

## Specifications

Product Code	W x D x H (mm)	Internal Ice Well Dimensions	
		W	D x H (mm)
SBM.CS.0950	950 x 665 x 469	300	300 x 202
SBM.CS.7.0950	950 x 765 x 469	300	300 x 202
SBM.CS.7.1000.LG.MOBILE	1000 x 700 x 900	1000	865 x 1100
SBM.CSB.7.0950	950 x 765 x 469	380	675 x 273

Due to continuous product research and development, the information contained herein is subject to change without notice.

Revision: B - 29/07/2024 - 03

[www.stoddart.com.au](http://www.stoddart.com.au)