



**INSTALLATION  
AND OPERATION MANUAL**  
**READ ALL INSTRUCTIONS BEFORE USE**



**Models:**  
My Carts and Deep Ledge Utility Carts



**Page Intentionally Left Blank**

## 1.0 Introduction

1.1 Your New Metro Product . . . . .	3
1.2 Australia and New Zealand Warranty . . . . .	4
1.2.1 Warranty Period	
1.2.2 Warranty Registration	
1.3 General Precautions . . . . .	4

## 2.0 Installation

2.1 Product Overview. . . . .	5
2.2 Setting Up . . . . .	6
2.2.1 Handling	
2.2.2 Unpacking	

## 3.0 Assembly

3.1 My Cart 2 & 3 Tier . . . . .	7
3.2 My Cart Deep Ledge . . . . .	9

## 4.0 Cleaning and Maintenance

4.1 My Cart 2 & 3 Tier . . . . .	13
4.2 My Cart Deep Ledge . . . . .	13
4.3 Disposal . . . . .	13
5.0 Troubleshooting . . . . .	14
5.1.1 Troubleshooting Procedures	

## 1.1 Your New Metro Product

Thank you for choosing this quality Metro product.

All Metro products are designed and manufactured to meet the needs of food service professionals. By caring for and maintaining this new Metro product in accordance with these instructions, will provide many years of reliable service.

Stoddart is a wholly Australian owned company, which manufactures and/or distributes a comprehensive range of food service equipment for kitchens, food preparation and presentation. Stoddart products are manufactured and engineered to provide excellent results whilst offering value-for-money, ease-of-use and reliability.

**Carefully read this instruction booklet, as it contains important advice for safe installation, operation and maintenance. Keep this booklet on hand in a safe place for future reference by other operators or users.**

### Disclaimer

The manufacturer/distributor cannot be held responsible or liable for any injuries or damages of any kind that occur to persons, units or others, due to abuse and misuse of this unit in regards to installation, removal, operation, servicing or maintenance, or lack of conformity with the instructions indicated in this documentation.

All units made by the manufacturer/distributor are delivered assembled, where possible, and ready to install. Any installation, removal, servicing, maintenance and access or removal of any parts, panels or safety barriers that is not permitted, does not comply in accordance to this documentation, or not performed by a **TRAINED AND AUTHORISED SPECIALIST** will result in the **IMMEDIATE LOSS OF THE WARRANTY.**

The manufacturer/distributor cannot be held responsible or liable for any unauthorised modifications or repairs. All modifications or repairs must be approved by the manufacturer/distributor in writing before initiating. All modifications or repairs performed to this unit must be performed at all times by a **TRAINED AND AUTHORISED SPECIALIST.**

**Stoddart design, manufacture & distribute Food Service Equipment (appliances) exclusively for the commercial market.  
This appliance is not designed nor intended for household or domestic use and must not be used for this purpose.**

This product is intended for commercial use, and in line with Australian electrical safety standards the following warnings are provided:

- This product is not intended for use by persons (including children) with reduced physical, sensory or mental capabilities, or lack of experience and knowledge, unless they have been given supervision or instruction concerning the use of the product by a person responsible for their safety. Children should be supervised to ensure that they do not play with the product
- If the supply cord is damaged, it must be replaced by the manufacturer, its service agent or similarly qualified persons in order to avoid a hazard



## Warranty & Registration

### 1.2 Australia and New Zealand Warranty

#### 1.2.1 Warranty Period

All Stoddart manufactured and distributed products are covered by Stoddart's standard Australia and New Zealand Product Warranty (minimum 12 month on-site parts and labour, terms and conditions apply). Further to this standard warranty, certain products have access to an extended warranty. Full terms, conditions and exclusions can be found using the below Link/QR code.

#### 1.2.2 Warranty Registration

To register your new product, Follow the below Link/QR code.

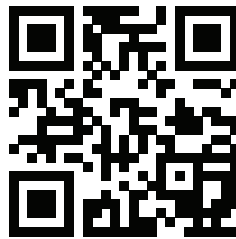

[www.stoddart.com.au/warranty-information](http://www.stoddart.com.au/warranty-information)

### 1.3 General Precautions

When using any electrical unit, safety precautions must always be observed.

Our units have been designed for high performance. Therefore, the unit must be used exclusively for the purpose for which it has been designed.

- All units **MUST** be installed according to the procedures stated in the installation section of this manual
- In the case of new personnel, training is to be provided before operating the equipment
- **DO NOT** use this unit for any other purpose than its intended use
- **DO NOT** store explosive substances such as aerosol cans with a flammable propellant in or near this unit
- Keep fingers out of "pinch point" areas
- Unit is not waterproof **DO NOT** use jet sprays, hoses or pour water over/on the exterior of the unit
- Only use this unit with voltage specified on the rating label
- **DO NOT** remove any cover panels that may be on the unit
- **DO NOT** use sharp objects to activate controls
- If any fault is detected, refer to troubleshooting
- The manufacturer declines any liability for damages to persons and/or things due to an improper/wrong and/or unreasonable use of the machine
- Only specifically trained/qualified Technicians (Stoddart, one of our service agents, or a similarly qualified persons) should carry out any and all repairs, maintenance and services

## 2.1 Product Overview

	WARNING - TIPPING HAZARD
	<ul style="list-style-type: none"> <li>Do not stand or climb on shelving.</li> <li>Place heavy objects on lowest shelf.</li> <li>Distribute weight as evenly as possible.</li> <li>Push mobile unit in long direction.</li> <li>Inspect casters before use.</li> <li>Replace worn casters immediately.</li> </ul> <p><b>Failure to follow these instructions could result in personal injury or property damage.</b></p>

	WEIGHT CAPACITY - DEEP LEDGE CARTS
	<p>Shelf - 68kg Unit - 227kg</p>

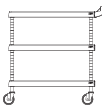
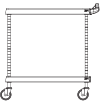
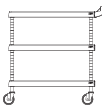
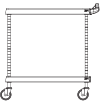
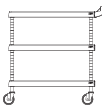
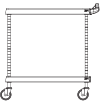
	WEIGHT CAPACITY - MY CARTS 2 & 3 TIER															
	<table border="1"> <thead> <tr> <th>SIZE TIER</th> <th>406 x 686mm 16"x 27"</th> <th>508 x 762mm 20"x 30"</th> <th>606 x 915mm 26"x 36"</th> </tr> </thead> <tbody> <tr> <td>  </td> <td>181Kgs 400Lbs</td> <td>181Kgs 400Lbs</td> <td>226Kgs 500Lbs</td> </tr> <tr> <td>  </td> <td>136Kgs 300Lbs</td> <td>136Kgs 300Lbs</td> <td>181Kgs 400Lbs</td> </tr> </tbody> </table>	SIZE TIER	406 x 686mm 16"x 27"	508 x 762mm 20"x 30"	606 x 915mm 26"x 36"		181Kgs 400Lbs	181Kgs 400Lbs	226Kgs 500Lbs		136Kgs 300Lbs	136Kgs 300Lbs	181Kgs 400Lbs			
	SIZE TIER	406 x 686mm 16"x 27"	508 x 762mm 20"x 30"	606 x 915mm 26"x 36"												
		181Kgs 400Lbs	181Kgs 400Lbs	226Kgs 500Lbs												
	136Kgs 300Lbs	136Kgs 300Lbs	181Kgs 400Lbs													

## 2.2 Setting Up

### 2.2.1 Handling

- Use suitable means to move the unit;
  - For smaller items use two people
  - For large items a fork lift, pallet trolley or similar (the forks should reach completely beneath the pallet)

### 2.2.2 Unpacking

- Check the unit for damage before and after unpacking. If unit is damaged, contact the distributor and manufacturer
- Should any item have physical damage, report the details to the freight company and to the agent responsible for the dispatch within seven (7) days of receipt. No claims will be accepted or processed after this period
- The unit is supplied flat packed and will require assembly.
- Remove all protective plastic film, tapes, ties and packers before installing and operating
- Remove shelf transport springs and zipties
- Clean off any remaining residue from the unit using a clean cloth dampened with warm soapy water

## 3.1 My Cart 2 &amp; 3 Tier

## MYCART™ SERIES UTILITY CART

Assembly Video:

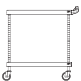

SIZE TIER	406 x 686mm 16"x27"	508 x 762mm 20"x30"	606 x 915mm 26"x36"					
	400Lbs 181Kgs	400Lbs 181Kgs	500Lbs 226Kgs	x24	x4	x4	x1	x2
	300Lbs 136Kgs	300Lbs 136Kgs	400Lbs 181Kgs	x16	x4	x4	x1	x1

All carts

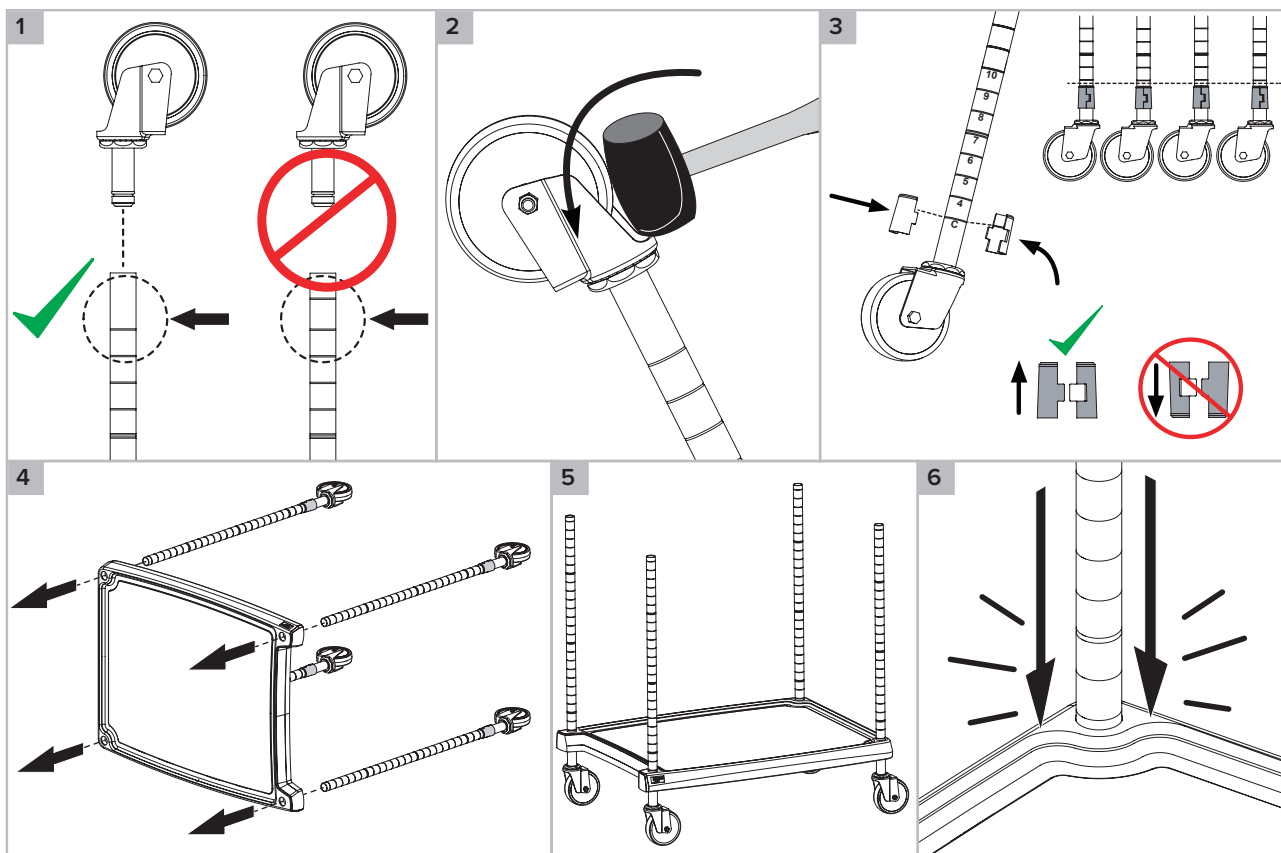



### 2-Shelf Cart

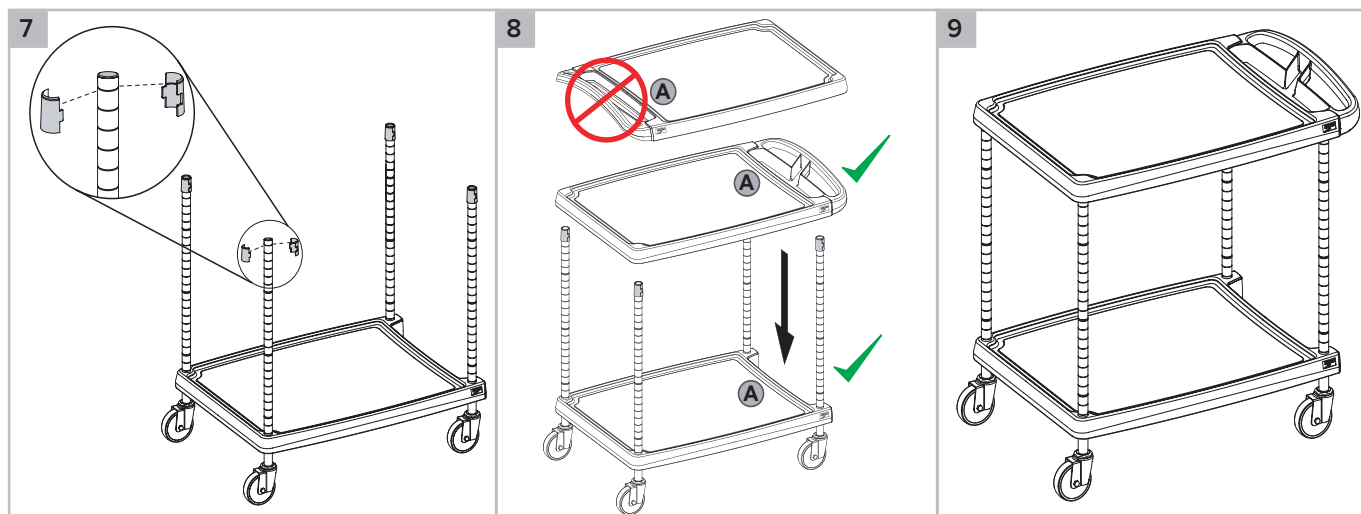

### 3-Shelf Cart

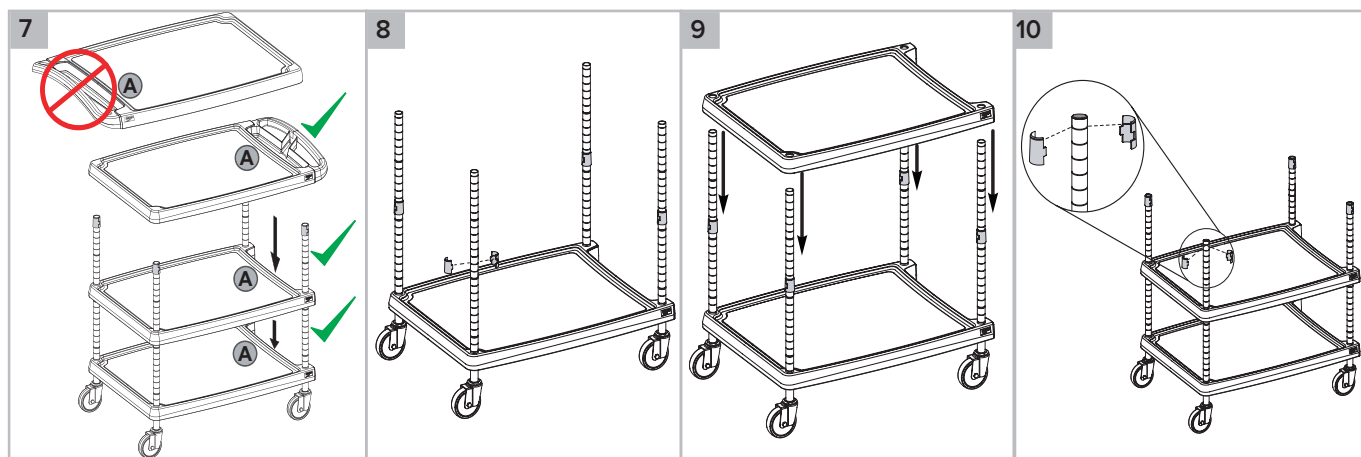

#### Cleaning Information

Most spills can be cleaned with a damp cloth or a water rinse, however, stubborn soils may require the use of commercial cleaning products. The use of abrasive cleaners and/or harsh chemicals is NOT recommended. Always insure that the cleaner is recommended for use on plastics, and follow any special instructions from the cleaner manufacturer.

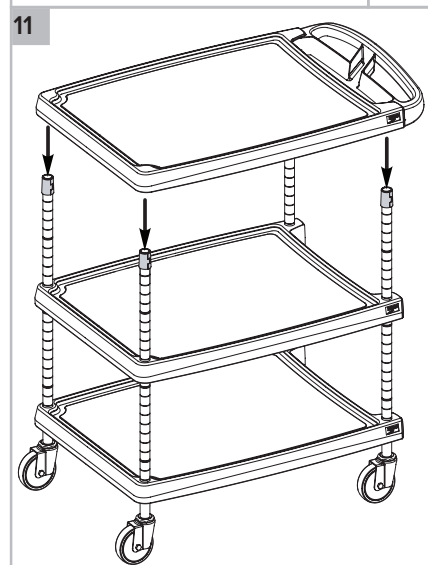

Information and specifications are subject to change without notice. Please confirm at time of order.

Due to continuous product research and development, the information contained herein is subject to change without notice.

[www.stoddart.com.au](http://www.stoddart.com.au)

[www.stoddart.co.nz](http://www.stoddart.co.nz)

### 3.2 My Cart Deep Ledge

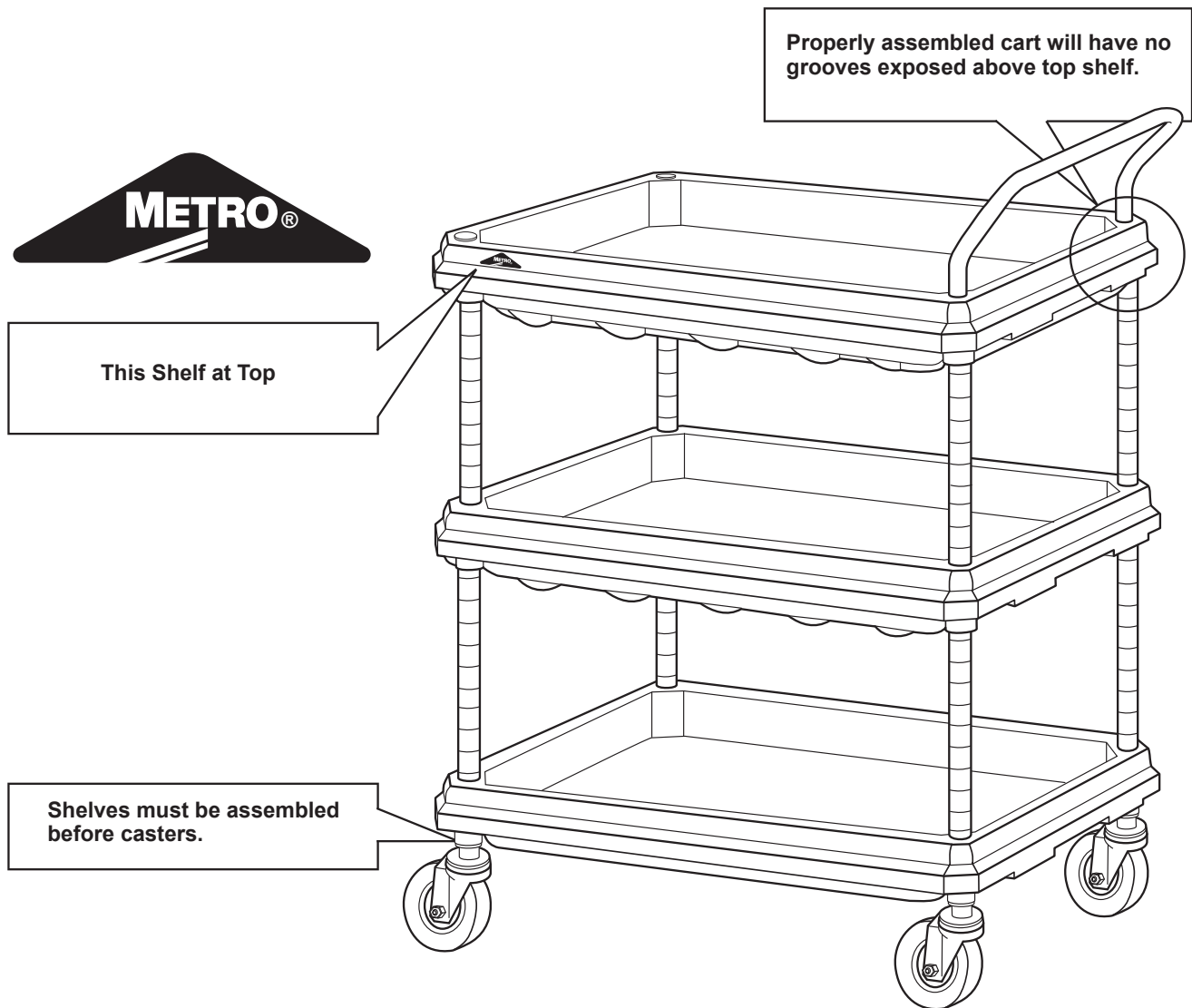

## LIST OF COMPONENTS

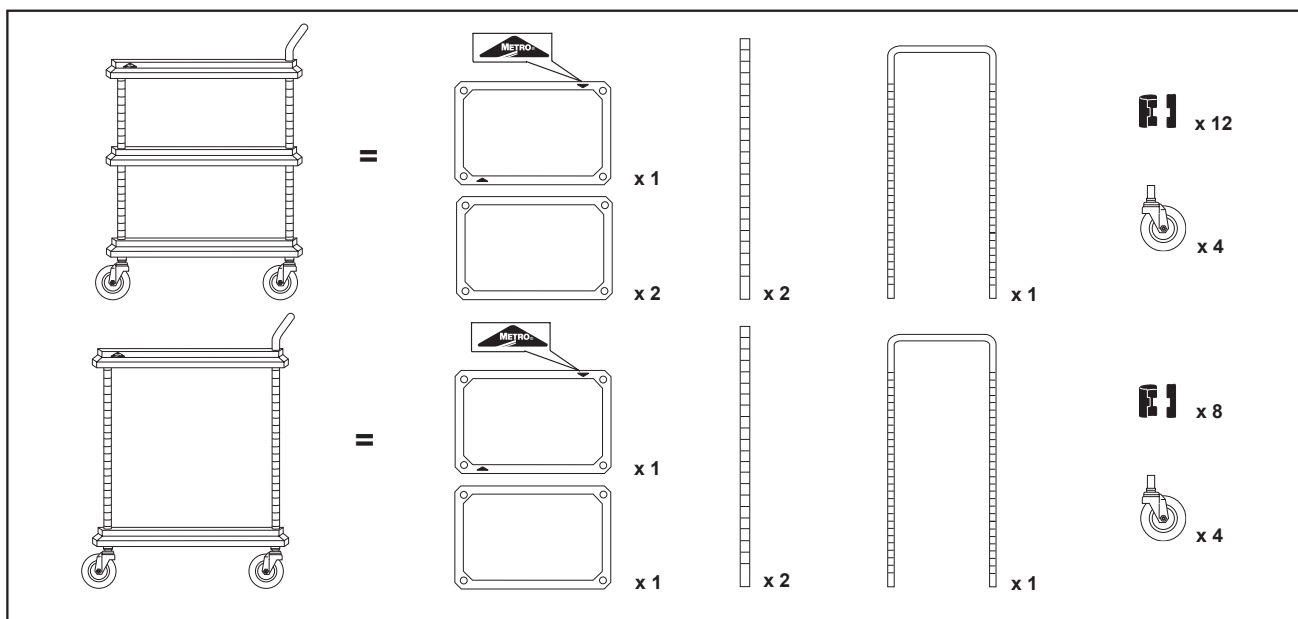

### ATTENTION!

**Shelves must be assembled before casters.**

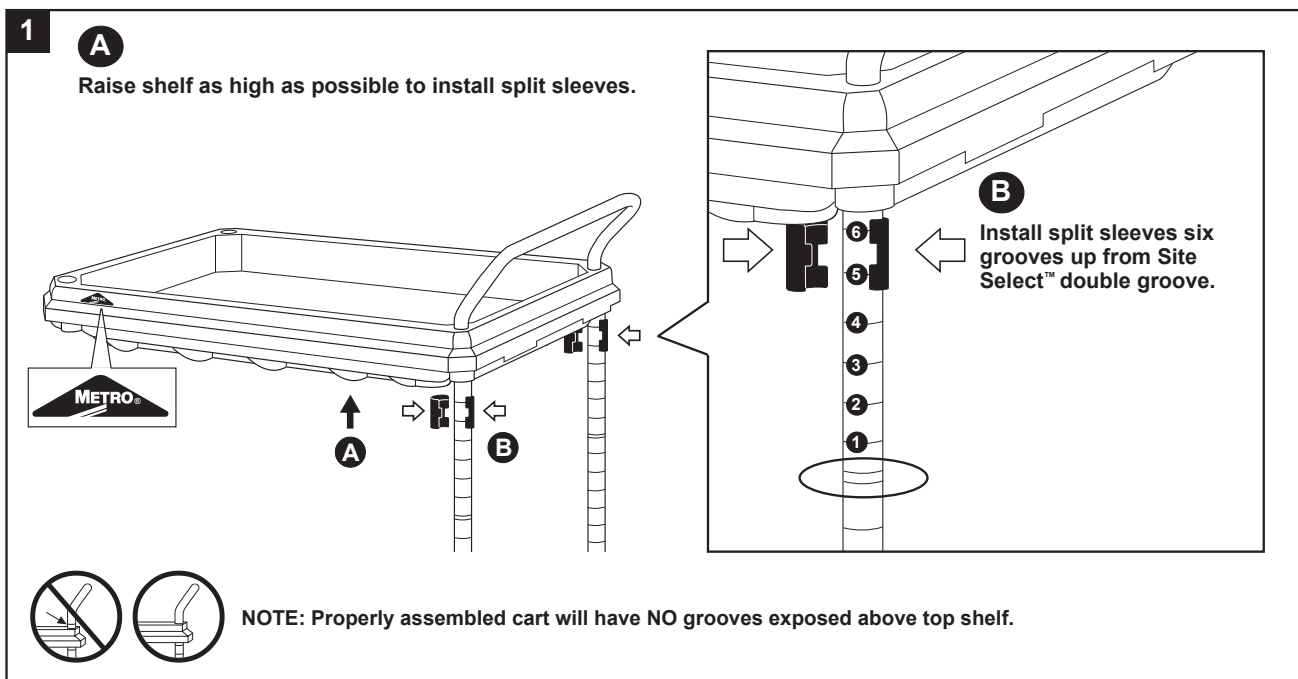

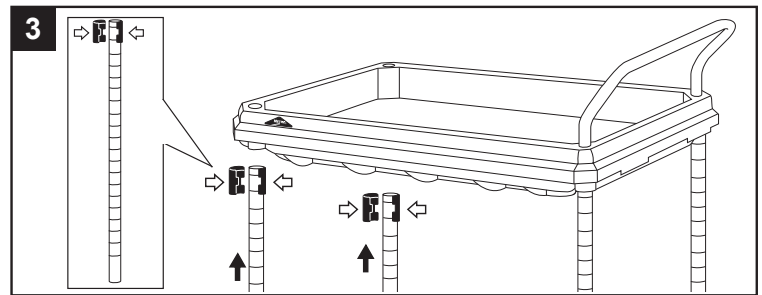
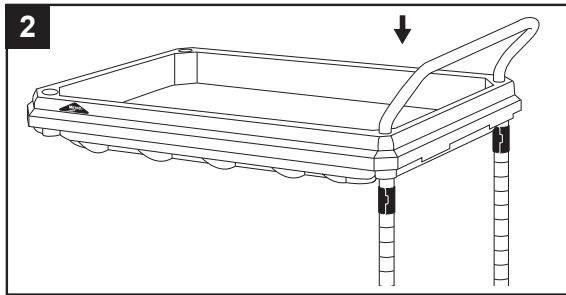

For 3-shelf unit, install middle shelf now. **4**

For 2-shelf unit, proceed to step **6**.

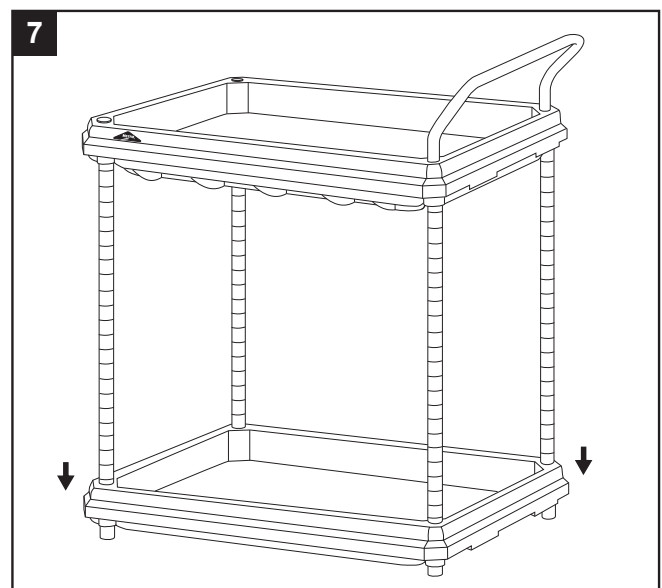
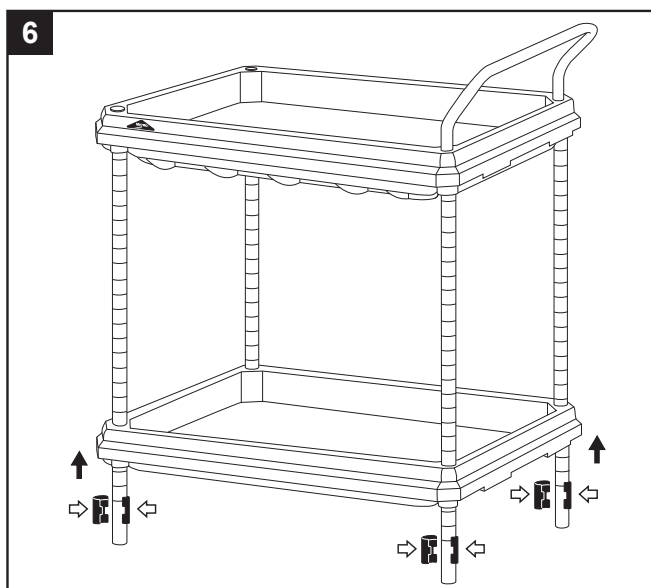
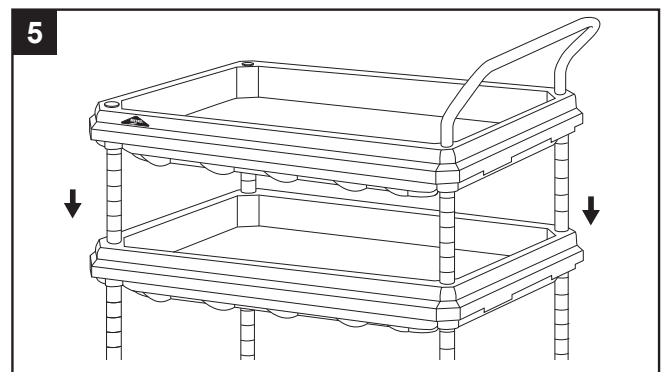
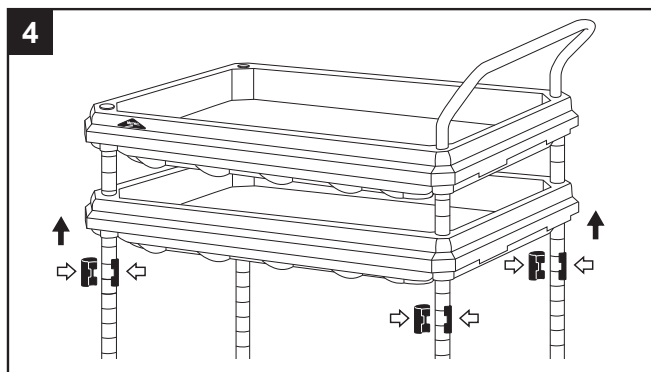

8

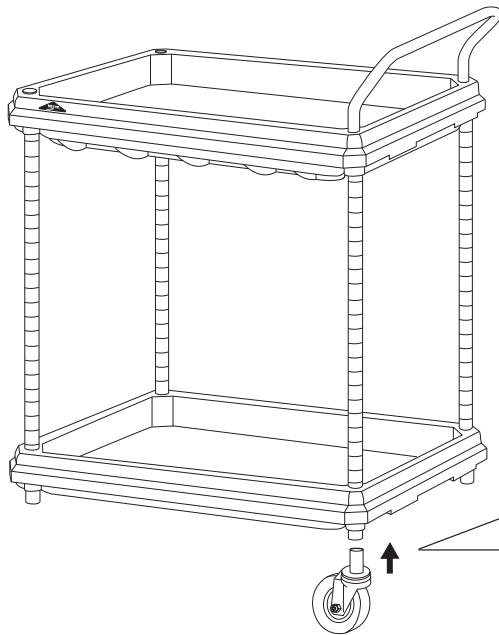

**ATTENTION! Shelves must be assembled before casters.**

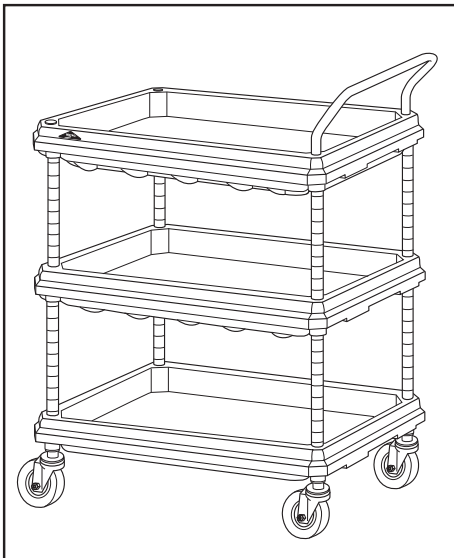
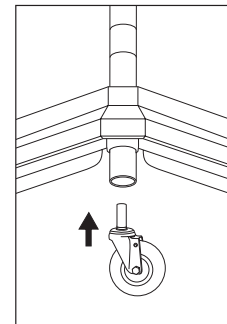

## WEIGHT LOAD CAPACITY

Shelf	68 kg
Unit	182 kg

### 4.0 Cleaning

#### 4.1 My Cart 2 & 3 Tier

1. Most spills can be cleaned with a damp cloth or a water rinse, however, stubborn soils may require the use of commercial cleaning products.
2. The use of abrasive cleaners and/or harsh chemicals is NOT recommended.
3. Always insure that the cleaner is recommended for use on plastics, and follow any special instructions from the cleaner manufacturer.

#### 4.2 My Cart Deep Ledge

1. Most spills can be cleaned with a damp cloth or a water rinse, however, stubborn soils may require the use of commercial cleaning products.
2. The use of abrasive cleaners and/or harsh chemicals is NOT recommended.
3. Always insure that the cleaner is recommended for use on plastics, and follow any special instructions from the cleaner manufacturer.

### 4.3 Disposal

If the appliance is no longer of use, please dispose in an environmentally correct way.

The distributor / retailer can contact their local metal recycling centre to collect the remaining cabinet, shelves, etc.

There may be special requirements or conditions. Information on the disposal of refrigeration appliances can be obtained from:

- Your supplier
- Government authorities (The local council, Ministry of the Environment, etc.)



Discarded electric appliances are recyclable and should not be discarded in the domestic waste! Please actively support us in conserving resources and protecting the environment by returning this appliance to the collection centres (if available).



Dispose of packaging in accordance to applicable legal regulations.

## 4.0 Cleaning and Maintenance



### 5.0 Troubleshooting

#### 5.1.1 Troubleshooting Procedures

- If any faults/issues occur with the unit, follow the below troubleshooting procedures
- If the troubleshooting procedures do not correct the problem, contact the Stoddart Service Department

Problem	Possible Causes	Possible Corrective Action
	Shelving is not level	<ul style="list-style-type: none"><li>• Ensure each shelf clip/wedge are on the same post number</li></ul>
		<ul style="list-style-type: none"><li>• Adjust post feet to ensure unit is level</li></ul>
	Mobile units feel unsecure	<ul style="list-style-type: none"><li>• Ensure caster wheels have been fixed securely</li></ul>
		<ul style="list-style-type: none"><li>• Ensure caster wheels are in good working condition</li></ul>



## Australia

Australian Business Number: 16009690251

### Service / Spare Parts

<https://customerservice.stoddart.com.au>

### Sales

Tel: 1300 79 1954

Email: [sales@stoddart.com.au](mailto:sales@stoddart.com.au)

Web: [www.stoddart.com.au](http://www.stoddart.com.au)

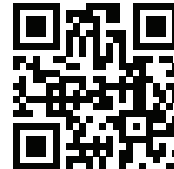

Customer  
Service Portal

---

## New Zealand

New Zealand Business Number: 6837694

### Service / Spare Parts

<https://customerservice.stoddart.com.au>

### Sales

Tel: 0800 79 1954

Email: [sales@stoddart.co.nz](mailto:sales@stoddart.co.nz)

Web: [www.stoddart.co.nz](http://www.stoddart.co.nz)

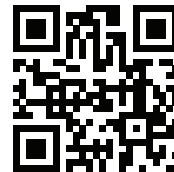

Customer  
Service Portal