

DRINKING FOUNTAINS

Metro - Freestanding

Model: SPPL.DF.Mx.FS.yy

SPPL = Stoddart Plumbing Product
 DF = Drinking Fountain
 Mx = MS = Metro Single
 = MD = Metro Dual
 FS = Freestanding
 yy = DB = Dog bowl (hinged, includes tap for filling)
 = BF - Bottle Filler Position (bottle filler supplied separately)
 eg: for specification and ordering quote
 Code: SPPL.DF.MD.FS

Features and Benefits

- Ideal for Schools, Shopping malls and outdoor areas
- Easy-Push buttons & valves supply a regulated flow of fresh drinking water while reducing water waste
- Large rounded collection bowl prevents excess water on the ground
- Floor mounted drinking fountain can be easily mounted to most wall surfaces at heights suitable to the application.
- Wheelchair accessible as per the requirements advised in AS1428.2
- A Backflow Prevention Device is connected to the appliance for connecting to mains water supply
- For connecting to a waste, a trap is connected to the outlet
- Plumbing components used with this product meet or exceed the performance requirements of WMTS-105

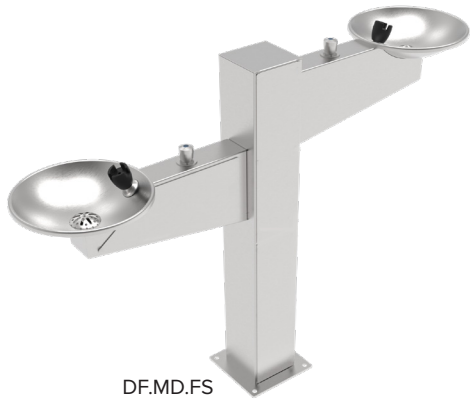

DF.MD.FS



DF.MS.FS

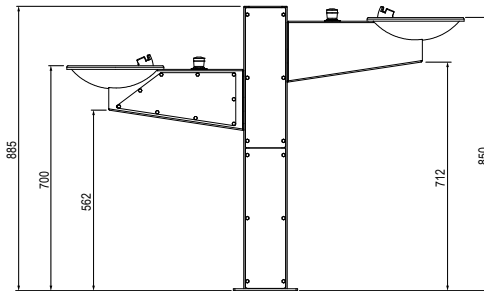
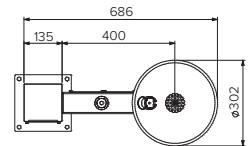
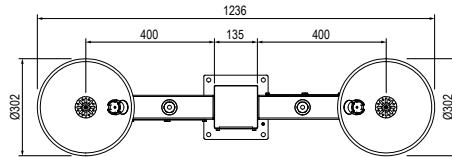

DF.MD.FS

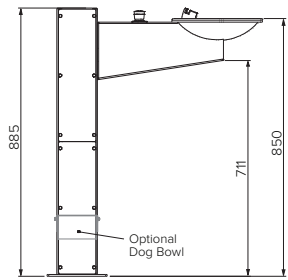

DF.MS.FS

Specifications:

Construction: 2.0 316 grade stainless steel construction, no.4 satin finish. Unit is pre-plumbed with button and bubbler.

Water Connection: Single 15mm (1/2" BSP)

Waste Connection: 40mm waste connection

Unit Fixing: The unit is welded to a 6mm thick stainless steel floor mounting plate with 13mm fixing holes. Drink fountain access panels are fitted to bowl arm and post with 6mm fixings.

Model No.	L x D x H (mm)
SPPL.DF.MS.FS	686 x 302 x 885
SPPL.DF.MS.FS.BF	686 x 302 x 885
SPPL.DF.MS.FS.DB	686 x 302 x 885
SPPL.DF.MS.FS.BF.DB	718 x 302 x 885
SPPL.DF.MD.FS	1236 x 302 x 885
SPPL.DF.MD.FS.BF	1236 x 302 x 885
SPPL.DF.MD.FS.DB	1236 x 302 x 885
SPPL.DF.MD.FS.BF.DB	1236 x 302 x 885

Optional Extras:

Sold Separately - Tapware Options:



CMPL.0615



DB



CMPL.1226



Tapware components supplied for this appliance are Watermarked and WELS rated



Due to continuous product research and development, the information contained herein is subject to change without notice.

Revision: A - 8/07/2025 - 04

www.stoddart.com.au

www.stoddart.co.nz