

SAFE ENSUITE



STODDART[®]

PLUMBING PRODUCTS



- 4** Wash Basin - Wall Mounted Single Outlet
- 5** Wash Basin - Wall Mounted Dual Outlet
- 6** V2 Integrated Wash Basin
- 7** Low Profile Basin - Wall Hung
- 8** High Security WC Toilet Pan - Floor Mounted
- 9** Access WC Toilet Pan Spacer Box
- 10** Mirror
- 11** Mirror with Shelf



SAFE ENSUITE

Wash Basin - Wall Mounted

Model: SPPL.SE.WB.IS.xxx

SPPL = Stoddart Plumbing Product
 SE = Safe Ensuite
 WB = Basin
 IS = Integrated Splashback with Single Outlet
 eg.: for specification and ordering quote
 Code: SPPL.SE.WB.IS.106

Features and Benefits:

- Ideal for specialist hospitals, clinics, care homes and custodial applications
- Constructed from GRP moulded High Performance impact resistant material with polyester gel coat, formulated to resist chemicals and ultra violet rays
- Moulded impact resistant
- Moulded soap shelves
- Vandal and ligature resistant
- Programmable, wave-on or tactile activation sold separately

**Sold Separately****Sensor Options:**

Programmable
Standard, Hot (red) & Cold (blue)

Wave on
Hot (red) & Cold (blue)

Tactile Switch Options:

Tactile Switch
Hot (red) & Cold (blue)

Specifications:

Construction:	GRP High Performance Composite material
Gross Weight:	10kg
Tap Outlet:	Integrated stainless steel water spout set at 5L /min
Waste Grid:	316 grade Stainless Steel anti-ligature
Cable Length:	3 metres (8/15m cable P.O.A available upon request)
Unit Fixing:	Secure to wall with provided 4 x 10mm Stainless Steel all thread - to suit 100mm wall thickness only.

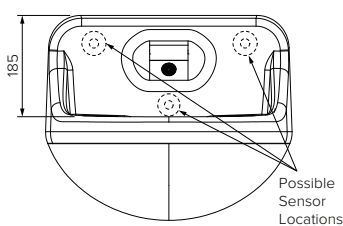
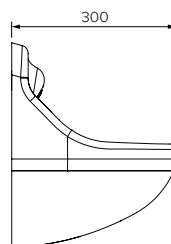
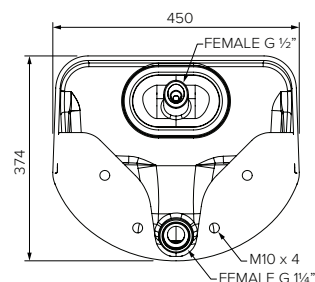
**Front View****End View****Rear View**

Model No.	Description	L x W x H (mm)
SPPL.SE.WB.IS.125	No sensor	450 x 300 x 374
SPPL.SE.WB.IS.106	Programmable centre sensor	450 x 300 x 374
SPPL.SE.WB.IS.119	Left hand Tactile button	450 x 300 x 374
SPPL.SE.WB.IS.120	Left hand Wave-on sensor	450 x 300 x 374
SPPL.SE.WB.IS.124	Left hand Programmable sensor	450 x 300 x 374
SPPL.SE.WB.IS.113	Right hand Tactile button	450 x 300 x 374
SPPL.SE.WB.IS.114	Right hand Wave-on sensor	450 x 300 x 374
SPPL.SE.WB.IS.118	Right hand Programmable sensor	450 x 300 x 374
SPPL.SE.WB.IS.107	Dual Tactile buttons	450 x 300 x 374
SPPL.SE.WB.IS.108	Dual Wave-on sensor	450 x 300 x 374
SPPL.SE.WB.IS.112	Dual Programmable sensor	450 x 300 x 374

Due to continuous product research and development, the information contained herein is subject to change without notice.

Revision: B - 3/10/2025

www.stoddart.com.au
www.stoddart.co.nz

Wash Basin - Wall Mounted

Model: SPPL.SE.WB.ID.xxx

SPPL = Stoddart Plumbing Product

SE = Safe Ensuite

WB = Basin

ID = Integrated Splashback with Dual Outlet

eg.: for specification and ordering quote

Code: SPPL.SE.WB.ID.105

Features and Benefits:

- Ideal for specialist hospitals, clinics, care homes and custodial applications
- Constructed from GRP moulded High Performance impact resistant material with polyester gel coat, formulated to resist chemicals and ultra violet rays
- Moulded impact resistant
- Moulded soap shelves
- Vandal and ligature resistant
- Programmable, wave-on or tactile activation sold separately

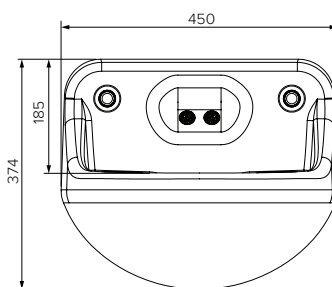

Front View

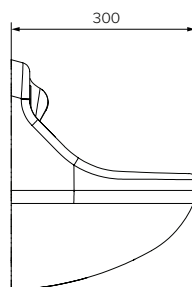

End View

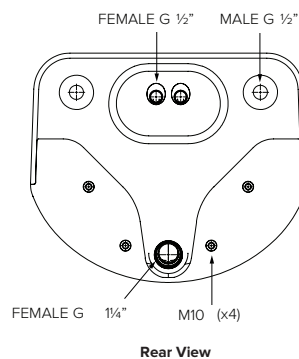

Rear View

Sold Separately

Sensor Options:

Programmable
Standard, Hot (red) & Cold (blue)Wave on
Hot (red) & Cold (blue)

Tactile Switch Options:

Tactile Switch
Hot (red) & Cold (blue)**Specifications:**

Construction:	GRP High Performance Composite material
Gross Weight:	10kg
Tap Outlet:	Integrated stainless steel water spout set at 5L /min
Waste Outlet:	Rear concealed waste outlet
Waste Grid:	316 grade Stainless Steel anti-ligature
Cable Length:	3 metres (8/15m cable P.O.A available upon request)
Unit Fixing:	Secure to wall with provided 4 x 10mm Stainless Steel all thread - to suit 100mm wall thickness only.

Model No.	Description	L x W x H (mm)
SPPL.SE.WB.ID.100	Tactile Buttons	450 x 300 x 374
SPPL.SE.WB.ID.101	Wave-on Sensors	450 x 300 x 374
SPPL.SE.WB.ID.105	Programmable Sensors	450 x 300 x 374

Due to continuous product research and development,
the information contained herein is subject to change without notice.

Revision: A - 3/10/2025

www.stoddart.com.au

www.stoddart.co.nz

V2 Integrated Wash Basin

Model: SPPL.SE.WB.HD.xxx

SPPL = Stoddart Plumbing Product

SE = Safe Ensuite

WB = Basin

HD = High Sided Integrated Splashback with Dual Outlet

eg.: for specification and ordering quote

Code: SPPL.SE.WB.HD.080

Features and Benefits:

- Ideal for specialist hospitals, clinics, care homes and custodial applications
- Constructed from GRP moulded High Performance impact resistant material with polyester gel coat, formulated to resist chemicals and ultra violet rays
- Basin and moulded soap shelves
- Moulded impact resistant
- Vandal and ligature resistant
- Wave-on and tactile activation sold separately

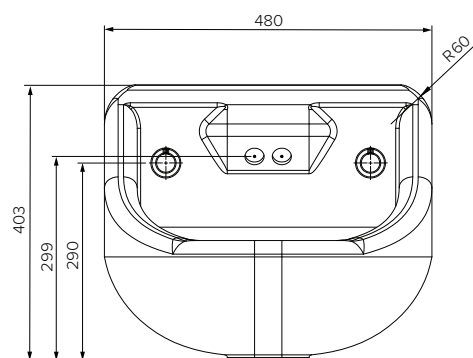

Front View

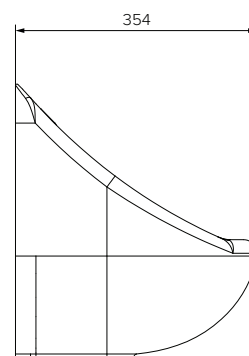

End View

Sold Separately

Sensor Options:

Tactile Switch Options:

Programmable
Standard, Hot (red) & Cold (blue)Wave on
Hot (red) & Cold (blue)Tactile Switch
Hot (red) & Cold (blue)**Specifications:**

Construction:	GRP High Performance Composite material
Gross Weight:	13.6kg
Tap Outlet:	Integrated stainless steel water spout set at 5L /min
Waste Outlet:	Rear concealed waste outlet
Waste Grid:	316 grade Stainless Steel anti-ligature
Cable Length:	3 metres (8/15m cable P.O.A available upon request)
Unit Fixing:	Secure to wall with provided 4 x 10mm Stainless Steel all thread - to suit 100mm wall thickness only.

Model No.	Description	L x W x H (mm)
SPPL.SE.WB.HD.080	Dual sensor, dual outlet	480 x 354 x 403

Due to continuous product research and development,
the information contained herein is subject to change without notice.

Revision: 3/10/2025

www.stoddart.com.au

www.stoddart.co.nz

Low Profile Basin - Wall Hung

Model: SPPL.SE.WB.L.xxx

SPPL = Stoddart Plumbing Product

SE = Safe Ensuite

WB = Wash Basin

L = Low Profile

eg.: for specification and ordering quote

Code: SPPL.SE.WB.L.081

Features and Benefits:

- Ideal for specialist hospitals, clinics, care homes and custodial applications
- Constructed from GRP moulded High Performance impact resistant material with polyester gel coat, formulated to resist chemicals and ultra violet rays
- Polyester gel coat formulated to resist chemicals and ultra violet rays
- Option of 0/1/2 tap holes available
- Vandal and ligature resistant
- Concealed rear waste outlet
- Fixing kit for walls up to 250mm thick provided

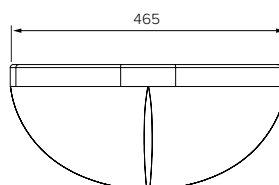

Front View

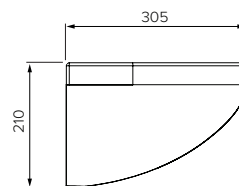

End View

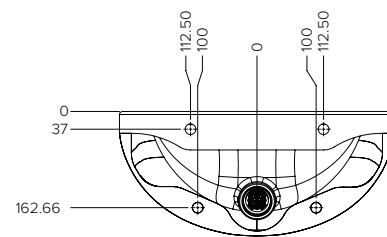

Rear View

Specifications:

Construction:	GRP High Performance Composite material
Gross Weight:	7.95kg
Waste Outlet:	Rear concealed waste outlet
Cable Length:	3 metres (8/15m cable P.O.A available upon request)
Unit Fixing:	Secure to wall with provided 4 x 10mm Stainless Steel all thread - to suit 100mm wall thickness. Optional fixing kit is available for fixing the basin on up to 250mm wall thicknesses.

Model No.	Description	L x W x H (mm)
SPPL.SE.WB.L.081	No Tap Holes	465 x 305 x 210
SPPL.SE.WB.L.082	Single Left Hand Tap Hole	465 x 305 x 210
SPPL.SE.WB.L.083	Single Right Hand Tap Hole	465 x 305 x 210
SPPL.SE.WB.L.084	Dual Tap Holes	465 x 305 x 210

Due to continuous product research and development, the information contained herein is subject to change without notice.

Revision: A - 3/10/2025

www.stoddart.com.au

www.stoddart.co.nz

High Security WC Toilet Pan - Floor Mounted

Model: SPPL.SE.TP.F.xxx

SPPL = Stoddart Plumbing Product

SE = Safe Ensuite

TP = Toilet Pan

F = Floor Mounted

eg.: for specification and ordering quote

Code: SPPL.SE.TP.F.034

**Features and Benefits:**

- Ideal for specialist hospitals, clinics, care homes and custodial applications
- Constructed from GRP moulded High Performance impact resistant material with polyester gel coat, formulated to resist chemicals and ultra violet rays
- Available in 2 heights: Standard and Access*
- Water efficient 4 litre flush
- Domestic aesthetics
- Vandal and ligature resistant
- Hygienic non-porous surface
- Concealed rear waste outlet
- Large trap to reduce blockages
- Warm to the touch surface, eliminates 'icy shock'
- Fixing kit for walls up to 150mm thick provided
- Available with Blue/Grey polyester gel coated top for the visually impaired

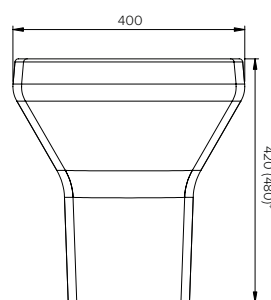

Front View

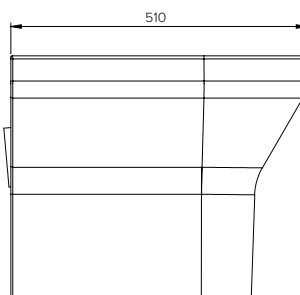

End View

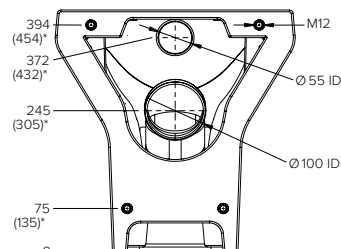

Rear View

Specifications:

Construction:	GRP High Performance Composite material
Gross Weight:	Standard = 16.8kg Access = 18.1kg
Flush Inlet:	ø55
Waste Outlet:	ø100 Rear Concealed outlet
Unit Fixing:	Secure through wall with provided 4 x 12mm Stainless Steel all thread
Optional Colours:	Stoddart have 3 standard RAL colour options (see across), however, we can apply other RAL colours upon request (at an additional cost). Available on the standard back-to-wall and wall-hung pans

Model No.	Description	L x W x H (mm)
SPPL.SE.TP.F.010	Standard height - White Top	510 x 400 x 420
SPPL.SE.TP.F.011	Access height - White Top	510 x 400 x 480
SPPL.SE.TP.F.034	Standard height - Blue Top	510 x 400 x 420
SPPL.SE.TP.F.035	Access height - Blue Top	510 x 400 x 480
SPPL.SE.TP.F.071	Standard height - Grey Top	510 x 400 x 420
SPPL.SE.TP.F.072	Access height - Grey Top	510 x 400 x 480
SPPL.SE.TP.F.074	Standard height - Red Top	510 x 400 x 420
SPPL.SE.TP.F.075	Access height - Red Top	510 x 400 x 480

*Indicates dimensions for access model

Due to continuous product research and development, the information contained herein is subject to change without notice.

Revision: A - 3/10/2025

www.stoddart.com.au

www.stoddart.co.nz



Access WC Toilet Pan Spacer Box

Model: SPPL.SE.TP.ASB

SPPL = Stoddart Plumbing Product

SE = Safe Ensuite

TP = Toilet Pan

ASB = Access Spacer Box

eg.: for specification and ordering quote

Code: SPPL.SE.TP.ASB

Features and Benefits:

- Designed specifically to allow access for wheelchairs on Stoddart Safe Ensuite toilet pans
- Constructed from GRP moulded high performance impact resistant material with polyester gel coat, formulated to resist chemicals and ultra violet rays
- Optional extra for use with SE.TP.F.xxx pans (Access high models only)

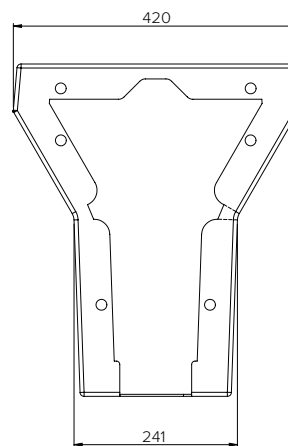
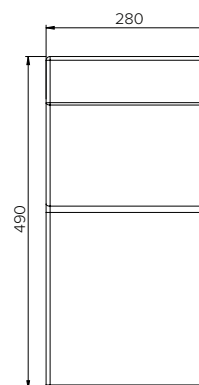
**FRONT VIEW****END VIEW****Specifications:**

Construction: GRP High Performance Composite material

Unit Fixing: Unit has holes for fixing itself to the toilet pan and the wall. Fixing kit is supplied.

Model No.	Description	L x W x H (mm)
SPPL.SE.TP.ASB	Standard Model	420 x 280 x 490



Due to continuous product research and development,
the information contained herein is subject to change without notice.

Revision: A - 3/10/2025

www.stoddart.com.au
www.stoddart.co.nz

Mirror

Model: SPPL.SE.MI.025

SPPL = Stoddart Plumbing Product

SE = Safe Ensuite

MI = Mirror

eg.: for specification and ordering quote

Code: SPPL.SE.MI.025

Features and Benefits:

- Ideal for specialist hospitals, clinics, care homes and custodial applications
- Constructed from GRP moulded High Performance impact resistant material with polyester gel coat, formulated to resist chemicals and ultra violet rays
- Virtually indestructible polycarbonate mirror insert
- Impact resistant frame and mirror
- Anti-ligature

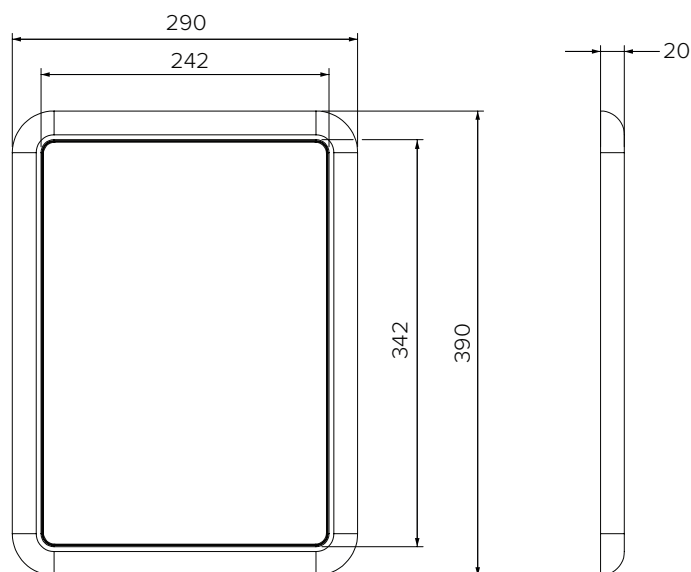

Front View

End View

Specifications:

Construction: GRP High Performance Composite material

Gross Weight: 2.20kg

Unit Fixing: Structural adhesive (contact Stoddart)

Model No.	L x H x W (mm)
SPPL.SE.MI.025	290 x 390 x 20

Due to continuous product research and development,
the information contained herein is subject to change without notice.

Revision: A - 3/10/2025

www.stoddart.com.au

www.stoddart.co.nz

Mirror with Shelf

Model: SPPL.SE.MI.037

SPPL = Stoddart Plumbing Product

SE = Safe Ensuite

MI = Mirror

eg.: for specification and ordering quote

Code: SPPL.SE.MI.037

Features and Benefits:

- Ideal for specialist hospitals, clinics, care homes and custodial applications
- Constructed from GRP moulded High Performance impact resistant material with polyester gel coat, formulated to resist chemicals and ultra violet rays
- Virtually indestructible polycarbonate mirror insert
- Recessed shelf built in to the mirror frame
- Ligature and impact resistant
- 2 orientations to suit the needs of any application

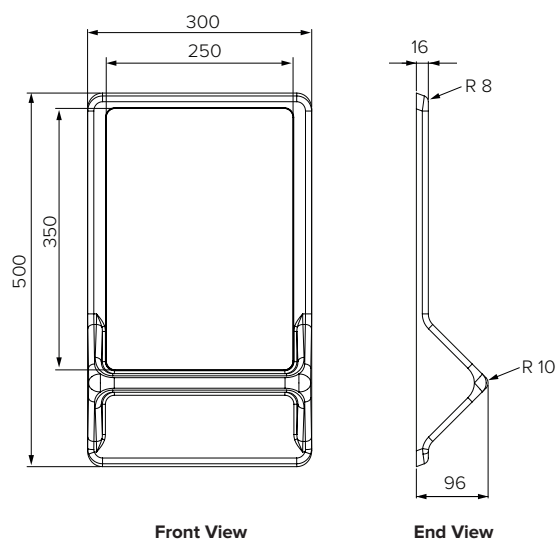
**Orientation**

No.1

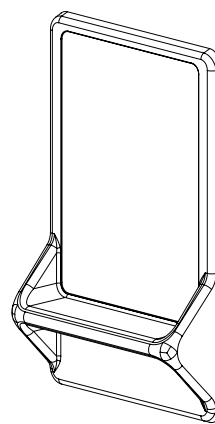

No.2

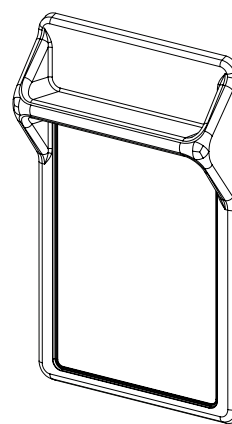
**Specifications:**

Construction: GRP High Performance Composite material

Gross Weight: 3.25kg

Unit Fixing: Structural adhesive (contact Stoddart)

Model No.	L x H x W (mm)
SPPL.SE.MI.037	300 x 500 x 96

Due to continuous product research and development,
the information contained herein is subject to change without notice.

Revision: A - 3/10/2025

www.stoddart.com.au
www.stoddart.co.nz

Brisbane

Sydney

Melbourne

Perth

Adelaide

1300 79 1954

www.stoddart.com.au

Auckland

0800 79 1954

www.stoddart.co.nz

