

KYOTA™

M888 Kokoro 4D Massage Chair User's Manual



KYOTA™

Kyota Massage Chairs
800-242-0761 | www.kyotamassagechairs.com

www.kyotamassagechairs.com

Congratulations and thank you for trusting Kyota Massage Chairs. Combined with healthy eating, exercise, and a good sleep regimen, your massage chair is a great way to take care of your body and mind. This will lead to a happy, productive lifestyle.

Please read and follow all safety and operating instructions listed in this user manual prior to use. Basic precautions should always be used when operating an electrical appliance.

Please Note: We reserve the right to make changes to information published in this manual, including but not limited to, specifications and product descriptions. These changes may be made at any time and without notice. This manual supersedes and replaces all information supplied prior to the publication hereof.

Preparation	Safety Precautions	2
	Massage Chair Parts	6

Usage & Maintenance	Installation & Placement Instructions	8
	Remote & Massage Chair Operation	14
	Product Care & Storage	21

Additional Info.	Troubleshooting	22
	Specifications	23

Contact Kyota Massage Chairs' Technical Support Team with any questions or concerns at 800-242-0761. Our dedicated specialists will be happy to assist you!

Watch the Assembly Video:
<https://kyotamassagechairs.com/assembly-tutorials/M888>

IMPORTANT SAFETY INSTRUCTIONS

CAUTION

- TO REDUCE THE RISK OF ELECTRIC SHOCK, DO NOT REMOVE COVER. THERE ARE NO SERVICEABLE PARTS INSIDE.
- TO REDUCE RISK OF FIRE OR ELECTRIC SHOCK, DO NOT EXPOSE THE MASSAGE CHAIR TO RAIN OR MOISTURE.



This symbol indicates the presence of uninsulated “dangerous voltage” within the massage chair’s enclosure that may be of sufficient magnitude to constitute a risk of electric shock.



This symbol indicates the presence of important operating and maintenance instructions in the literature accompanying the massage chair.

This massage chair is intended for household use only.

When using an electrical appliance, basic precautions should always be followed.

Read all instructions before using this massage chair.

⚠ DANGER - To reduce the risk of electric shock:

1. Always unplug this massage chair from the electrical outlet immediately after using and before cleaning.
2. If liquid is accidentally spilled onto the chair, remove the power plug from the electrical outlet immediately. Do not use wet hands to connect or disconnect the power plug from the electrical outlet.
3. Do not operate during a lightning storm.
4. Although operation will be stopped automatically by the Auto Timer function, always remember to turn off the main power switch after use.
5. Do not place the power cord under the chair or under any other heavy objects.
6. Do not wind the power cord around the chair as this may damage the cord and result in a fire or electric shock.
7. Do not operate the chair with a damaged cord or with an extension cord.
8. Do not use the chair if the electrical outlet is loose.

Model	M888 Kokoro Massage Chair
Dimension of Main Body (in)	63 x 34 x 51 (L x W X H)
Necessary Clearance to Wall (in)	4
Net Weight (lbs)	318
Shipping Weight (lbs)	384
Max. User Weight (lbs)	300
Voltage	120V 60Hz
Fuse	3.15 AMP
Power Consumption	230W
Safety Standards	Type 1

If you encounter problems while operating your Kyota M888 Kokoro massage chair, try the suggestions below. If the issue(s) persist, flip the main power switch on the back of the chair to the Off position and remove the power plug from the outlet. Contact Infinity's technical support team at 800-242-0761 for service.

Do not disassemble or attempt to repair the massage chair yourself. Doing so will void the warranty and Kyota will not bear any responsibility for any subsequent consequences.

Problem	Possible Cause/Solution
The massage chair is connected to a power source, but is not functioning.	<ul style="list-style-type: none"> • Check that the main power switch on the back of the chair is in the On position. • Check that the power plug is inserted properly and the power outlet is functioning properly. • Press the Power button on the remote. • Check the fuse next to the main switch in the back of the chair.
Sounds are coming from the massage mechanism.	It is normal for the motors to make noise while operating or rubbing against the backrest area.
No sound is coming from the speakers.	Ensure the volume on your device is turned up and the Bluetooth pairing was successful.
Backrest or legrest will not extend or retract.	There may be too much pressure placed on the backrest or legrest. Reduce the weight or pressure on the backrest or legrest.
The seat or legrest airbag is not working.	Check to see if there is an air tube blockage or if an air tube is pinched. If so, clear the air tube or straighten it out.

⚠ WARNING - To reduce the risk of burns, fire, electric shock, or injury:

1. This massage chair should never be left unattended when plugged in. Unplug from outlet when not in use, and before putting on or taking off parts.
2. Do not operate under blanket or pillow. Excessive heating can occur and cause fire, electric shock, or other injury.
3. Close supervision is necessary when this chair is used by or near children, pets, or disabled individuals. Keep children and pets away from extended foot support.
4. Use this massage chair only for its intended use as described in this manual. Do not use attachments not recommended by Infinity.
5. Never operate this massage chair if it has a damaged cord or plug, if it is not working properly, if it has been dropped or damaged, or if it has been damaged by water. Contact Kyota's technical support team at 800-242-0761 for assistance.
6. Do not move or carry this massage chair by the power cord, or use the cord as a handle.
7. Keep the cord away from heated surfaces.
8. Never operate the massage chair with the air openings blocked. Keep the air openings free of lint, hair, and other debris.
9. Never drop or insert any object into any opening.
10. Do not use outdoors.
11. Do not operate where aerosol (spray) products are being used, or where oxygen is being administered.
12. To disconnect, turn all controls to the OFF position, then remove the plug from the outlet.
13. Use heated surfaces carefully. May cause serious burns. Do not use over sensitive areas or on areas with poor circulation. The unattended use of heat by children or disabled individuals may be dangerous.
14. Never use pins or other metallic fasteners with this chair.
15. Never remove the cover from this chair. Do not use the chair when the upholstery is ripped, torn, or removed. This may cause injury or malfunction. Carefully examine the covering before each use. Call Kyota's technical support team if the covering shows any sign of deterioration, such as blistering, peeling, cracking, or ripping.
16. Keep dry. Do not operate the massage chair in a wet or moist environment. Do not use the chair when your body is wet, or operate with wet hands.
17. Do not use the massage chair while wearing excessively loose clothing or jewelry.
18. Keep long hair away from massage chair openings and moving parts during use.
19. Do not insert your hand or foot along the path of the massage rollers during use.
20. Any individual who is pregnant; uses a pacemaker; suffers from diabetes, phlebitis, and/or thrombosis; is at an increased risk of developing blood clots due to recent surgery; or is being treated or has been diagnosed with any other medical condition or physical injury should consult a physician before using this massage chair.
21. This massage chair is designed as a non-professional solution to help soothe tired, aching muscles. It is not intended for self-treatment of conditions that should be managed by a qualified healthcare provider. If your ailments and symptoms persist or worsen after use, contact your doctor immediately.

22. Do not use this chair if you are not feeling well.
23. Stop operation immediately if you experience any discomfort.
24. Do not fall asleep during the massage session.
25. Do not operate after consuming pain killers, sedatives, or alcohol.
26. Do not use this chair in combination with other therapeutic equipment or items such as an electric blanket, as this may result in ineffectiveness or injury.
27. Do not stand on or in this massage chair. Use only while seated.
28. Do not disassemble any part of the chair. Touching the internal components may result in malfunction or electric shock. Instead, contact Infinity's technical support team immediately for professional assistance.
29. Always position the massage chair on a flat, level surface.
30. Do not operate for more than 30 consecutive minutes. Turn off the chair and allow it to rest for 30 minutes before using again. This will prolong the life of the chair.
31. Do not perform continuous massage on the same spot of your body for more than 5 minutes at a time, as this may result in excessive stimulation and may have adverse effects.
32. Never use the chair on open skin wounds or swollen, inflamed areas.
33. Do not apply massage rollers directly on the head, elbow or knee joints, torso, or abdomen.
34. If the power goes off during use, be sure to turn the power switch to the OFF position and pull the power plug out from the outlet to prevent damage from occurring when the power is restored.

SAVE THESE INSTRUCTIONS

Grounding Instructions

This product must be grounded. If it should malfunction or break down, grounding provides a path of least resistance for the electric current to reduce the risk of electric shock.

This product is equipped with a cord with an equipment-grounding conductor and a grounding plug. The plug must be plugged into an appropriate outlet that is properly installed and grounded in accordance with all local codes and ordinances.

DANGER: Improper connection of the equipment-grounding conductor can result in a risk of electric shock.

Check with a qualified electrician or serviceperson if you are in doubt as to whether the product is properly grounded. Do not modify the plug provided with the product. If it does not fit the outlet, have a proper outlet installed by a qualified electrician.

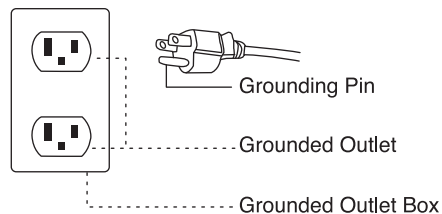

Storing the Massage Chair

- Disconnect the massage chair from the power source after use.
- Do not expose the massage chair to direct sunlight, high temperature, or high humidity. This could cause fading or other damage to the upholstery.
- Do not put heavy objects on the massage chair.
- If the outer cover is torn or the mechanism is damaged, stop using the chair and contact Infinity for assistance.

Cleaning the Massage Chair

Follow the steps below to clean your massage chair:

- Remove the main plug from the outlet.
- Clean the synthetic leather, controller, cords with a dry cloth.
- If necessary, you can dampen a soft cloth with a neutral cleaning solution or water to clean the synthetic leather. Lysol wipes are another safe and easy way to clean this material. Then, wipe it with a dry cloth and let air dry.
- Any cloth material of the chair (e.g., the inside of the arm airbags or calf airbags) can be spot cleaned with a soft cloth dampened with a weak neutral detergent and gently clean where necessary. Avoid cleaning the fabric too often so as to avoid wear and tear.
- To clean any plastic parts of the chair (e.g., the base), use a soft cloth lightly soaked in a neutral detergent. Then, wipe again with a water-dampened cloth. Finally, wipe it with a clean, dry cloth.

Caution

- Do not immerse the chair in water.
- Never use scouring pads, abrasive cleaning agents (e.g., benzene or thinner), or harsh chemicals such as petroleum or acetone to clean the chair. Additionally, never use heat to dry the chair after cleaning. These items may cause fading or other damage to the upholstery.
- Any additional servicing should be performed by an authorized service representative. This chair has no user serviceable parts inside.

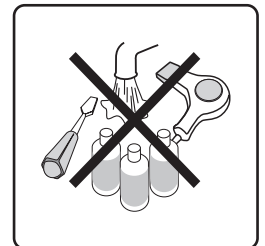

Voice Operation

To use the Overture’s speech recognition feature, first use the command, “Turn on speech recognition mode.” It will then be able to identify the rest of your commands. You will be able to hear the corresponding speaker voice feedback after the chair successfully recognizes your command. The corresponding responses are as follows:

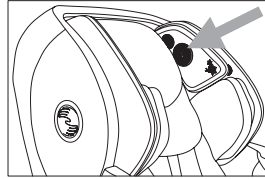

COMMANDS	RESPONSES
Turn on speech recognition mode	Speech recognition has been activated
Voice off	Voice recognition mode is off
Massage chair shut down	Massage chair is powering off
Health massage	Health massage has been activated
Pain relief	Pain relief massage has been activated
Body stretch	Body stretch massage has been activated
Zero gravity start	Zero gravity position
Experience	Experience massage has been activated
Relaxation	Relaxation massage has been activated

How to Use Voice Operation:

1. Say, “Turn on speech recognition mode.” If you say “Voice Off” and “Massage chair shutdown,” the massage chair will shut down by default. To restart, say “Turn on speech recognition mode” again.
2. When your voice command is recognized, the speaker will respond after 1 second. You can then say your next command entry.
3. After turning on speech recognition mode, the chair will remain in this mode for 3 minutes. If you say nothing after 3 minutes, it will shut off speech recognition mode and you will need to say “Turn on speech recognition mode” again.
4. Use standard language and speak slowly and clearly.

FCC Statement

1. This device complies with Part 15 of the FCC Rules. Operation is subject to the following two conditions:
 - (1) This device may not cause harmful interference, and
 - (2) This device must accept any interference received, including interference that may cause undesired operation.
2. Changes or modifications not expressly approved by the party responsible for compliance could void the user’s authority to operate the equipment.

This equipment has been tested and found to comply with the limits for a Class B digital device, pursuant to part 15 of the FCC Rules.

These limits are designed to provide reasonable protection against harmful interference in a residential installation. This equipment generates, uses and can radiate radio frequency energy and, if not installed and used in accordance with the instructions, may cause harmful interference to radio communications. However, there is no guarantee that interference will not occur in a particular installation.

If this equipment does cause harmful interference to radio or television reception, which can be determined by turning the equipment off and on, the user is encouraged to try to correct the interference by one or more of the following measures:

- Reorient or relocate the receiving antenna.
- Increase the separation between the equipment and receiver.
- Connect the equipment into an outlet on a circuit different from that to which the receiver is connected.
- Consult the dealer or an experienced radio/TV technician for help.

FCC Radiation Exposure Statement:

This equipment complies with FCC radiation exposure limits set forth for an uncontrolled environment. In order to avoid the possibility of exceeding the FCC radio frequency exposure limits, human proximity to the antenna shall not be less than 20cm (8 inches) during normal operation.

External Structure

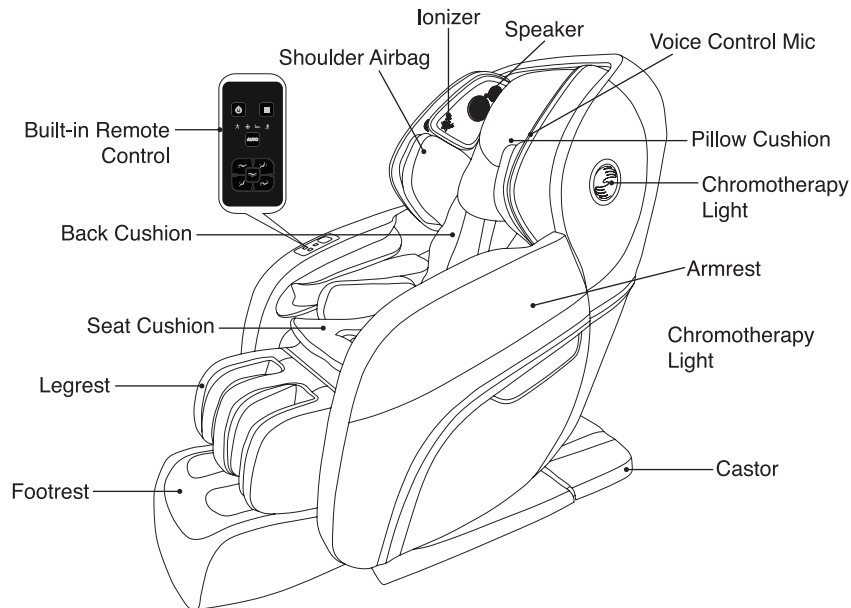

Wireless Remote

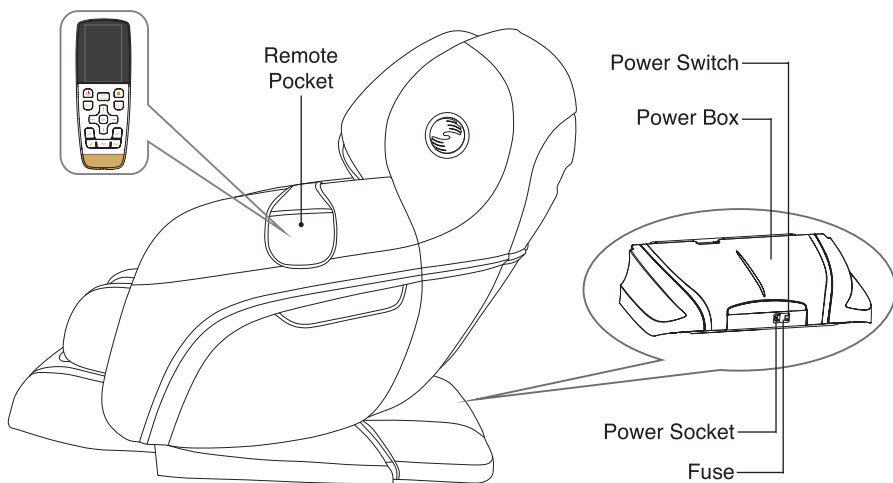

Wireless Remote Display

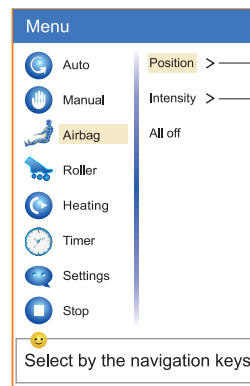

Airbag Massage: After pressing MENU key, navigate to Airbag, then press OK. You can adjust both the position and intensity, or turn off all air massage. Simply choose the desired function, press OK, then choose your preference from the corresponding menu.

Foot Roller: Press MENU and navigate to Roller. Choose from Quick, Soft, or Stop foot roller settings.

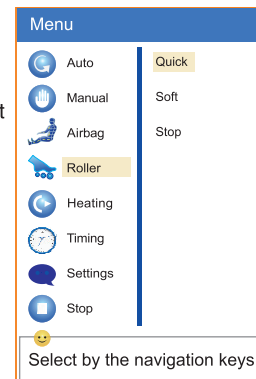

Heating: Press MENU, navigate to Heating, press OK, and select which heating functions you'd like to turn on or off. Options include: Back On, Waist On, Foot On, Temp+, and Temp-.

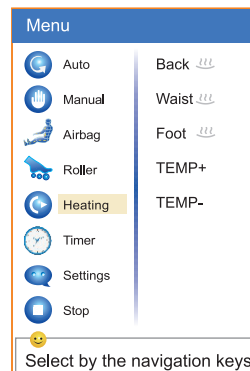

Timer: Press MENU, navigate to Timing, and choose the length of your massage. Options include 10 minutes, 20 minutes, or 30 minutes. The default time is 20 minutes. The massage chair will turn off automatically and reset after the time is up.

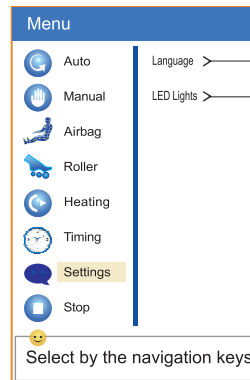
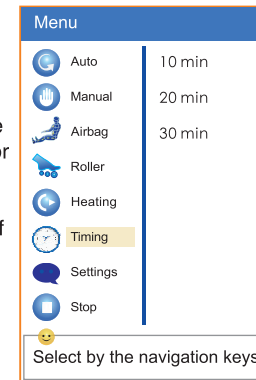

Settings: Press MENU and navigate to Settings. Here, you can choose your language and turn the LED lights on or off.

Stop: Press MENU and select Stop to stop the current massage and return to the main interface.



When you begin a new auto program, the massage chair will begin the body scan and "Body scanning..." will display on the screen. After the body scan is finished, the chair will beep 5 times (once per second). During these 5 seconds, the rollers are in the shoulder position and you are able to press Up or Down to adjust. While adjusting, "Shoulder height adjusting..." will display on the screen.

Wireless Remote Display

Main Interface



After switching on the chair, press the ON/OFF button and you will hear a short beep. The LCD screen will load and after about 2 to 3 seconds, it will display the main interface and enter standby mode. The main interface displays the massage position, method, time, current massage status, etc. All of this information will adjust once you start a massage.

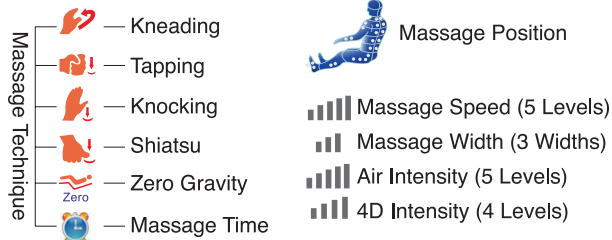

- Lumbar Heat Temperature
- Heat On Indicator
- Armrest LED Light Status
- Air Ionizer Indicator
- Calf Massage Function Display

Menu Interface

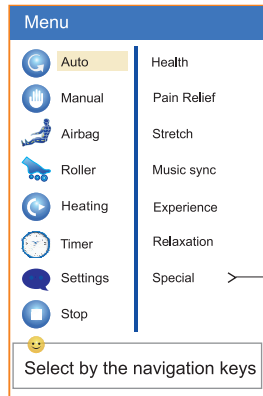

Press the Menu button when in the main interface to switch to the menu interface. Here, you can select all your massage functions and settings. Press the Menu button again to return to the main interface.

Auto Mode: Press Menu and select from Health, Pain Relief, Stretch, Music Sync, Experience, and Relaxation. You can also select Special to view six additional programs: Neck & Shoulder, Waist & Spine, Back Rehab, Active, Relax, and Healing. (4D Intensity is not adjustable and will not show when in Auto Mode.)

Manual Mode: Press Menu, select manual massage using the navigation key. Here, you can adjust: Mode, Position, Width, Speed, 4D, and Footrest. Choose the corresponding function, then press OK to enter the next menu. Massage techniques include Kneading, Tapping, Knocking, Knead & Tap, and Shiatsu. Massage position lets you set the rollers at Whole, Partial (smaller area), or Point (precise spot).

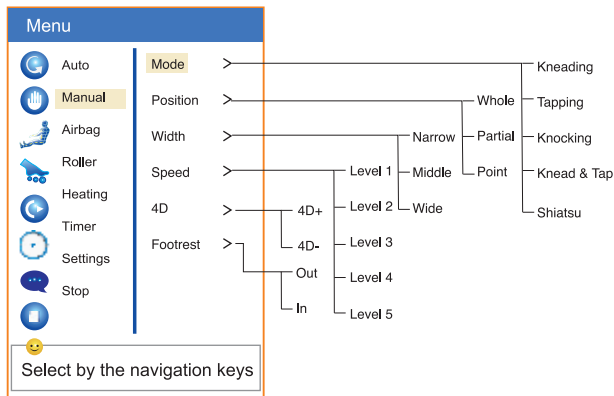

Internal Structure

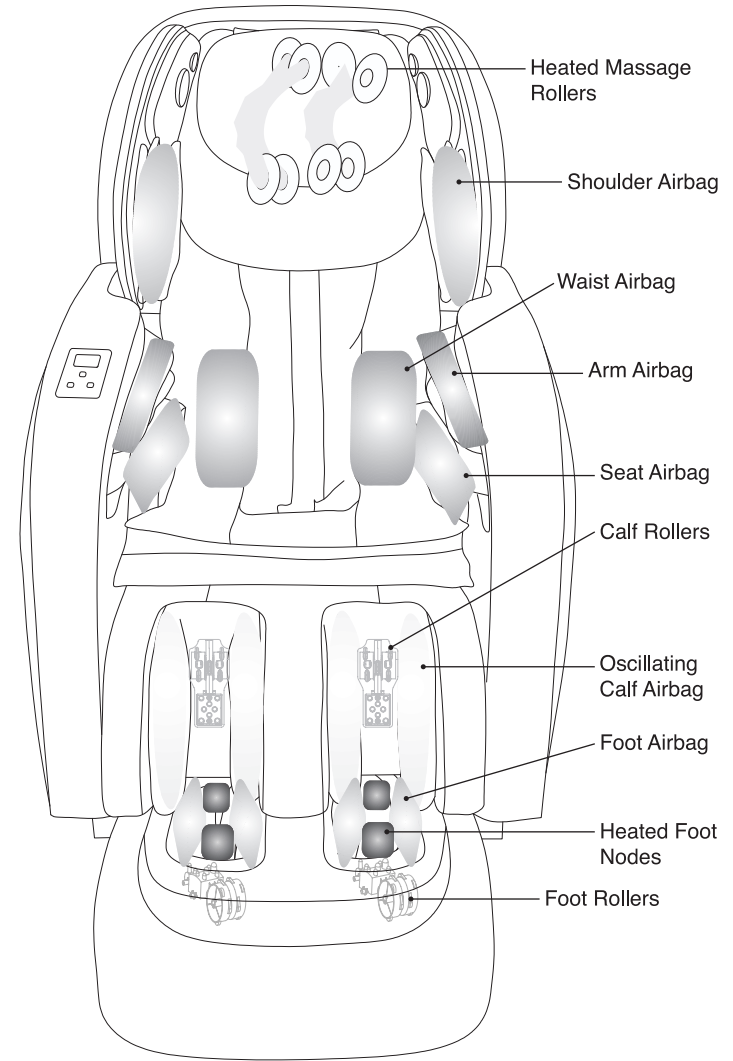

Watch the Assembly Video:

<https://kyotamassagechairs.com/assembly-tutorials/M888>

Unpack the Massage Chair & Accessories

1. Remove the accessories boxes, chair body, backrest pad, pillow, power cord, remote control, and remote control pocket from the box.
2. Confirm all the necessary accessories are present.

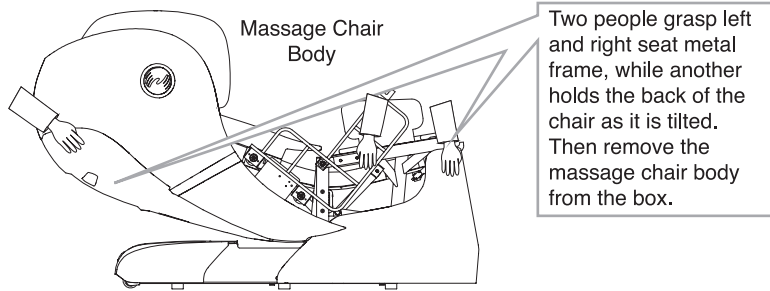

Accessories

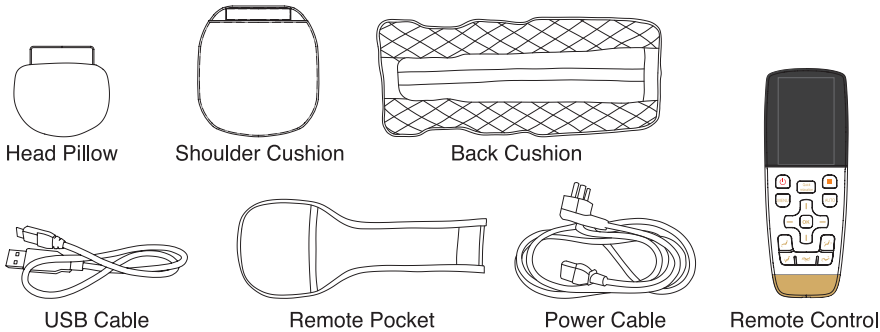

3. Take out the left and right armrest from the armrest box. Lay them flat on a table or floor, being careful not to scratch either armrest.

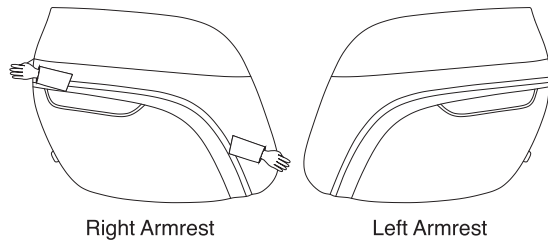

4. Remove the legrest from the legrest box by gripping the front and back sides and carefully sliding it out.

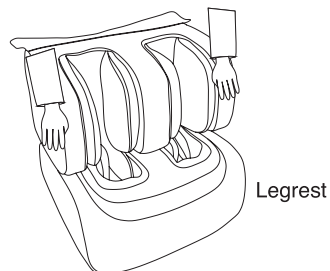

Wireless Remote



After switching the massage chair on, press ON/OFF for at least 1 second to fully turn on the chair. Then select from the AUTO programs or use the manual menu to set a custom massage. Press ON/OFF again for 1 second to turn off the chair, which will then reset to its upright position. The remote will power off after about 3 to 5 seconds.



Press to enter Quick Relaxation mode. The massage status will display on the remote screen. Default working time for this program is 8 minutes.



Press during operation to stop all massage chair functions immediately. All buttons will become invalid upon pressing the emergency stop button. Press ON/OFF to reactivate the remote and restart your massage.



Use this button when in the main interface to switch to the menu interface. Here, you can select different functions and settings for your massage. Press MENU again to return to the main interface.



Press to select from six Special massage programs: Neck & Shoulder, Waist & Spine, Back Rehab, Active, Relax, and Healing. Your massage status will display at top of screen.

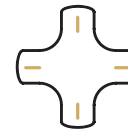

The direction button allows you to navigate up, down, left, and right. When in the Menu, use this to select menu items. In Manual mode, press up and down to adjust the position of the massage rollers during the shoulder height detection at the beginning of your massage and before a fixed point massage.



When in the Menu, use the OK button to confirm menu choices and enter the next menu. When on the main interface, press this button to turn on the air ionizer; press again to turn the ionizer off.



Hold down to raise the legrest; release to stop. Controller screen will show "Position adjusting..." while adjusting the legrest.



Hold down to lift the backrest and lower the legrest; release to stop. Controller screen will show "Position adjusting..." while adjusting the massage chair.



Hold down to lower the legrest; release to stop. Controller screen will show "Position adjusting..." while adjusting the legrest.



Hold this key to recline the backrest and raise the legrest; release to stop. Controller screen will show "Position adjusting..." while adjusting the chair.



When the chair is ON, press this key once to set the chair at level 1 zero gravity; press again to reach level 2 zero gravity; and press a third time to reach sleeping mode. Press the key a fourth time to reset the chair to the upright position.

Wireless Remote

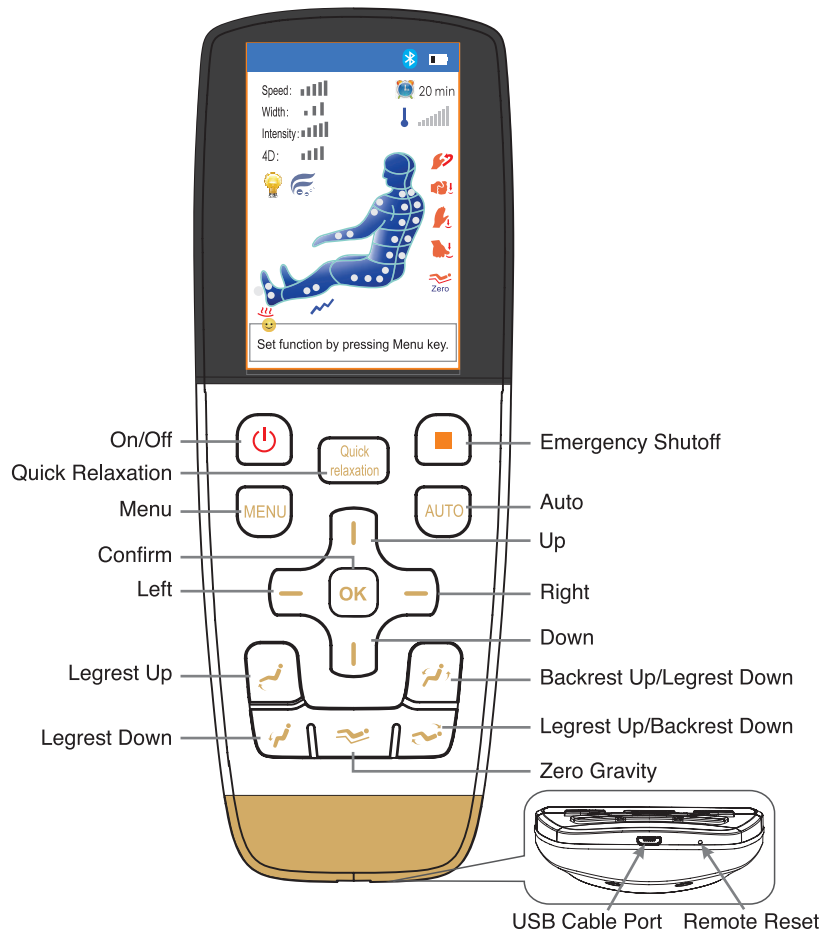

Connecting the Wireless Remote to Bluetooth

1. Turn on the massage chair. Hold the MENU and OK buttons at the same time for 4 seconds, and the screen should indicate the Bluetooth pairing has begun.
2. The Bluetooth icon will light up if the connection is successful.
3. After pairing successfully, turn the controller off and on again. Your wireless remote is now ready to use to operate your massage chair.
4. The remote will remain paired with your chair for future use.

Please note: Your wireless remote should be charged upon receipt of your chair. If it won't turn on or has low battery, simply charge it with the provided USB cable.

Controller Reset

If the remote disconnects or experiences pairing issues, use a pin or similar sharp object to press the reset button.

Assemble the Legrest

1. Unscrew the bolt from legrest hanger.
 2. Connect the legrest's airhose to the corresponding air nozzles of the chair body.
 3. Connect power line to the power socket tightly.
 4. Raise the rotation shaft board on hangers, lift the legrest, put rotation shaft into hangers on chair body, and lower rotation shaft board down.
 5. Close the axis cover and screw on the bolt tightly.
 6. Connect the leather of the legrest to the seat by securing the Velcro pieces.
- CAUTION:** Make sure the air tube and wires are not tangled.

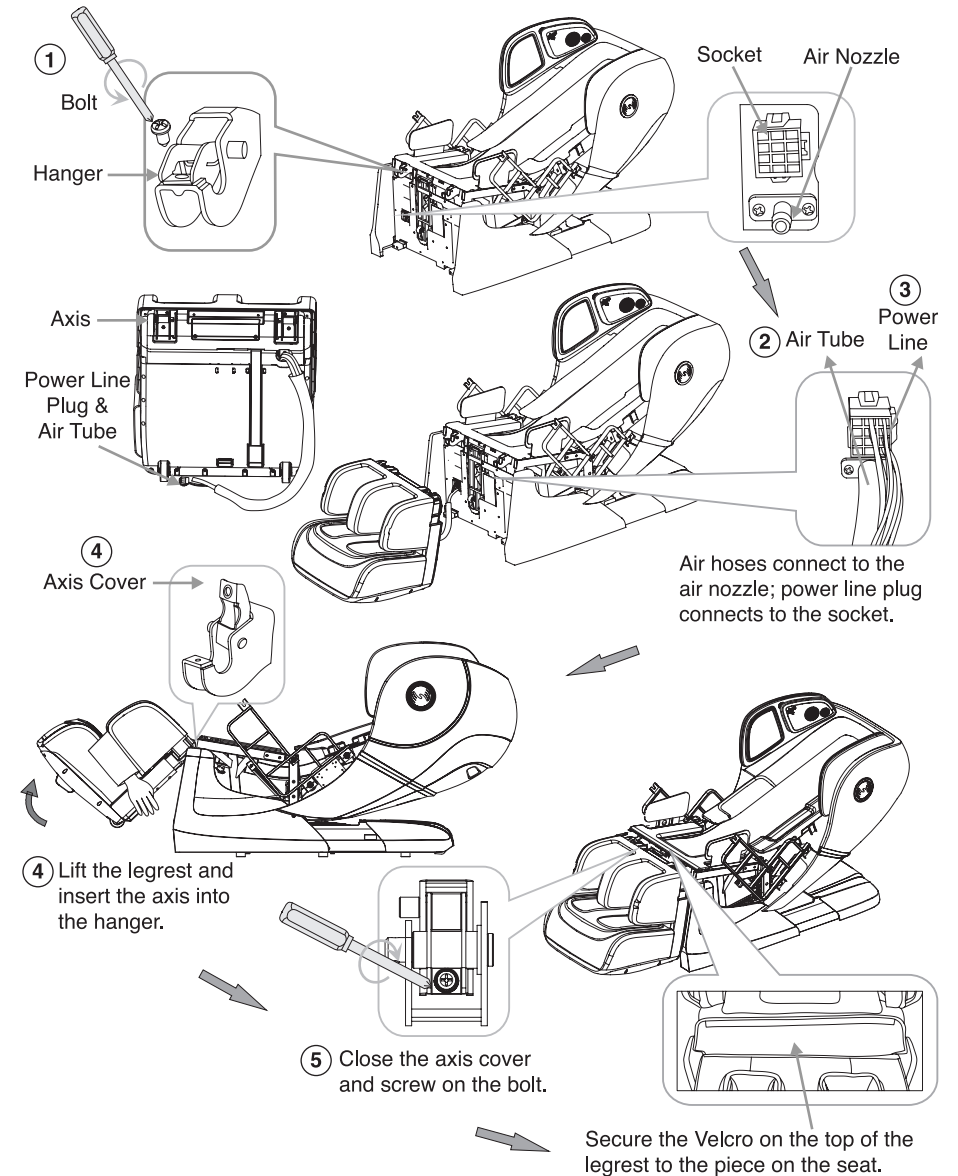

Assemble the Armrests

1. Recline the chair to expose the fixed hole on the chair body. Lift the armrest and plug it into the rotating stand on the side of the chair body.
2. Plug the power plug into the socket.
3. Connect the air hose of the armrest to the air tubes on the seat tightly. The black air tube should be connected to the air hose marked as "1" and the grey air tube should be connected to the air hose marked as "2".
4. Insert the rear armrest fixed plate into the fixing hole on the chair body.
5. Remove the rubber plug from the armrest, tighten the screws inside the hole, then put the rubber plug back on snugly.

CAUTION:

- Do not squeeze the air tubes during installation, as this may cause an air leakage or prevent the airbags from inflating.
- Ensure that the fixed plate and LED light wire are plugged in securely, otherwise the armrest may fall or the LED light will not work.

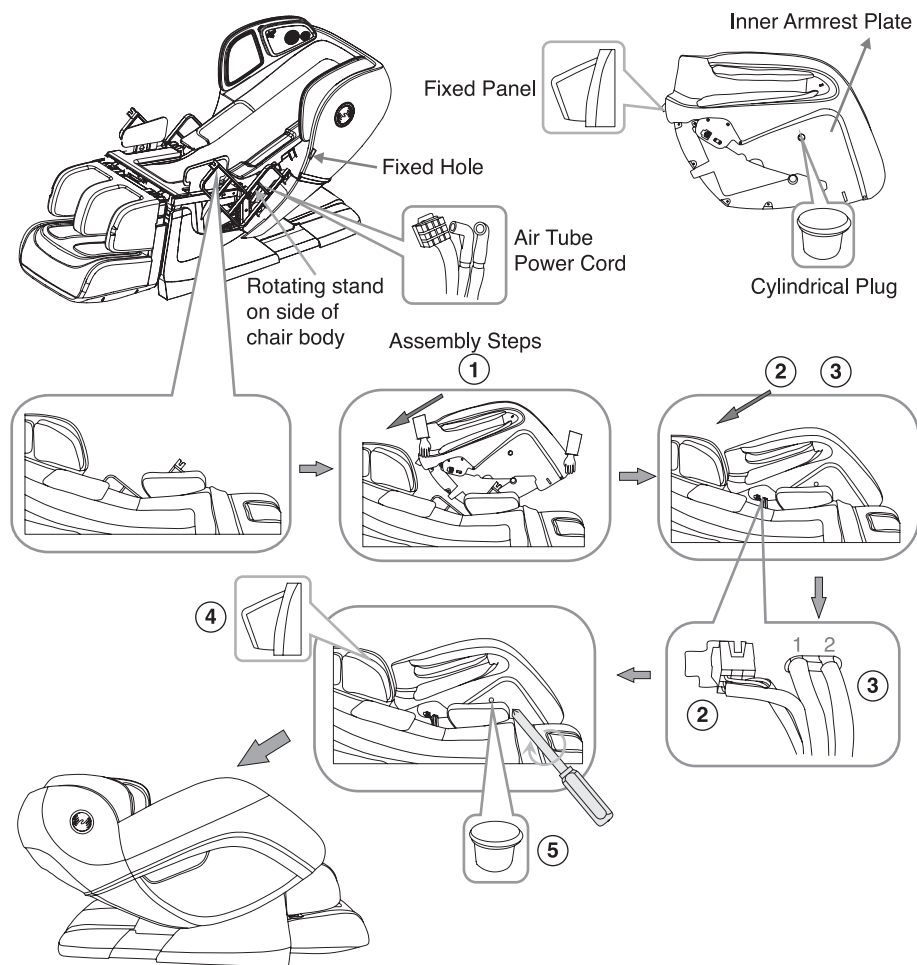

Built-in Remote



In standby mode, press ON/OFF to power on the chair. Choose a program through the menu on the wireless remote, or quickly select one by pressing AUTO on the built-in remote. Press ON/OFF again to turn off the massage chair, which will then reset to its upright position.



Press this key to stop all massage functions immediately. To start the massage again, you will need to press the ON/OFF key.



Press AUTO to toggle between four auto programs. The icon of each program will light up when selected.



Quick Demo: Demonstrates basic functions of the chair. Default working time is 8 mins.



Health Program: Default working time is 20 mins.



Stretch Program: Default working time is 20 mins



Rhythm Massage: Default working time is 20 mins.



Hold down to raise the legrest; release to stop. Please note: Legrest cannot be raised during "Stretch" program.



Hold down to lift the backrest and lower the legrest; release to stop. Please note: This function is not available during "Stretch" program.



Hold to lower the legrest; release to stop. Please note: Legrest cannot be lowered during "Stretch" program.



Hold to recline the backrest and raise the legrest; release to stop. Please note: This function is not available during "Stretch" program.



Press the ZERO GRAVITY button once to set the chair at level 1 zero gravity; press again to reach level 2 zero gravity; and press a third time to reach sleeping mode. Press the key a fourth time to reset the chair to the upright position.

Built-in Remote

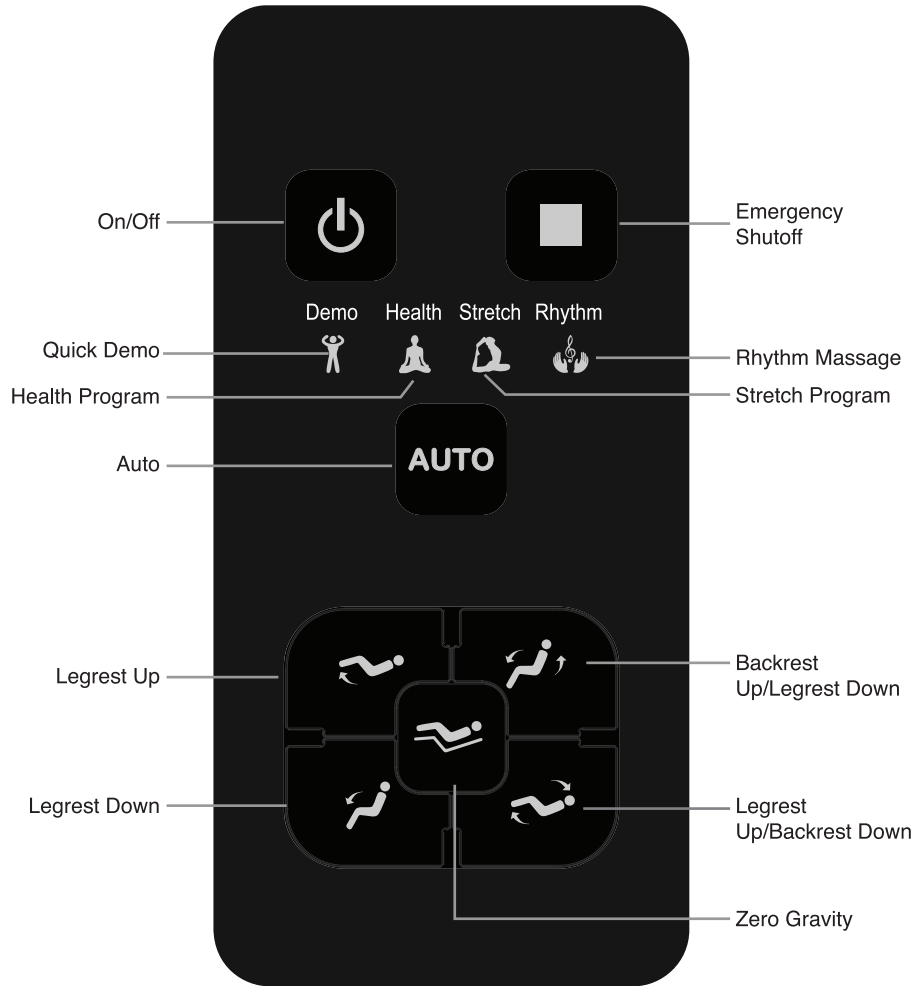

Install the Cushions & Remote Pocket

Put the back cushion, shoulder cushion, and head pillow onto the headrest, then connect them with the zipper and Velcro.

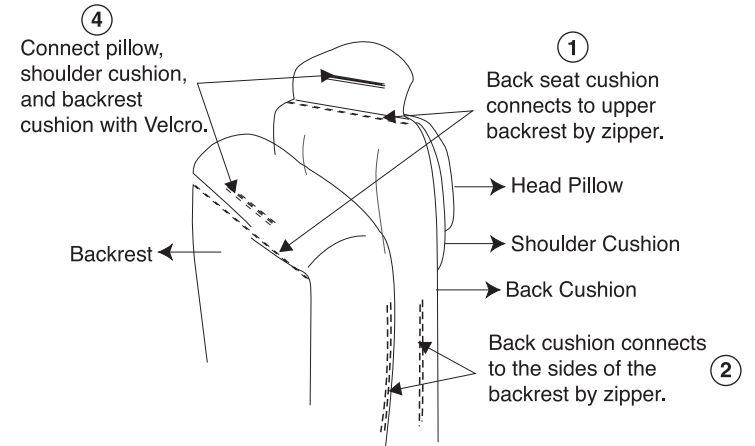
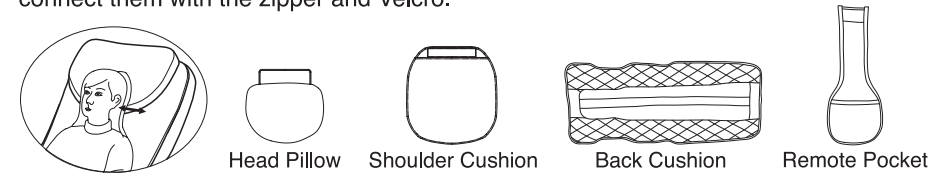

If you feel the massage isn't strong enough, you can choose to remove the pillow and shoulder cushion.

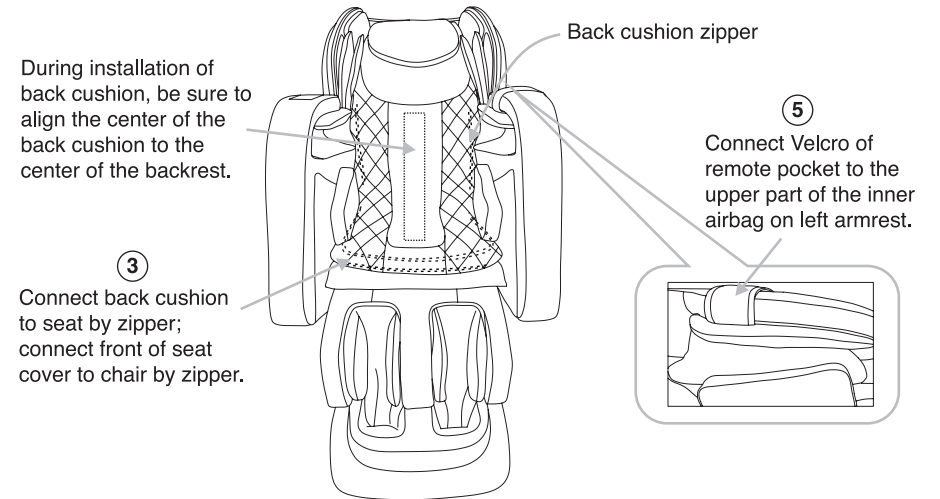

Installation & Placement Instructions

Restore the Chair

1. Plug the power cord into the hole on the power box as shown in the right picture.
2. Insert the plug of the power cord into the outlet.
3. Turn on the switch behind the power box. Switch on/off "O/I". (Press "I" down to turn if on.)
4. Switch off, chair resets to upright state.
5. Use the convenient controller built into the armrest or the wireless remote to select your massage function.
6. When the chair is ON, the USB port can be used for charging your mobile device. You can also charge the chair's wireless remote here by using the USB cable that accompanies it.



Make sure the switch is OFF before plugging in the chair.

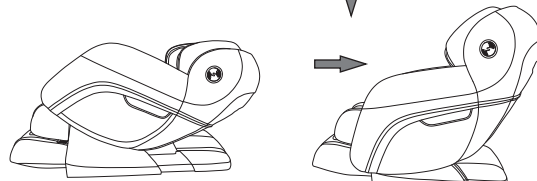
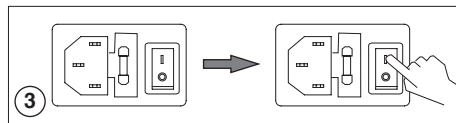
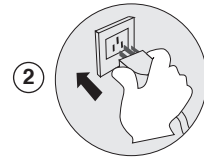
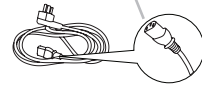
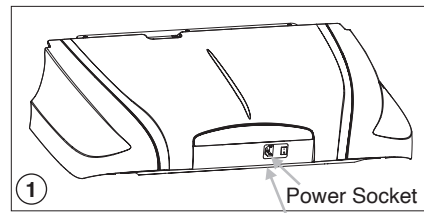

4 Chair in the original upright position

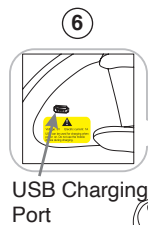

USB Charging Port

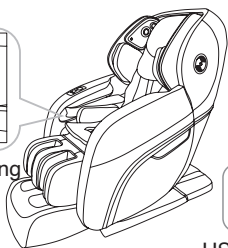

USB Cable Port



Wireless Remote

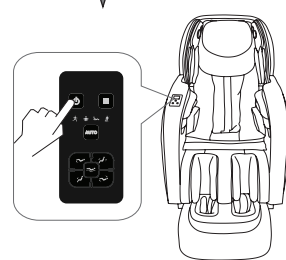

Installation & Placement Instructions

Moving the Massage Chair

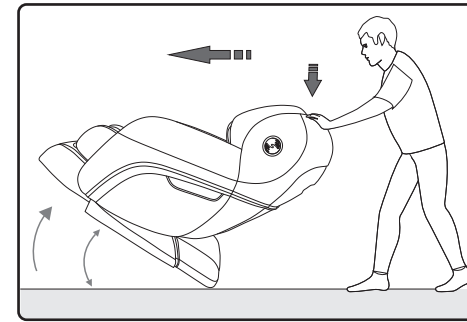

- As illustrated, push the backrest downwards and tilt the chair onto its wheels at a 40° angle. Slowly push and maneuver the massage chair to the desired location. Lower the chair slowly until it is fully flat on the floor.

Caution:

- Do not move the massage chair when occupied or in use.
- Moving the massage chair may damage floors. We recommend moving

the chair on rugs or carpeted floors.

- Do not drop or suddenly let go of the chair when moving it, as this may damage the chair or the floor.
- We advise two people move the massage chair together.

Chair Placement

- When placing your massage chair, be sure to leave at least 4 in. of clearance between the back of the chair and any wall or other objects to allow it to recline safely.
- When using the massage chair, ensure there are no people, pets, or objects within 20 in. of the front of the chair to allow the footrest to extend safely.
- Place the massage chair on a carpet or other padded surface in order to avoid scratching or damaging the floor.

Caution:

- Keep the distance between the power socket and power switch within 5 feet.
- To avoid damage or injury, do not place the massage chair on a wet or uneven floor.

