

In-Use Screen

After a Massage program is selected, In-use screen displays all settings to that program.

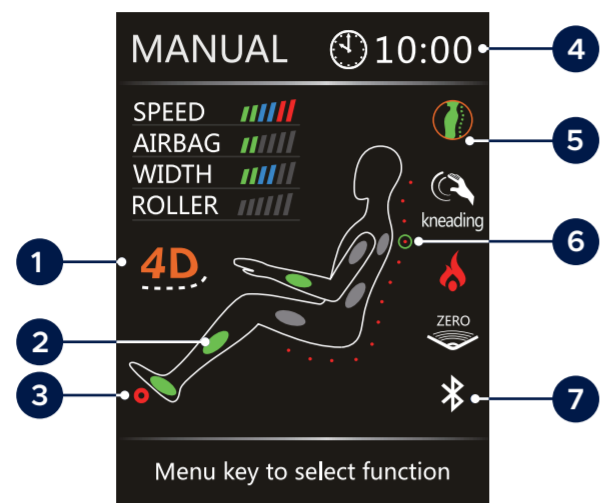

- 1 4D intensity level
- 2 Active airbags
- 3 Active rollers
- 4 Time left
- 5 Indicators
- 6 Back-roller position & direction
- 7 Bluetooth connected

Sounds

From the **HOME** screen, select the **SOUNDS** menu. Toggle the following settings to play Nature sounds from your chair.

Sound: Select from Nature sounds.

Volume: Set volume level.

BEEP: Set to OFF to stop sounds from remote control.

To play Nature sounds, Bluetooth must be **ON** prior to selection.

MyMassage Memory

Your chair has the ability to save your favorite customized massage programs to memory. To do this, **create a manual massage program** (see page 18 of User Manual for instructions) with all of your desired air, heat, speed, and intensity settings.

Storing a memory program:

After creating your custom massage in manual mode, select **AUTO** from the Home display and scroll to the bottom of the page. Here you will see **MyMassage 1** and **MyMassage 2**. Press **OK** button to select either 1 or 2 then select "**Save**". If you save over the top of an existing memory program, the existing program will be erased and replaced by the most recent save.

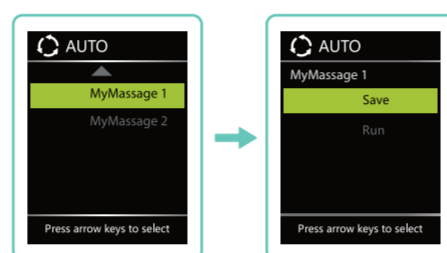

Loading a memory program

Select **AUTO** from Home display and scroll to the bottom of the page. Select **MyMassage 1** or **MyMassage 2** and then select "**Run**". The chair will now run the program you created.

Share a photo and tag us:

[@infinity_chairs](https://twitter.com/infinity_chairs)

[@infinitymassagechairs](https://www.instagram.com/infinitymassagechairs)

[@infinitymassagechairs](https://www.facebook.com/infinitymassagechairs)

Don't forget to use **#infinitymassagechairs**

INFINITY®

72 Stard Road, Seabrook, NH 03874 | 603-910-5000
www.infinitymassagechairs.com

Version 2.1

INFINITY®

Quick Start Guide

Palisade 4D Massage Chair

INFINITY®

Multi-Functional Screen

Use the directional buttons below to navigate these menu screens. Then press OK to select.

On/Off – Powers up the remote or returns the chair to the exit position and powers down remote.

Menu – Shortcut to the home page of all menu screens.

Feet Adjust – Press and hold up arrow to bring foot rest up, press and hold down arrow to bring foot rest down.

4D – Press to increase or decrease 4D intensity of back mechanism. In-use screen displays intensity dial.

Feet Extend – Press and hold to extend the leg length adjustment.

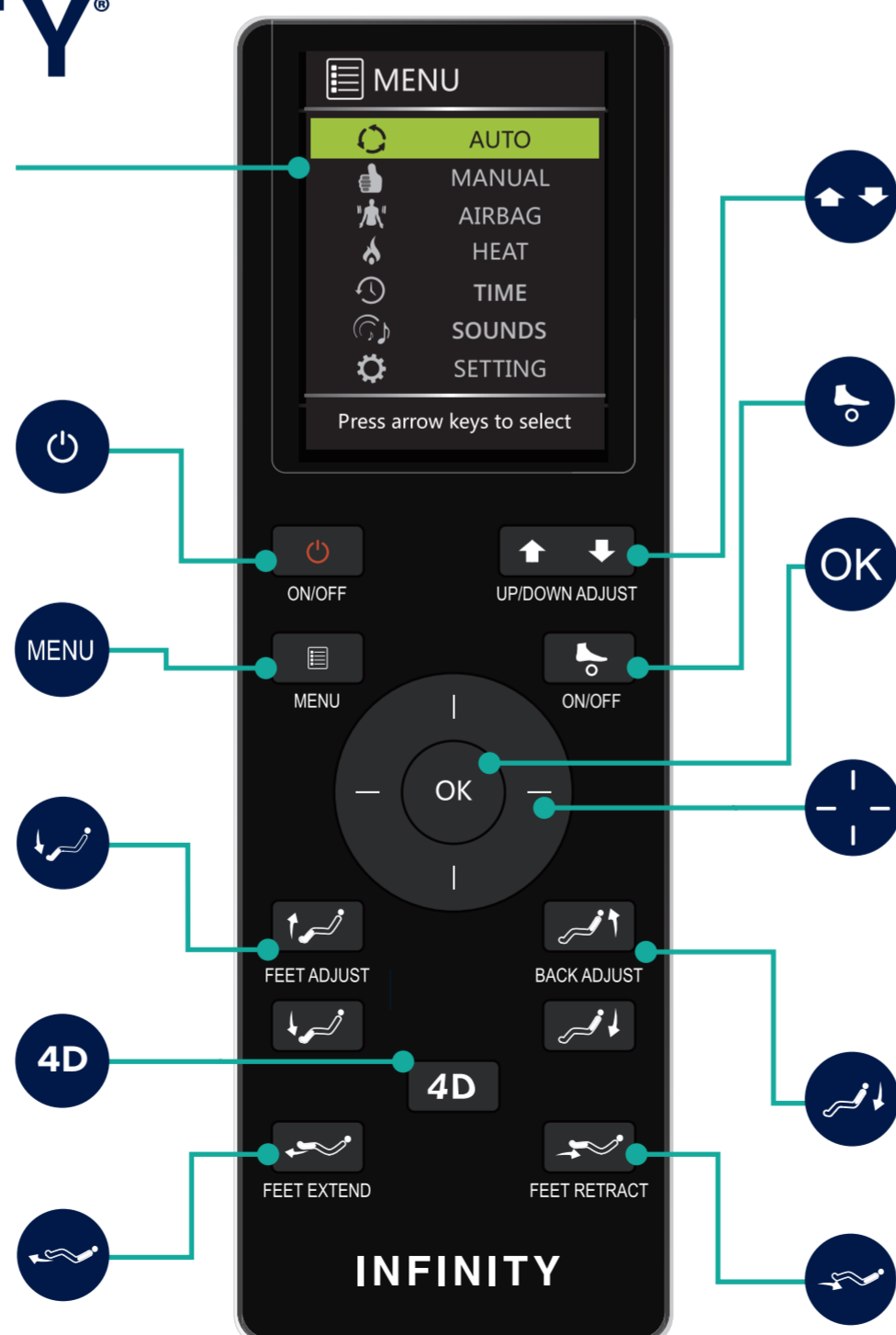

Back Adjustment – Back mechanism position adjustment; press and hold up to raise, press and hold down to lower. Use during initial body scan fine tuning or in manual point zone mode.

Foot Roller – Press this button to toggle the foot rollers on or off.

OK – After navigating to the command desired on the display, push OK to select.

During the massage, press OK button to switch to zero gravity.

Directional Button – Press up, down, left or right to navigate the display screen.

During the massage, press up or down buttons to adjust mechanism speed. Press left or right button to adjust airbag intensity.

Seat Back Position – Press and hold down arrow to recline the seat back, press and hold the up arrow to upright the seat back.

Feet Retract – Press and hold to retract the leg length adjustment.