

Step 1: Prior to assembly, carefully unpack all box contents. Check box contents to the detail below. Make sure all contents are accounted for. If anything is missing, please contact INFINITY at 603-910-5000. Do not return to the place of purchase.

Before assembling your chair, watch an assembly video at: www.infinitymassagechairs.com/assembly-tutorials
Alternatively, scan the QR code to go directly to the URL above.

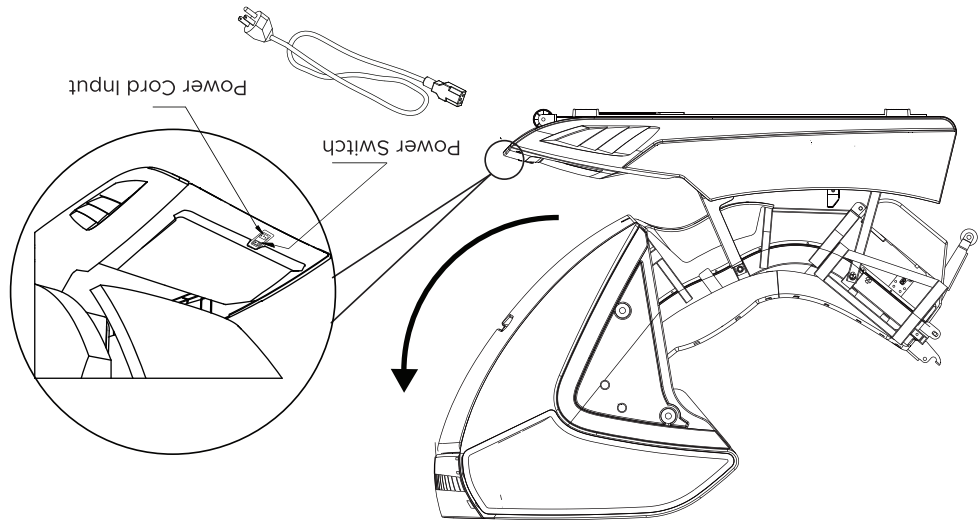

Step 3: Connect the chair power cord to a grounded 120V electrical outlet and plug it into the respective port on the back side of the base of the chair. Turn the Power Switch to 'ON'. Your chair will now reset and move to its upright position.

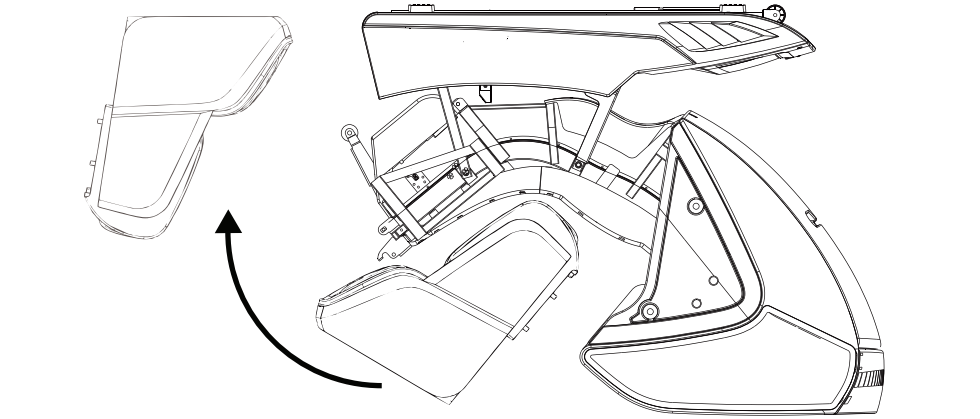

Step 2: Gently place the footrest to the floor, move it aside for now.

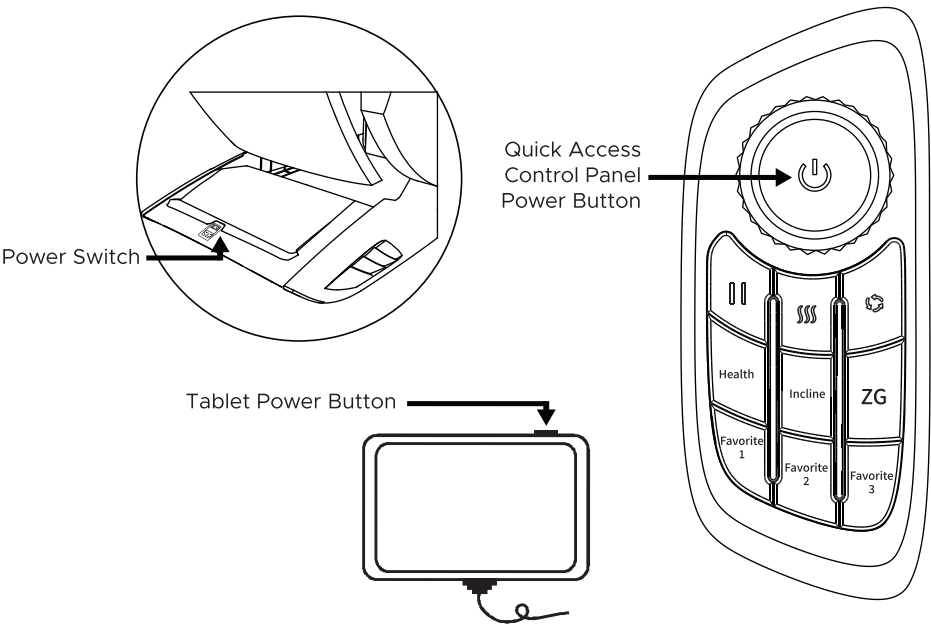

Step 12: Flip the main power switch on the chair back to on. Turn on the chair either by pressing the tablet's power button on the top right side, or the quick access control panel's power button.

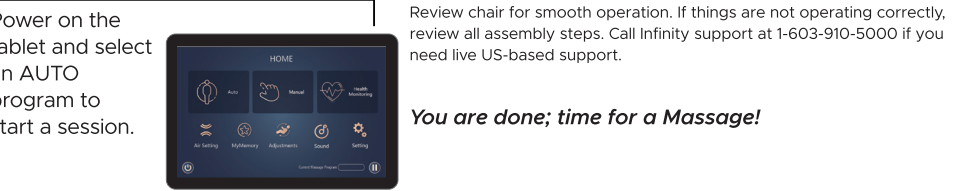

Register your product at www.infinitymassagechairs.com/warranty to ensure it is in our system. This will simplify the warranty process should you ever need it.

Alternatively, scan the QR code to go directly to the URL above.

INFINITY

72 Stard Road, Seabrook, NH 03874 (603) 910-5000 www.infinitymassagechairs.com
Version 1.4

INFINITY

MASSAGE CHAIRS

Assembly Guide

Sovana 4D DualPro

Massage Chair

INFINITY

MASSAGE CHAIRS

- 4 Step 4:** Connect the tablet cord to the cord port on the chair's right side—align the notch and pins, push in, and twist to secure. Place the tablet on the seat pad.

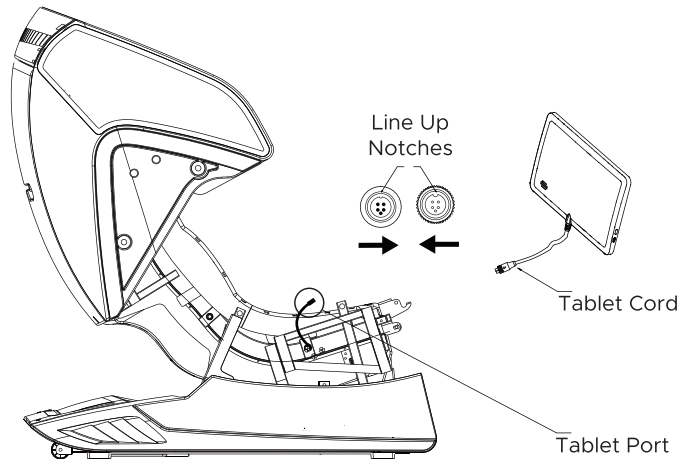

- 6 Step 6:** First, locate the electrical plug on the right arm panel and the electrical port on the chair body. Firmly clip plug into port; matching corresponding colors. Second, locate the air hose and air port between chair body and arm panel; firmly connect each air hose to air port and repeat for the other side.

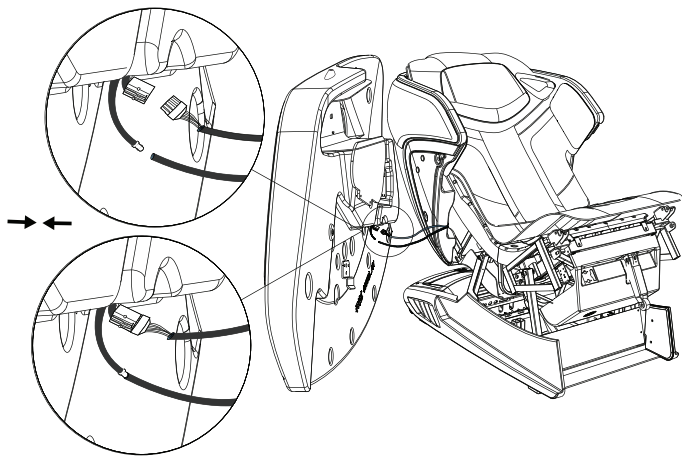

- 8 Step 8:** Move the footrest near the chair body, locate the electrical plug on the footrest and electrical port on the chair body, firmly push in both. Next, plug the footrest air hose into the chair body air port.

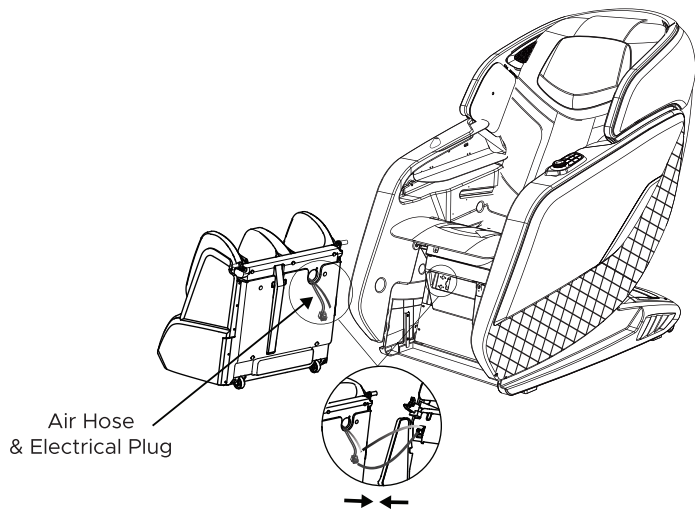

- 10 Step 10:** Remove the bolt from the tablet base and replace with tablet holder. Screw into place and tighten. Discard the bolt. Next, slide the tablet into the tablet holder.

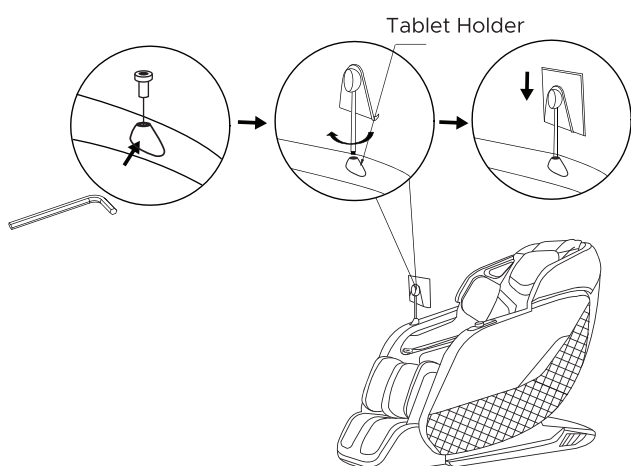

- 5 Step 5:** Determine the left arm panel from the right arm panel. Place each one to the side of the chair.

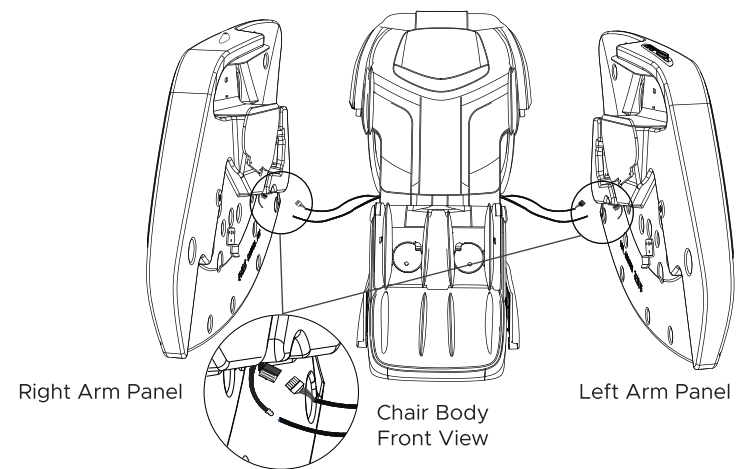

- 7 Step 7:** Align the right arm panel clip over the bottom bar on the chair's right side until it hooks into place. Insert the first (1) M8x25MM bolt with washer and loosely fasten. Insert the second (2) M8x25MM bolt and washer and loosely fasten. Now, tighten both bolts until they are secured. Repeat for the other side.

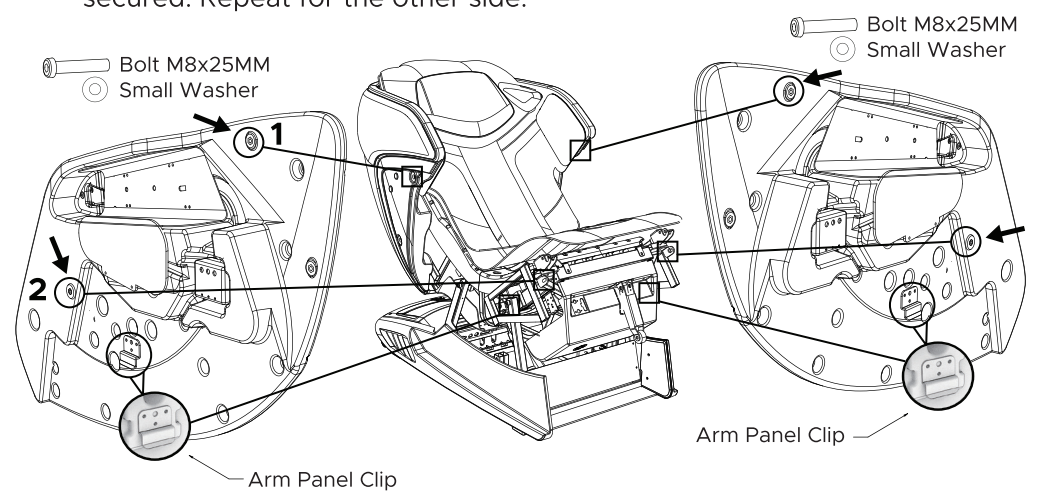

- 9 Step 9:** Place 1x plastic bushing over each footrest axle. Lift the footrest axle into the Hook insert, flip the cover down, insert 1x screw into each side of the footrest axle. Screw to tighten.

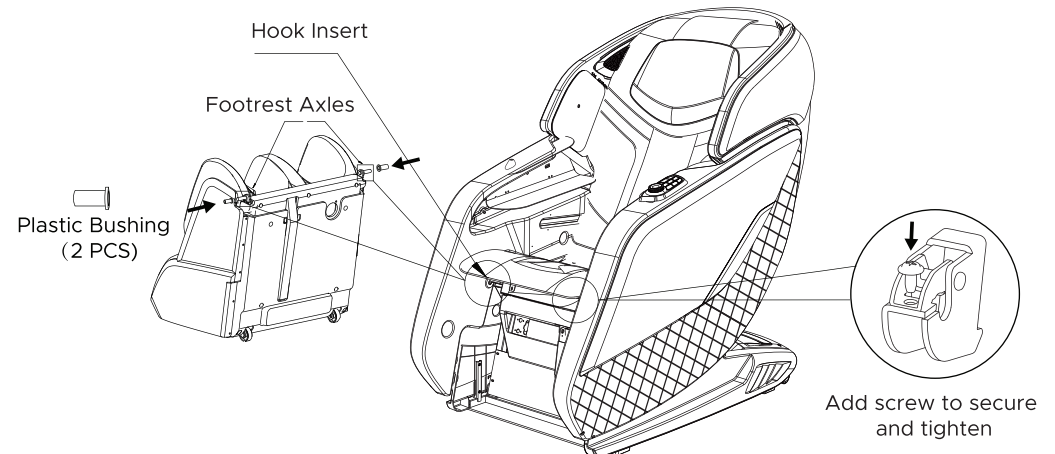

- 11 Step 11:** Find the zippers inside the chair body and align them at these points: (A) side of chair, (B) seat cushion, and (C) end of seat pad. Zip each until secure.

