

If anything is missing, please contact INFINITY at 603-910-5000. Do not return to the place of purchase.

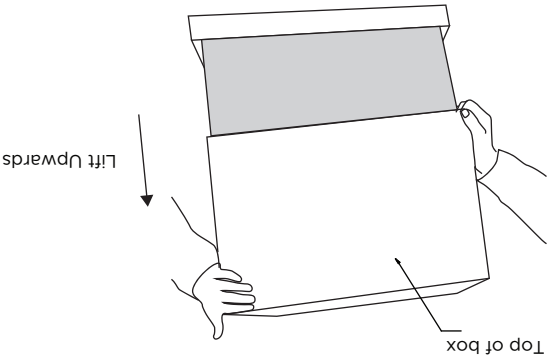

After removing the shipping straps, grab the box from the top and lift upwards. Flip the top of the box to hold protective coverings and cushioning materials.

2

Step 2: With the top of the box removed, you'll see your chair securely packed with protective coverings and cushioning materials. Carefully remove all foam inserts, plastic wraps, and packaging elements surrounding the chair.

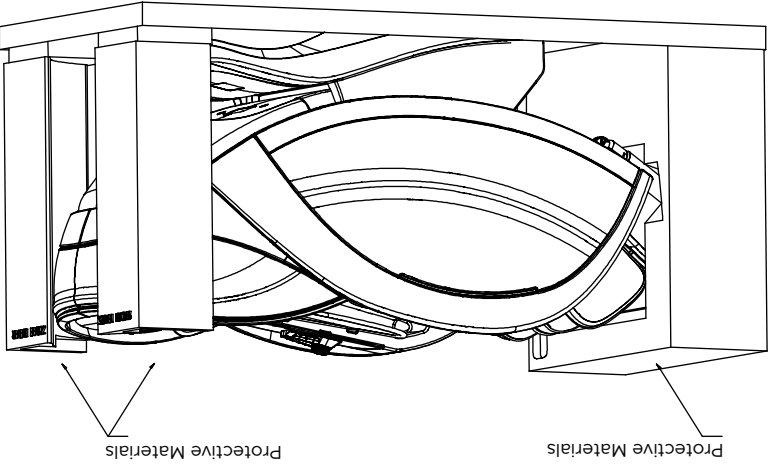

SCAN CODE

Before assembling your chair, watch an assembly video at: www.infinitymassagechairs.com/assembly-tutorials
Alternatively, scan the QR code to go directly to the URL above.

Additional Options:

Boost your comfort with the included back and foot pads. Lay the back pad on the seat cushion and up along the massage track to help reduce the intensity of the 4D mechanism. Place the foot pads in the foot wells to gently lessen the strength of the foot massage.

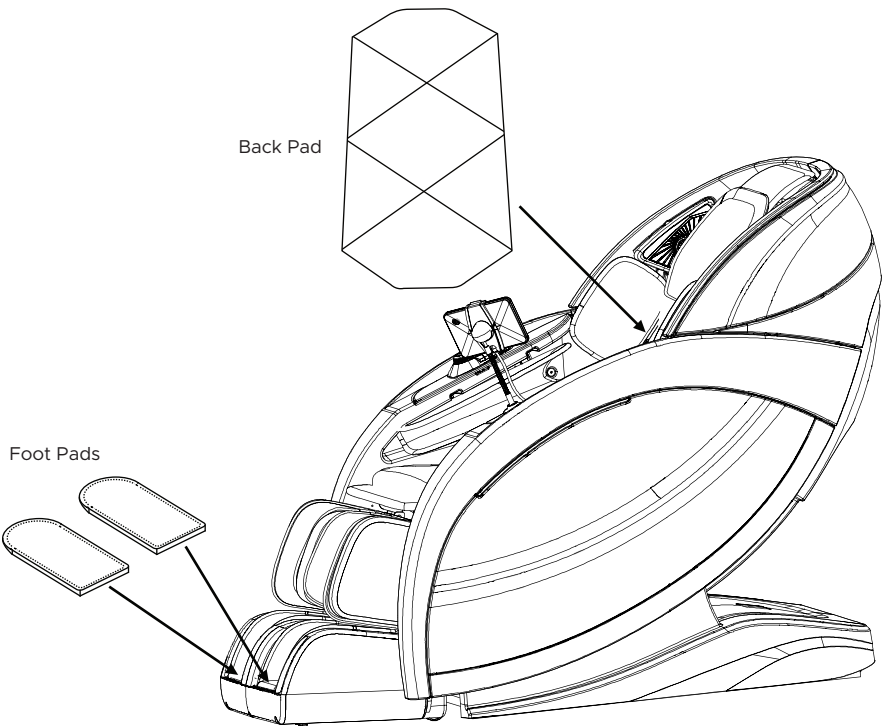

SCAN CODE

Register your product at www.infinitymassagechairs.com/warranty to ensure it is in our system. This will simplify the warranty process should you ever need it.
Alternatively, scan the QR code to go directly to the URL above.

INFINITY®

72 Stard Road, Seabrook, NH 03874
(603) 910-5000
www.infinitymassagechairs.com
Version 1.3

INFINITY® MASSAGE CHAIRS

Assembly Guide

Aura® Elite 4D Massage Chair

INFINITY

MASSAGE CHAIRS

- 3 Step 3:** With two people, carefully lift the chair by both sides and remove from the box. Take your time to ensure a smooth and secure lift.

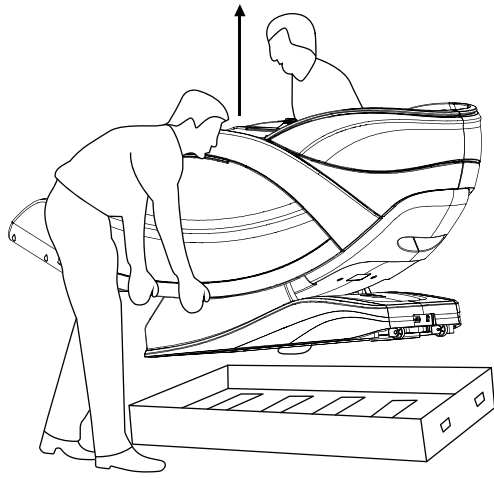

- 5 Step 5:** Find the Power button on the quick access panel, located on the chair's right arm. Press once to turn the chair ON, then press again to return it to the upright position.

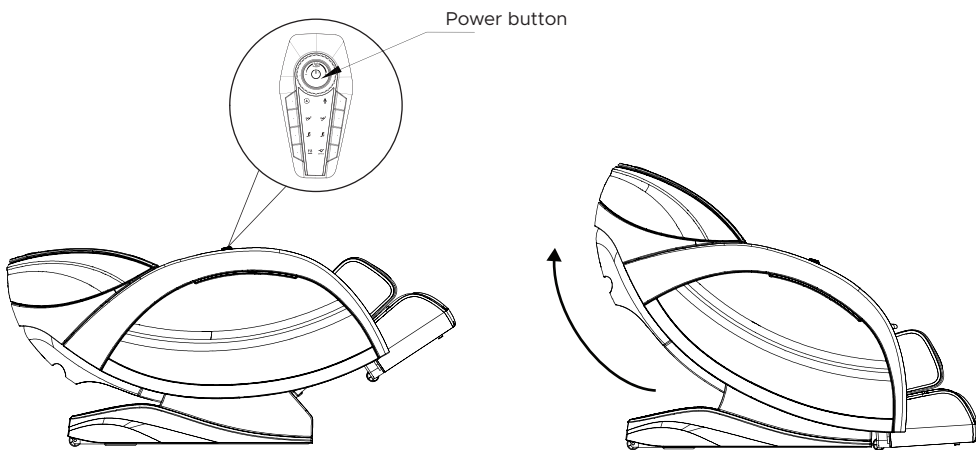

- 4 Step 4:** Plug the power cord into the power cord port on the back of the chair, then connect the other end to a 120V grounded outlet. Locate the main power switch on the back of the chair and press it on.

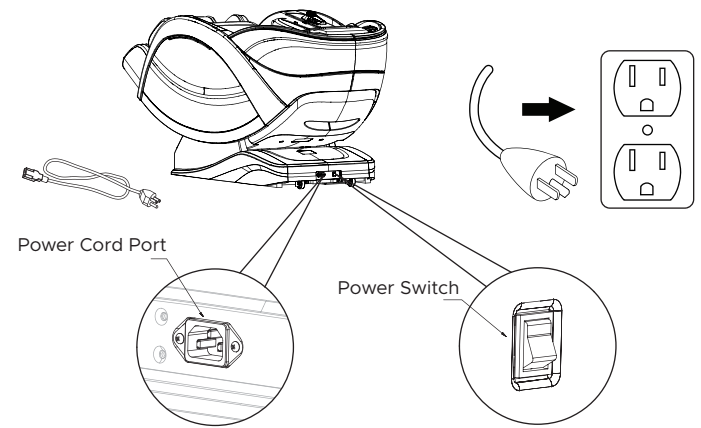

- 6 Step 6:** Insert the tablet holder into the base cover and hole. Using your hands, screw the tablet holder shaft into the hole, tighten to secure.

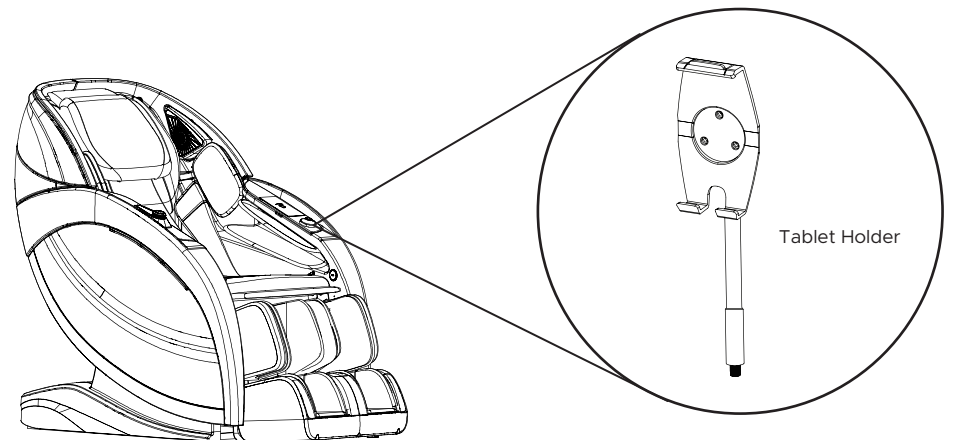

- 7 Step 7:** Remove the tablet from the column airbag. Slide its bottom side into the holder on the left arm panel, then snap the top into place.

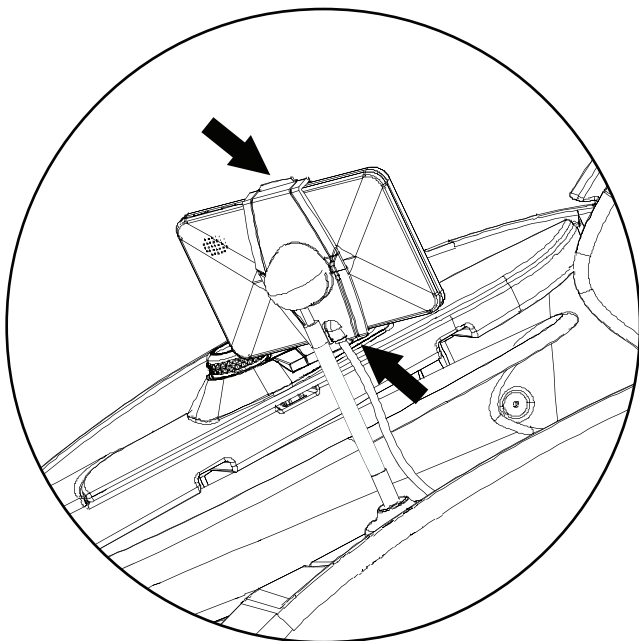

- 8 Step 8:** Ensure that all cables are connected and that the chair is in an upright position.

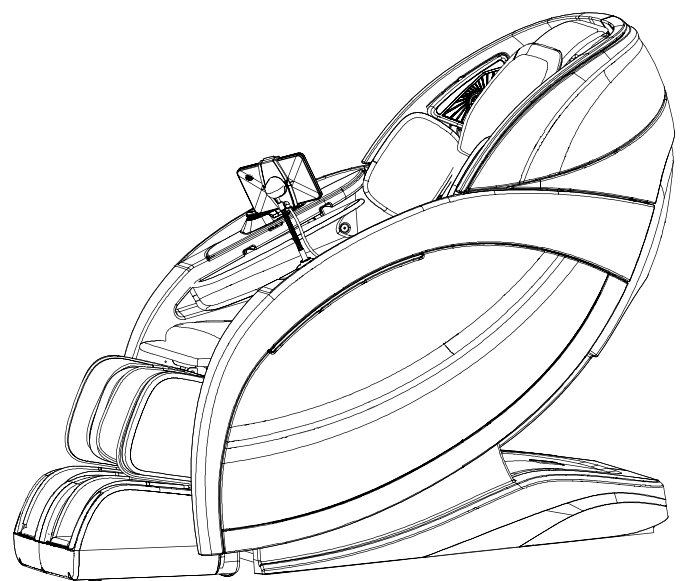

Select an auto program to start a session.



Review chair for smooth operation. If things are not operating correctly, review all assembly steps. Call Infinity support at 1-603-910-5000 if you need live US-based support.

You are done; time for a Massage!