

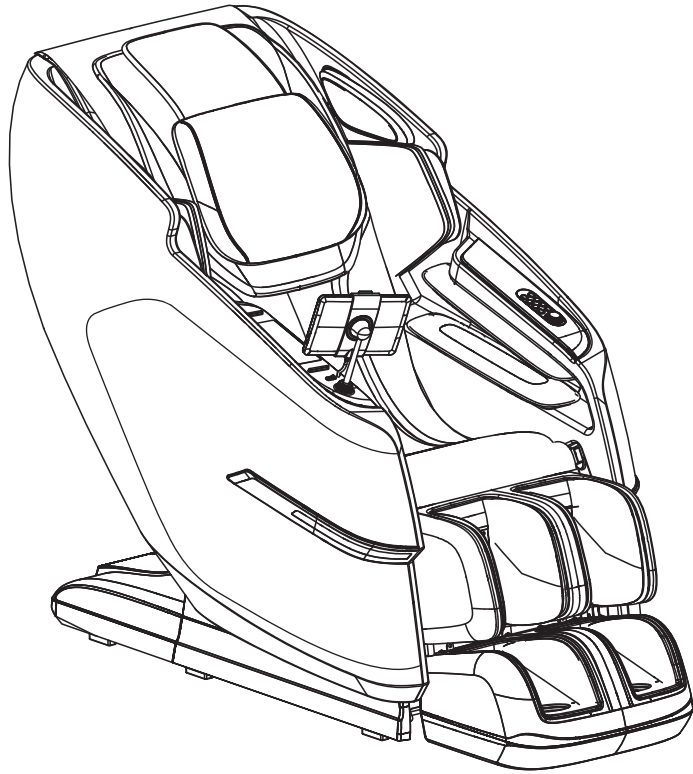

The World's Most
Advanced Massage Chairs®



Assembly Guide

Konbi M728 DualPro 4D Massage Chair

Before assembling your chair, watch an assembly video at:
www.kyotamassagechairs.com/assembly-tutorials

Alternatively, scan the QR code to go directly to the URL above.



SCAN CODE

4 Step 4:

Before attaching the footrest to the chair body, remove the clips on the chair body pins by sliding up using a flathead screwdriver if necessary (If clips are missing, there are spare clips in the Accessory Box).

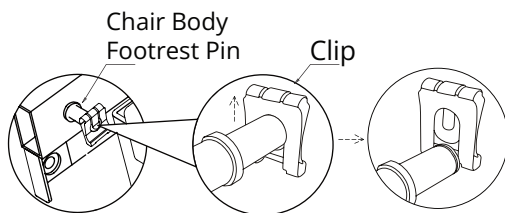

6 Step 6:

Remove the protective covering to expose the velcro and then fold the seat cushion down to attach the velcro. Next zip the seat cushion to the body of the chair and then zip the footrest to the seat cushion.

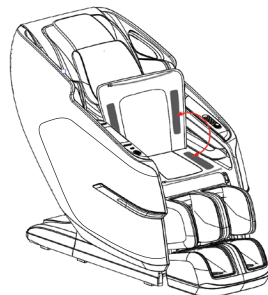

8 Step 8:

Attach the tablet cord to the connection port on the right side of the chair seat. Be careful to line up the pins and key, then push together when aligned, do not force.

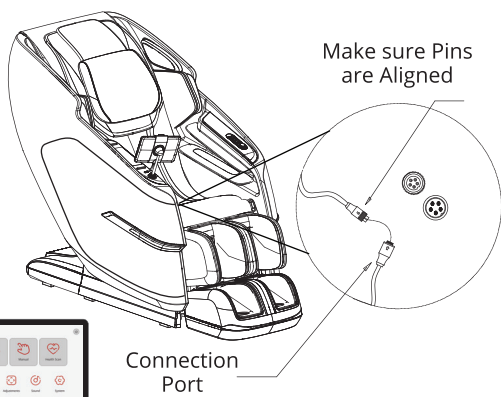

Flip main power switch ON. After the tablet turns on, a yellow warning screen will appear. Read and tap to confirm. Tap Auto and select any program.



The World's Most
Advanced Massage Chairs®

72 Stard Road, Seabrook, NH 03874 | (603) 910-5333 | www.kyotamassagechairs.com

Version 1.1

1

Step 1:

Open the box and remove packaging materials. Remove protective covering from the chair. Carefully check box contents to the detail below, making sure all contents are accounted for.

If anything is missing, please contact Kyota Massage Chairs at (603) 910-5333. Do not return to the place of purchase.

Chair with footrest in seat

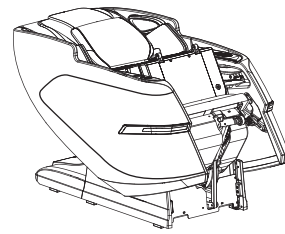

(2) Foot Pads
(In footrest)

Accessory Box Contents

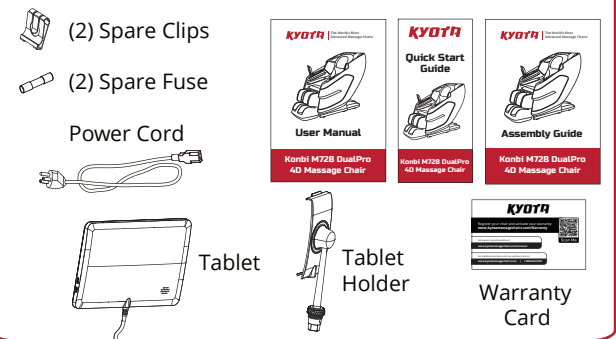

2

Step 2:

Lift the footrest off of the main body of the chair and place on floor. Then lift the main body out of the bottom cardboard base. This will require two people.

Connect the power cord to a grounded 110V electrical outlet and plug it into the power port on the backside base of the chair. Flip the main power switch on. Press & hold the power button on the left arm of the chair until the button illuminates and then let go. Press & hold the button again until the chair resets to the upright position. Turn off main power.

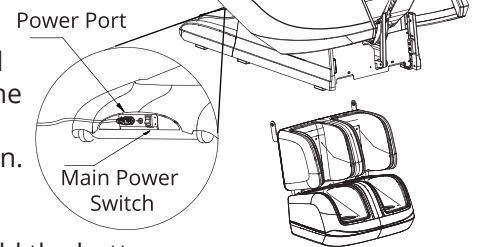

Electrical Port & Air Nozzles

3

Step 3:

Position the footrest in front of the main chair body. Connect the footrest electrical plug into the footrest electrical port. Push it in until it clips. Next, slide air hose 1 into air nozzle 1 and air hose 2 into air nozzle 2. Make sure both are secured tightly.

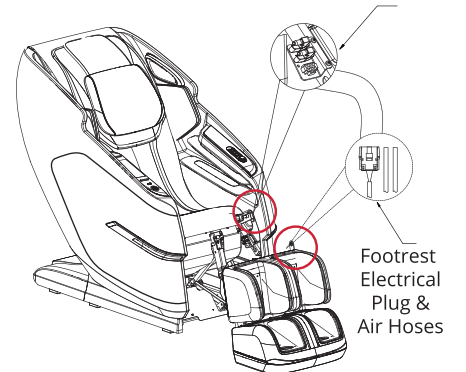

5

Step 5:

Next, lift the footrest and slide one side of the mounting bracket completely onto the chair body pin. Fasten the clip over the pin to secure. Carefully align the other side of the mounting bracket with the remaining pin and slide it on too. Make sure to center the footrest, then fasten the remaining clip over the pin to secure both sides of the footrest.

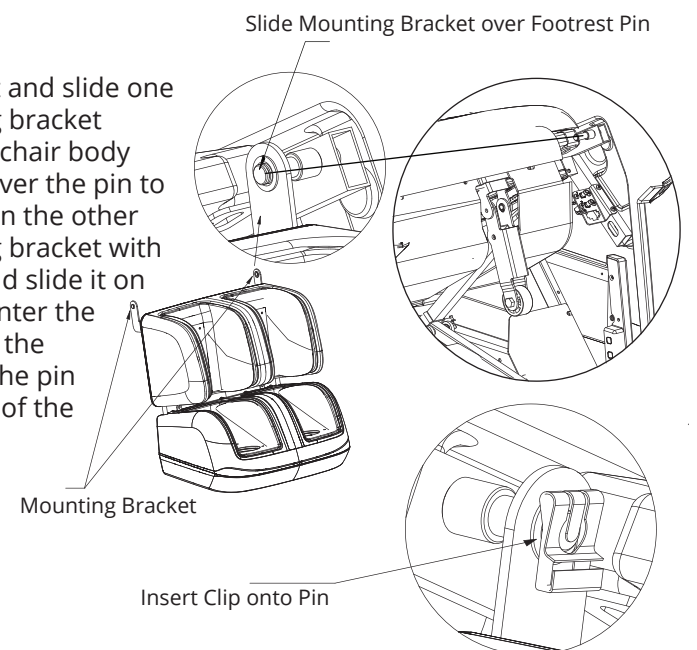

7

Step 7:

Locate the tablet holder from the accessory box. Insert the bottom end of the tablet holder into the tablet mount, making sure the flat end lines up. Screw the chrome fastener down and tighten. Mount the tablet on the tablet holder by seating the bottom first, then gently snap the top into the mount by bringing the two pieces together.

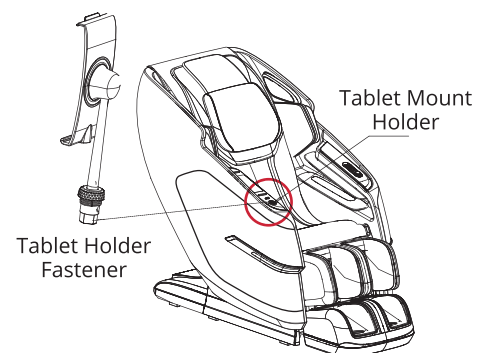

Review chair for smooth operation. If things are not operating correctly, review all assembly steps. Call Kyota support at (603) 910-5333 if you need live US-based support.

You are done; time for a Massage!



SCAN CODE

Register your product at www.kyotamassagechairs.com/warranty/registration to ensure it is in our system. This will simplify the warranty process should you ever need it.

Alternatively, scan the QR code to go directly to the URL above.