



The World's Most
Advanced Massage Chairs®

Before assembling your chair, watch an assembly video at:
www.kyotamassagechairs.com/assembly-tutorials

Alternatively, **scan the QR code** to go directly to the URL above.



SCAN CODE

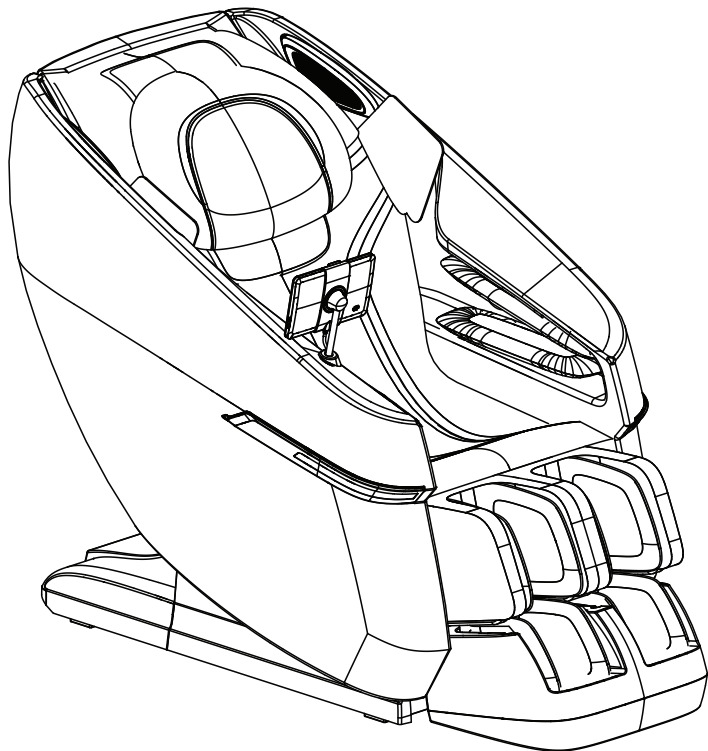

Assembly Guide

Zenyu M338 Massage Chair

2 Step 2:

Lift the footrest from the chair seat and place it on the floor next to the chair body. You'll need two people to lift the chair out of the box. Lift from the back and the base, do not grab the chair's arm panels to move or position.

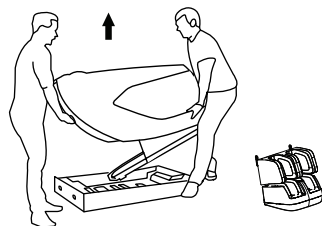

4 Step 4:

Remove the tablet controller from the accessory box and place it on the seat. Connect the tablet cord to the connection port on the right side of the seat, aligning the pins and tightening to secure. Press the tablet's power button to reset the chair to the upright position. When the chair is upright press the main power switch to off.

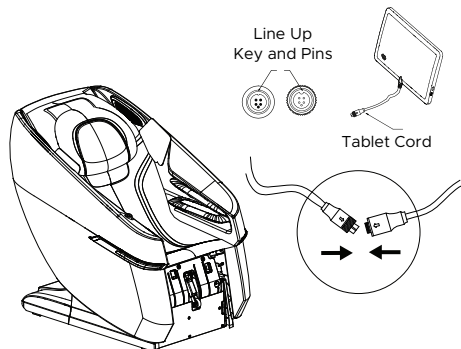

6 Step 6:

Use the provided screwdriver and gently put it into the footrest clip to loosen, then slide the footrest clip out. Repeat on the other side.

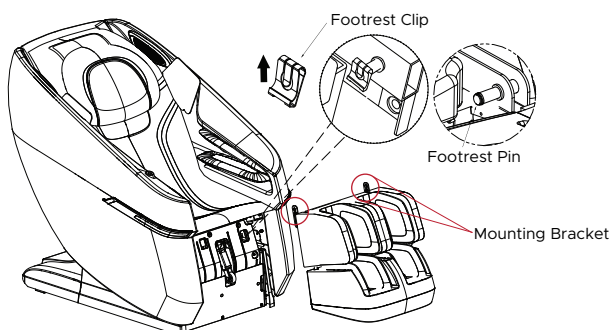

8 Step 8:

Apply the footrest flap to the corresponding velcro on the chair body. Place the seat cushion down also lining up the velcro on the chair body with the seat cushion. Now, locate the power switch in the back and press to turn on.

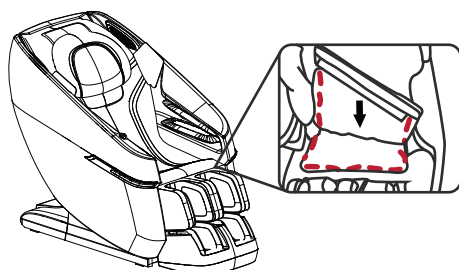

1

Step 1:

Locate the box straps, cut, and remove them. Grab the box and lift upwards, place the box and its packaging materials to the side. The accessory box will be located at the front of the chair. Carefully check the accessory box contents and make sure all items are accounted for.

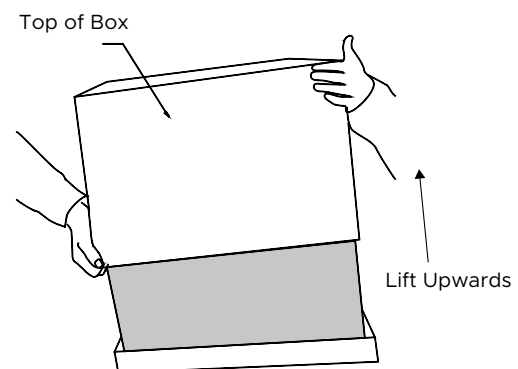

If anything is missing, please contact Kyota Massage Chairs at (603) 910-5333. Do not return to the place of purchase.

Box 1 Contents

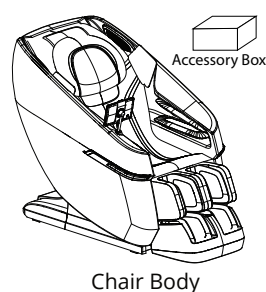

Accessory Box Contents

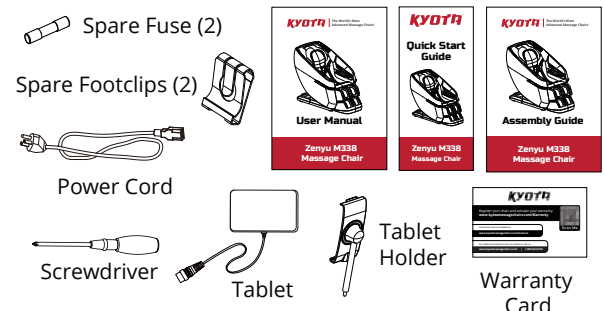

3 Step 3:

Plug the power cord into the back of the chair. Place the other end into a 120V grounded outlet. Turn the chair's power switch to **ON**.

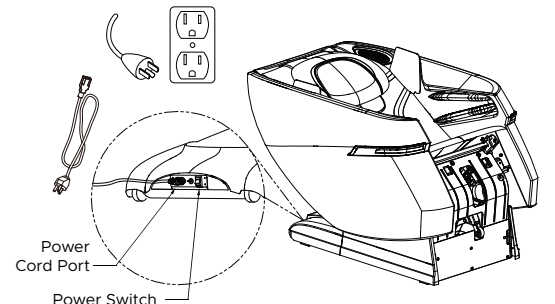

5 Step 5:

Position the footrest in front of the chair and align it. Connect the electrical plug to the port until it clips, then attach the air hose to the nozzle, ensuring it's firmly and fully seated.

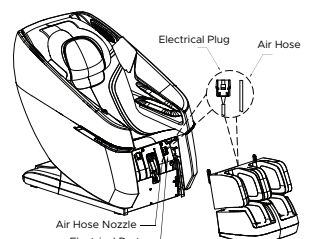

7 Step 7:

Lift the footrest and slide one side of the mounting bracket onto the chair pin. Secure with footrest clip. Align and slide the other side onto the opposite chair pin, center the footrest, and fasten the second clip. There are 2 spare footrest clips in the accessories box.

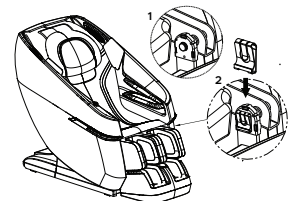

9 Step 9:

Remove the center bolt from the tablet base with a screwdriver and discard it. Attach the tablet holder in its place and hand-tighten. Insert the tablet controller into the holder. Press the power button on the tablet.

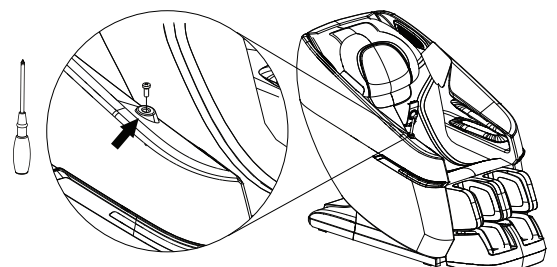

Optionally, the Quick Start Guide can be hung from the Tablet holder post as you install the tablet holder.

You are done; time for a Massage!

Review chair for smooth operation. If things are not operating correctly, review all assembly steps. Call Kyota support at (603) 910-5333 if you need live US-based support.



The World's Most
Advanced Massage Chairs®

72 Stard Road, Seabrook, NH 03874 | (603) 910-5333 | www.kyotamassagechairs.com

Version 1.2



SCAN CODE

Register your product at www.kyotamassagechairs.com/warranty/registration to ensure it is in our system. This will simplify the warranty process should you ever need it.

Alternatively, **scan the QR code** to go directly to the URL above.