

Prior to assembly, carefully unpack accessories box. Check the box to make sure all the contents are accounted for. **If anything is missing, please contact INFINITY at 603-910-5000. Do not return to the place of purchase.**

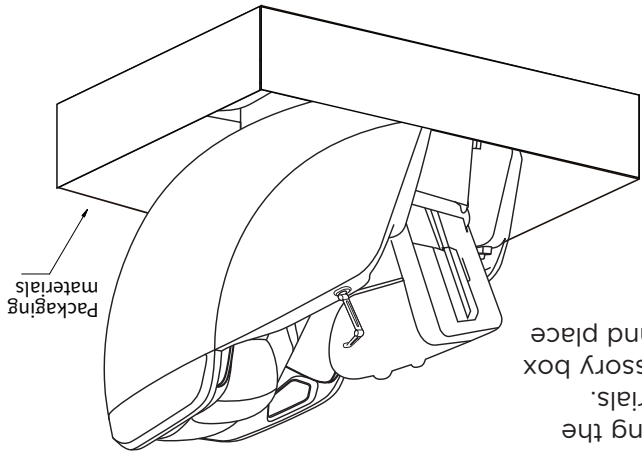

Step 2: Continue removing the packaging materials. Locate the accessory box in the seat pad and place aside for now.

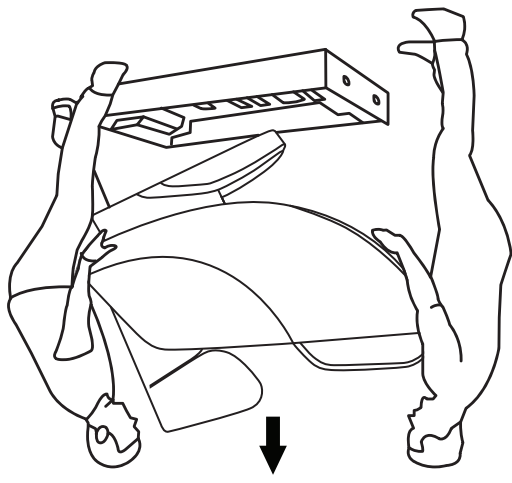

Step 3: With a partner, lift the massage chair out of the box and position on a flat surface.

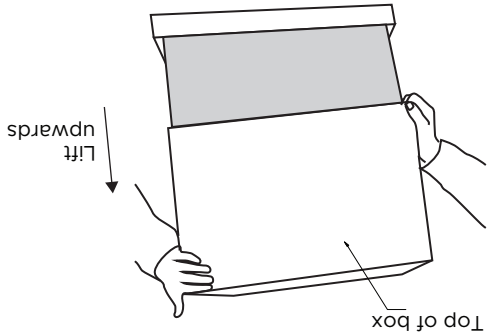

Step 1: Cut the tie straps, remove the box by lifting it upwards from the ground.



SCAN CODE

Before assembling your chair, watch an assembly video at: www.infinitymassagechairs.com/assembly-tutorials Alternatively, scan the QR code to go directly to the URL above.

Final Check:

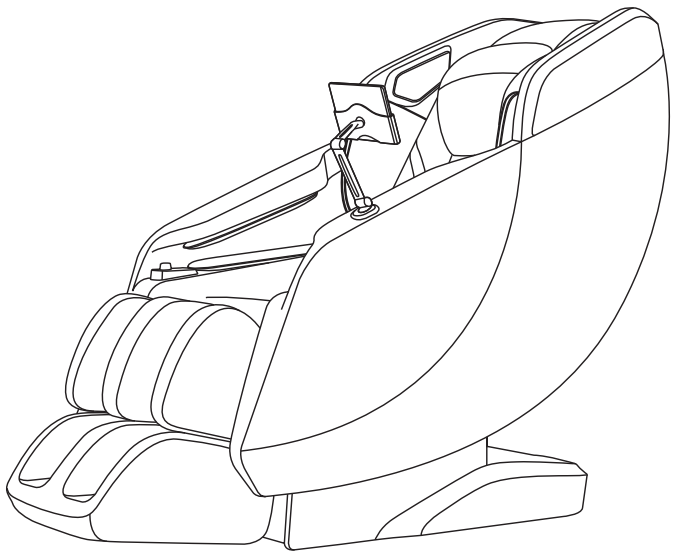

Power on the tablet and select a program to start a session.

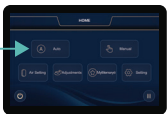

If you wish to use an App to control your chair, download the “Celebrity Elite 4D” App from the Apple or Google App store and follow pairing instructions found within the App.



Review chair for smooth operation. If things are not operating correctly, review all assembly steps. Call Infinity support at 1-603-910-5000 if you need live US-based support.

You are done; time for a Massage!



SCAN CODE

Register your product at www.infinitymassagechairs.com/warranty to ensure it is in our system. This will simplify the warranty process should you ever need it.

Alternatively, scan the QR code to go directly to the URL above.

INFINITY®

72 Stard Road, Seabrook, NH 03874
(603) 910-5000
www.infinitymassagechairs.com

Version 1.1

INFINITY®

MASSAGE CHAIRS

Assembly Guide

Celebrity® Elite 4D Massage Chair

INFINITY

MASSAGE CHAIRS

- 4 Step 4:** Lower the footrest slowly and steadily, guiding it downward until it reaches its natural resting position.

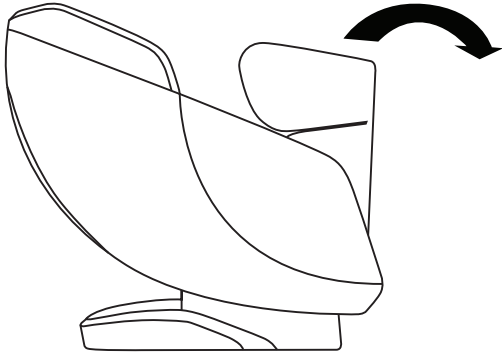

- 5 Step 5:** Grab the tablet holder and unscrew the nut from behind (1). Place the nut over the tablet stand ball bearing (2). Push the back of the tablet holder into the ball bearing (3), screw the nut until secured (4).

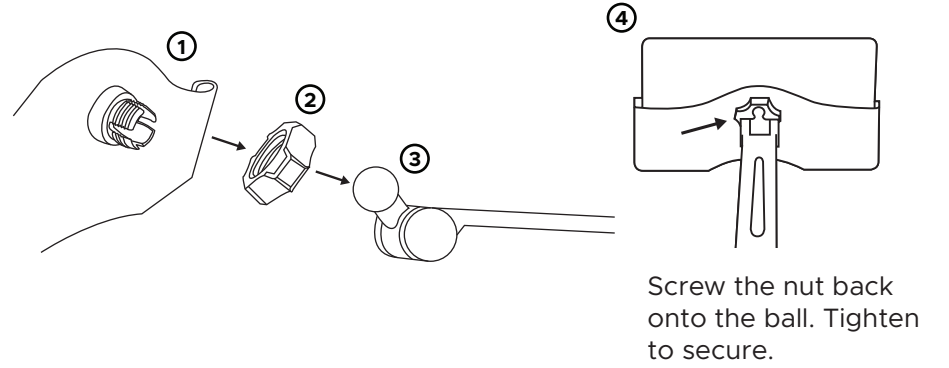

- 6 Step 6:** Grab the touch screen tablet and place it inside of the tablet holder.

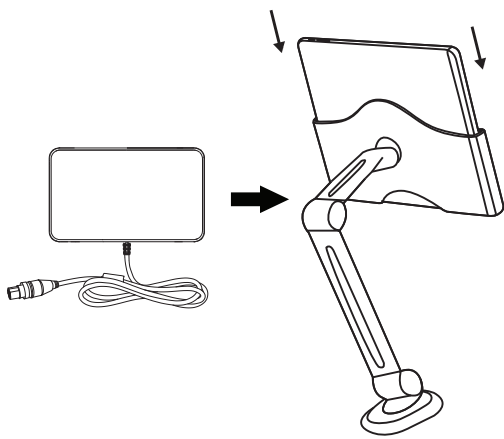

- 7 Step 7:** Find the tablet cord port in between the left armrest and seat cushion. Connect the two cords together, align the notch, key, and pins, gently push in and screw the fastener until secured.

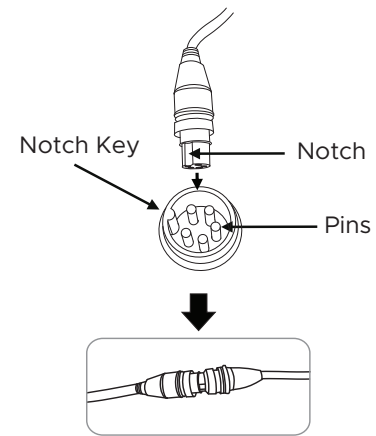

- 8 Step 8:** Locate the zippers on the bottom of the seat pad, there is one on each side and one in the front, align them and zip until the seat pad is secured. Tuck the tablet's cord in between the seat.

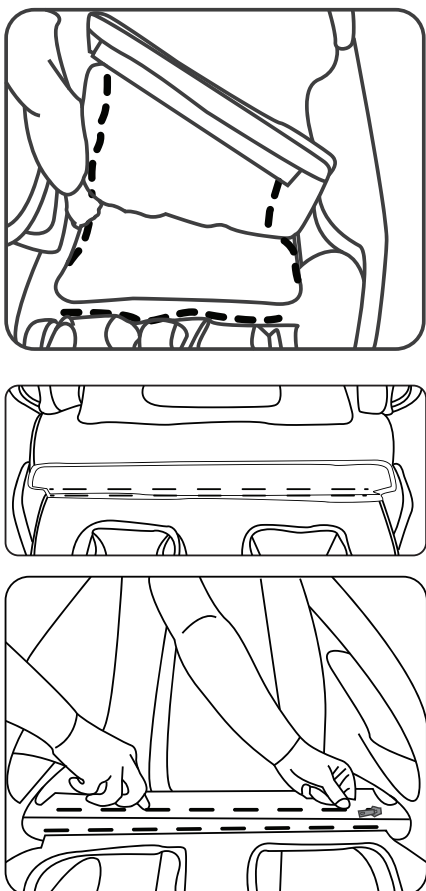

- 9 Step 9:** Connect the chair's power cord into a grounded 120V electrical outlet and plug it into the back side of the base of the chair. Flip the main power switch (I/O) to on (I).

