

## InVision Active Learning POD System™

37109	Table
37110	Center Pedestal
37111	Pedestal Riser
37112	Modesty Panel

**Touchboards**

205 Westwood Ave, Long Branch, NJ 07740  
Phone: 866-94 BOARDS (26273) / (732)-222-1511  
Fax: (732)-222-7088 | E-mail: sales@touchboards.com

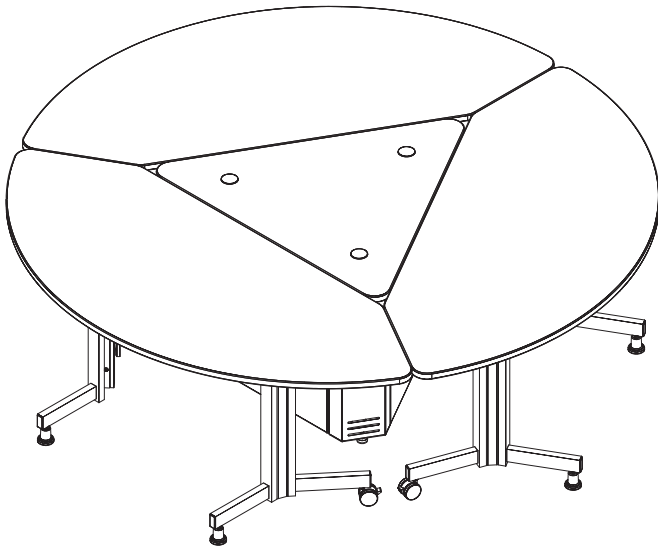

InVision Active Learning  
POD System

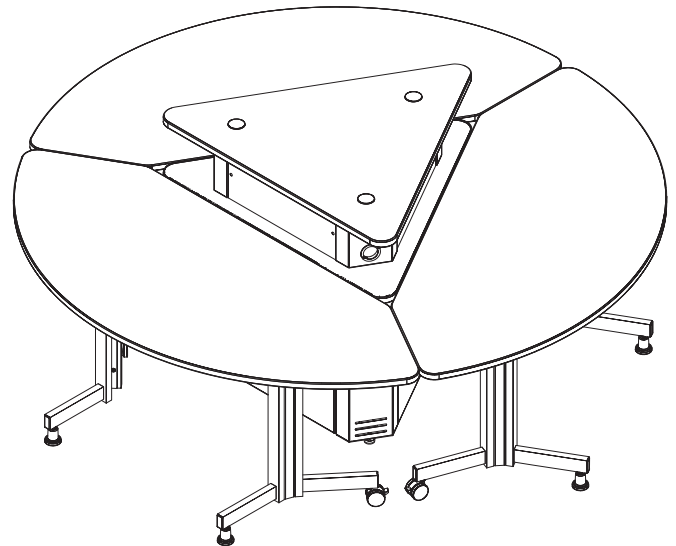

with optional  
Pedestal Riser

**CAUTION:**

Before using this product, read this manual and follow all safety and operating instructions.

Before you begin, please make sure all parts and proper quantities are included. Any parts damaged during shipment must be reported within 15 days of receipt. To report information regarding damages or if you have any questions, please call 1-800-235-1262.

To purchase parts or accessories, please contact us at  
[www.spectrumfurniture.com](http://www.spectrumfurniture.com)  
1-800-235-1262

Thank you for purchasing Spectrum products!



Spectrum Industries, Inc  
Chippewa Falls, WI 54729, USA

**! Safety !**

- Read this owner's manual before assembling or using this table.
- Do not sit or allow students to sit on top of table.
- Do not allow children to move table.
- Move tables slowly and carefully when mobile.
- Keep fingers and hands away from the table edges when moving to prevent pinching.
- For indoor use only. Do not install or store the unit where it will be exposed to weather. Keep unit dry.

## Hardware Package Contents

**Note:** The items shown here represent all the structural components available for the InVision Active Learning POD System. Some of the items shown may not be included with your particular unit-some assembly steps may not apply. Before beginning assembly, please review these instructions.



**37109 - Table**

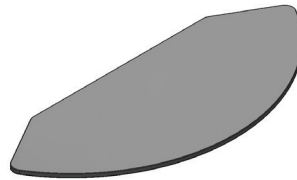

(1) 0113973  
worksurface



(2) 0113978  
leg bracket

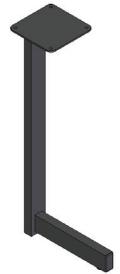

(4) 0113974  
leg

### (3) Table Parts Bag

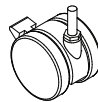

(4) 0105662  
stem caster



(26) 026064  
1/4-20 x 5/8" PHMS

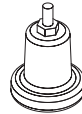

(4) 026038  
5/16-18 x 5/8" bell glide

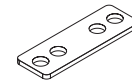

(1) 037749  
Unit-to-unit bracket

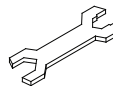

(1) 025069  
caster/glide wrench

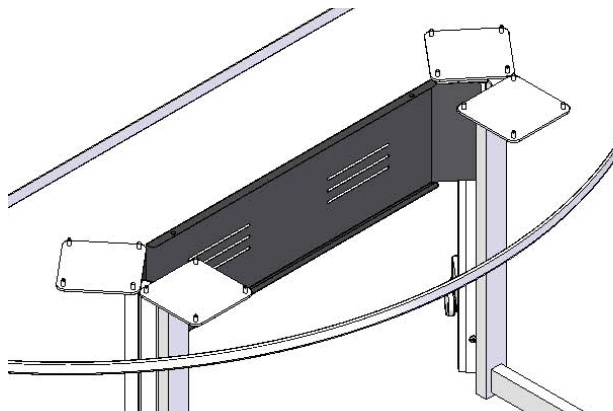

**37112 - Modesty Panel**



(1) 0114258  
modesty panel

### Modesty Panel Parts Bag



(2) 026064  
1/4-20 x 5/8" PHMS



(2) 0101382  
#14 x 7/8" PHSM

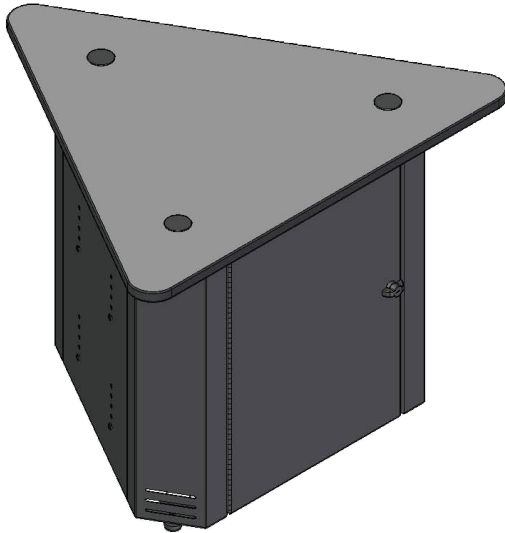

37110 - Center Pedestal

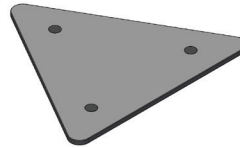

(1) 0113959  
top panel

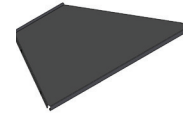

(2) 0113963  
shelf



(1) 0113964  
door stop bracket

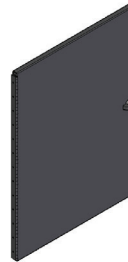

(1) 0113967  
door assembly



(2) 0113962  
side panel



(3) 0113960  
corner column

**Parts Bag**



(20) 026064  
1/4-20 x 5/8" PHMS



(3) 037779  
5/16-18 x 1" glide



(15) 0100167  
8-32 x 1/2" PH thread  
cutting screw



(3) 0113961  
floor mount bracket



(3) 041943  
1/4-20 locknut



(3) 039622  
2" grommet

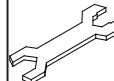

(1) 025069  
caster/glide wrench

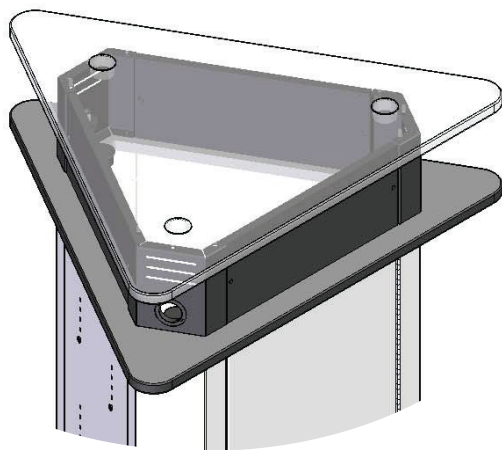

37111 - Pedestal Riser

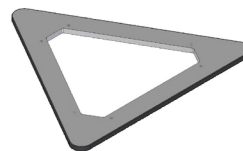

(1) 0114245  
open panel



(3) 0114243  
corner columns



(3) 0114244  
instrument  
panel

**Pedestal Riser Parts Bag**



(12) 026064  
1/4-20 x 5/8" PHMS

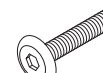

(6) 0102063  
1/4-20 x 35mm JC bolt

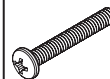

(6) 041289  
1/4-20 x 1-3/4" PHMS



(3) 059984  
2.5" Snap-in grommet



(1) 025039  
4mm hex wrench

# 1. Table assembly - 37109

## A. Assemble legs

**Note:** Each table comes with (4) casters and (4) glides. The table can be assembled with all 4 casters for frequent mobility, 4 glides for fixed locating, or 2 casters / 2 glides for occasional mobility. **Figure 1A** below shows the 2 casters / 2 glide assembly option.

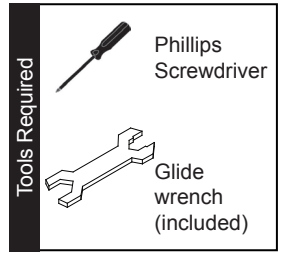

1. To make a leg assembly, attach a leg bracket (notches facing leg plates **Figure 1B**) to two legs with (4) 1/4-20 x 5/8" PHM screws. **Figure 1A**. Leave these screws loose until the legs are attached to the worksurface. This will help align the mounting holes. Each table requires a left and right leg assembly.
2. Attach the front bell glides and casters as shown.
3. Repeat this procedure for each set of legs.

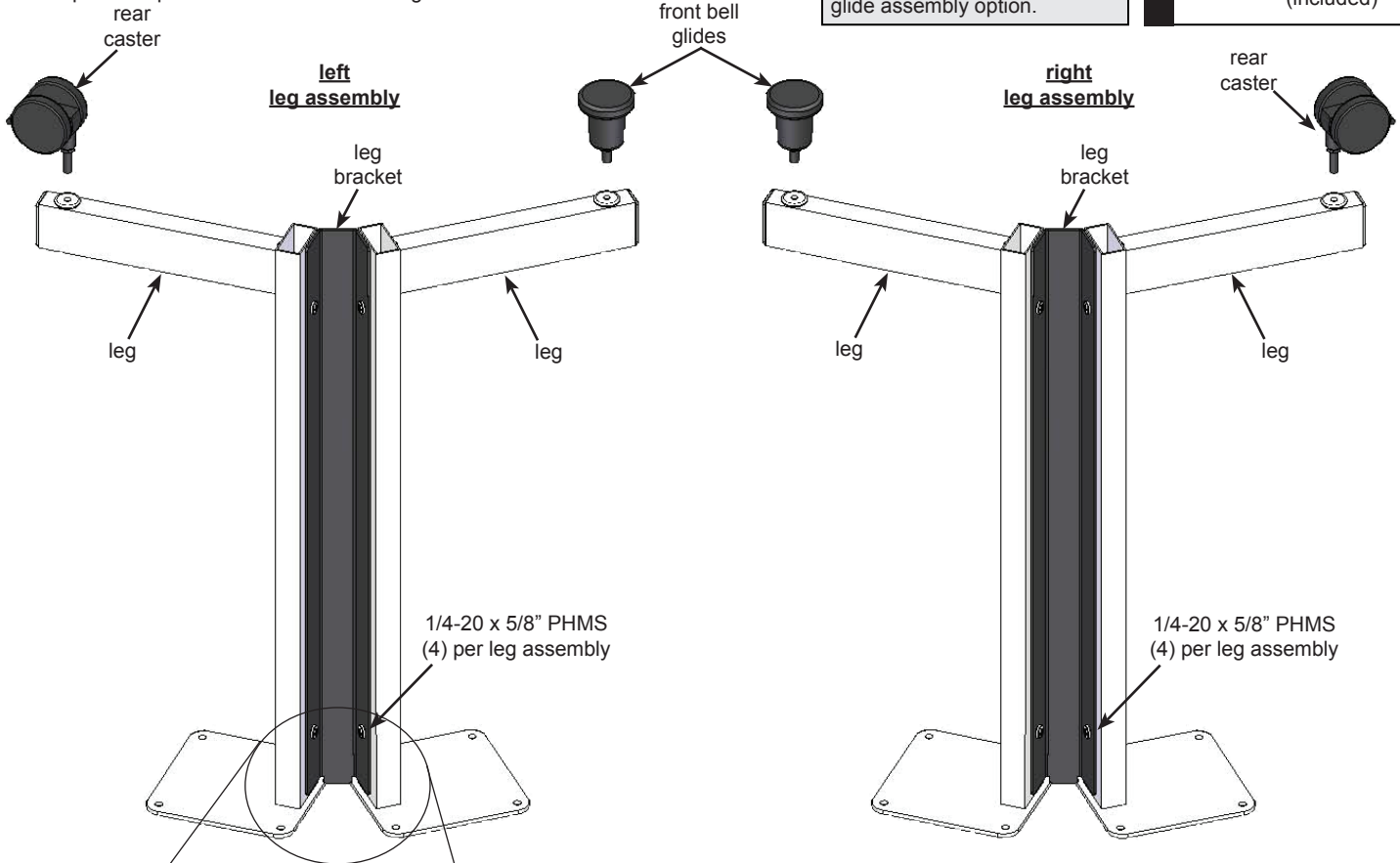

**Figure 1A**

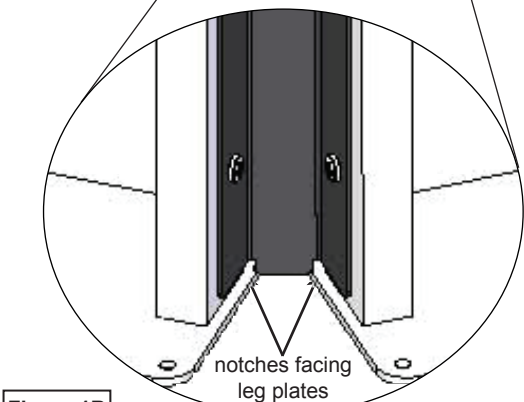

**Figure 1B**

## B. Attach legs to worksurface

1. Place the worksurface face-down onto a non-abrasive surface.
2. Attach each leg assembly to the worksurface with (8) 1/4-20 x 5/8" PHM screws. **Figure 1C**. Note: Bell glides should be on the curved-side of the worksurface.
3. Tighten all screws securely.
4. Flip table upright.
5. Repeat this assembly procedure on all three tables.

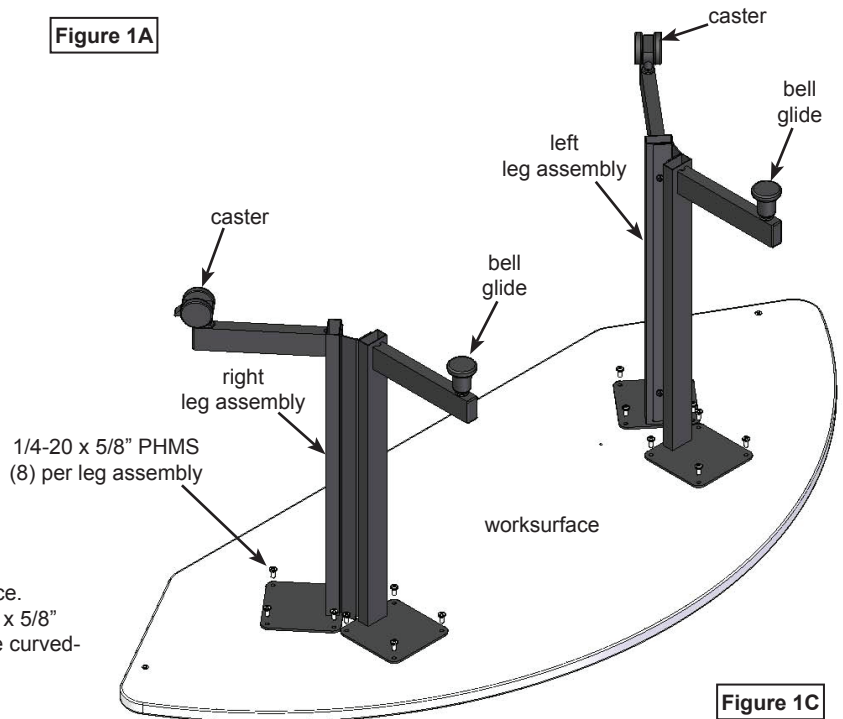

**Figure 1C**

## 2. Center pedestal assembly - 37110

### A. Choose pedestal top panel

Tools Required



Phillips  
Screwdriver



7/16" or adjustable  
wrench

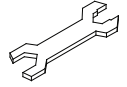

Glide wrench  
(included)

#### Option #1:

If you are assembling a standard (flush worksurface) table, install the solid top panel on the center pedestal. **Figure 2A.**

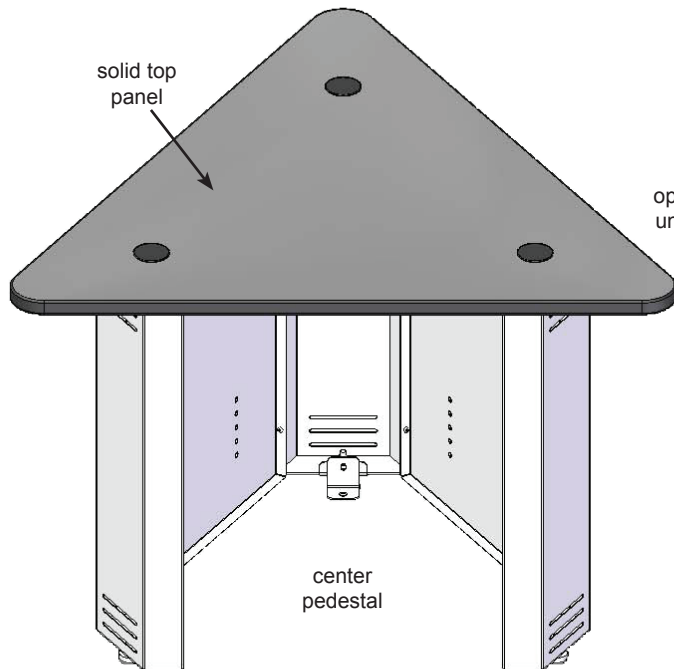

Figure 2A

#### Option #2:

If you will be using the optional pedestal riser, install the open panel (included with the riser) on the center pedestal. **Figure 2B.** Pedestal riser assembly will continue on p.8.

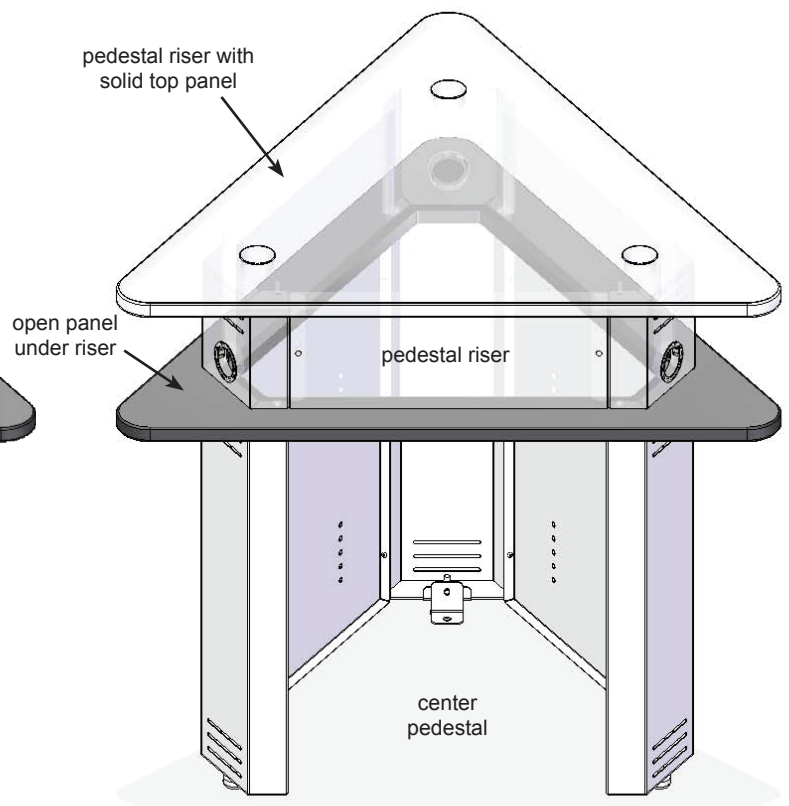

Figure 2B

## B. Assemble pedestal

1. Place the top panel face-down onto a non-abrasive surface. **Figure 2C.**
2. Align and attach the corner columns to the top panel using 1/4-20 x 5/8" PHM screws. Do not tighten completely yet.

**Note:** If you will be attaching the pedestal riser later with the open top panel, install (1) 1/4-20 x 5/8" PHM screw in the center mounting hole of each corner column. Longer screws will also be used during the riser assembly on p.8 to secure the riser to the corner columns.



3. Attach the (2) side panels to the corner columns as shown with 8-32 x 1/2" PH thread-cutting screws. (4) screws per panel will be used. Tighten securely, but do not overtighten these screws.
4. After the side panels and corner columns are installed, tighten all screws.
5. Install a glide into each corner column.
6. Determine which side you'd like the door to be hinged (from left or right). The door is symmetrical and can be hinged from the left or right side. Attach the door stop bracket to the corner column opposite the determined hinge side with (2) 8-32 x 1/2" PH thread-cutting screws. Tighten screws securely, but do not overtighten these screws.
7. Optional: If the unit is to be anchored to the floor, attach a floor bracket to each corner column with a 1/4-20 x 5/8" PHM screw and 1/4-20 locknut.
8. Flip the unit over.

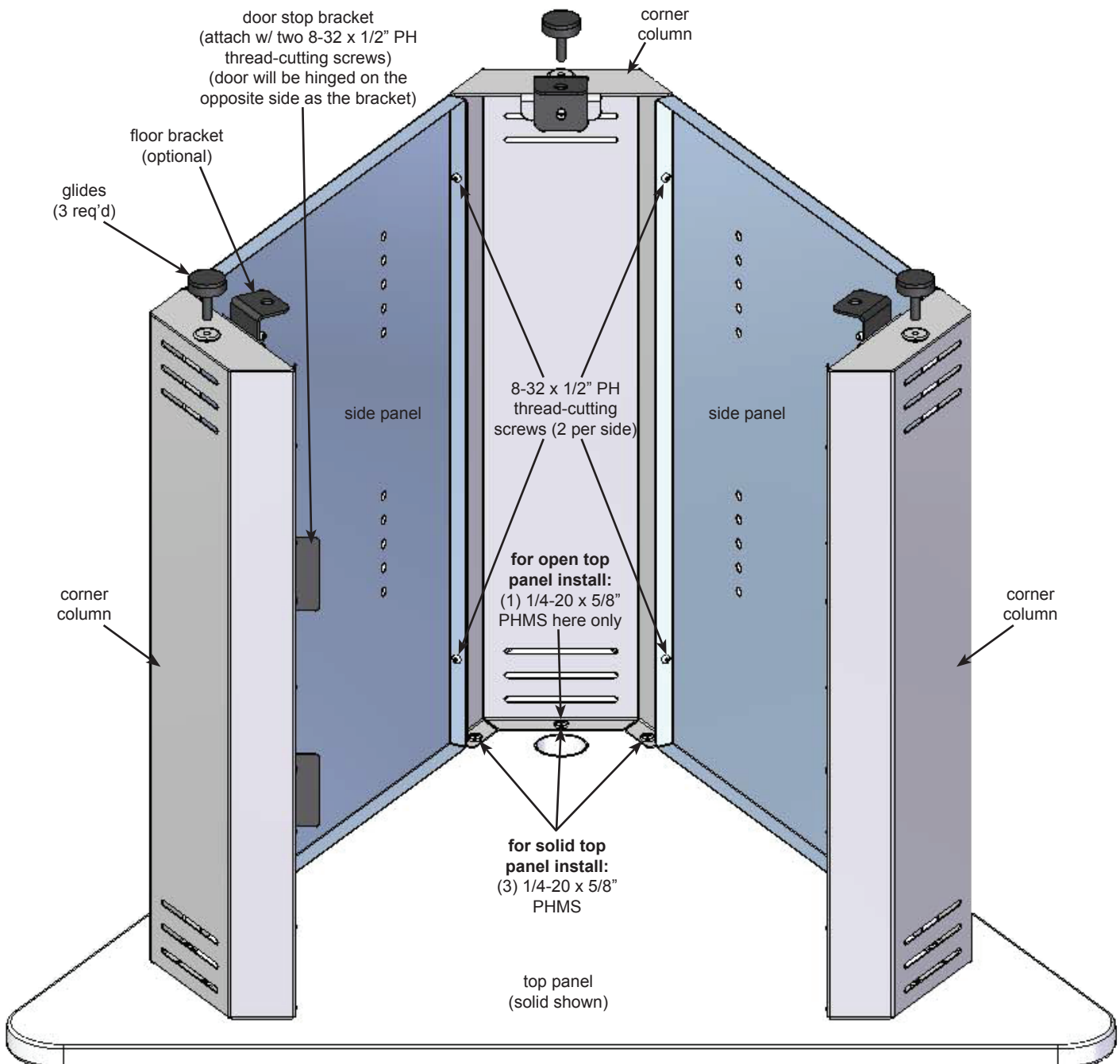

**Note:** If you will be attaching the pedestal riser, install the door, but not the shelves, then proceed with the pedestal riser assembly instructions on p.8.

9. Install the two adjustable shelves at the desired height and attach to the side panels with (4) 1/4-20 x 5/8" PHM screws and tighten securely. **Figure 2D.** Use the lowest set of mounting holes when installing the lower shelf.
10. Attach the door to the corner column (opposite the door bracket) with (5) 8-32 x 1/2" PH thread-cutting screws. Be careful not to overtighten these screws.
11. Install (3) 2" grommets in the top panel.

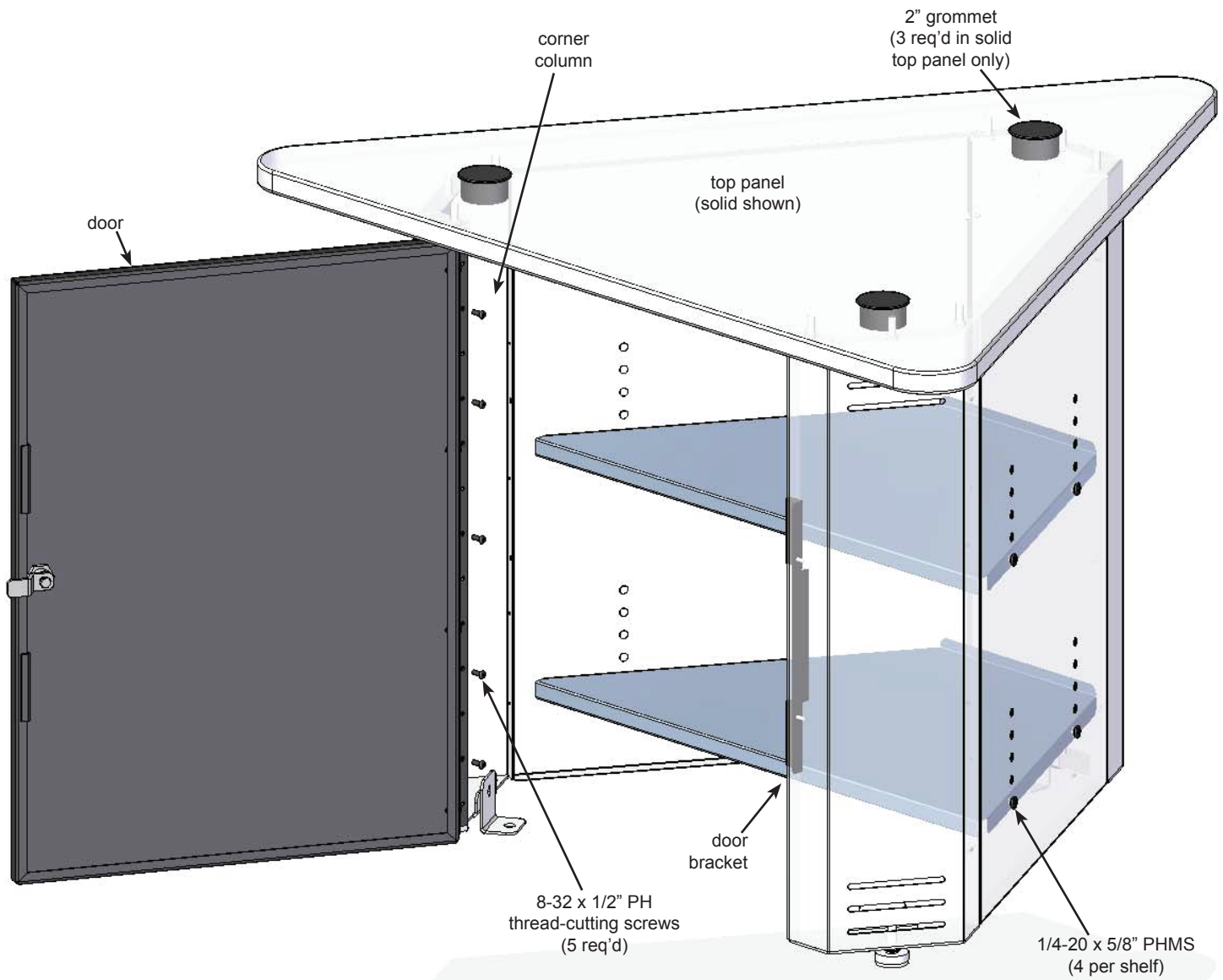

**Figure 2D**

**Note:** Spectrum recommends using the lowest set of mounting holes when installing the lower shelf to maximize pedestal stability.

**Note:** At this point, if you are using the optional floor brackets, place the pedestal into its final location, adjust the brackets to contact the floor and tighten securely. Mark the bracket hole locations onto the floor. These hole locations will be used with anchor fasteners compatible with your specific floor. (Not included.)

### 3. Pedestal Riser Assembly - 37111

**Note:** If you are installing the pedestal riser onto an existing pedestal with a solid top panel:

- The solid top panel must be removed and replaced with the open top panel prior to the riser assembly. (See step B1-B2 on p.6 for the open top panel assembly procedure.)
- The shelves should also be removed to provide easier access to the screws underneath.

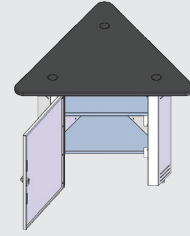

#### A. Install corner columns

1. Attach each corner column to the installed open panel top as shown with (2) 1/4-20 x 1-3/4" PHM screws. (installed from under the open top panel). **Figure 3A.** Do not tighten these screws completely yet.
2. Install a 2" snap-in grommet into each corner column.

Tools Required



Phillips  
Screwdriver

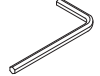

4mm hex wrench  
(included)

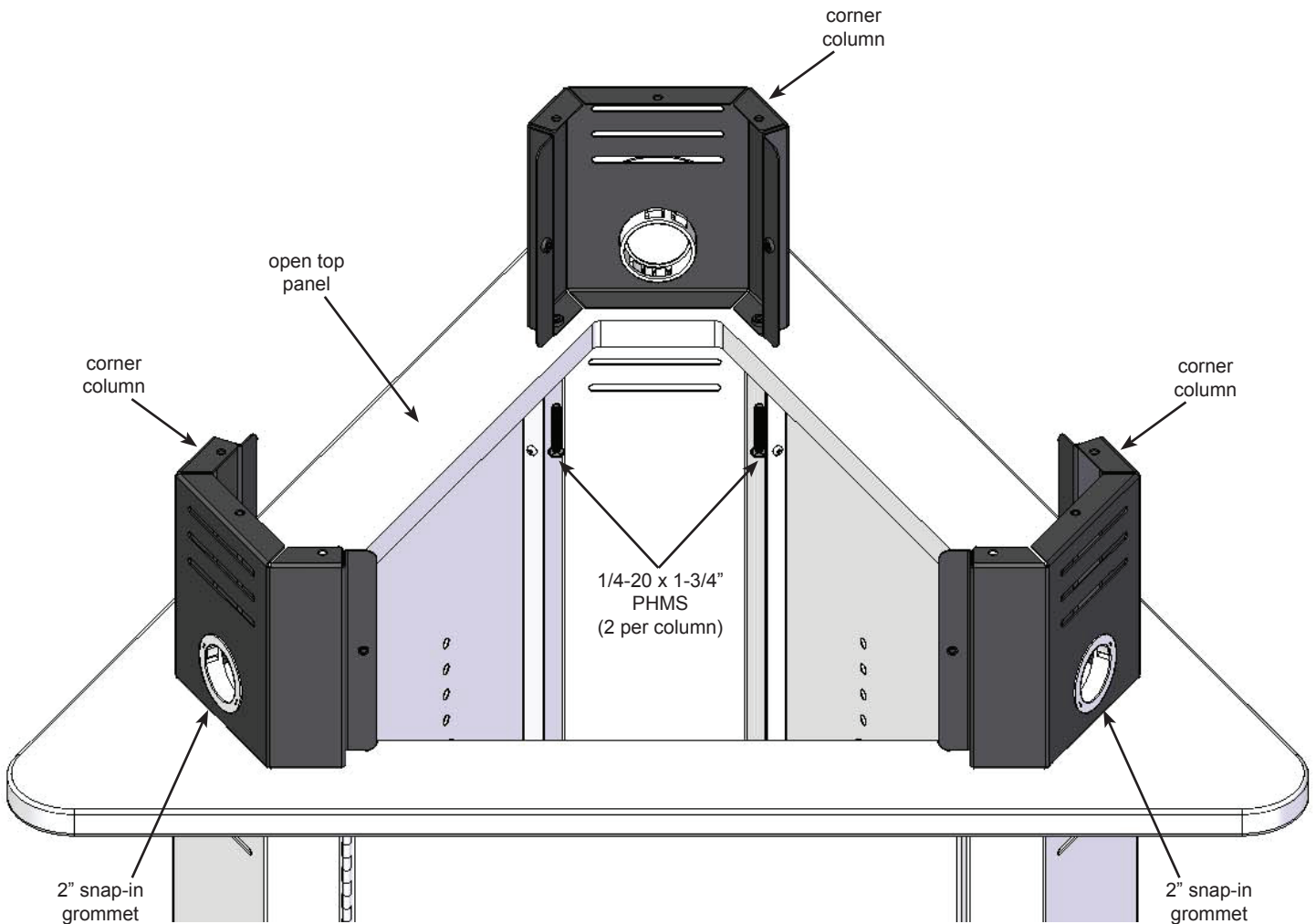

Figure 3A



## B. Install solid top panel and instrument panels

1. Set the solid top panel onto the corner columns while aligning the mounting holes. **Figure 3B**. Secure each corner column to the solid top with (2) 1/4-20 x 5/8" PHM screws and tighten securely.
2. Attach each instrument panel to the corner columns with (2) 1/4-20 x 35mm JC bolts. Tighten securely.
3. Tighten all screws securely.
4. Reinstall shelves.

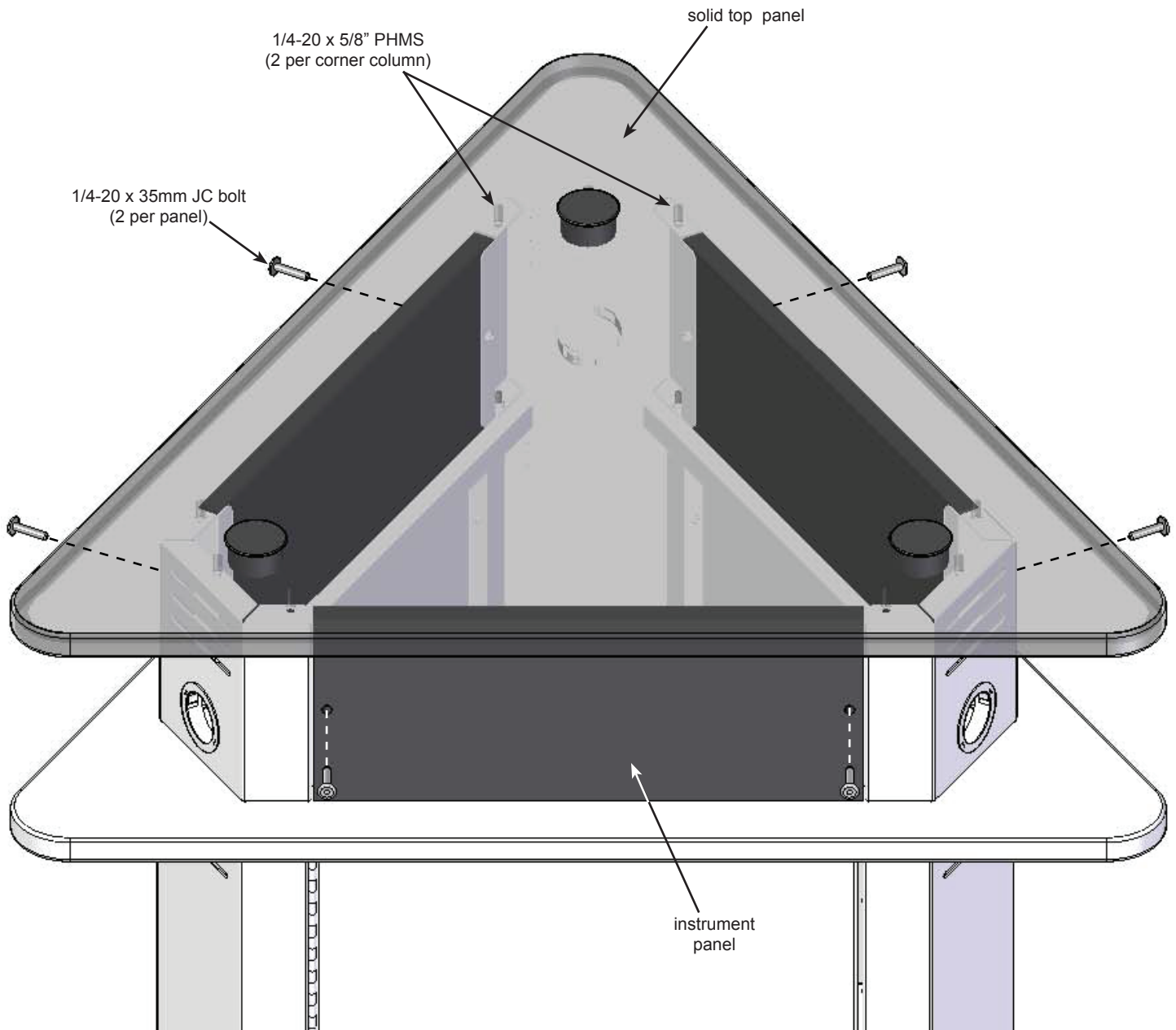

Figure 3B

## 4. Modesty panel assembly - 37112

### A. Install modesty panel

1. Carefully flip the table over onto a non-abrasive surface. **Figure 4.**
2. Remove the upper 1/4-20 x 5/8" PHM screw from each leg assembly.
3. Orient the modesty panel as shown while aligning the worksurface mounting holes.
4. Install (2) #14 x 7/8" PHSM screws into the worksurface to secure. Do not tighten completely yet.
5. Re-install the previously removed 1/4-20 x 5/8" PHM screws to secure the modesty panel to the leg assemblies.
6. Tighten all screws securely.
7. Repeat this procedure for the remaining tables.

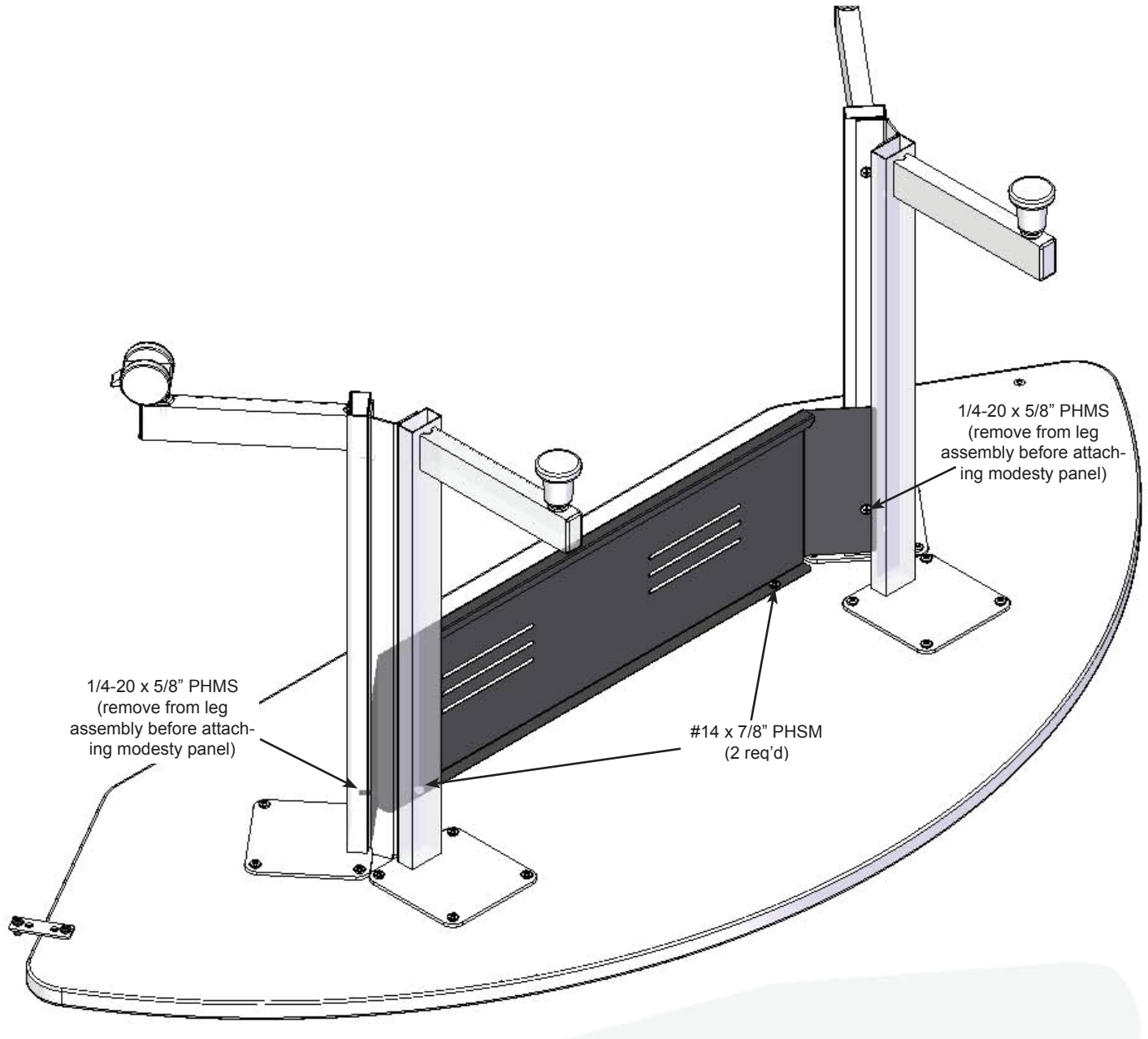
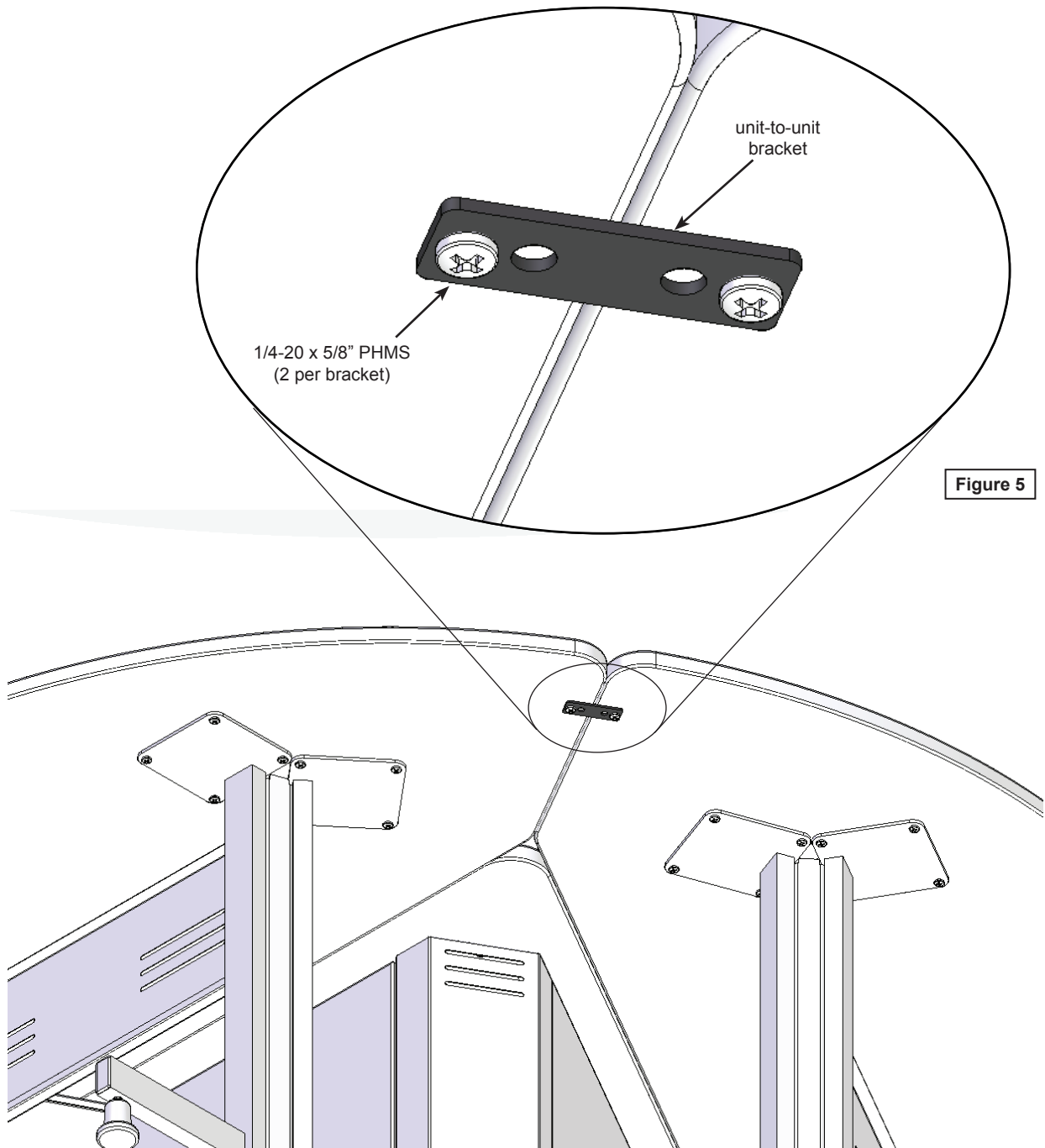

Figure 4

## 5. Connecting tables together (optional)

### A. Install brackets

1. To connect the tables together, place all three tables around the module.
2. Place the unit-to-unit bracket across the table seam and align with the worksurface mounting holes.
3. Attach with (2) 1/4-20 x 5/8" PHM screws. **Figure 5.**
4. Keep screws loose until all three tables are aligned and connected, then tighten securely.



# Warranty

## WE WILL MAKE IT RIGHT FOR YOU!

Spectrum is committed to provide complete customer satisfaction. Each of our products are manufactured from the best materials available and each product is stringently monitored throughout the production process through our P.A.C.E. program (Product Assurance to meet Customer Expectations). Our Customer Service Help Line 1-800-235-1262 is ready to provide immediate attention to any questions, comments or concerns. We are available to answer your calls Monday through Friday from 7 am to 5 pm CST, excluding observed holidays. In addition your product comments or concerns are welcome via e-mail at: [spectrum@spectrumfurniture.com](mailto:spectrum@spectrumfurniture.com).

## Warranty Statement

We guarantee all Spectrum products to be free of all defects in materials and workmanship, for the original owner, for a period of ten years. Any item deemed defective by Spectrum or the original manufacturer, under normal use conditions, will be repaired or replaced at Spectrum's discretion. This warranty applies to all products manufactured and distributed by Spectrum except the products listed below.

Items that have a varying warranty include, but are not limited to, the following:

- Adjustable Crank/Electric Desk Legs (1 yr)
- Flat Panel Desk Gas Cylinders (1 yr)
- Upholstered Soft-Goods (5 yrs)
- Adjustable Height & Stacking Chair Parts – including frames, gas cylinders, wood and plastic parts, and control handles (7 yrs)
- Adjustable Height & Stacking Chair Casters (2 yrs)
- Chair Upholstery & Textiles (2 yrs of normal use of Soft Goods, Adjustable Height, Stacking, Wood and Metal Chairs)
- Chair Upholstery - Graded-In Fabrics and C.O.M (no warranty)
- Height Adjustable Columns and Lifts (1 yr)
- General Use Casters (1 yr)
- Electrical – Electri-Pak, Power Communication Modules, and special order ECA electrical items (1 yr)
- Electrical - Power Strips & Electrical Timers (1 yr)
- Electrical Surge Suppressors (lifetime)
- Electrical - Retractable Power Cords (1 yr)
- Keyboard/Mouse Trays (1 yr)
- Flat Panel Monitor Arm – General Parts (5 yrs)
- Flat Panel Monitor Arm – Gas Cylinders (2 yrs)
- CRT Monitor Arm (1 yr)

Warranty is void if product is not used for its intended purpose or subjected to an unusual application, multiple-shift use, alteration, accident, abuse or abnormal wear and tear. Representations of colors on-line and in printed materials are meant to be a close reference to the actual colors but not an exact match. Slight variations in color and texture of wood stains, powder coating, laminates, fabrics and other materials are normal in different manufacturing lots; as such these variations are not considered defects.

**DESIGNED FOR INDOOR USE ONLY** – Unless specifically stated in the product specifications, Spectrum's products have been designed and constructed for indoor use only. Moving or using outdoors, or on excessively rough surfaces, may cause damage to the products and will void the warranty. If an outdoor application is desired please contact us to discuss potential custom design solutions.

**The warranty, as stated above, supersedes any previous warranties and is effective as of 9/1/2010**



# Touchboards

205 Westwood Ave, Long Branch, NJ 07740  
Phone: 866-94 BOARDS (26273) / (732)-222-1511  
Fax: (732)-222-7088 | E-mail: [sales@touchboards.com](mailto:sales@touchboards.com)

