



## 50T-IW 5-75 FtLb PreSet Single Setting Torque Wrenches







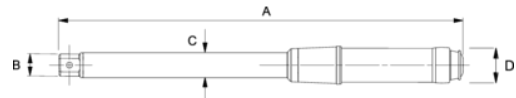

### PRODUCT DETAILS

- Factory Pre-Set models are set at the factory to the customer's specified torque setting, and are furnished with a Certificate of Calibration
- Please specify desired torque setting when order is placed
- Featuring a durable, non-slip cushion grip
- Uses universal round shank interchangeable heads
- Audible click and feel impulse torque control mechanism
- Tamper proof torque setting for production line use
- Accuracy:  $\pm 3\%$  CW of indicated value, in direction of torque indicator, from 20% to 100% of full scale
- Designed for use on production lines and other applications where a specific torque is required for repetitive operations
- Tamper proof torque setting for production line use Meets or exceeds ASME B107.300-2010

**▲ WARNING ▲**



PRODUCT ATTRIBUTES

Product	 lbf·ft		 N·m		<b>A</b>	<b>B</b>	<b>C</b>	<b>D</b>	 lb	
<b>50T-IW</b>	15-75 lbf·ft		20-102 N·m	0.425 in	11 in	0.68 in	0.96 in	1.4 in	1.4 lb	J