

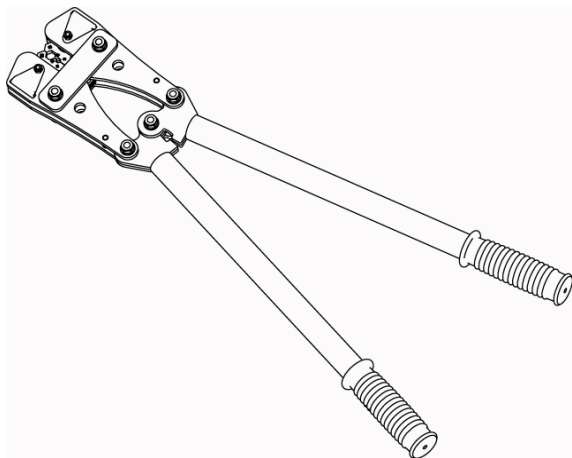

Instruction Manual for Item: 902-604 & 902-603

HeavyDuty Mechanical Hex Crimper 26"

HeavyDuty Mechanical Hex Crimper 15"



Due to continuing improvements, actual product may differ slightly from the product described herein.



Read this material before using this product.

Failure to do so can result in serious injury.

SAVE THIS MANUAL

SAVE THIS MANUAL

Keep this manual for the safety warnings and precautions, assembly, operating, inspection, maintenance and cleaning procedures. Write down the month and year of purchase. Keep this manual and the receipt in a safe and dry place for future reference.

IMPORTANT SAFETY INFORMATION

In this manual, on the labeling, and all other information provided with this product:



This is the safety alert symbol. It is used to alert you to potential personal injury hazards. Obey all safety messages that follow this symbol to avoid possible injury or death.



DANGER indicates a hazardous situation which, if not avoided, will result in death or serious injury.



WARNING indicates a hazardous situation which, if not avoided, could result in death or serious injury.



CAUTION, used with the safety alert symbol, indicates a hazardous situation which, if not avoided, could result in minor or moderate injury.

GENERAL SAFETY RULES

TO WORK IN SAFE CONDITIONS WITH THIS TOOL, IT IS IMPERATIVE TO READ THE DIRECTIONS CAREFULLY FOR USE AND TO FOLLOW THE INSTRUCTIONS. IF YOU DO NOT RESPECT THE INFORMATION WRITTEN IN THIS MANUAL THE WARRANTY MAY BE VOIDED.

1. Work area safety:

- a. Keep work area clean and clear.
- b. **Keep children and bystanders away while operating the mechanical crimping tool. Distractions can cause you to lose control.**
- c. Do not leave the tool in acidic, alkaline or other corrosive gases or liquids and do not operate or store the tool in high temperatures to avoid damage.

2. Personal safety

- a. Stay alert, watch what you are doing and use common sense when operating the tool. Do not use the tool when you are tired or under the influence of drugs, alcohol or medication. A moment of inattention while operating hydraulic tools may result in serious personal injury.
- b. Use safety equipment. Always wear eye protection. Safety equipment such as a mask, non-skid shoes, hard hat, or hearing protection will reduce the risk of personal injuries.
- c. Dress properly. Do not wear loose clothing or jewelry. Keep your hair, clothing and gloves away from moving parts. Loose clothes, jewelry or long hair can be caught in moving parts.
- d. Do not force the tool. Use the correct tool for your application. The correct tool will do the job better and safer at the rate for which it was designed.

- e. Store out of the reach of children and do not allow untrained workers who are unfamiliar with the mechanical crimping tool around this tool. This tool is dangerous in the hands of inexperienced users.
- f. Maintain your tool. Check for misalignment or binding of moving parts, breakage of parts and any other condition that may affect the mechanical crimping tool's operation. If damaged, have the mechanical crimping tool repaired before use. Many accidents are caused by poorly maintained tools.
- g. Use the Mechanical Crimping Tool, accessories and tool bits etc., in accordance with these instructions and in the manner intended for this tool, considering the working conditions and the work to be performed. Use of the Mechanical Crimping tool for operations alternate from those intended could result in a hazardous situation.

3. Service

Have your Mechanical Crimping Tool serviced by a qualified service technician using only identical replacement parts. This will ensure the safety of the Mechanical Crimping Tool is maintained.

SPECIFIC SAFETY RULES

1. Maintain labels and nameplates on the tool. These labels list important safety information. If unreadable or missing, contact the agent to replace.
2. This product is not a toy, keep away children.
3. Do not slide your fingers in the die profile.
4. Do not put your fingers in the head of the crimping tool.
5. Do not crimp on live cables or conductors.
6. Crimp Cu or Al conducting material only.
7. The warnings, precautions, and instructions discussed in this instruction manual cannot cover all possible conditions and situations that may occur. It must be understood by the operator that common sense and caution are factors which cannot be listed here but must be supplied by the operator.



SAVE THESE INSTRUCTION

UNDERSTAND YOUR TOOL

902-603/604 are mechanical crimping tools with a built-in, non-interchangeable rotating die. A lug or link is crimped when the dies comes together. The crimp is completed when the handles are completely closed, and the dies touch one another.

1. Specifications:

	902-603	902-604
Crimping range:	10 AWG – 1/0	10 AWG – 250 4/0
Length:	15in	26in
Tool weight:	3.3lbs	8.4lbs

2. Description of the components:

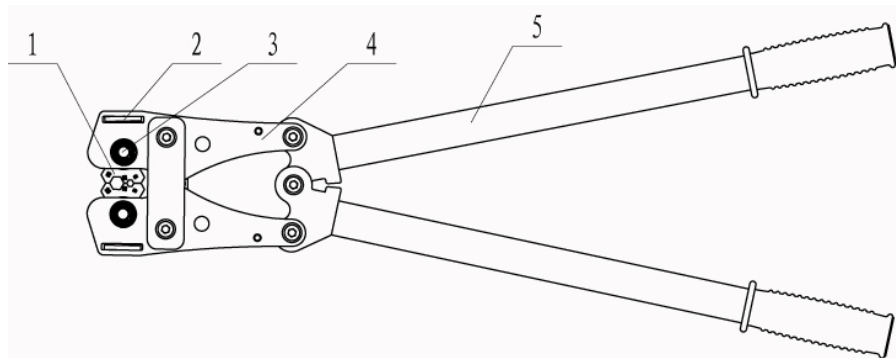

Table 1

Item No.	Description	Function
1	Rotary dies	Non-interchangeable die for crimping
2	Angle lock	Locks the head plate
3	Buttons	Activates/locks rotating die
4	Head plate	Supports the die and delivers power
5	Handles	Operation

OPERATING INSTRUCTIONS

Read the entire **SAFETY INFORMATION** section at the beginning of this manual including all text under subheadings before using this product.

⚠ DANGER

This tool is dangerous when the parts are broken.

1. To choose die size, open the handle completely, dies can be rotated by activating the spring-loaded buttons.
2. Press the buttons until the die can be rotated. Adjust the die to the required lug or link size.

⚠ CAUTION

The angle locks must be in starting position and the dies must be locked securely.

3. A lug or link is crimped when the dies come together.
4. The crimp is completed when the handles are completely closed and the dies touch one another

⚠ WARNING

Do not crimp lugs to electrical cables that are live or near live circuits. Note this tool is not insulated.

5. Open the handles to take out the crimped connector.

Refer to the illustrations for visual reference:

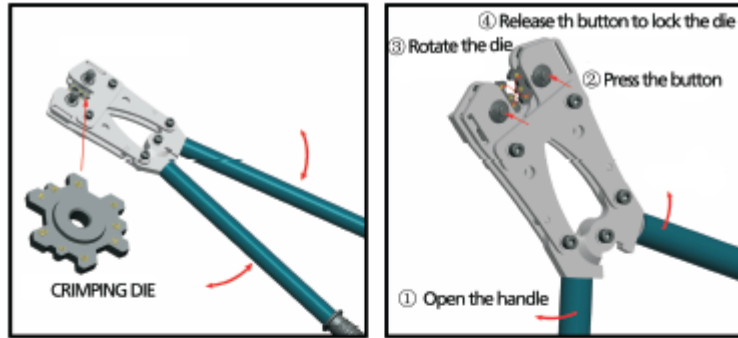

1.

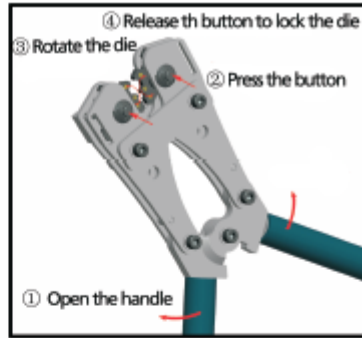

2.

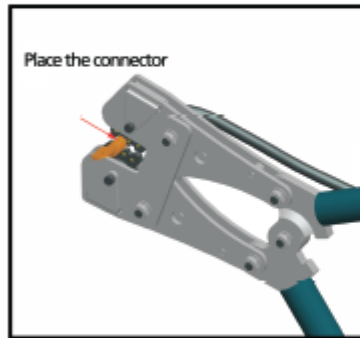

3.

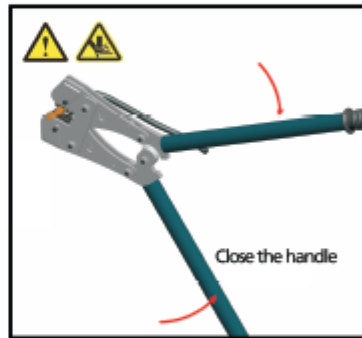

4.

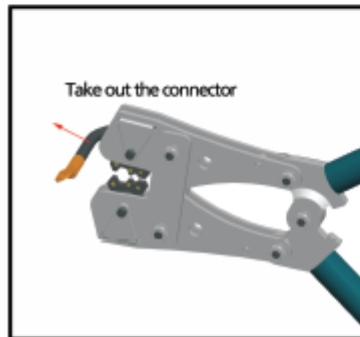

5.



6.

MAINTENANCE AND SERVICING

⚠WARNING

Damaged equipment may cause serious personal injury. Do not use damaged equipment. If abnormal noises or vibrations occurs, have the problem corrected before using.

1. **Before each use**, inspect the general condition of the tool. Check for loose screws, misalignment or binding of moving parts, cracked or broken parts, or any other condition that may affect safe operation.
2. **After using**, clean external surfaces of the tool with a clean, moist towel. Coat all metal surfaces of the tool, including the dies to avoid environmental damage. Store the tool in a dry environment.
3. Service to this tool should only be done by a qualified Service Technician.

LIMITED 5 YEAR WARRANTY

We make every effort to assure our products meet high quality and durability standards and warrants to the original purchaser that this product is free from defects in materials and workmanship for the period of five years from the date of purchase (90 days if used by a professional contractor or if used as rental equipment). This warranty does not apply to damage due directly or indirectly, to misuse, abuse, negligence or accidents, repairs or alterations outside our facilities, normal wear and tear, or to lack of maintenance. We shall in no event be liable for death, injuries to persons or property, or for incidental, contingent, special or consequential damages arising from the use of our product. Some states do not allow the exclusion or limitation of incidental or consequential damages, so the above limitation of exclusion may not apply to you. THIS WARRANTY IS EXPRESSLY IN LIEU OF ALL OTHER WARRANTIES, EXPRESS OR IMPLIED, INCLUDING THE WARRANTIES OF MERCHANTABILITY AND FITNESS.

To take advantage of this warranty, the product or part must be returned to us with transportation charges prepaid. Proof of purchase date and an explanation of the complaint must accompany the merchandise. If our inspection verifies the defect, we will either repair or replace the product at our election or we may elect to refund the purchase price if we cannot readily and quickly provide you with a replacement. We will return repaired products at our expense, but if we determine there is no defect, or that the defect resulted from causes not within the scope of our warranty, then you must bear the cost of returning the product.

The warranties give you specific legal rights and you may also have other rights which vary from different country.