

## TECHNICAL DATA SHEET Tapered, Absorbent Tipped Applicator

### Intended Use

Medical (General Hospital)

Characteristic	Specification				
Material Composition	<b>Shaft</b>	Wood Products - Paper (White) Birch			
	<b>Tip</b>	White Cotton 15 Grain USP Grade, Reconstituted, Bleached Cotton			
	<b>Adhesive</b>	Tip is secured to the handle with non-toxic, water soluble adhesive			
	<b>Binder</b>	Cotton bud is formed and held, using a non-toxic, water soluble adhesive applied evenly over the tip			
Description	Shaft covered with tapered soft fibrous material at one end (Refer to Appendix 1 for specific attribute)				
Color	<b>Bud</b>	White			
Dimension	<b>Swab</b>	Size		Length (L1)	
		3"		2.937"	
		6"		5.875"	
	<b>Shaft</b>	Diameter (D2)			
		0.085"			
	<b>Bud</b>	Length (L2)	Length (L3)	Diameter (D1)	Diameter (D3)
0.625"		0.300"	0.130"	0.040"	

### Measurement Diagram

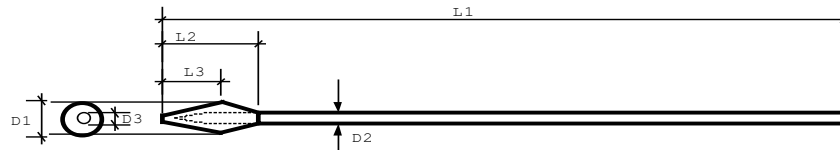

### Additional Information

Storage Condition	Country of Origin
Store at room temperature and dry condition	China

### Appendix 1 List of Item Codes and Attributes

## Appendix 1 (List of items)

AMD Medicom Inc.

Item Code	Description	Packaging Information	Size	Treatment
56122	SolonCare Cotton Tipped Applicators	100 Swabs/Bag, 10 Bags/Box, 10 Boxes/Case, 10 000 Swabs/Case	3"	Non-Sterile
56225	SolonCare Cotton Tipped Applicators	100 Swabs/Bag, 10 Bags/Box, 10 Boxes/Case, 10 000 Swabs/Case	6"	Non-Sterile