

PD3002 Multimedia Podium



New Feature:

Top rear removable, intended to easily be mounted in a wedge position or as flat large work surface, that can support monitors laptops and room control systems.



Flat Top Shown



The roll-about multimedia podiums are the ideal solution for distance education, electronic classrooms and corporate training sites. Model **PD3002** features a keyboard slide, a large pullout drawer with interior storage for additional electronic equipment.

Standard Features

- Large 41" W x 28.75" D work surface to accommodate monitors, laptops and presentation documents
- Slide out keyboard shelf
- Heavy-duty casters for easy maneuvering
- 1x PC/storage compartment 20" W x 28" D x 18.75" H with adjustable height shelf
- 1x 10 space EIA compliant 10U rack rails (10-32 screws)
- Large 24" W x 20.5" D x 7.625" H pullout drawer
- Door locks on all compartments
- Many laminate finishes to choose from
- Ships assembled

Options

- **C900S** 15" - 24" Adjustable monitor arm
- **PLM1022** 10" - 24" Monitor mount
- **MM1232** 12" - 32" Monitor mount
- **MCB1925** 19" - 25" Monitor/camera bracket
- **FM3** Count down timer/clock
- **MIC-18** MX418 S/C Shure Gooseneck microphone
- **LIGHT-18** Littlite Gooseneck
- **FAN** Quiet cooling fan
- **PB** Six outlet power bar with 10 ft. cord
- **PC-PATCH** 2x 110AC, RJ45, Phone, 2x USB
- **SF-PB3** Surface mounted 3-outlet 120V power bar
- **CUB3** Round cable well
- **CUB4** Black-B/Silver-S Power Panel
- **CUB5** Round cable well (Black or silver)
- **CUB8** Table top cable well
- **CHGQIW/B** Wireless charging station white or black. Only on flat cutout
- **CHGQI-DNGL** Dongle Lightning, USB Type-C, Micro-USB. Requires CHGQIW/B
- **RR10** 10U set of rack rails (Rear)
- **9031/9052** Metal shelf/drawer (check website)
- **SH-FL** Folding side shelf kit
- **9107** Lacing bar (19" long)
- **LEV4AX4** 4x Levelers for non-mobile applications
- **CUSTOM CUTOUT** Cutouts for electronics or other items specified by the customer

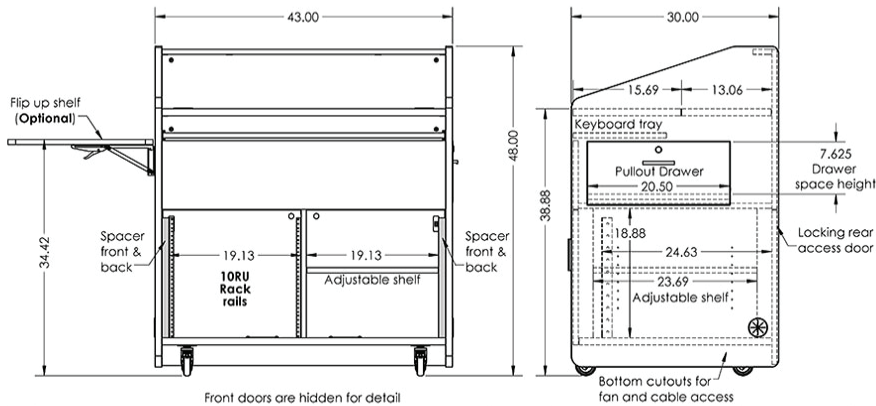
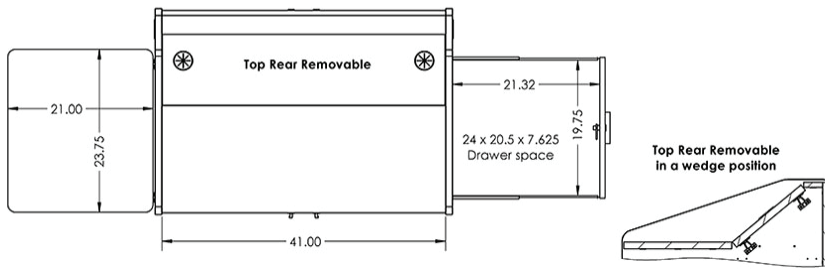

Specifications

Model: PD3002
Width: 43"
Depth: 30"
Height: 48"

Finishes



Other finishes are available with a longer lead time. Check website.

The information contained in this drawing is the sole property of Audio Visual Furniture International. Any reproduction in part or as a whole without the written permission of Audio Visual Furniture International is prohibited. AVFI can build or modify stock configurations to suit customer specifications. Please contact us to discuss how this service can help meet your needs. Some quantity restrictions may apply. Specification subject to change without notice. Computers, cameras, monitors, etc. are shown to illustrate product usage and are not included unless otherwise noted.