

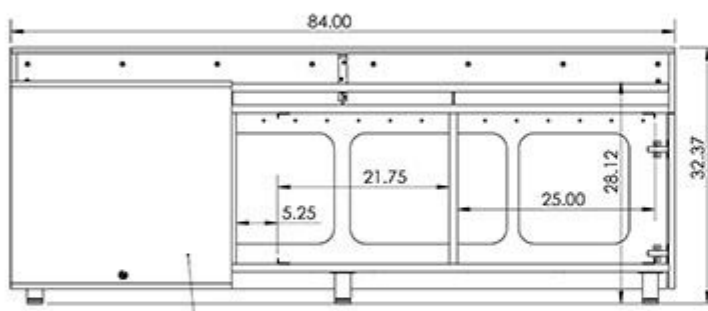

CR3-WM

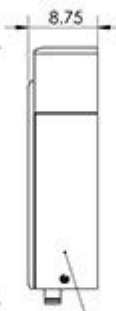

Lift-off front panels for full access.



Quick access side doors

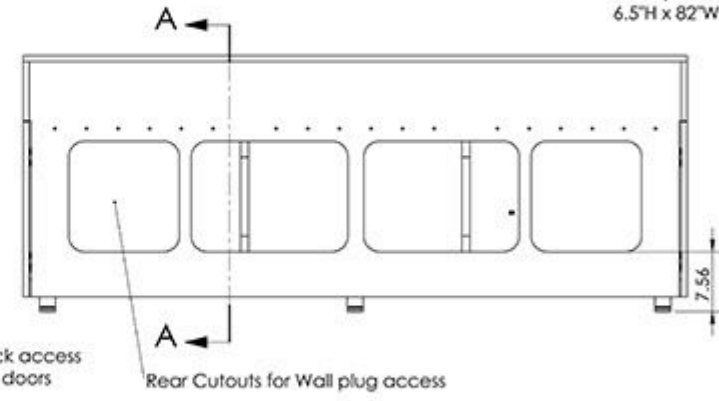

Rear Cutouts for Wall plug access

Adjustable Speaker bar Shelf
Max speakerbar size is:
6.5"H x 82"W x 6"D

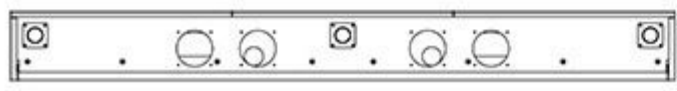
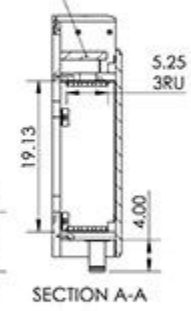

The information contained in this drawing is the sole property of Audio Visual Furniture International. Any reproduction in part or as a whole without the written permission of Audio Visual Furniture International is prohibited.
 * Specification subject to change without notice
 * AVFI can build or modify stock configurations to suit customer specifications. Please contact us to discuss how this service can help meet your needs. Some quantity restrictions may apply.
 * Computers, cameras, monitors, etc. are shown to illustrate product usage and are not included unless otherwise noted.