

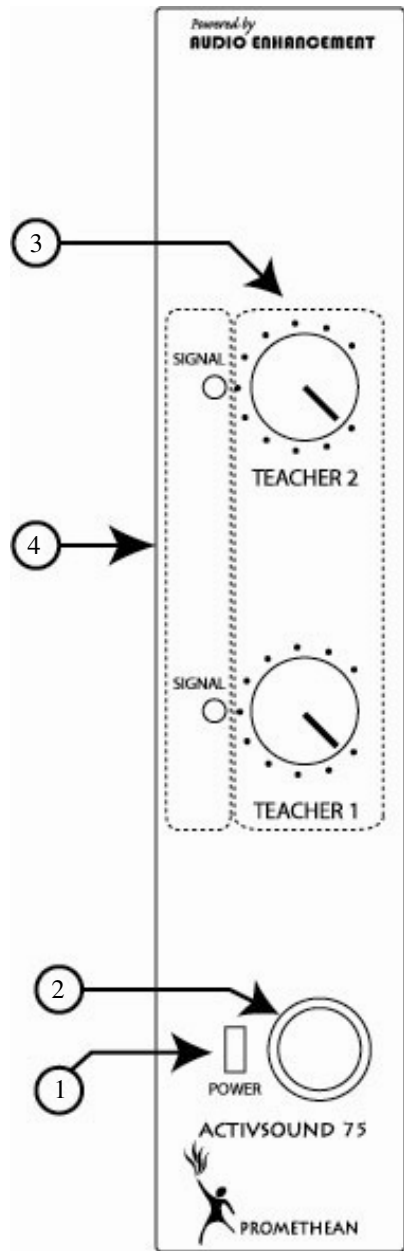

- (1) Power switch  
Turns the power on/off.
  - (2) Power indicator  
Lights "green" when the power is turned ON.
  - (3) Infrared Microphone Volume Control [Teacher 1 and 2]  
This control is used to adjust the level of the infrared microphones.
  - (4) Infrared Signal Indicator [ Teacher 1 SIGNAL, Teacher 2 SIGNAL ]  
Lights "green" when the infrared wireless receiver is receiving a signal.
- AC adapter  
Use the "3A-621DA24" AC adapter provided to supply power to the



Front Panel

# Operating Controls

## ActivSound 100

(1) Power switch. Turns the power on/off.

(2) Power indicator. Lights "green" when the power is turned ON.

(3) Infrared Microphone Volume Control [Teacher 1 and 2]. This control is used to adjust the level of the infrared microphones.

(4) Infrared Signal Indicator [ Teacher 1 and 2 ] . Lights "green" when the infrared wireless receiver is receiving a signal.

(5) Auxiliary Input volume TV/DVD and CD/MP3 ] . This Control adjusts the volume of the auxiliary inputs connected to the input terminals (11).

(6) Equalizer [ BASS, TREBLE ] . The Bass and Treble controls allow the teacher to have control over the quality of his or her voice. This adjustment is made by adjusting the "BASS" low-range or "TREBLE" high-range until the desired sound quality is achieved.

(7) Speaker output volume [ SPEAKER L, R ] . Output levels from each pair of speakers are adjustable with this volume

- AC adapter. Use the "3A-621DA24" AC adapter provided to supply power to the

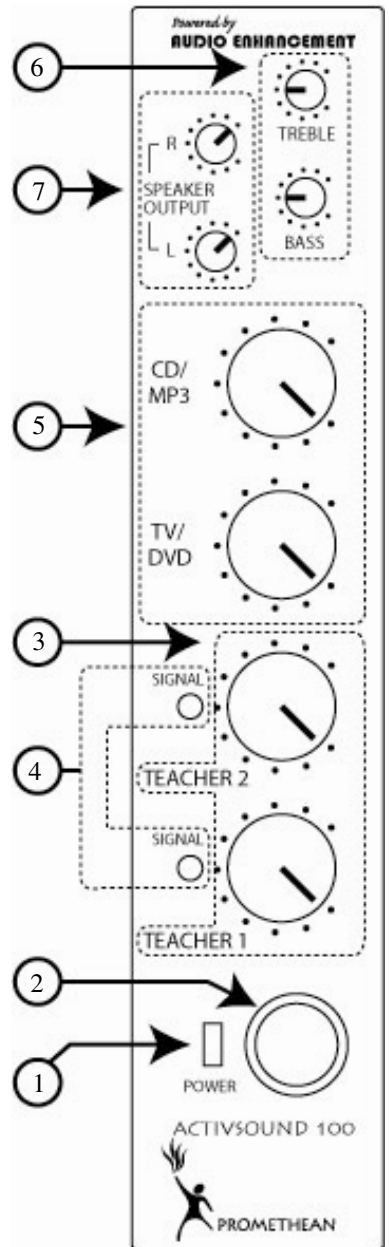

Front Panel

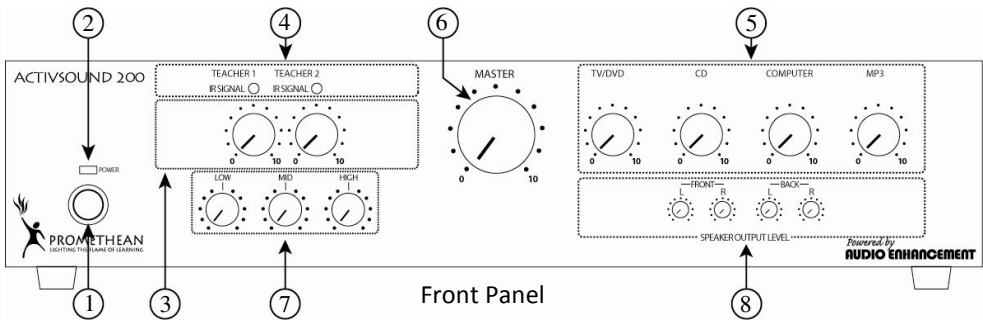

Front Panel

- (1) Power switch. Turns the power on/off.
- (2) Power indicator. Lights "green" when the power is turned ON.
- (3) Infrared Microphone Volume Control [Teacher 1 and 2]. This control is used to adjust the level of the infrared microphones.
- (4) Infrared Signal Indicator [Teacher 1 and 2]. Lights "green" when the infrared wireless receiver is receiving a signal.
- (5) Auxiliary Input volume [TV/DVD, CD, COMPUTER, and MP3]. This Control adjusts the volume of the auxiliary inputs connected to the input terminals.
- (6) Master volume. Adjusts overall level of the system.
- (7) Equalizer [LOW, MID, HIGH]. The 3-Band Equalizer allows the teacher to have control over the quality of his or her voice. This adjustment is made by adjusting "LOW", "MID", or "HIGH" controls until the desired sound quality is achieved.
- (9) AUX mute setting switch [OFF/LOW/HIGH] The Aux mute switch allows selection of whether or not the teachers voice mutes the auxiliary inputs when he or she speaks. The 'off' setting provides for no muting. The Low setting provides for a standard level of attenuation. The High setting provides for a faster attenuation. Set the switch to 'low' for normal operation.

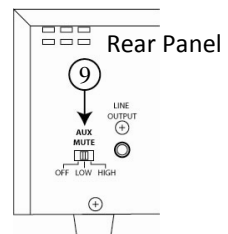

- AC adapter

Use the "3A-901DA24" AC adapter provided to supply power to the "ActivSound

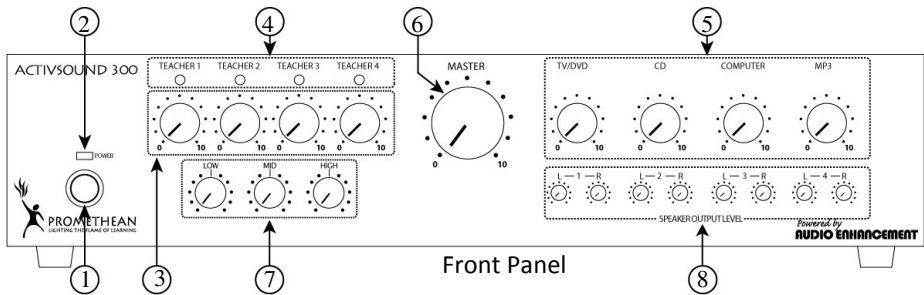

- (1) Power switch  
Turns the power on/off.
- (2) Power indicator  
Lights "green" when the power is turned ON.
- (3) Infrared Microphone Volume Control [Teacher 1 to 4]  
This control is used to adjust the level of the infrared microphones.
- (4) Infrared Signal Indicator [ Teacher 1 to 4 ]  
Lights "green" when the infrared wireless receiver is receiving a signal.
- (5) Auxiliary Input volume [ TV/DVD, CD, COMPUTER, and MP3 ]  
This Control adjusts the volume of the auxiliary inputs connected to the input terminals (11).
- (6) Master volume  
Adjusts overall level of the system.
- (7) Equalizer [ LOW, MID, HIGH ]  
The 3-Band Equalizer allows the teacher to have control over the quality of his or her voice. This adjustment is made by adjusting "LOW", "MID", or "HIGH" controls until the desired sound quality is achieved.
- (8) Speaker output volume [ L/R -1, L/R-2, L/R-3, L/R-4 ] The level from each speaker can be independently adjusted with these controls .
- (9) AUX mute setting switch [ OFF/LOW/HIGH ] The Aux mute switch allows selection of whether or not the teachers voice mutes the auxiliary inputs when he or she speaks. The 'off' setting provides for no muting. The Low setting provides for a standard level of attenuation. The High setting provides for a faster attenuation. Set the switch to 'low' for normal operation.

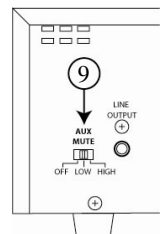

- AC adapter

Use the "PW-150A2-1Y-240E" AC adapter provided to supply power to the "ActivSound 300 amplifier".

- (1A) Momentary power switch— Push to Talk.
- (1B) Continuous power switch— Slide up to lock on and then talk.
- (2) Power indicator —lights "green" when the power is turned either momentary or continuous.
- (3) Microphone (audio pickup) - speak into this part of the microphone.
- (4) Infrared signal emitters — the infrared signal is broadcast from multiple infrared signal emitters.
- (5) Battery case— Slide the battery cover down to remove.
- (6) Charging terminal—charging input for charging the batteries with the AC Adapter or the battery charger
- (7) Charging indicator—The charging indicator provides a "red" light to indicate the following conditions when the power switch is off and the microphone is being charged.

- ⊙ Charging: Flashing slowly

- ⊙ Finished Charging: Continuously ON

- ⊠ Charging error (trying to charge an alkaline battery) : Flashing very fast

- (8) External Auxiliary input terminal (on the side) - Used to connect a CD or MP3 player or other device. Allows the user to wirelessly connect a source to the system.
- (9) Single "AA" NiMH rechargeable battery or non-rechargeable Alkaline battery.
- (10) Channel assignment switch. Channel switch (inside the battery case) - Set the channel of the infrared wireless microphone to the desired channel.

- ⊙ Channels 1 or 2 for use with Actisound 75, 100, or 200. Channels 1 through 4 for use with Actisound 300.

- Uses two Panasonic NiMH AA rechargeable batteries.
  - Use the specialized battery charger "\*\*\*\*\*" or the AC adapter for charging "\*\*\*\*\*" the NiMH batteries.
- Charging time is approximately four hours but may vary depending on the conditions of the battery.



# Operating Controls

## TEACHER MICROPHONE



- (1) Power/Mute switch: Turns the power on/off. Press and hold to turn on/off. Press momentary to mute.
- (2) Power indicator—Lights green when the power is turned ON.
- (3) Microphone (audio pickup) - Speak into this part of the microphone.
- (4) Infrared signal emitter The infrared signals are broadcast from multiple IR signal emitters.
- (5) Battery case cover (on the back) Slide it down to remove. Requires 1 "AA" NiMH rechargeable battery or 1 non-rechargeable Alkaline battery.
- (6) Charging terminal Charging input for charging the batteries with the AC charger.
- (7) Charging indicator—The charging indicator provides a "red" light to indicate the following conditions when the power switch is off and the microphone is being charged.
  - ⊙Charging: Flashing slowly
  - ⊙Finished Charging: Continuously ON
  - ⊠ Charging error (trying to charge an alkaline battery) : Flashing very fast
- (8) External Auxiliary input terminal (on the side)  
Used to connect a CD or MP3 player or other device. Allows the user to wirelessly connect a source to the system.
- (9) External Microphone input accepts lavalieri or headband microphones.
- (10) Channel assignment switch. Channel switch (inside the battery case) - Set the channel of the infrared wireless microphone to the desired channel.
  - ⊙ Channels 1 or 2 for use with Actisound 75, 100, or 200. Channels 1 through 4 for use with ActivSound 300.
- (11) UP/DOWN Remote volume control buttons for Own (Teacher), Other(Student), and Line sources.
- (12) SELECT button –Selects which source will be controlled by the remote buttons (Own, Other, Line).
- (13) Source SELECT indicators. Show which source (Own, Other, Line) is currently selected for remote control.
- (14) 'F' Function button—Reserved for future implementation.

## Charging the Battery

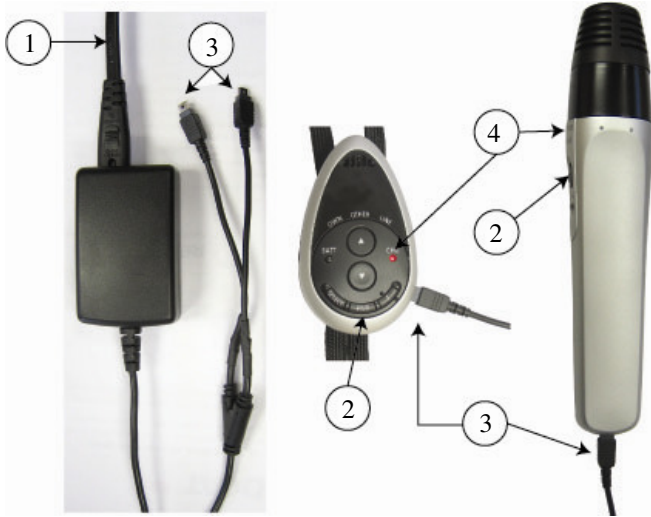

1. Connect power cord (1) to the AC mains.
2. Turn "off" the power switch (2).  
Check that the power indicator (2) has gone out.
3. Connect the charging plug(s) (3) to the microphone(s)
4. The red Charging LED (4) should start flashing. It will stop flashing and remain on when charging is completed.



## Operating Controls

## ActivSound ONE

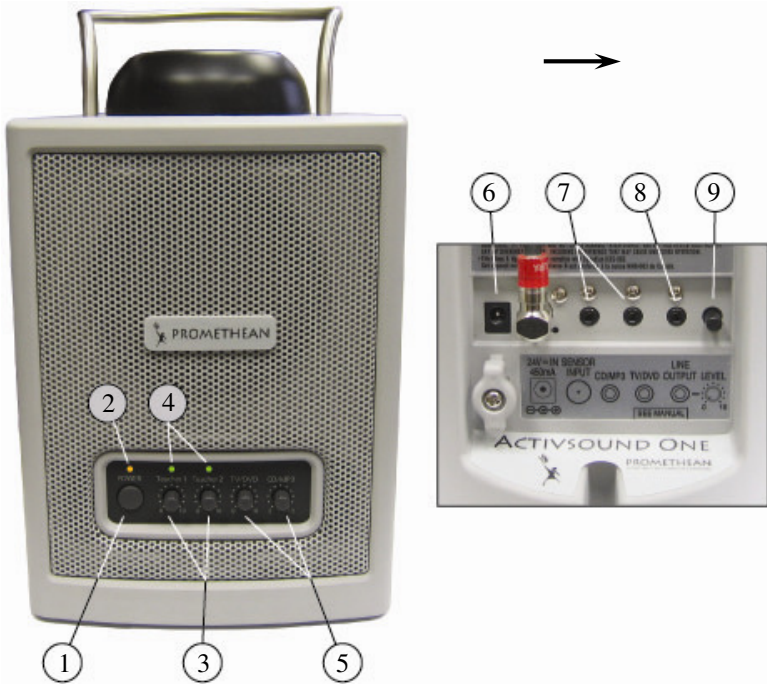

- (1) Power switch. Turns the power on/off.
- (2) Power Indicator. Lights “amber” when the power is turned ON.
- (3) Infrared Microphone Volume Control [Teacher 1 and 2]. These controls are used to adjust the level of the Teacher/Student microphones.
- (4) Infrared Signal Indicator [Teacher 1 and 2]. Lights “green” when the infrared wireless receiver is receiving a signal from a microphone.
- (5) Auxiliary Input volume Controls [TV/DVD and CD/MP3]. These controls adjust the volume of the auxiliary inputs connected to the input connectors.
- (6) Connector for AC adapter. Use adapter “3A-621DA24”.
- (7) Auxiliary line level input connectors. 3.5mm stereo mixed-to-mono.
- (8) Line level output. 3.5mm stereo (mono source).
- (9) Line level output level control.

## Teacher's Check List



**TURN** on the transmitter (green LED will indicate power, red LED indicates that batteries need to be recharged).

**POWER** on the amplifier (red LED will indicate power; green LED by teacher volume control indicates receipt of IR signal).

**TRANSMITTER/MICROPHONE** needs to be worn in a way as to have a clear path to the receiving sensors.

**POSITION** the transmitter/microphone six inches from your mouth.

**RELAX** and speak at a comfortable level. Remember, you do not have to project your voice.

**CHARGE** the batteries every day. Ni-MH batteries will last for 6-8 hours of continuous use. Recharge for at least 12 hours (overnight). (Ni-MH-Batteries need to be replaced annually.)

**HAVE ANOTHER PERSON MONITOR** your amplified voice from time to time to make sure it is not too loud.

# Troubleshooting

## Transmitter is not working

Is the battery light on your transmitter green?

**YES** – Is the red light on your external sensor on?

**YES** – Is there anything in the room blocking the sensor?

**YES** – Move the obstruction and retry. If the problem is not fixed please contact Promethean .

**NO** – Is there anything covering the transmitter?

**YES** – Free the transmitter from any obstructions.

**NO** – Contact Promethean .

**NO** – Contact Promethean for assistance.

**NO** – Have your batteries been charged overnight?

**YES** – Are your batteries over 1 year old?

**YES** – Try a new set of batteries. If the problem persists contact Promethean .

**NO** – When charging, verify the charger is fully plugged into outlet. If the problem persists contact Promethean .

**NO** – Charge the batteries overnight.

# Troubleshooting

## No Audio

Is your power supply plugged into the amplifier/receiver and the wall outlet?

**YES** – Is the power switch set to “On” and the indicator light red?

**YES** – Is the teacher transmitter turned on with a green battery light?

**YES** – Is the green indicator light on the amplifier/receiver for Teacher 1 or 2 on?

**YES** – Try another transmitter in your room to determine if it works and contact Promethean .

**NO** – Verify if a red light is showing on the dome sensor and contact Promethean .

**NO** – Are your batteries fully charged?

**YES** – If the batteries are more than 1 year old please replace the batteries. If the problem persists contact Promethean for assistance.

**NO** – Charge the batteries overnight.

**NO** – Will other items power up in that outlet?

**YES** – If available try another outlet. If the problem persists contact Promethean .

**NO** – Contact the school

**NO** – Plug in the amplifier/receiver to the wall outlet.