

316 STAINLESS STEEL HINGE PIN

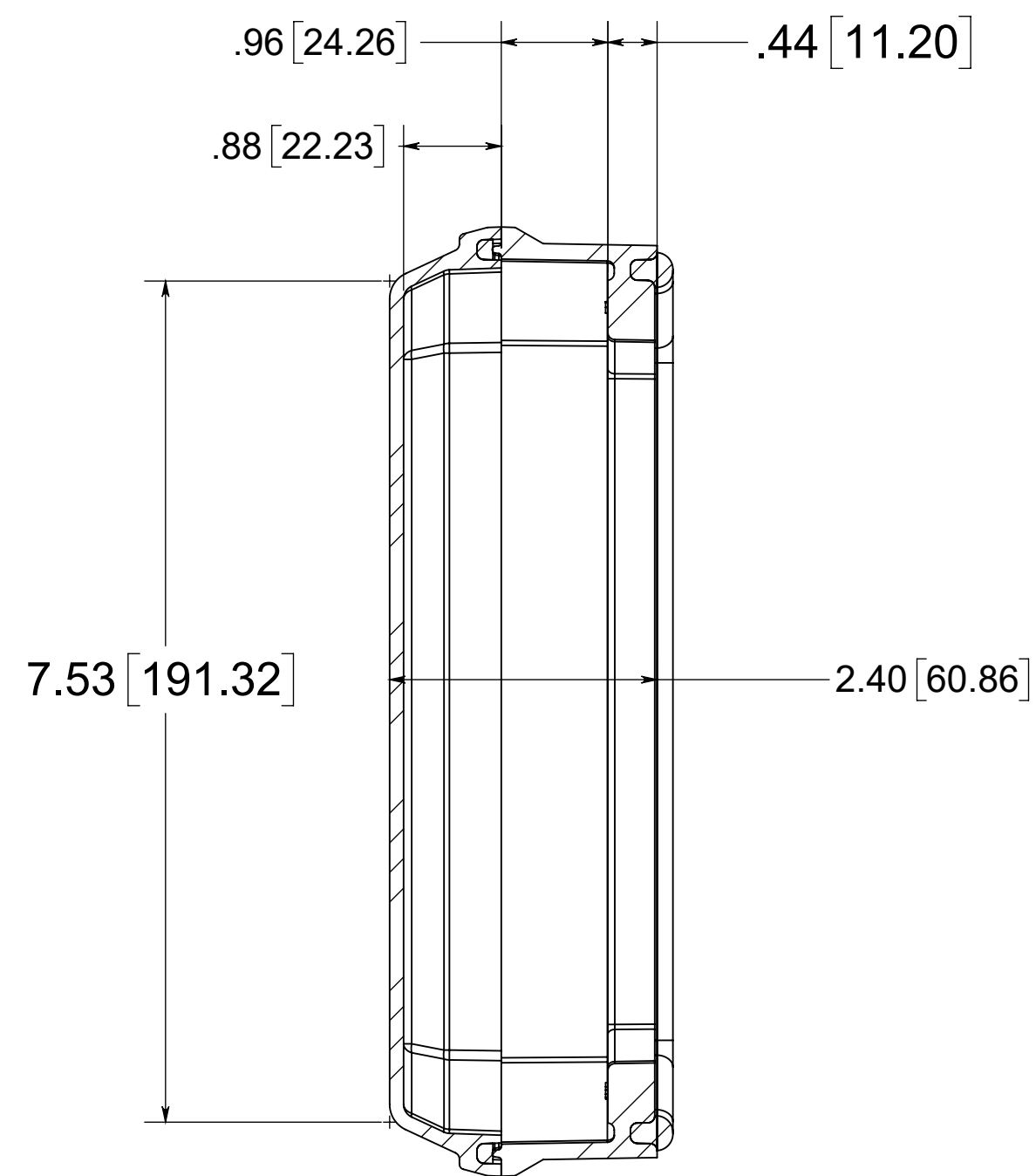

SECTION A-A

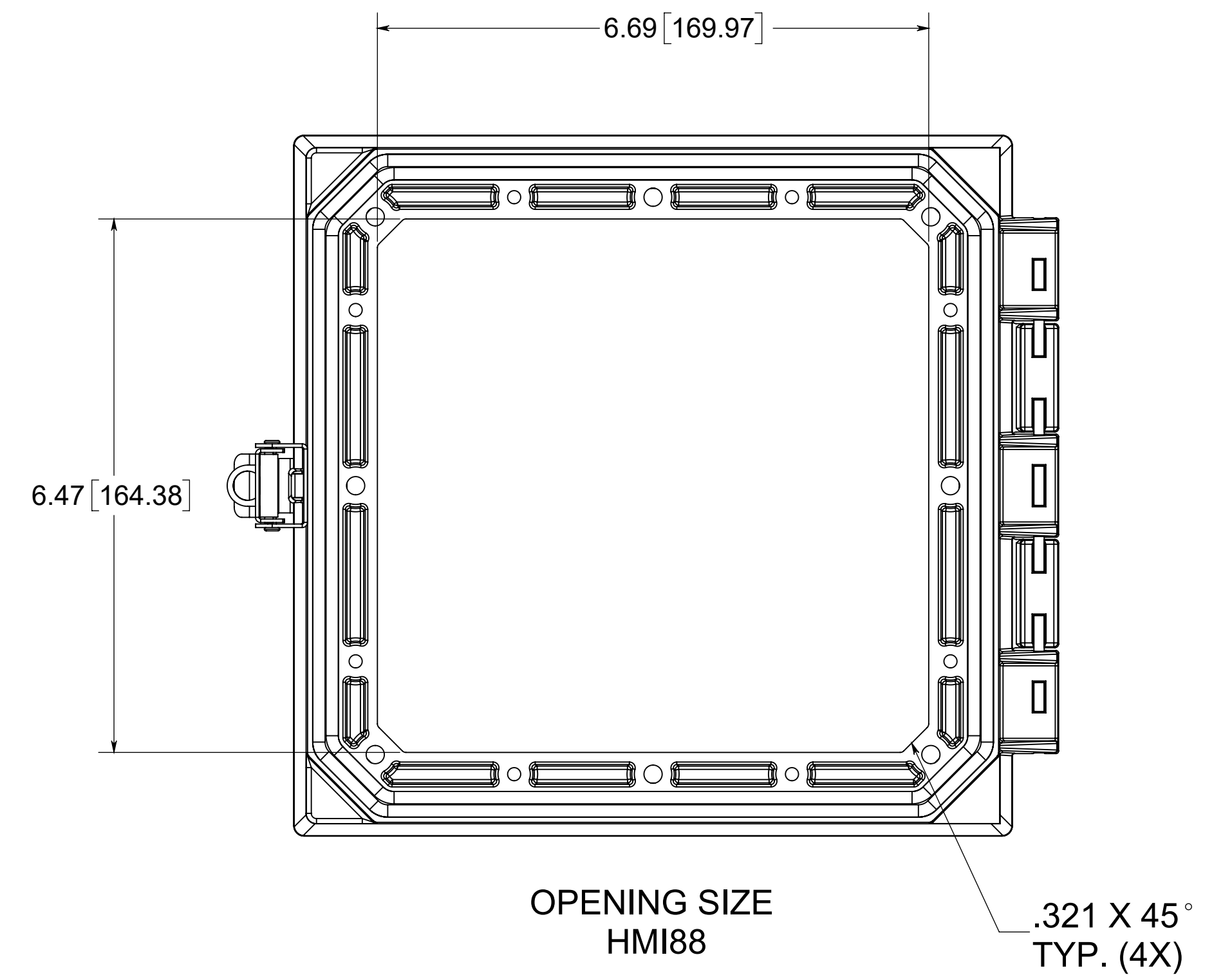

OPENING SIZE HMI88

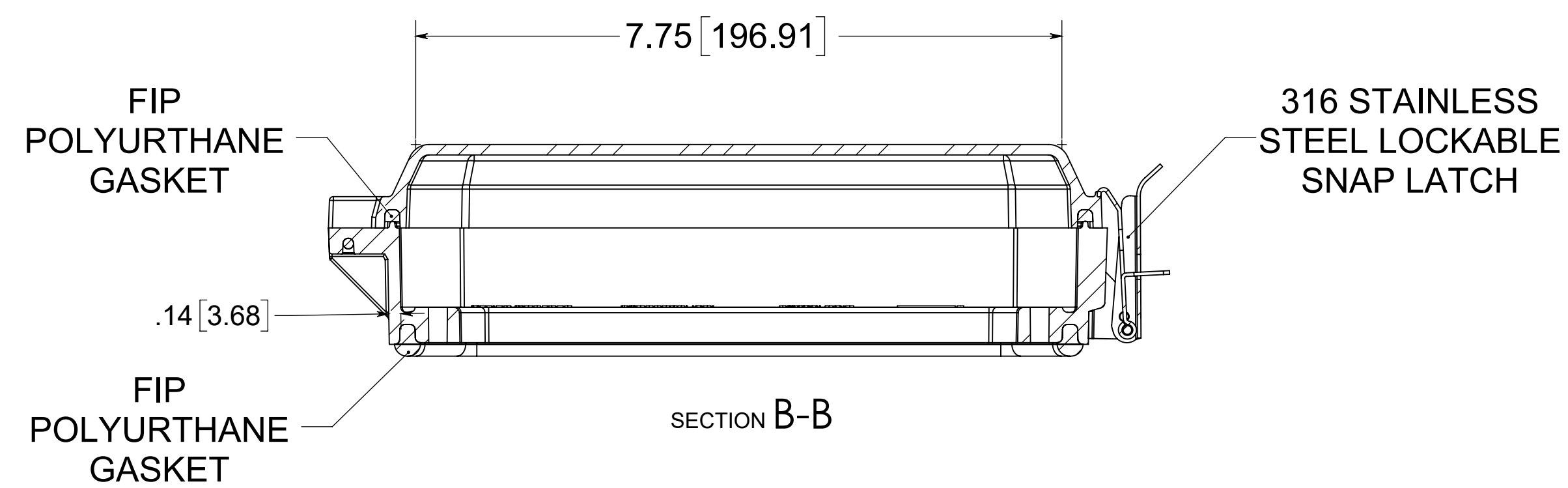

SECTION B-B

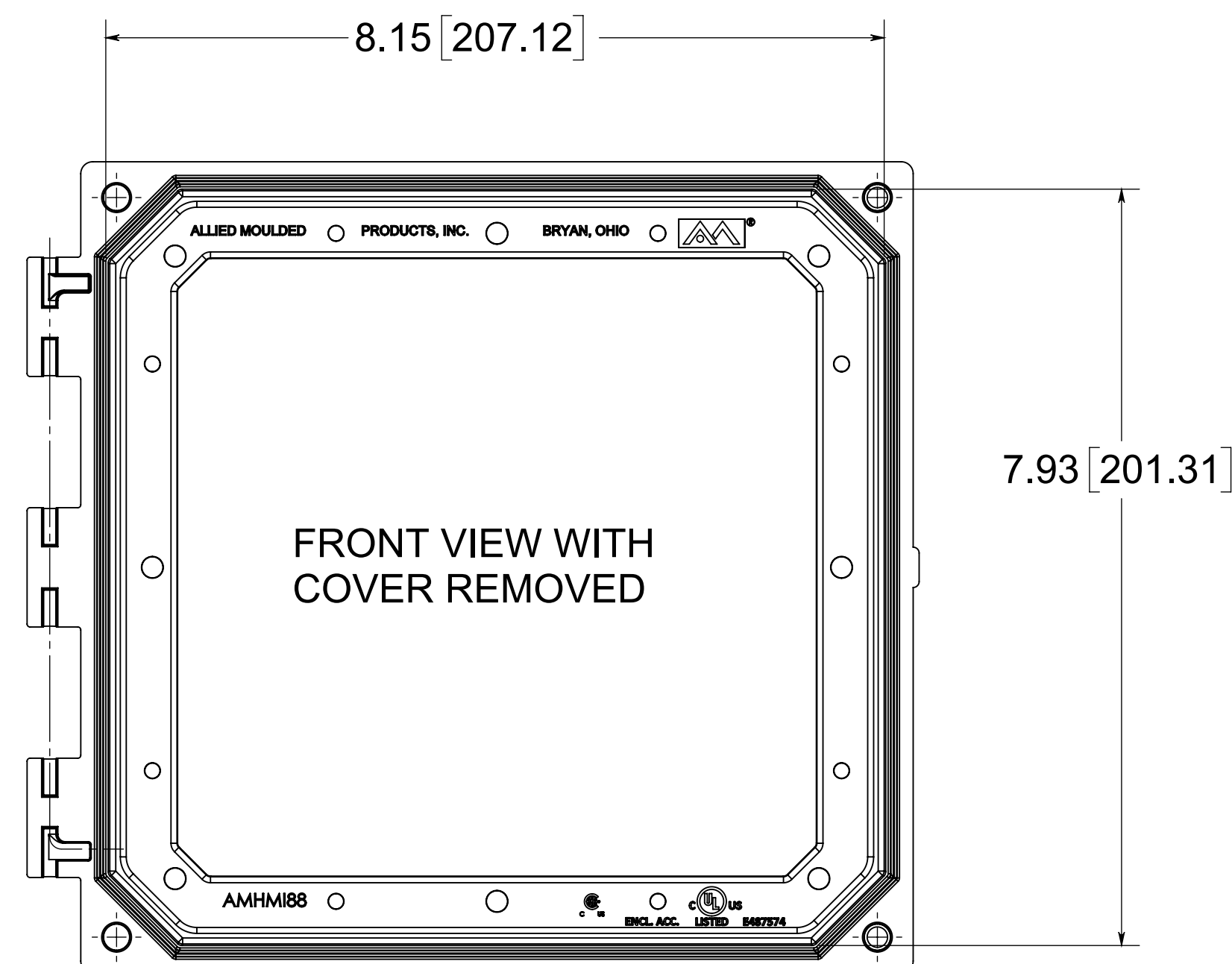

FRONT VIEW WITH COVER REMOVED

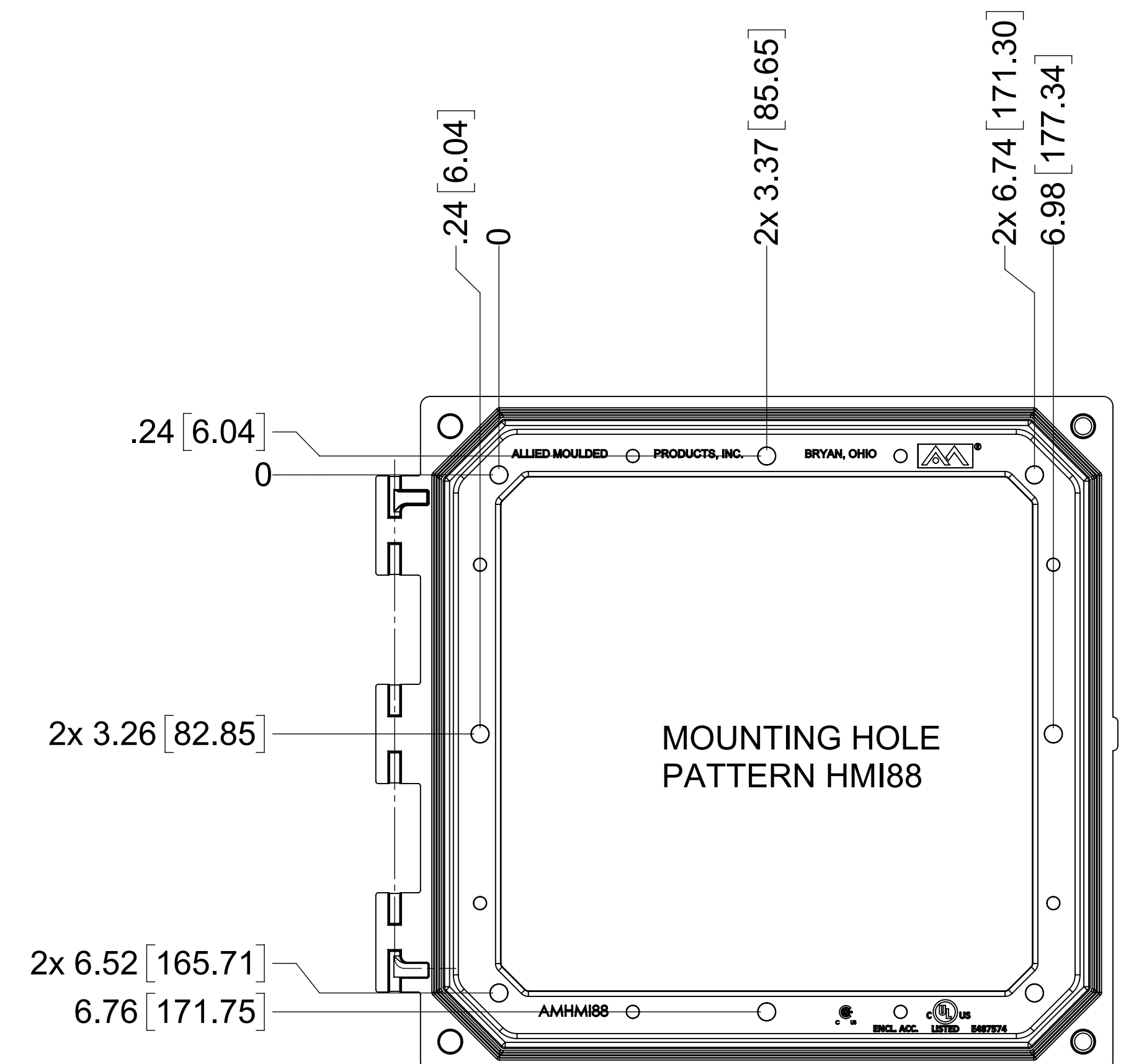

MOUNTING HOLE PATTERN HMI88

MATERIAL:
 BOX- INJECTED POLYCARBONATE
 STANDARD COVER- INJECTED POLYCARBONATE
 CLEAR COVER- INJECTED POLYCARBONATE

NOTE:
 1. DATA SUBJECT TO CHANGE
 2. WILL FIT ALLIED MOULDED ENCLOSURES SIZES 10x12 AND LARGER

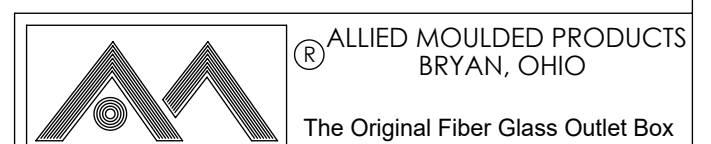

CONFIDENTIAL
 THIS MATERIAL IS OWNED BY THE ALLIED MOULDED PRODUCTS COMPANY, IS DISCLOSED IN CONFIDENCE, AND IS NOT TO BE REPRODUCED OR DISTRIBUTED WITHOUT PRIOR WRITTEN PERMISSION FROM ALLIED MOULDED PRODUCTS.
 © Allied Moulded Products, Inc. All Rights Reserved

Description
Access-Indus
 Part No.
AMHM188CCL