

AC-LOCKER SERIES

SECURE RFID CHARGING LOCKERS



AC-LOCKER-12-RFID

AC-LOCKER-24-RFID

Charging

Each bay offers:

Two AC outlets, up to 100 W power adapter on 12 Bay and up to 60 W adapter on 24 Bay.
Two USB charging ports, up to 2.4 A each.

Electrical and Operating Requirements

The AC-Locker has been engineered to charge all connected devices from a single 15 A AC circuit.

Maintenance-free locks powered by the internal power supply.



IMPORTANT

THE ELECTRICAL SYSTEM IS DESIGNED TO HANDLE A MAXIMUM OF 1500 WATTS. If wattage exceeds 1500W at one time, charging system may not operate correctly. Remove devices until the total wattage is under 1500W.



WARNING

- THIS IS NOT A TOY. CHILDREN SHOULD NEVER MOVE OR CLIMB THE LOCKER!
- NEVER climb, sit on or tilt Locker.
- DO NOT touch any part of the electrical system while plugged in.
- DO NOT place liquids on or near the Locker.
- DO NOT use an extension cord with this unit.
- DO NOT plug in the cart if the receptacles or power cords are broken, cracked, torn or inadequately repaired.
- Repairs should always be performed by a qualified electrician.

For warranty claims, please have the following information ready, then visit www.anywherecart.com/support to create a help ticket.

Serial Number:

Software Version:

Date Of Purchase:

Reseller Name:

PO Number:

Factory Default Admin Password: contact support@anywherecart.com for your Factory Default Password.

Your New Admin Password: _____

TABLE OF CONTENTS

Product Overview.....	5
Unboxing.....	6-7
Assembly (12 Bay).....	8-15
Assembly (24 Bay).....	16-23
Setting Up Cables.....	24-28
Mounting to Wall.....	29
Operation with ID Card.....	30
Operation with Password.....	31
Changing Admin Password.....	32
Reviewing Access Data.....	33
Adjusting Single Bay Settings.....	34
Admin Options.....	35
Troubleshooting.....	36





Front (closed)

- 1 Upper Locker Cabinet
- 2 Upper Access Door
- 3 Lower Locker Cabinet
- 4 Lower Access Door



Front (open)

- 5 Individual Locker Bay
- 6 Power Module
(2 USB + 2 Standard Outlets)



Control Panel

- 7 Touch Screen Display
- 8 Upper Access Door Lock
- 9 Card Reader
(RFID or Swipe)



Back

- 10 Handles
- 11 Power Cord

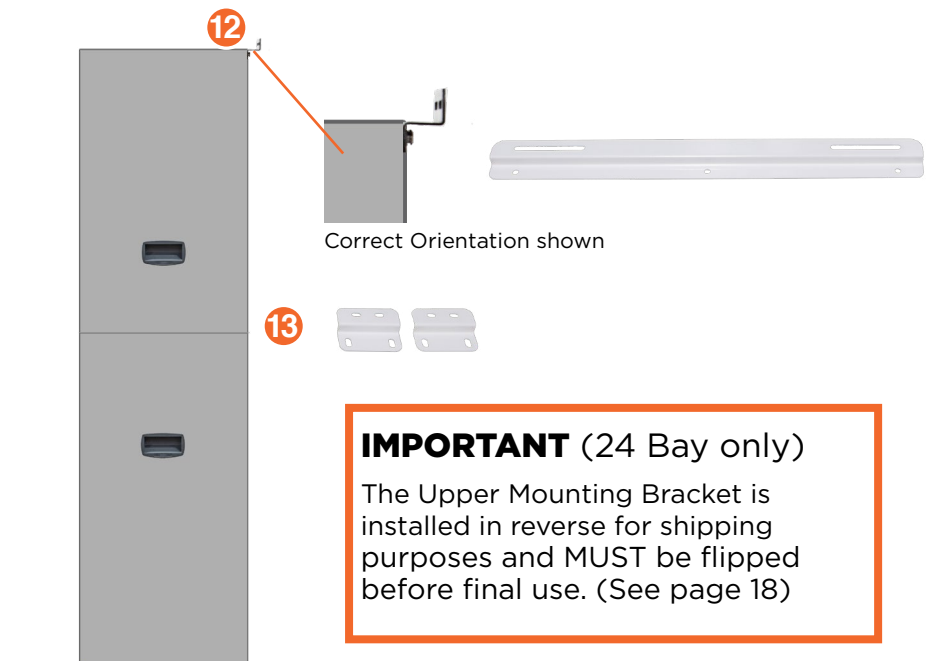

Side

- 12 Upper Mounting Bracket
- 13 Middle Mounting Brackets

IMPORTANT (24 Bay only)

The Upper Mounting Bracket is installed in reverse for shipping purposes and **MUST** be flipped before final use. (See page 18)

- 1 Remove the strapping with scissors or plier cutters. Do not use a box cutter.



- 2 Lift and Remove the top wood sheet, top cardboard lid and foam. Then remove corrugated cardboard from inner sides.



- 3 With the help of an assistant, gently lift the main box up and out of the way.



- 4 Remove all other packaging and inspect for damage to the Upper or Lower Cabinets.



- 1 On the Lower Cabinet, find and remove the keys attached to the power cord.



- 2 On the Upper Cabinet, insert key into Access Door Lock and open door.



- 3 Press down on the uppermost top release lever for Bay #1. A Hex wrench and screen protecting film are located inside.

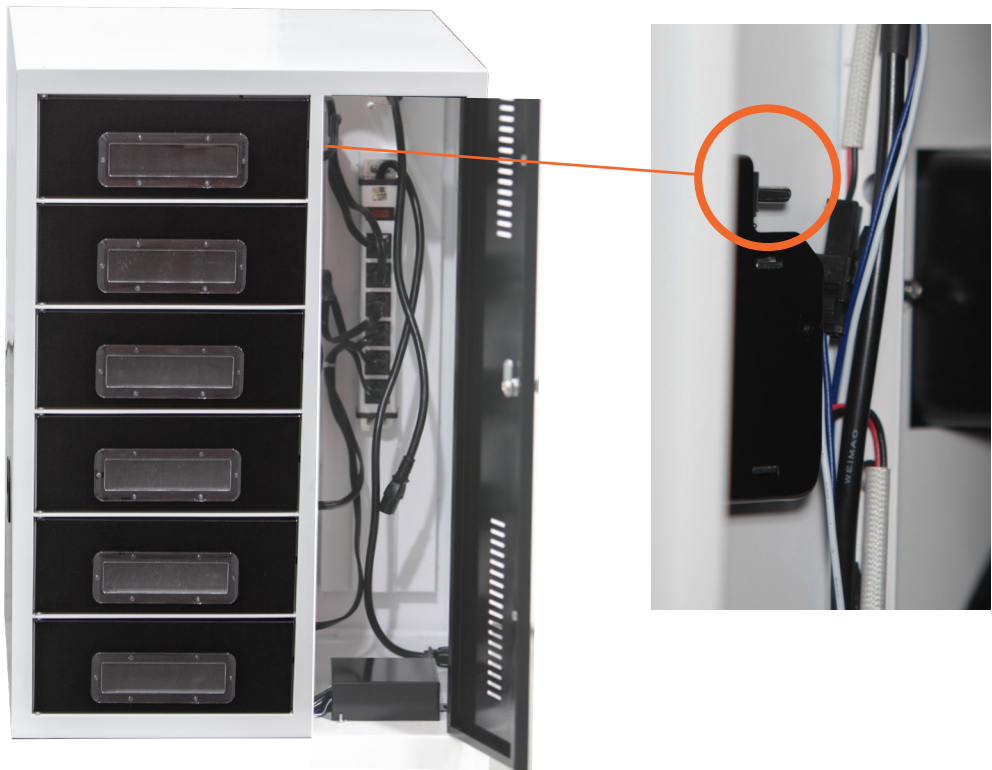

- 4 Locate the plastic bag containing the (1) Upper Mounting Bracket and (2) Middle Mounting Brackets

Upper Mounting Bracket



Middle Mounting Brackets



- 5** Using the Hex wrench, remove the (3) Hex bolts from the top, back edge of the Upper Cabinet.

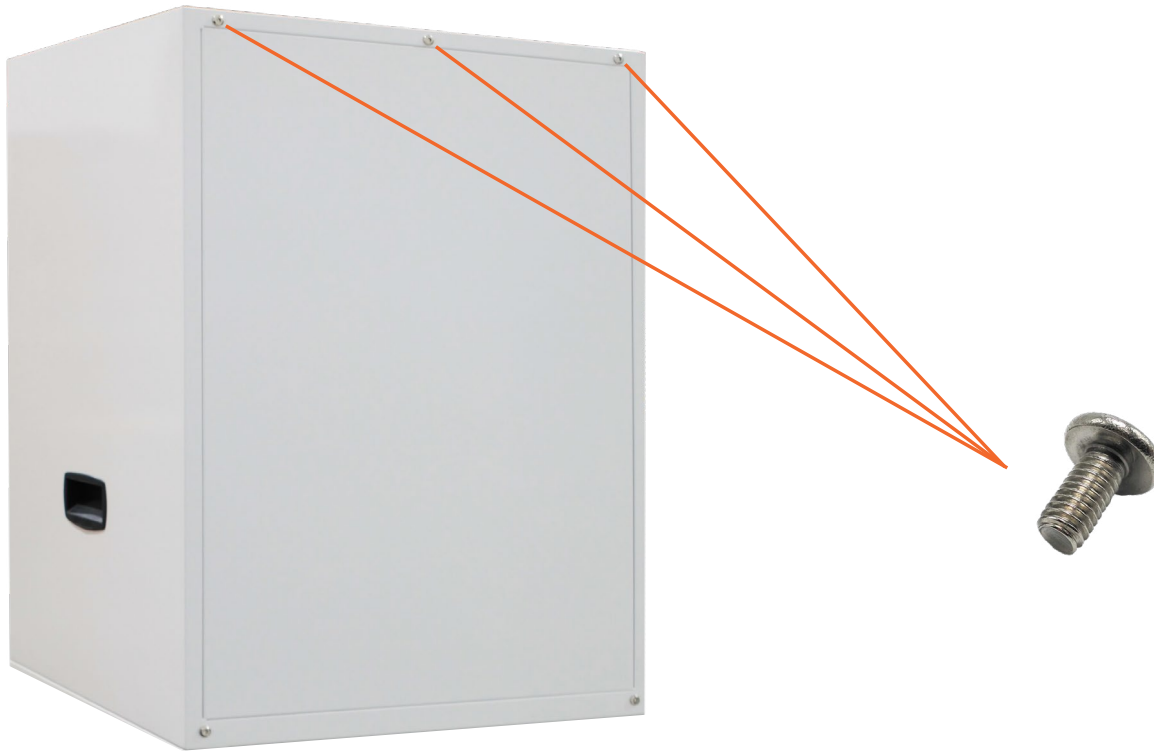

- 6** With the Upper Mounting Bracket in hand, align the 3 round holes with the Upper Cabinet holes, making sure the slotted edge protrudes outward. Then, using the Hex wrench, install and tighten the (3) Hex bolts.



- 7 On the Lower Cabinet, locate the Hex bolt from the front edge.

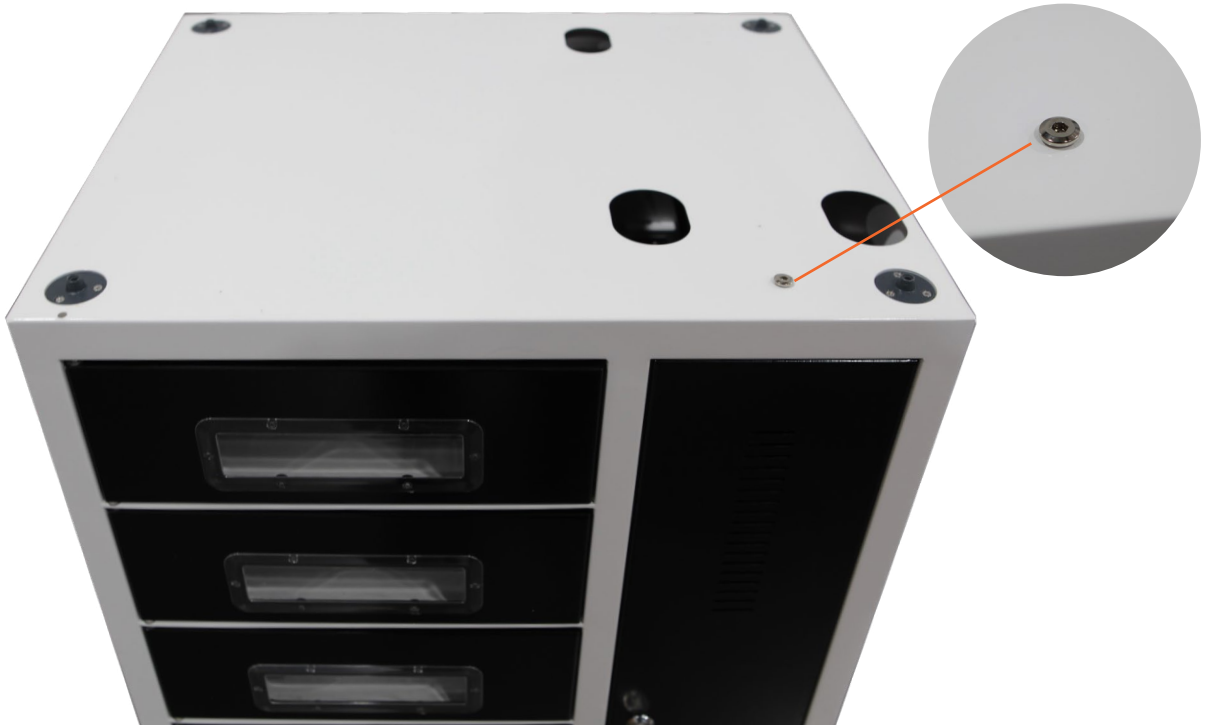

- 8 Using the Hex wrench, remove the Hex bolt from the front edge of the Lower Cabinet and set aside. **IMPORTANT** Do Not Discard the bolt.



- 9** Using the side handles, carefully lift the Upper Cabinet on top of the Lower Cabinet. For your safety, always move these pieces with the help of 1 or 2 assistants.



- 10 On the Upper Cabinet, insert key into Access Door Lock and open door.



- 11 Using the Hex bolt from step 8, secure both Cabinets together by inserting it into the Lower Cabinet threaded hole at the bottom, then tightening it using the Hex wrench.

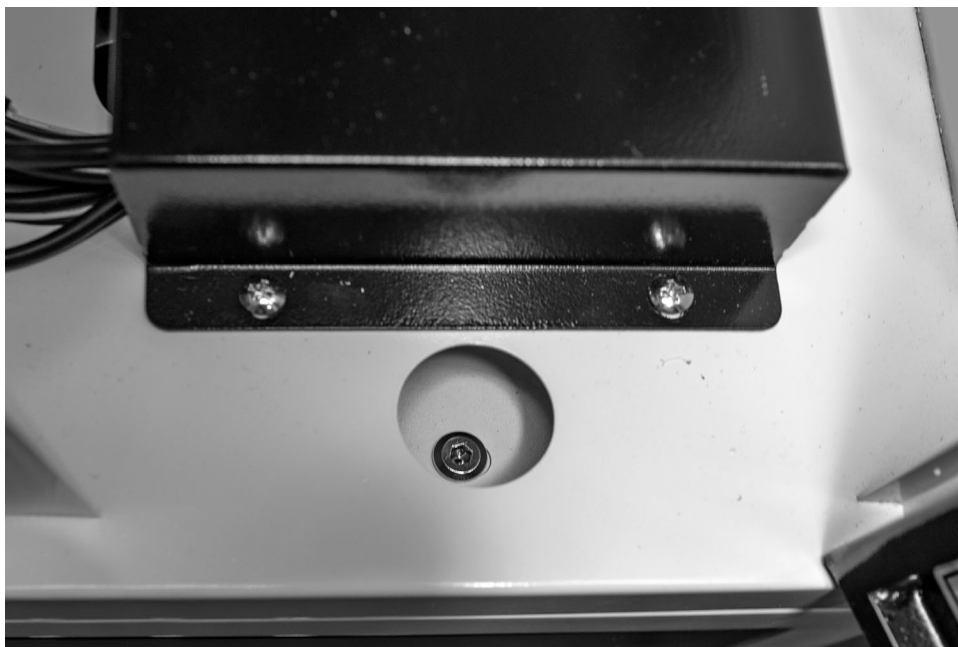

- 12** Working in the back, use the Hex wrench to remove the (4) Hex bolts from the middle left and middle right edges.



- 13** With (1) Middle Mounting Bracket in hand, align the 2 narrow holes with the holes in the cabinets, making sure the slotted edge protrudes outward. Then, using the Hex wrench, install and tighten the (2) Hex bolts.

Middle Mounting Bracket



- 14** Working on the opposite side, align the other (1) Middle Mounting Bracket, then install and tighten the (2) Hex bolts.



- 1 On the Lower Cabinet, find and remove the keys attached to the power cord.



- 2 On the Upper Cabinet, insert key into Access Door Lock and open door.



- 3** Press down on the uppermost top release lever for Bay #1. A Hex wrench and screen protecting film are located inside.

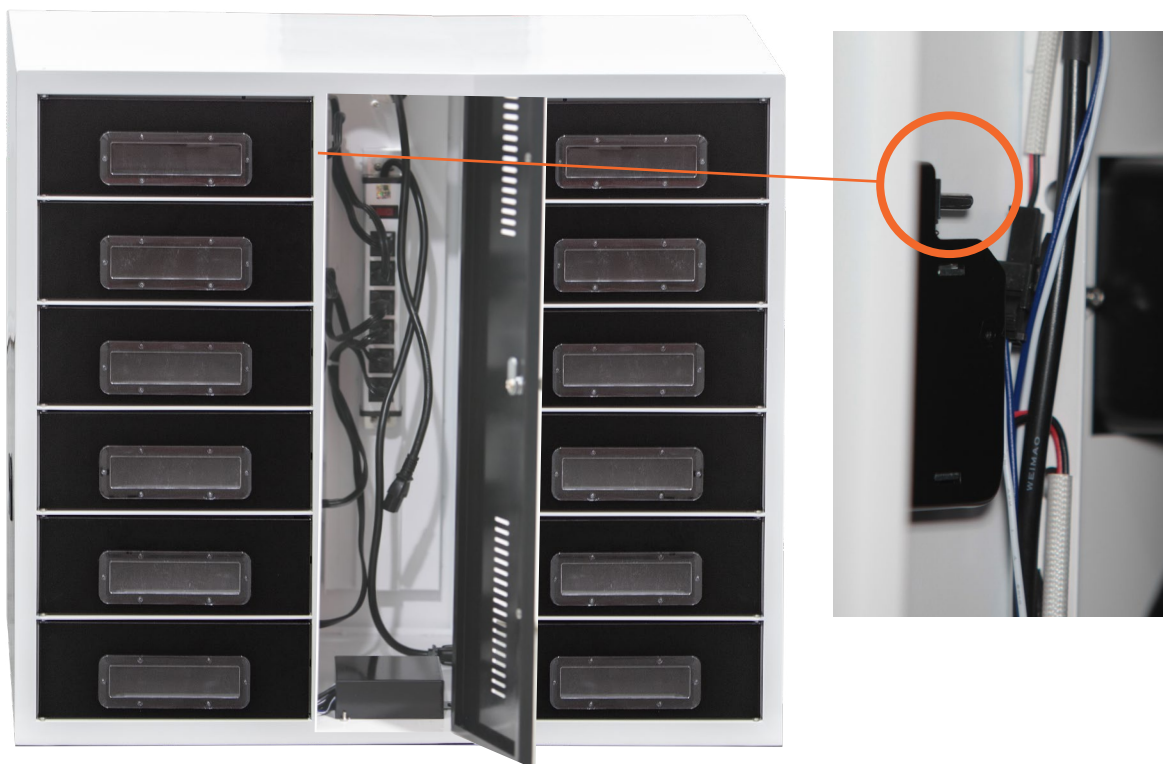

- 5** Using the Hex wrench, remove the (3) Hex bolts from the Upper Mounting Bracket located on the top, back edge of the Upper Cabinet.

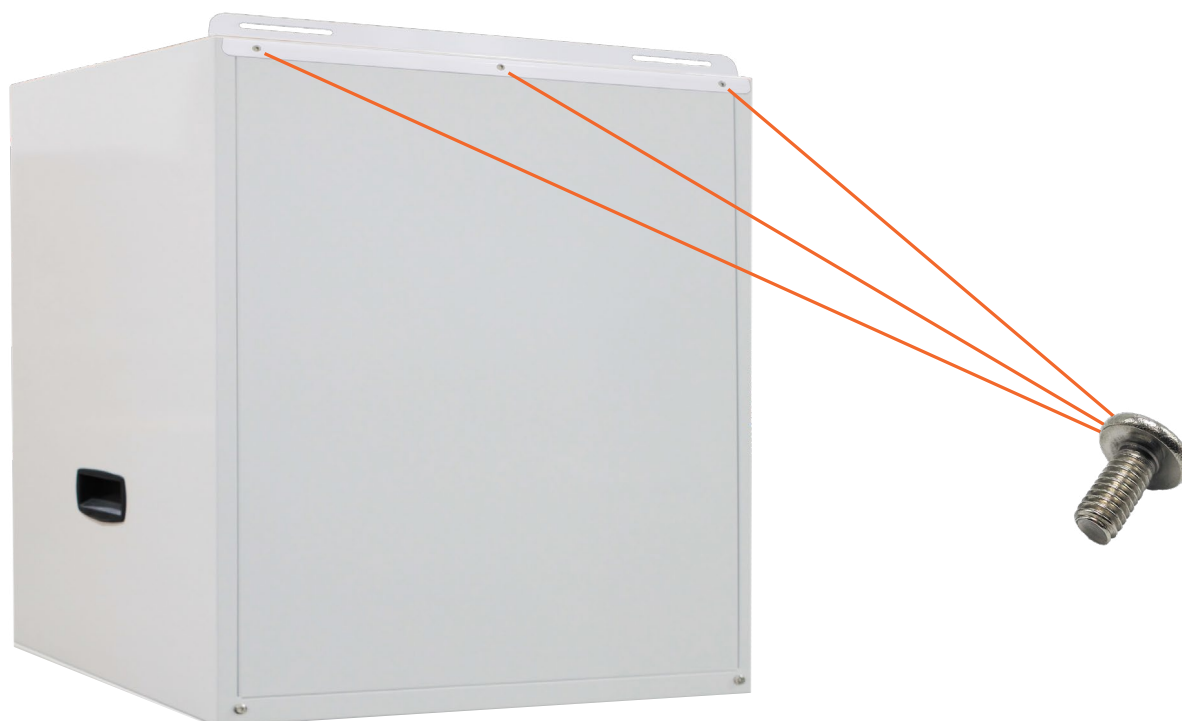

- 6 Remove the Upper Mounting Bracket and flip it around, making sure the slotted edge protrudes outward. Then, using the Hex wrench, re-install and tighten the (3) Hex bolts.

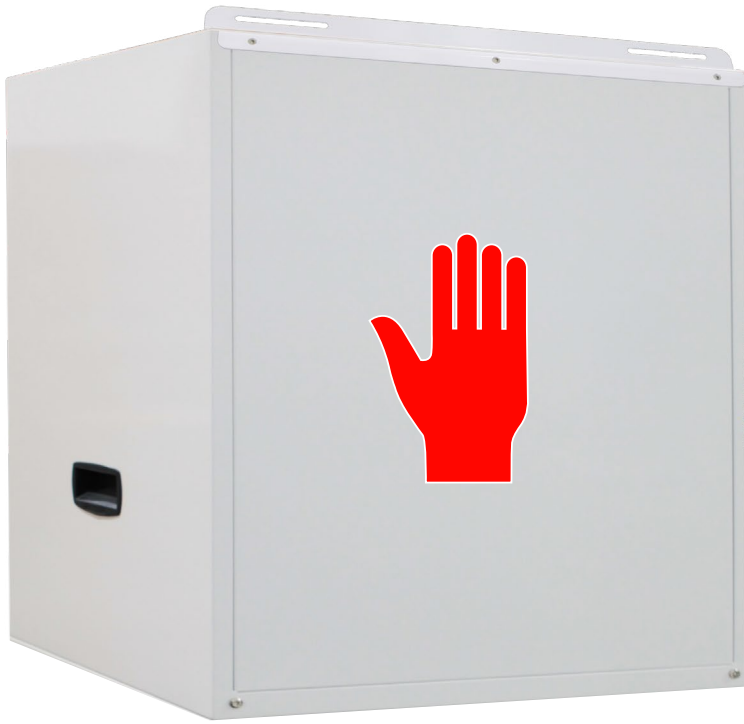

Shipping (Reversed) Orientation shown



Correct Orientation shown

- 7 On the Lower Cabinet, locate the Hex bolt from the front edge.



- 8 Using the Hex wrench, remove the Hex bolt from the front edge of the Lower Cabinet and set aside. **IMPORTANT** Do Not Discard the bolt.

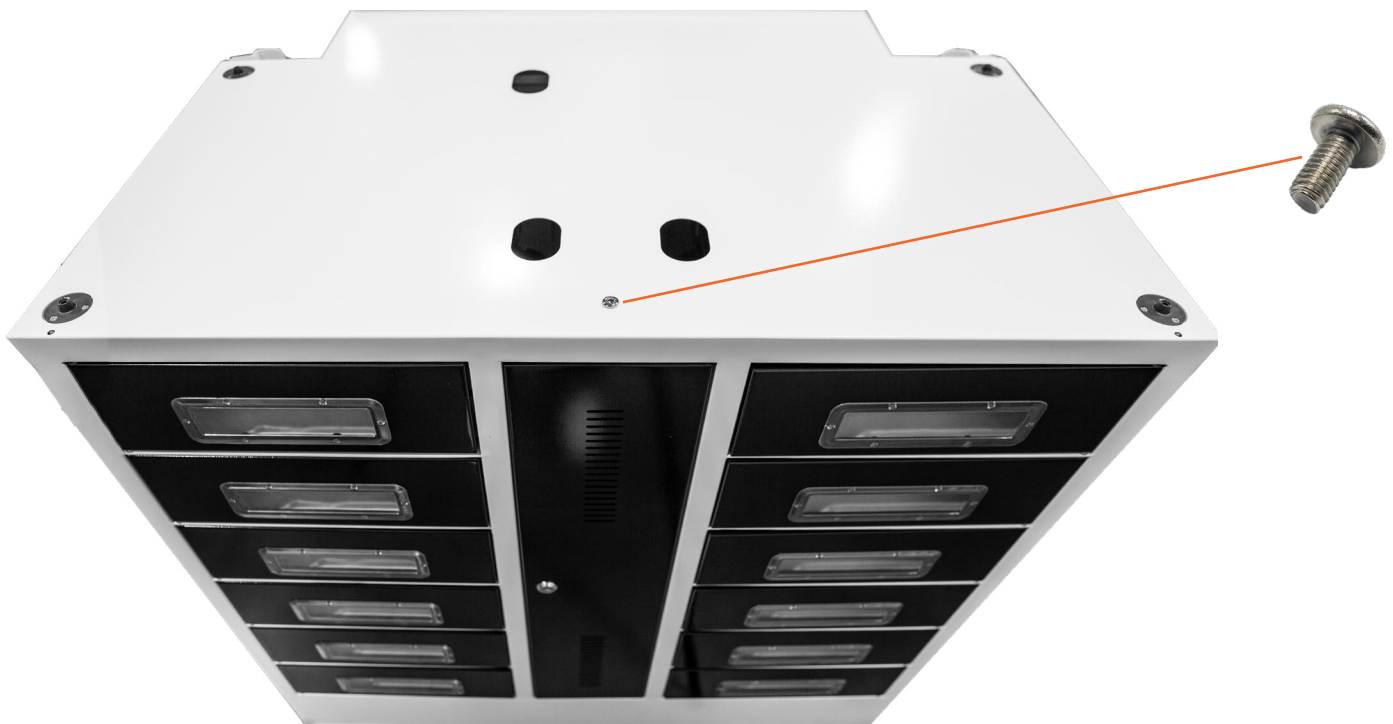

- 9 Using the side handles, carefully lift the Upper Cabinet on top of the Lower Cabinet. For your safety, always move these pieces with the help of 1 or 2 assistants.



- 10 On the Upper Cabinet, insert key into Access Door Lock and open door.



- 11 Using the Hex bolt from step 8, secure both Cabinets together by inserting it into the Lower Cabinet threaded hole at the bottom, then tightening it using the Hex wrench.



- 12 Working in the back, use the Hex wrench to remove the (4) Hex bolts from the middle left and middle right edges.



- 13** With (1) Middle Mounting Bracket in hand, align the 2 narrow holes with the holes in the cabinets, making sure the slotted edge protrudes outward. Then, using the Hex wrench, install and tighten the (2) Hex bolts.

Middle Mounting Bracket



- 14** Working on the opposite side, align the other (1) Middle Mounting Bracket, then install and tighten the (2) Hex bolts.



- 1 Open both the Upper AND Lower Access Panel doors with the key.

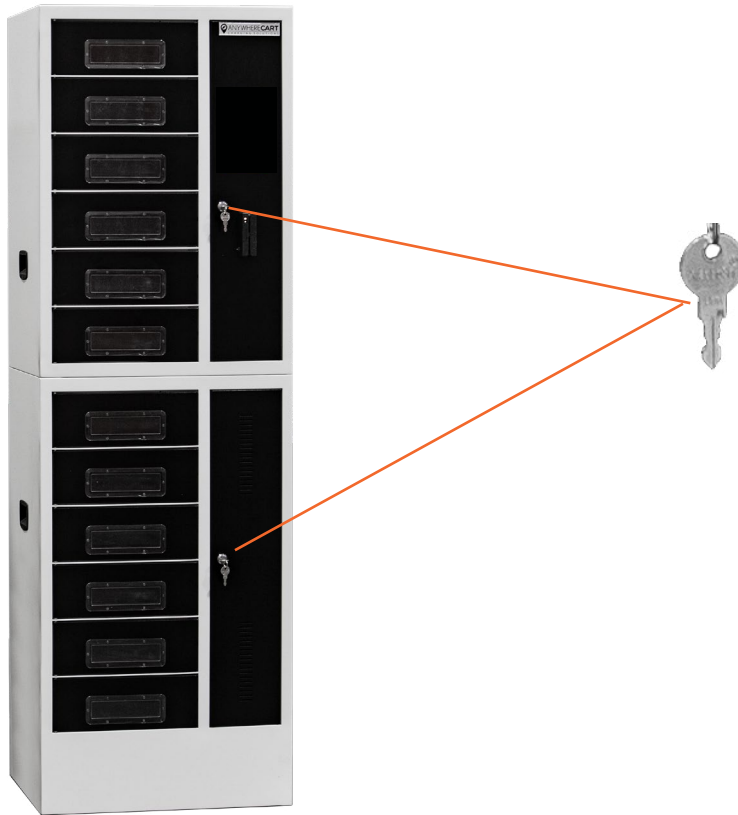

- 2 Locate the Upper Data Connection Cable in the Upper Cabinet; It has a white, 4-pin connector (Molex style). Push the cable through the pass-through hole next to the black box.

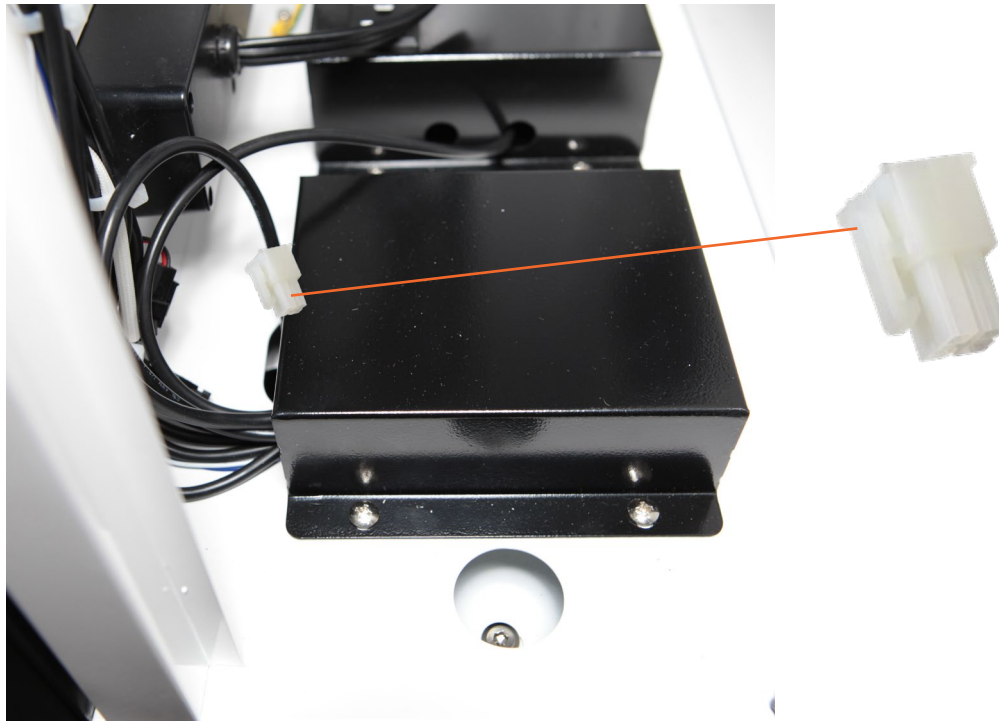

- 3** Locate the Lower Data Connection Cable in the Lower Cabinet.

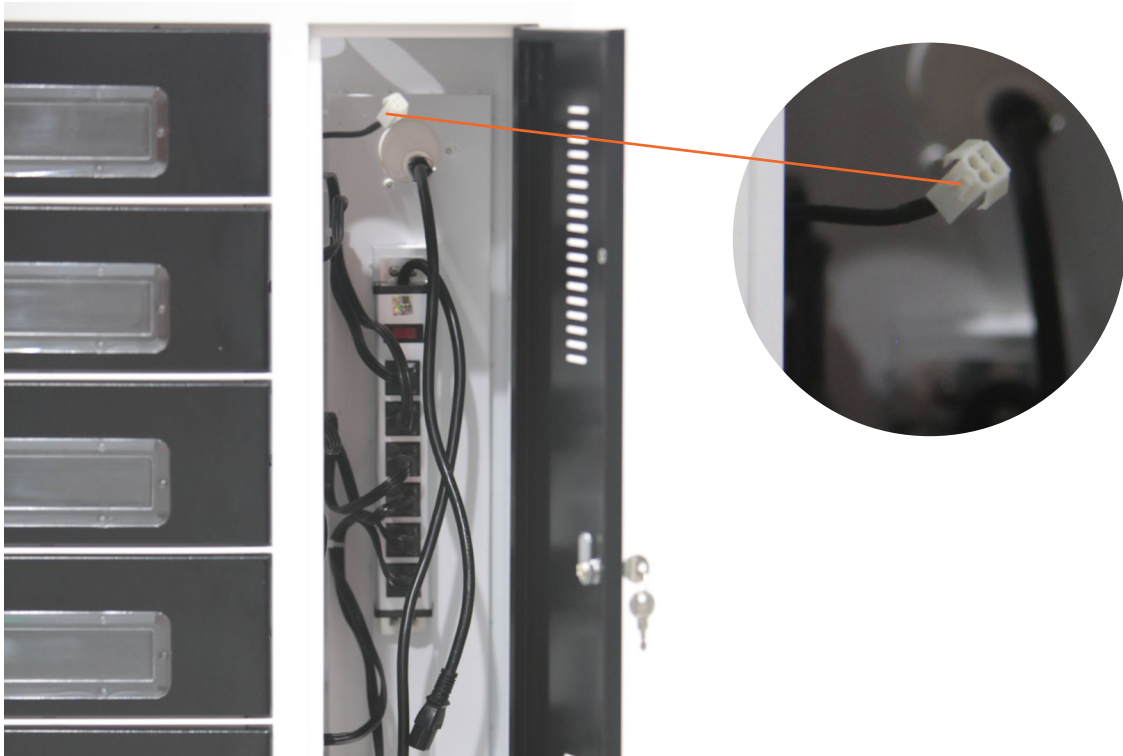

- 4** Connect the Upper AND Lower Data Connection Cables together until clasp locks.

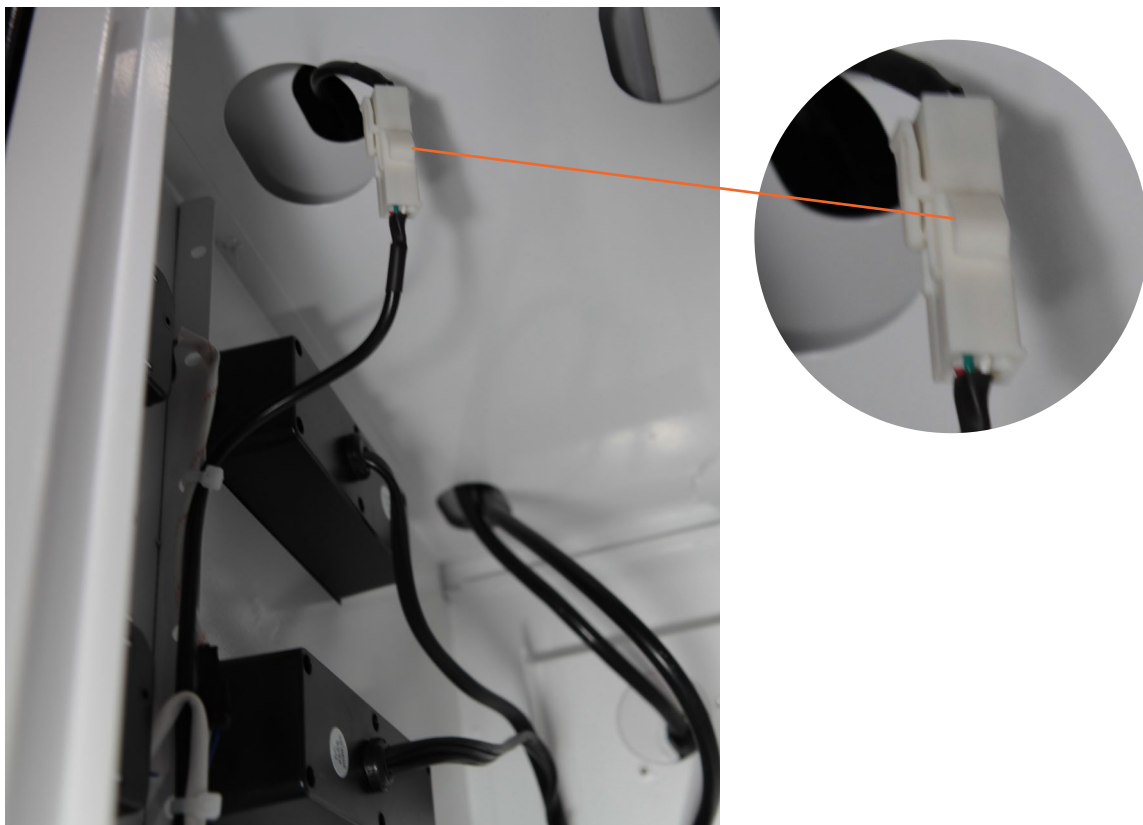

- 5** In the Lower Cabinet, locate both the Power Strip Plug AND the Power Input Plug.



Power Input Plug



Power Strip Plug



- 6 In the Upper Cabinet, locate the Power Supply; Its a black box with open electrical outlets.



Power Supply

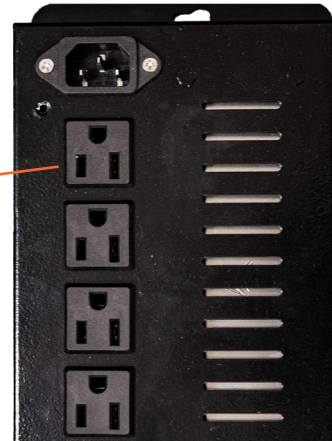

- 7 One at a time, feed the Power Input Plug, then the Power Strip Plug through the pass-through hole located near the back.

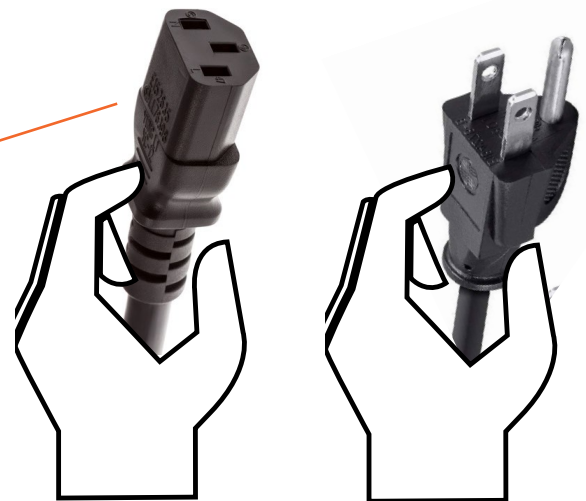
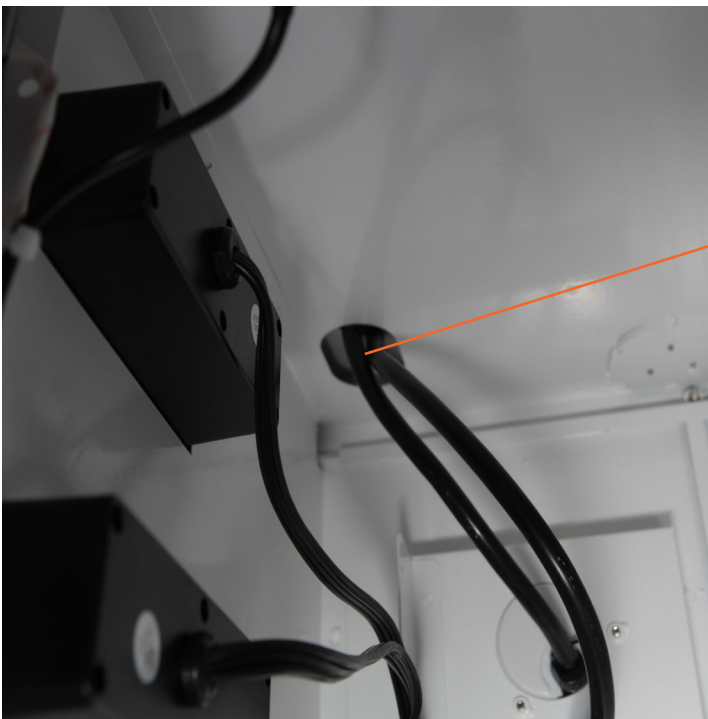

- 8 Plug both the Power Input Plug AND Power Strip Plug into the Power Supply.



- 9 Plug in the locker into an electrical outlet.



- 1 Position your Locker so that wall studs or heavy duty wall anchors are accessible, as well as an electrical outlet.

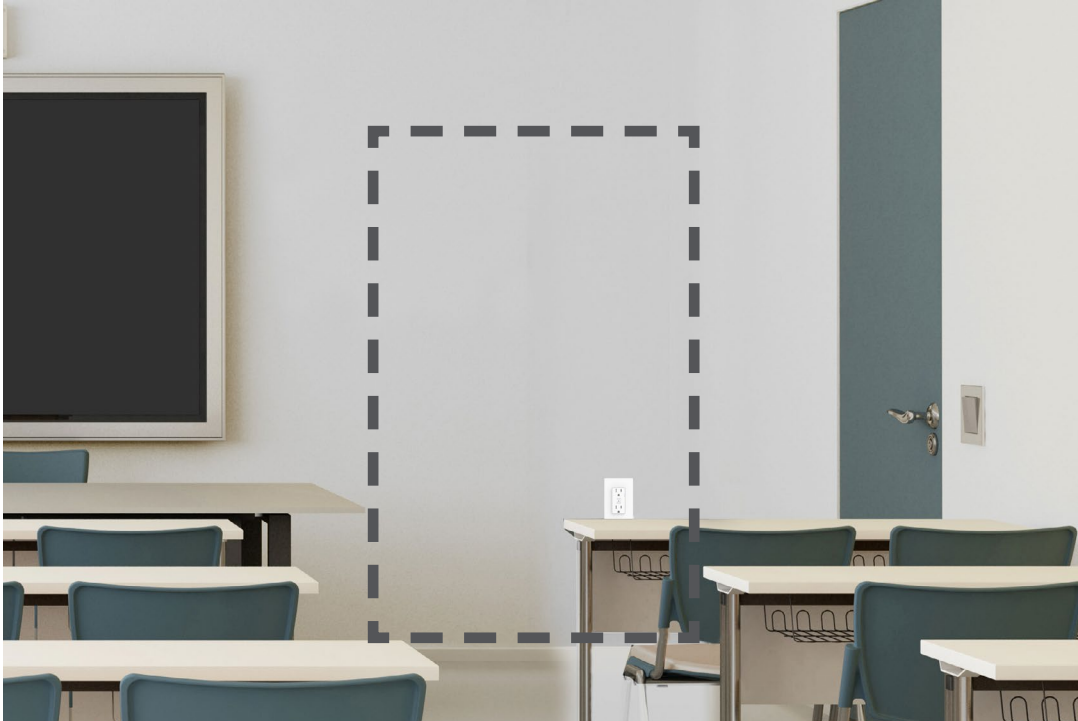

- 2 Ensure the Upper Mounting bracket and both Middle Mounting Brackets are affixed to either wall studs or heavy duty wall anchors.

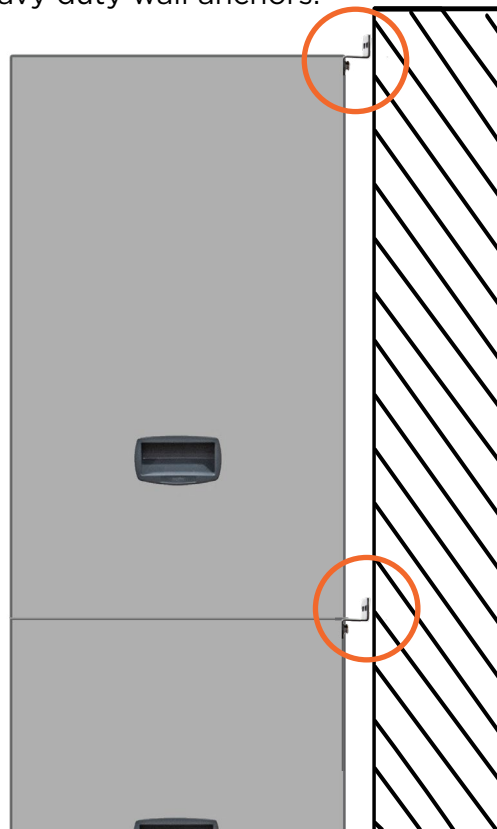

1 Press "Storage" under CARD



2 Place or swipe CARD on Card Reader



3 Press "Take out" under CARD

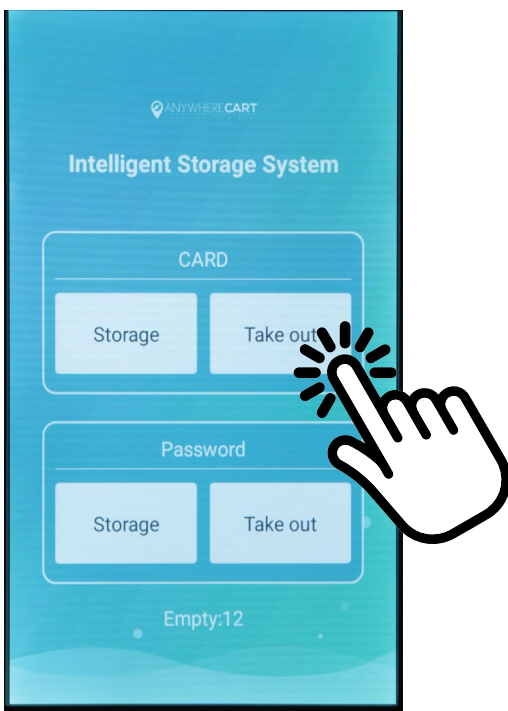

4 Place or swipe CARD on Card Reader

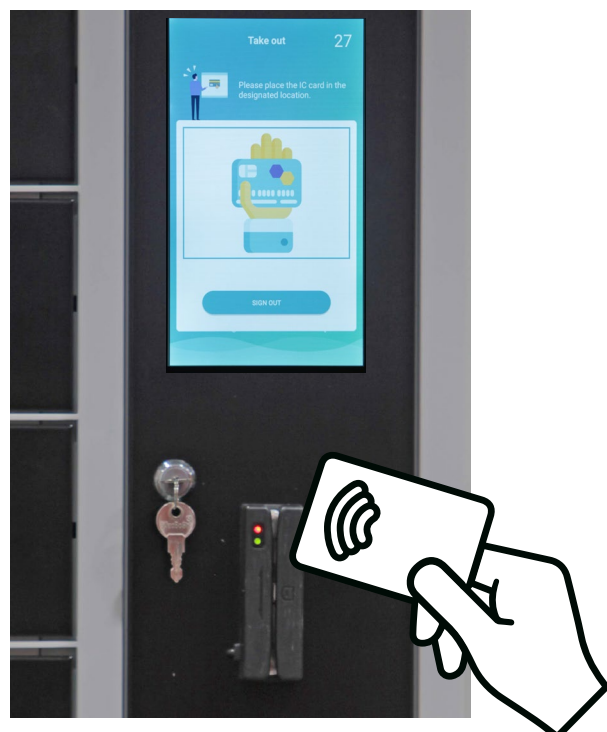

1 Press "Storage" under Password

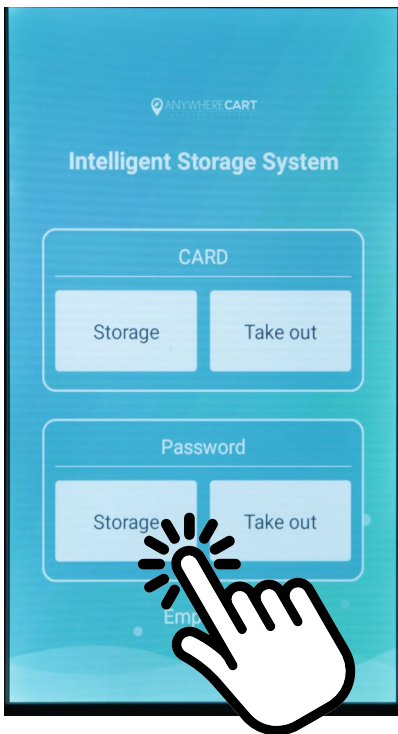

2 Input a 4-Digit Password



3 Press "Take out" under Password

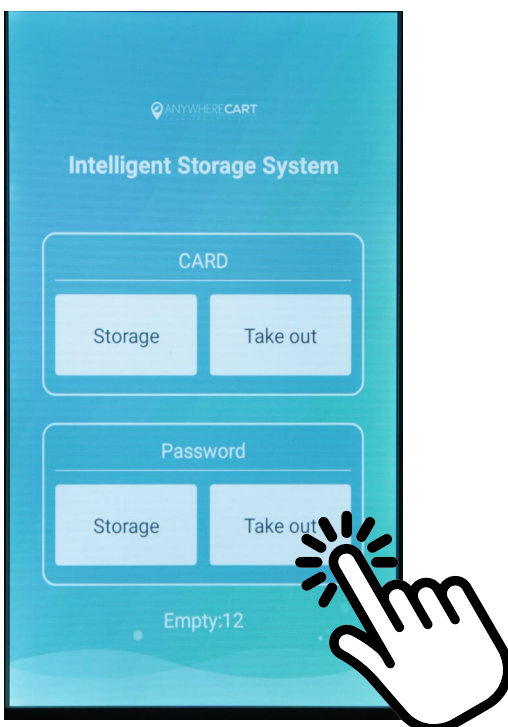

4 Press the bay you would like to access

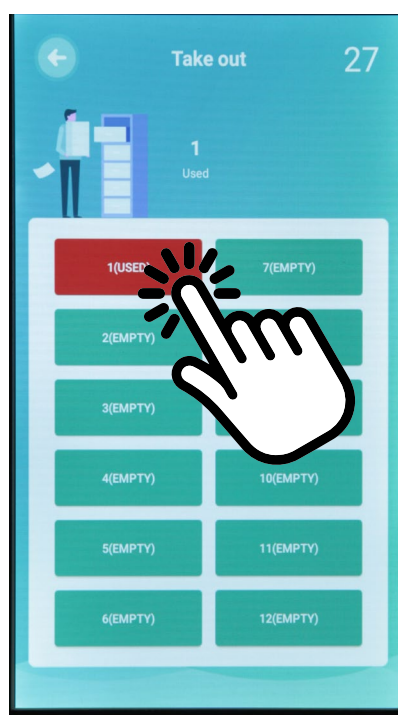

5 Input your Password

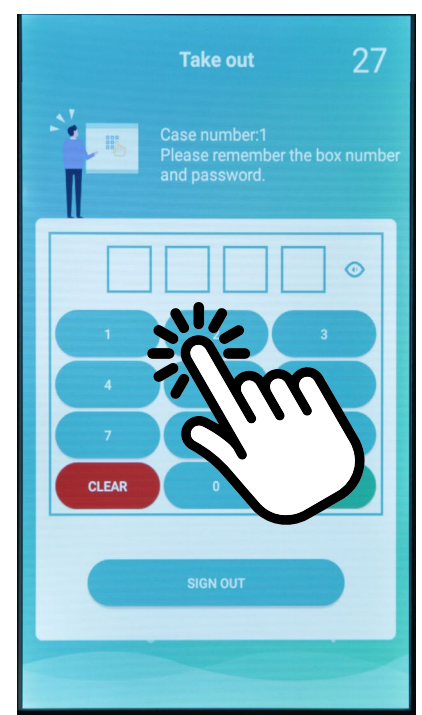

- 1** Press & hold the top left corner for 3 seconds

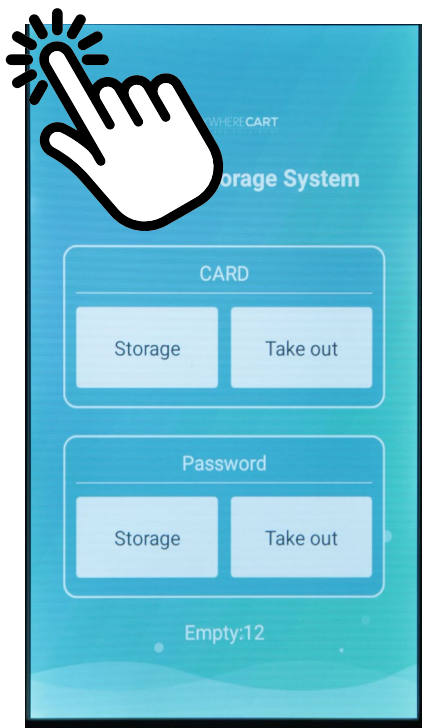

- 2** Enter the Admin Password
(Contact support@anywherecart.com for your Factory Default Password)

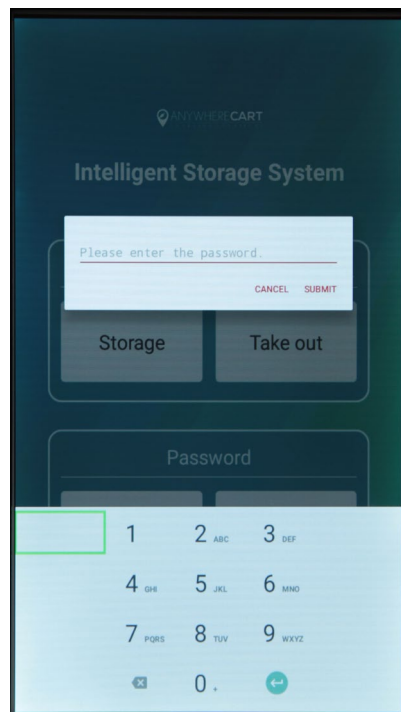

- 3** Access settings by pressing "Gear" icon

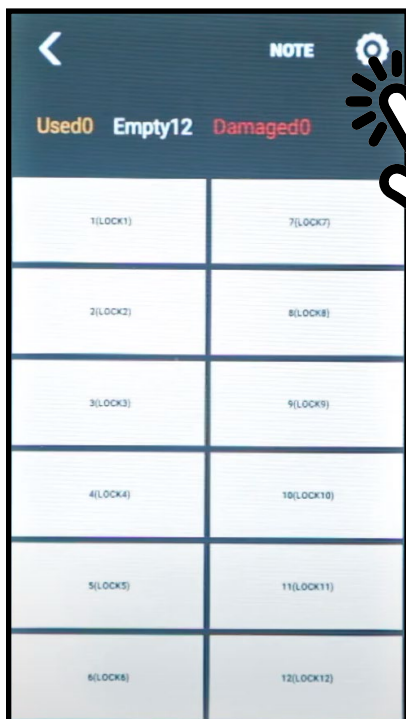

- 4** Press "PASSWORD"

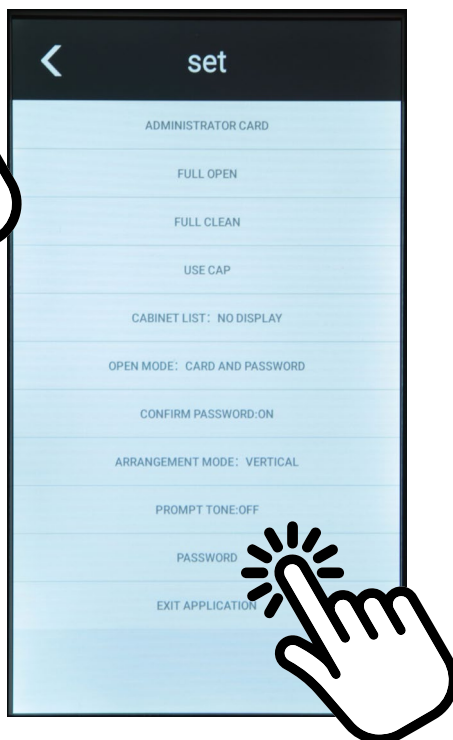

- 5** Input both old & new Passwords



- 1 Press & hold the top left corner for 3 seconds

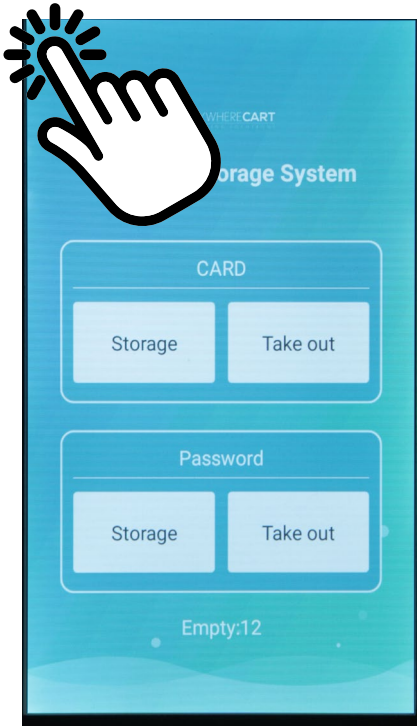

- 2 Enter your Admin Password

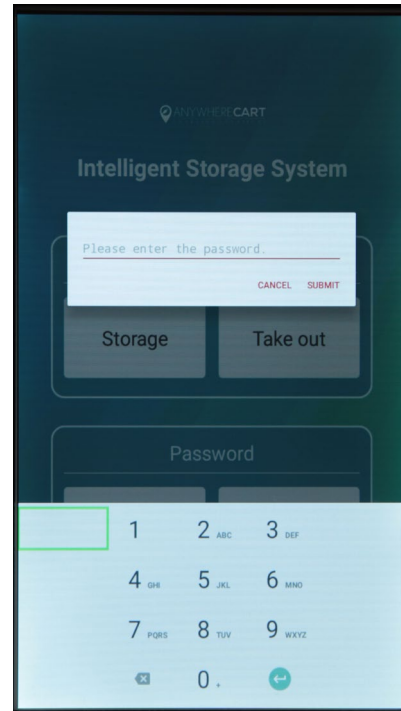

- 3 View log by pressing "NOTE" icon



- 4 Review Access Data

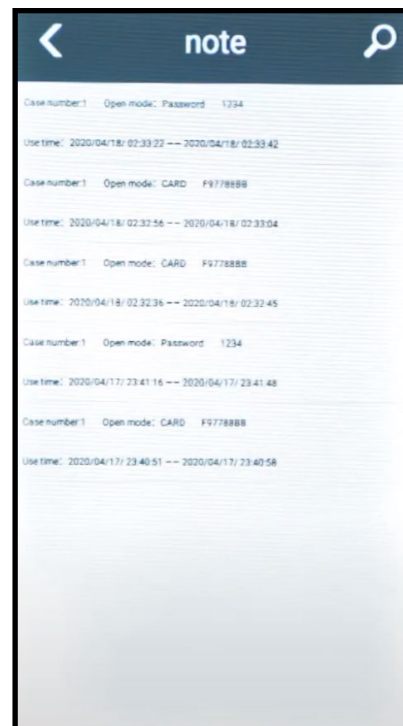

- 1 Press & hold the top left corner for 3 seconds

- 2 Enter your Admin Password

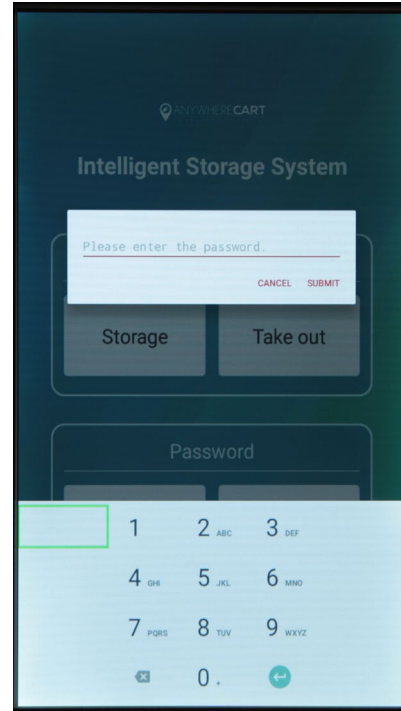
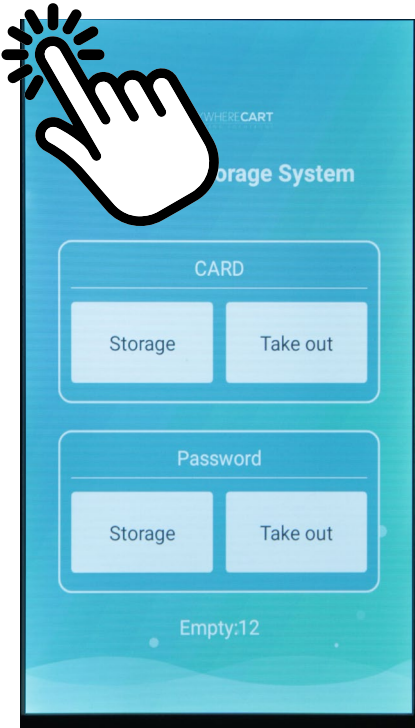

- 3 Press the Bay you would like to modify

- 4 Adjust parameters

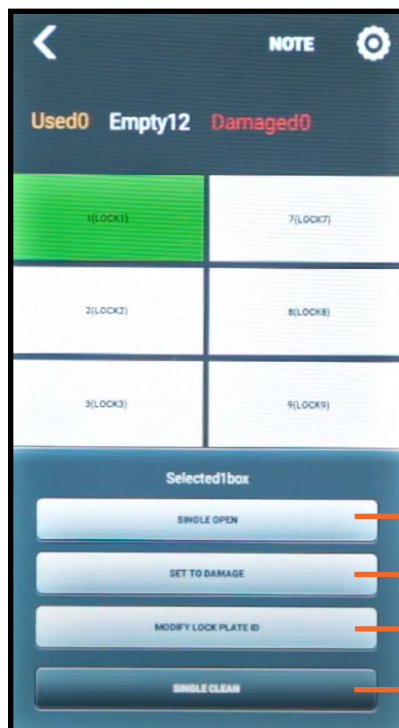
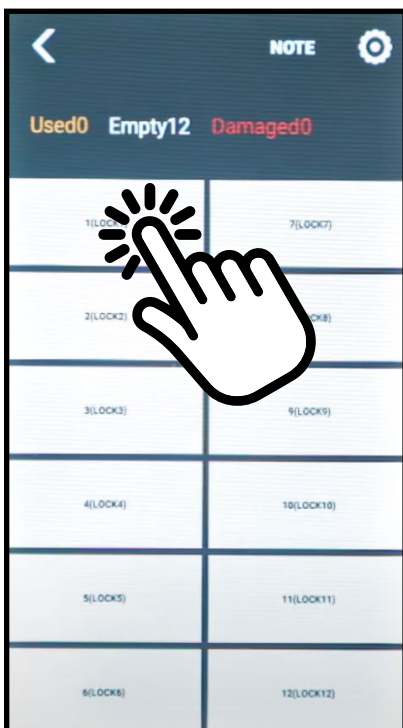

- A SINGLE OPEN**
Opens Bay once
- B SET TO DAMAGE**
Marks Bay as Damaged and inaccessible by users
- C MODIFY LOCK PLATE ID**
Allows Bay to be named
- D SINGLE CLEAN**
Clears Bay Access Data

1 Press & hold the top left corner for 3 seconds

2 Enter the Admin Password

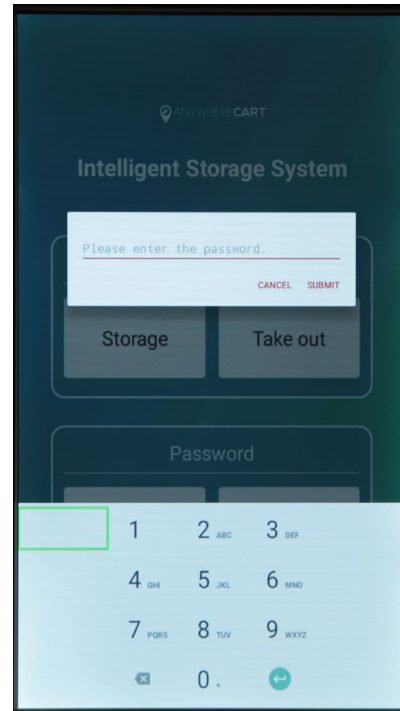
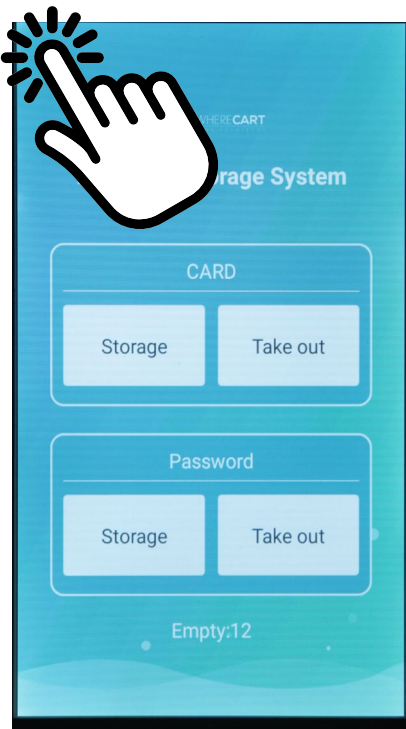

3 Access settings by pressing "Gear" icon

4 Adjust parameters

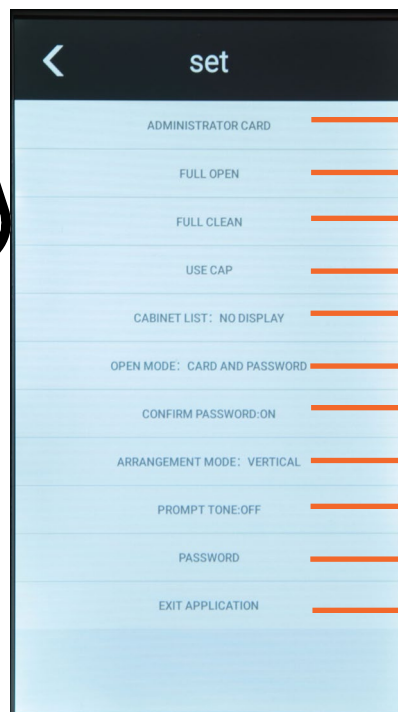
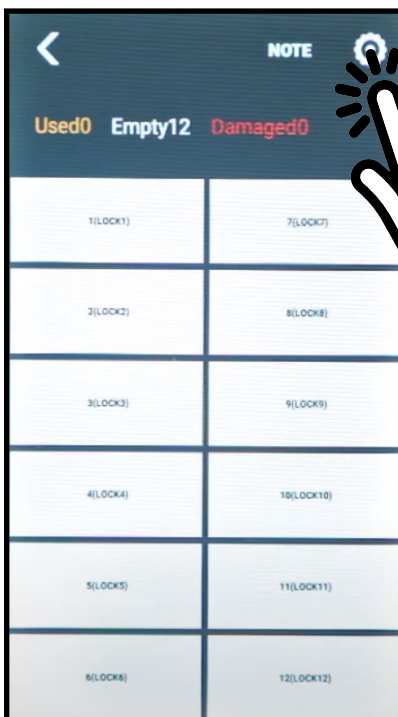

- A ADMINISTRATOR CARD**
Sets up a master access card
- B FULL OPEN**
Opens all Bays at once
- C FULL CLEAN**
Clears All Bay Access Data
- D USE CAP**
Allows user to access up to 3 Bays
- E CABINET LIST**
Toggles view of Bay Number
- F OPEN MODE**
Allows for both Card & Password
- G CONFIRM PASSWORD**
Toggles confirmation of password
- H ARRANGEMENT MODE**
Sets Locker to either Vertical or Horizontal layout
- I PROMPT TONE**
Toggles Voice Alert
- J PASSWORD**
Changes Admin Password
- K EXIT APPLICATION**
PLEASE AVOID! Exits Android App

The power is out and I need access

Open the Upper and Lower Access Door Lock with key. Then, Push down on each Release lever to open Bays



A User no longer remembers password

Follow the instructions for Single Open, then Single Clean on page 34

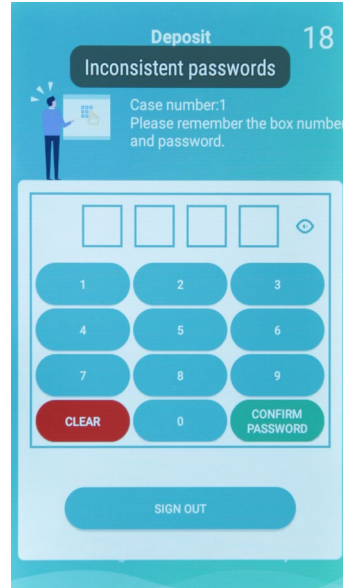

I don't see the main menu.

Screen Saver activated; Press the screen.

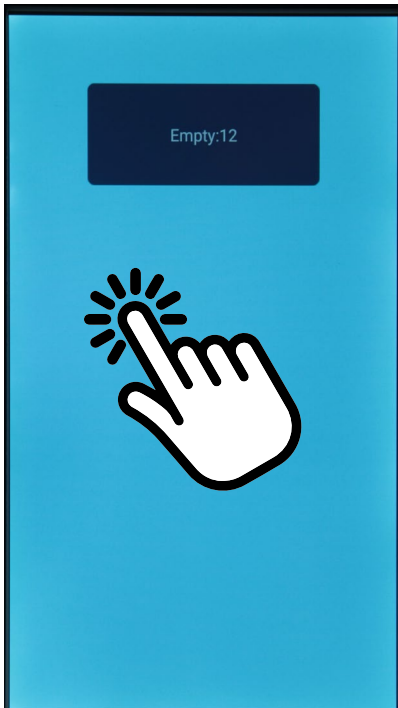

Someone exited the App

Press the Android Home Button

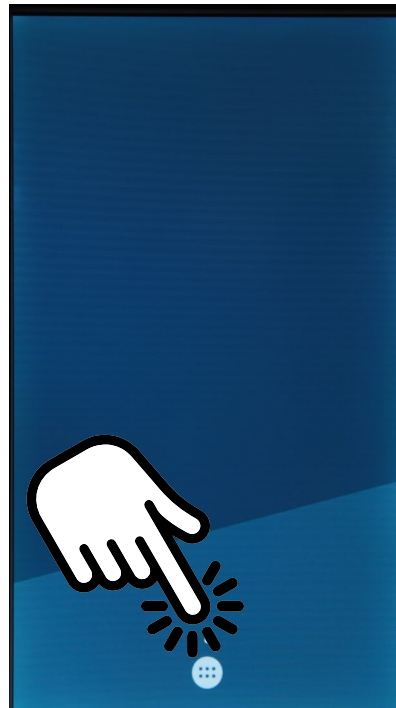

Then Press "Cabinet" App icon

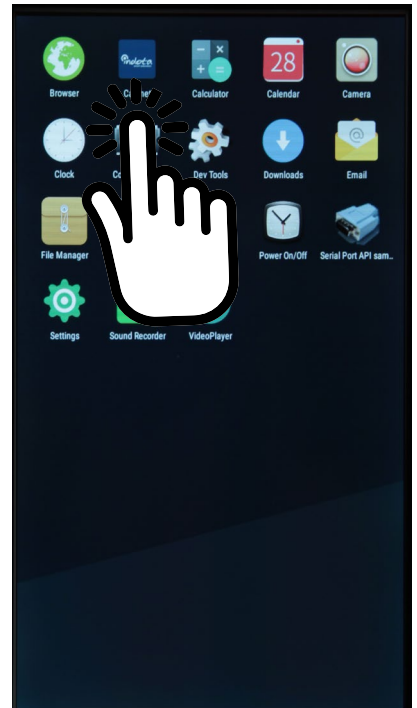

Limited Warranty

1. The terms below shall have the following definitions for purposes of this Warranty:

"Client" means the original party purchasing the Products from Anywhere Cart or from an authorized dealer to sell Anywhere Cart branded products.

"Components" mean the mechanical components of a Product including the locks and hinges.

"Electronics" mean the power supplies, power strips and touchscreen. Cords are not warrantied.

"Frame" means the main frame or chassis of a Product.

"Products" means any goods and any related services to be supplied by Anywhere Cart to the Client pursuant to the Acceptance of an Order and any other goods or services which Anywhere Cart supplies to the Client from time to time.

Anywhere Cart warrants that the Products to be supplied to Client are free from defects in material and workmanship under normal use and service for which they were intended if, but only if, the Products have been properly installed and operated. Anywhere Cart's obligation under this Warranty is limited to only supplying replacement part(s) for any part(s) which are returned and found to be defective, provided that such part(s) are returned to Anywhere Cart within the following Warranty Period:

- a. With regard to the Frame, the Warranty Period shall be for the life of the Product to Client.
- b. With regard to Components, the Warranty Period shall be for a period of two (2) years from the date of delivery of the Product to Client.
- c. With regard to Electronics, the Warranty Period shall be for a period of two (2) years from the date of delivery of the Product to Client.

Except as prohibited or limited by applicable law, Anywhere Cart does not warrant that the Products meet the requirements of any safety code of any country, state, municipality, or other jurisdiction, and Client assumes all risk and liability whatsoever resulting from the use thereof, whether used singly or in combination with other machines or apparatus. This Warranty shall not apply to any of Anywhere Cart's Products, or parts thereof, which have been repaired or altered, without Anywhere Cart's written consent, outside Anywhere Cart's facility or altered in any way so as, in the sole judgment of Anywhere Cart, to adversely affect the stability or reliability of the Products, or if such Products have been subject to misuse, negligence, or accident, or have been operated in a manner not in accordance with Anywhere Cart's printed instructions or have been operated under conditions more severe than, or otherwise exceeding, those set forth in the specifications for such Products.

EXCEPT AS PROHIBITED OR LIMITED BY APPLICABLE LAW, THIS WARRANTY AND THE OBLIGATIONS AND LIABILITIES OF Anywhere Cart ARE EXCLUSIVE AND IN LIEU OF WARRANTIES, GUARANTIES OR LIABILITIES, EXPRESS OR IMPLIED, INCLUDING ANY IMPLIED WARRANTY FOR MERCHANTABILITY, FITNESS FOR A PARTICULAR PURPOSE, ARISING BY LAW OR OTHERWISE OR WHETHER OR NOT OCCASIONED BY Anywhere Cart's NEGLIGENCE AND CLIENT HEREBY WAIVES ALL REMEDIES NOT EXPRESSLY PROVIDED IN THIS WARRANTY. THIS WARRANTY SHALL NOT BE EXTENDED, ALTERED OR VARIED EXCEPT BY A WRITTEN INSTRUMENT SIGNED BY Anywhere Cart AND CLIENT. REGARDLESS OF THE FAILURE OF THE SOLE AND EXCLUSIVE REMEDIES PROVIDED IN THIS WARRANTY, Anywhere Cart WILL NOT BE LIABLE FOR ANY SPECIAL, INCIDENTAL, INDIRECT OR CONSEQUENTIAL DAMAGES WHATSOEVER (INCLUDING, WITHOUT LIMITATION, DAMAGES FOR LOSS OF REVENUE, BUSINESS OR PROFITS, LOSS RESULTING FROM BUSINESS INTERRUPTION, LOSS OF BUSINESS INFORMATION, LOSS RESULTING FROM ANY CLAIM BY ANY THIRD PARTY, ANY LOSS DUE TO DAMAGE TO PROPERTY, AND INJURY TO OR DEATH OF ANY PERSONS RESULTING, DIRECTLY OR INDIRECTLY, FROM THE USE OR LOSS OF THE PRODUCTS OR ANY OTHER PECUNIARY LOSS) OF ANY KIND OR NATURE. Anywhere Cart NEITHER ASSUMES NOR AUTHORIZES ANY PERSON TO ASSUME FOR IT ANY OTHER LIABILITY IN CONNECTION WITH THE SALE OR USE OF THE PRODUCTS, AND THERE ARE NO ORAL AGREEMENTS OR WARRANTIES COLLATERAL TO OR AFFECTING THIS WARRANTY. THE EXCLUSION OF SPECIAL, INCIDENTAL, INDIRECT OR CONSEQUENTIAL DAMAGES IS AN INDEPENDENT AGREEMENT OF Anywhere Cart AND CLIENT APART FROM THE SOLE AND EXCLUSIVE REMEDIES PROVIDED IN THIS WARRANTY.

Client shall notify Anywhere Cart by registered or certified mail, return receipt requested, of a breach of this Warranty within thirty (30) days after discovery thereof, but not later than the expiration of the applicable Warranty Period, otherwise such claims shall be deemed waived.

2. Limitations of Warranty.

Anywhere Cart makes no warranties to any third party. You are responsible for all claims, damages, settlements, expenses, and attorneys' fees with respect to claims made against You as a result of Your use or misuse of the Product. This warranty applies only if the Product is installed, operated, maintained, and used in accordance with Anywhere Cart specifications. Specifically, the warranties do not extend to any failure caused by (i) accident, unusual physical, electrical, or electromagnetic stress, neglect or misuse, (ii) fluctuations in electrical power beyond Anywhere Cart specifications, (iii) use of the Product with any accessories or options not furnished by Anywhere Cart or its authorized agents, or (iv) installation, alteration, or repair of the Product by anyone other than Anywhere Cart or its authorized agents.

3. Disclaimer of Warranty.

Except As Expressly Provided Otherwise Herein And To The Maximum Extent Permitted By Applicable Law, Anywhere Cart Disclaims All Other Warranties With Respect To The Product, Whether Express, Implied, Statutory Or Otherwise, Including Without Limitation, Satisfactory Quality, Course Of Dealing, Trade Usage Or Practice Or The Implied Warranties Of Merchantability, Fitness For A Particular Purpose Or Noninfringement Of Third Party Rights.

4. Limitation of Liability.

In no event shall Anywhere Cart be liable for indirect, incidental, special, exemplary, punitive, or consequential damages of any nature including, but not limited to, loss of profits, data, revenue, production, or use, business interruption, or procurement of substitute goods or services arising out of or in connection with this limited warranty, or the use or performance of any product, whether based on contract or tort, including negligence, or any other legal theory, even if Anywhere Cart has advised of the possibility of such damages. Anywhere Cart's total, aggregate liability for damages of any nature, regardless of form of action, shall in no event exceed the amount paid by you to Anywhere Cart for the specific product upon which liability is based.

5. Governing Law and Your Rights.

This warranty gives You specific legal rights; You may also have other rights granted under state law. These rights vary from state to state.

6. Warranty Period for Anywhere Cart Product Purchased:

AC-LOCKER	Lifetime Frame, 2 Years Components, 2 Year Electronics
-----------	--