

# CS22D

## 2-Port USB DVI KVM Switch

- The CS22D 2-Port USB DVI KVM Switch is a control unit that allows access to two computers from a single USB and DVI console (keyboard, video and mouse). With the CS22D, you can access the computers conveniently via a Remote Port Selector.

The CS22D's compact all-in-one design makes it ideal for multiplatform desktop applications.

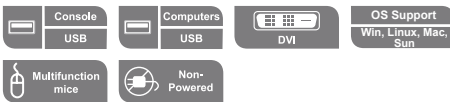

### Features

- One DVI-D video console controls two DVI-D USB interface computers
- Computer Selection via Remote Port Selector
- OS Support: Windows 2000, Windows XP, Windows Vista, 7, Mac, Sun and Linux
- Superior video quality- up to 1920 x 1200@60Hz
- Supports USB hot-plugging
- Non-powered
- Supports USB 2.0 device



**205 Westwood Ave, Long Branch, NJ 07740**  
**Phone: 866-94 BOARDS (26273) / (732)-222-1511**  
**Fax: (732)-222-7088 | E-mail: sales@touchboards.com**

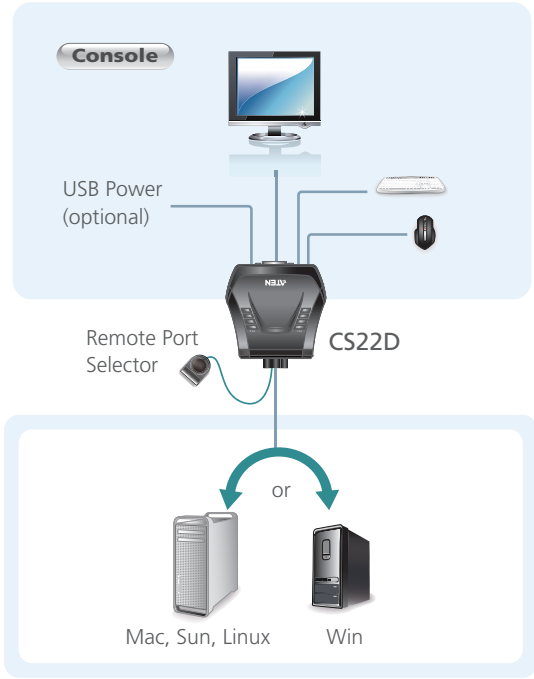

### Specification

Function		CS22D	
Computer Connections		2	
Port Selection		Remote Port Selector	
Connectors	Console ports	Keyboard	1 x USB Type A Female (Black)
		Mouse	1 x USB Type A Female (Black)
		Video	1 x DVI-I Female (Black)
		Power	1 x mini USB Type B Female (Black, Optional)
	Computer ports	KB/MS	2 x USB Type A Male (Black)
	Video	2 x DVI-D Male (Black)	
LEDs	Selected	2 (Green)	
Resolution		DVI-D: 1920 x 1200 @ 60 Hz	
Power Consumption		5V, 2.5W	
Environment	Operation Temperature	0-50°C	
	Storage Temperature	-20-60°C	
	Humidity	0-80% RH, Non-condensing	
Physical Properties	Housing	Plastic	
	Weight	0.33 Kg	
	Dimension (L x W x H)	9.95 x 9.36 x 3.01 cm	

