

CS692

2-Port USB HD Audio/Video KVM Switch

Touchboards

205 Westwood Ave, Long Branch, NJ 07740
 Phone: 866-94 BOARDS (26273) / (732)-222-1511
 Fax: (732)-222-7088 | E-mail: sales@touchboards.com

- The CS692 USB HD Audio/Video KVM Switch links two HD-enabled PCs or devices to a single USB keyboard, USB mouse, and HD display console. The CS692 Switch takes a giant step forward from prior cable KVM models in the Petite series, by offering full HDMI functionality, USB 2.0 peripheral sharing (via a USB hub attached to the USB mouse port), and a firmware upgrade function that allows you to keep up with latest available versions.

Featuring an unbeatable combination of HDMI functionality, USB 2.0 peripheral sharing convenience, gaming keyboard support, and enhanced user-friendly operations, the CS692 allows users to keep up with the latest innovations in desktop multimedia applications.



Features

- One HD video console controls two HD-enabled PCs or devices
 - HDMI compatible; HDCP compatible
 - **Computer selection via remote port selector, hotkeys, and USB mouse**
 - Audio-enabled – full bass response provides a rich experience for 2.1 channel surround sound systems
 - **Independent switching of the KVM and Audio focus – one computer has the KVM focus and the other the Audio focus¹**
 - Multiplatform support – Windows, Mac, Linux
 - Compact design, built-in all-in-one cables (2 x 1.2 m)
 - Superior video quality – up to 1920 x 1200; 1080p
 - Compatible with widescreen LCD monitors
 - **Video DynaSync™ – exclusive ATEN technology eliminates boot-up display problems and optimizes resolution when switching between ports**
 - **Power on detection – if one computer is powered off, the CS692 will automatically switch to the other computer**
 - Supports gaming and multimedia keyboards
 - Supports multifunction and wireless keyboards and mice
 - Console mouse port emulation/bypass feature supports most mouse drivers and multifunction mice
 - Mac keyboard support and emulation²
 - **USB 2.0 mouse port can be used for USB hub and USB peripheral sharing³**
 - Non-Powered
 - Firmware upgradable
- Note: 1. HD audio through the HD monitor's built-in speakers cannot be switched independently.
 2. PC keyboard combinations emulate Mac keyboards. Mac keyboards work only with their own computers.
 3. May require an additional power adapter.
 To use the USB 2.0 mouse port as a USB hub, you must first disable mouse emulation mode.

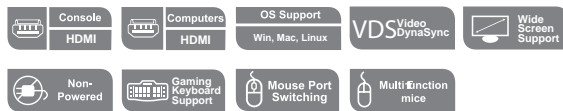
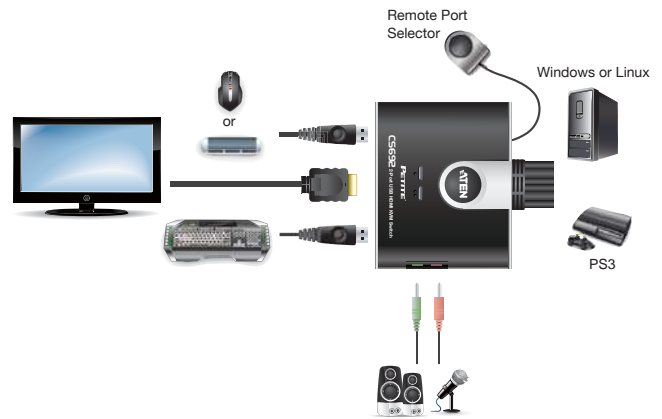

Specification

Function	CS692		
Computer Connections	2		
Console Connections	1		
Port Selection	Remote Port Selector, Mouse, Hotkeys		
Connectors	Console Ports	Keyboard	1 x USB Type A Female (Silver)
		Video	1 x HD Type A Female (Black)
		Mouse	1 x USB Type A Female (Silver)
		Speakers	1 x Mini Stereo Jack Female (Green)
		Mic.	1 x Mini Stereo Jack Female (Pink)
	KVM Ports	Keyboard	2 x USB Type A Male (Purple)
		Video	2 x HD Type A Male (Black)
		Mouse	2 x USB Type A Male (Black)
		Speakers	2 x Mini Stereo Plug Male (Green)
		Mic.	2 x Mini Stereo Plug Male (Pink)
LEDs	KVM	2 (Green)	
Cable Length	KVM	2 x 1.2 m	
	Remote Port Selector	1.8 m	
Emulation	Keyboard / Mouse	USB	
Video	1080p; 1920 x 1200		
Scan Interval	3, 5, 10, 20 secs. (default 5 secs.)		
Power Consumption	DC 5V, 2.65W		
Environment	Operating Temp.	0–50°C	
	Storage Temp.	–20–60°C	
	Humidity	0–80% RH, Non-condensing	
Physical Properties	Housing	Plastic	
	Weight	0.41 kg	
	Dimensions (L x W x H)	8.24 x 6.65 x 2.52 cm	

* Product specifications and appearance are subject to change without notice.

