

P10 WX35NXT

**Ultra
Short
Throw**

**Finger Touch
Interactive
Projector**

Be Brilliant.

Ultra Short Throw, done the Boxlight way.



**Comprehension,
accelerated.**

In Business. In Medicine. In Science. Real time annotation gets the big ideas across, fast. Annotate pictures, reports, body scans, on-line feeds, full-motion video. Call up preloaded shapes and effects. Even tap previously saved presentations.



**You've never sounded
so Brilliant.**

SoundLite is presentation sound, done the BOXLIGHT way. Compact, easy to install, with a potent Class D amplifier. SoundLite 30W adds a high fidelity wireless microphone that automatically defers to the presenter's voice, over music, or other audio. Better sound, better understanding. Brilliant.

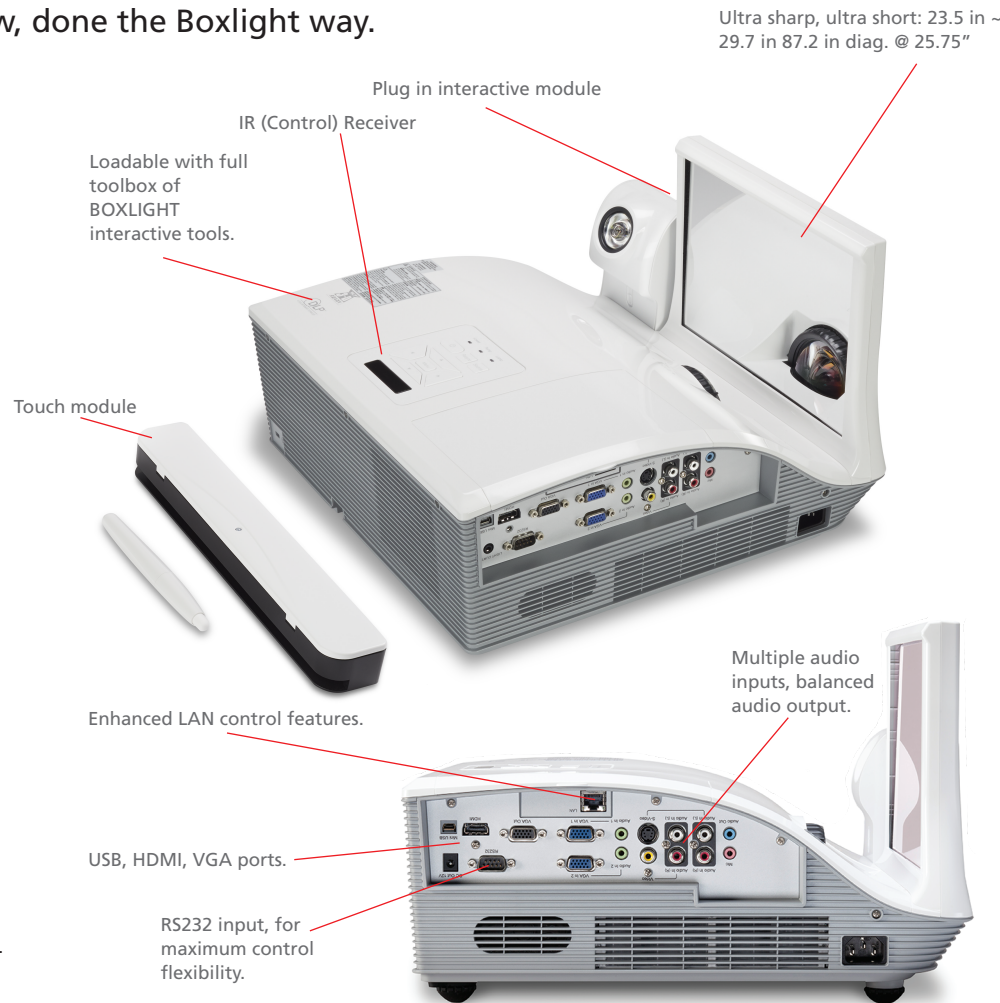

Ultra sharp, ultra short: 23.5 in ~ 29.7 in 87.2 in diag. @ 25.75"

Plug in interactive module

IR (Control) Receiver

Loadable with full toolbox of BOXLIGHT interactive tools.

Touch module



**Equations become
revelations.**

When inspiration hits you, or the class seems stuck, annotate, almost anything. From full-motion video to yesterday's homework, real time, on screen, even on-line. P10 WX31NXT is fully compatible with Windows7 and MAC OS 10 software and teaching programs.



Brilliance, guaranteed.

Never worry about expensive bulb replacement again. Lamps For Life is a BOXLIGHT exclusive: a managed, one time fee, bulb replacement program. \$99.00 for education users, \$299.00 for corporate customers.* That's it, for as long as you own your BOXLIGHT.

* Some conditions apply.

Enhanced LAN control features.

Multiple audio inputs, balanced audio output.

USB, HDMI, VGA ports.

RS232 input, for maximum control flexibility.



Tools that make Brilliance, simple.

Tools matter, and no one has a more powerful built-in interactive toolbox than BOXLIGHT. Over 40 shapes, effects, and functions. A palette with hundreds of brilliant colors and shades. Controlled by the fastest reacting pens in the business, with super fast rendering. All in all, pure presentation power, and magic.

24/7/365

US-based technical support

Model	P10 WX35NXT
Technology	.65" WXGA DMD DLP®
Brightness	3500 lumens (standard) / 2450 lumens (economy)
Native Resolution	1280 x 800 (WXGA)
Supported Resolution	up to 1600 x 1200 (UXGA)
Brightness Uniformity	80%<
Projection Methods	Desktop front/rear, Ceiling front/rear
Optical Offset	125%
Colors	1.07 billion true color
Color System	NTSC / NTSC 4.43 / PAL (including PAL-M, N) / SECAM/PAL60
Color Wheel	6 Segment
Aspect Ratio	Native 16:10; Compatible 4:3, 16:9
Image Size	70 in to 100 in / 1.78 m to 2.54 m
Projection Distance	23.5 in ~ 29.7 in 87.2 in diag @ 25.75"
Throw Ratio	.35:1 *allow 3-5% variance on all projector throw ratios
Speaker	1 x 10W
Contrast Ratio	10000:1
Digital Zoom	2x zoom
Keystone Correction	Vertical +/- 15 degrees
Vertical Scan Rate	48 to 120 Hz
Horizontal Scan Rate	31 to 92 kHz
Lens Type	Fixed zoom / Manual focus
Lamp	280W UHP
Lamp Life	4000 (standard) / 5000 (economy)
Remote Control	Multi-function credit card style with battery
Noise Level	37db (standard) / 33db (economy)
Power Supply	Universal AC 100 - 240 V ~ 50 - 60 Hz
Power Consumption	345W±10% at 110VAC <.5W in standby mode
Safety Certifications	CE, FCC, UL
Computer Compatibility	VGA, SVGA, XGA, SXGA, WXGA, UXGA VESA standards; PC and Macintosh compatible
Video Compatibility	480i/p, 576i/p, 720p, 1080i

Video Compatibility (HDMI)	SDTV 480P, HDTV 720P, 1080i, 1080p
Inputs	VGA x 2, HDMI, S-Video, Composite, Audio RCA (L/R), 3.5mm audio x 2, 3.5mm mic, MINI-USB for interactive function
Outputs	VGA, 3.5mm audio DC 12V for laser module
Service and Network Control	RJ45, RS232 D-Sub 9pin
Weight	17.7 lbs / 8 KG
Dimensions (W x H x D)	14.06 in x 14.45 in x 5.32 in / 357 mm x 367 mm x 135 mm
Operating Conditions	41 ~ 104°F
Security	Kensington® lock port, anchor security bar
Standard Accessories	AC power cord, VGA cable, remote control with battery, user manual (CD), (2) pens, USB cable, 3.5 mm cable for laser curtain
Optional Accessories	Replacement remote, cables, Lamps for Life
Interactive Technology	
Type	Laser and IR camera
Touch Points	up to 10
Camera Speed	90FPS
Accuracy	+/- 3 pixels
Reaction Time	<12ms

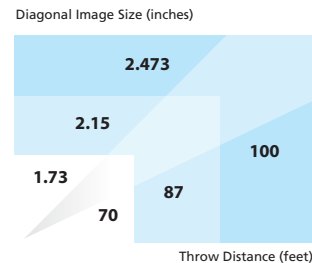

IR Camera Module	
ID Size	104.7 (W) x 118.3 (L) x 71.5 (H) mm
Weight	<165g
Power Consumption	5V/0.3A
Light Curtain Module	
Laser Safety	Class 1
Curtain to Screen Distance	70mm>A>20mm @100"
LED Indicator	Blue/Red
I/O Port	Interactive Jack x 1
ID Size	330.2 (W) x 50.7 (L) x 41.1 (H) mm
Weight	<330g
Power Consumption	12V/0.2A
General Specifications	
Calibration	4 points manual calibration for Windows Auto calibration supported
Multi-Touch	10-touch points (Win 7 & 8 compliant)
Multi-Touch Min Distance	>40mm
Working Projection Image Size	75" ~ 100" @ WXGA co-operate with TR0.35 projector
Display Mode	Support ceiling mode only
IR Camera Installation	IR camera cannot support hot plug. Before installation, please ensure AC power cord is unplugged from projector
Software Driver	
OS Required	Microsoft Windows XP (SP3) Windows 7 & 8 touch mode 10 touch points supported and mouse mode supported (Windows: .NET framework 4.0 installation is required).
Processor Type	Intel Core™ i3 or above
RAM	2GB or more
Min HDD Space	110 MB

Award Winning Technical Support 24/7/365

BOXLIGHT products come with free lifetime technical support. Speak with a hands-on, in-house, ISF Certified® technician ready to service your projector should the need arise.

www.boxlight.com
phone: 360-464-2119
text 'p10' to 51555