

*** BILL OF MATERIAL ***

REV.	DATE	DESCRIPTION	ECO	BY	C'K'D.
2	3/31/98	CHNG'D PT23400 TO PT30538 & 31FX100SHCS 1.00 LG. TO 31FX75SHCS .75 LG.	4096	PL	KH

ITEM	CATALOG NO.	QTY	DESCRIPTION
1	PT209541	1	HYPRESS HEAD
2	433-201717-003	1	END CAP
3	PT209542	1	PISTON
4	PT209517	1	DIE HOLDER
5	PT23415	1	SPRING HOLDER, UPPER
6	PT23410	1	SPRING HOLDER, LOWER
7	PT30538	1	RETURN SPRING
8	PT209543	2	DIE PIN
9	PT11454	2	COMPRESSION SPRING, .36 OD X Ø.026 X .62 LG, SS
10	078X62RLPN	2	SPRING PIN, Ø.078 X .62 LG
11	PT94	1	COUPLING, MALE
12	PT11148	1	ADAPTER, 3/8 NPT MALE TO 3/8 NPT MALE
13	433-80970-007	2	SEAL, HIGH PRESSURE
14	38CX62SHCS	1	CAP SCREW, SKT HD, 3/8-16 X .62 LG
15	31FX75SHCS	1	CAP SCREW, SKT HD, 5/16-24 X .75 LG
16	PT6554	1	SET SCREW, HEX SKT, NYLON TIP, #10-32 X .23 LG
17	411-205851-011	1	WIPER RING
18	411-205977-010	1	LABEL, Y45
NOT SHOWN	PT206016	1	CARRYING CASE
NOT SHOWN	ALFU55DRUM	3.5 in. ³	HYDRAULIC FLUID
NOT SHOWN	PT204438-01	1	WARRANTY CARD, 5 YEAR
NOT SHOWN	Y46C-CARTON	1	CARTON
NOT SHOWN	7633THERMAL	1	THERMAL LABEL

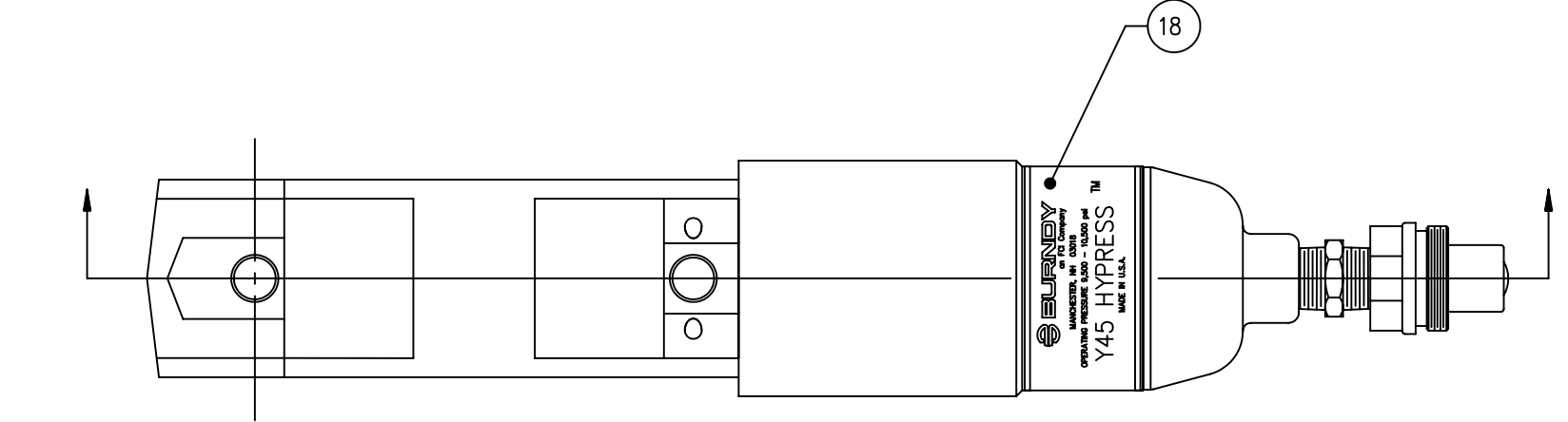

SEE PAGE 2 FOR SECTION "A"- "A"

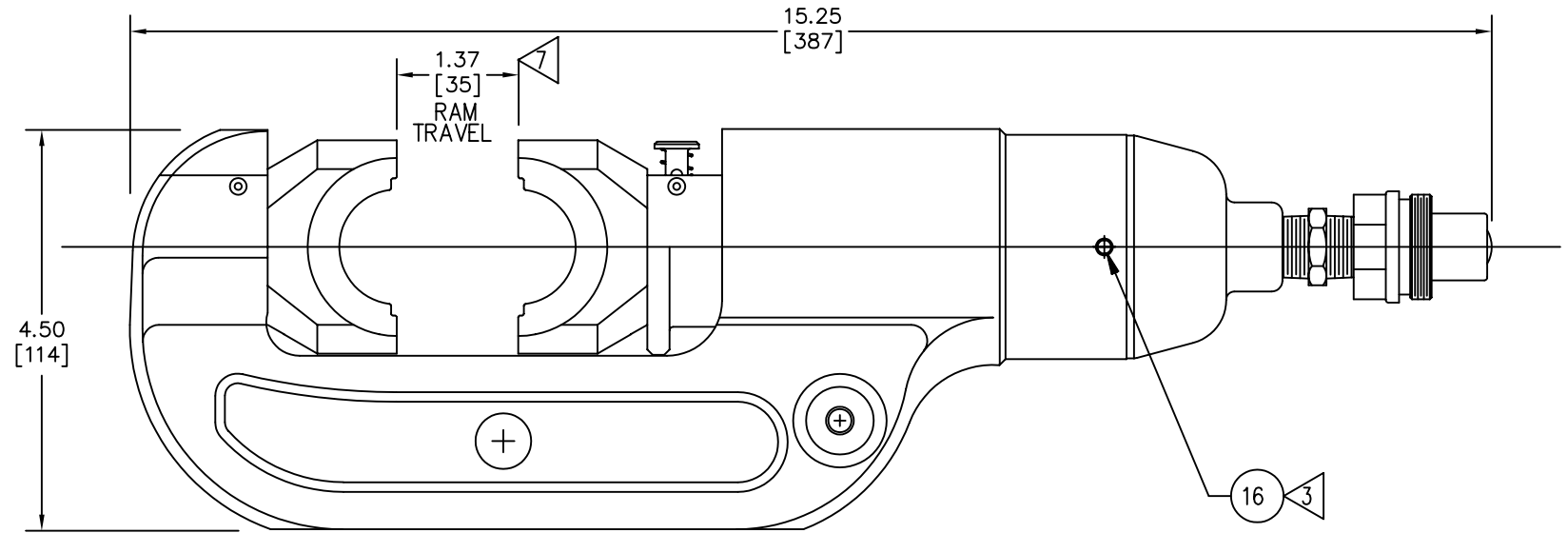

OPERATING	PRESSURE		FORCE	
	MIN	MAX	MIN	MAX
	9,500 psi	10,500 psi	29,800 lbs	32,900 lbs
	615 bar	724 bar	133 kn	146 kn
FLUID	BURNDY 'ALFLUID' OR 'HYFLUID'			

SUPERSEDES: SE206098
SE205907

FEATURES:

- WEIGHT: 15.5 lbs [7 kg].
- TOOL CASE WITH DIE HOLDER TRAY INCLUDED.
- OPTIONAL HOTSTICK ADAPTOR AVAILABLE (CAT. NO. PT23484).
- OPTIONAL ADAPTOR FOR USE WITH "U" DIE SETS AVAILABLE (CAT. NO. PT6515).
- ALSO AVAILABLE WITH MOLDED RUBBER COVERING (CAT. NO. Y45-1).
- ALSO AVAILABLE IN 6,000 psi [414 bar] OPERATING PRESSURE VERSION (CAT. NO. Y45L).
- APPLICABLE FOR BUTTING DIES. RAM TRAVEL FOR NON BUTTING DIES WILL VARY.
- DIMENSIONS IN BRACKETS [] ARE IN MILLIMETERS, ROUNDED OFF TO THE NEAREST MILLIMETER, UNLESS OTHERWISE NOTED AND ARE FOR REFERENCE ONLY.

TO ORDER BURNDY® PRODUCTS CALL UNITED STATES: 1-800-346-4175 (LONDONDERRY, NH) CANADA: 1-800-361-6975 (QUEBEC) 1-800-387-6487 (ALL OTHER PROVINCES) FOR PRODUCT INFO: http://www.burndy.com		Y45 HYPRESS™	
		ITEM NO: N/A	CAT NO: Y45
SCALE: 1/1 DRAWN BY: A MONTMINY 22/MAR/96 CHECKER: M LAROCHELLE 15/APR/96 DSN APPVL: G HESKEY 25/MAR/96 MFG APPVL: --- QC APPVL: D VARIO 27/MAR/96 MKT APPVL: M BLAKE 9/APR/96			
PROJECT #: --- DOCUMENT TYPE: Sales REL LEVEL: AutoCAD		DRAWING NO SE210372	REV 2
		SHEET 1 OF 2	