

SVW Wireless Solenoid Valve

CHARGE, RECOVER & EVACUATE WITH PRECISION

The SVW is a compact, battery operated wireless solenoid with "IN" and "OUT" 1/4" SAE male ports that quickly open or close, to control refrigerant flowing through connected hoses.

Manual Charging, Recovery or Evacuation

Once powered on, the SVW can be "manually" opened or closed by pressing the ON/OFF button. Each press of this button will "cycle" the valve to open or close (in 100 milliseconds).

Automatic Charging Or Recovery

In either mode, the SVW will precisely control refrigerant flow in one of two ways:

1. Pair the SVW to the CPS CC220EW Enhanced Wireless scale (sold separately). Then, input a charge or recovery weight into the scale's corded hand control (memory).
2. Pair the SVW to a mobile device running the CPS Link™ app. Then, pair the mobile device to any CPS wireless scale, and input a charge or recovery weight into the mobile device.

In both methods, weight sensed by the scale is transmitted to the SVW, which opens or closes to regulate refrigerant flow through hoses connected to a supply or recovery tank.

KEY FEATURES:

- Operate manually (using On/Off key) with other service equipment or in automatic mode
- Ensures fast, On/Off control of refrigerants during service routines
- Saves time, reduces cost and extends service equipment life
- Compatible with all common CFC, HFC, HCFC refrigerants and blends
- Transmits up to 150 ft (45m) for up to 500 hours



Charging



Recovery

ADDED FUNCTIONALITY IF PAIRED TO A MOBILE DEVICE (Running The CPS Link™ App):

- **Store Job Data** - Work orders, invoice # and customer.
- **Create & Store Customer Data** - Name, address, phone, e-mail, notes.
- **Tank Tracker (For Automatic Charging/Recovery)** - Track refrigerant used on jobsites, plus time, date, location where used.
- **Export** - E-mail files to customer or home office.



Automatic Charge



Automatic Recovery



Automatic Evacuation



SVW SPECIFICATIONS

Control By Wireless/Corded Scale	Use with CC220EW (With LCD display)
Control By Mobile Device Running CPS Link™ App	Use with CC220EW or other CPS wireless scale
Turn ON	Press ON/OFF button (2 secs) until LED turns green. Release button to operate.
Turn OFF	Press and hold ON/OFF button (5 secs) until the LED turns OFF. Release button.
Cycle Solenoid ON/OFF (While SVW ON)	Press and release (pulse) the button.
Solenoid Open/Close Time	100 Milleseconds
Auto Power Off (ENABLED)	SVW turns OFF after set period of inactivity (default: 10 mins)
Auto Power Off (DISABLED)	Disable via APP
Charge/Recover Alarms	In CC220EW control and mobile device
Wireless Connectivity	Bluetooth®
Transmission Range (Line Of Sight)	Up to 150 feet
Frequency Range	2400 to 2480 MHz
Power Source	9V Alkaline (Included)
Continuous Battery Life	Up to 500 hours
Battery Status Indicator	On mobile device
Width x Length x Height, Weight (+ Soft Case, Battery)	2.7" x 4.5" x 3" (70 x 83 x 76 mm), 11.5 Oz (0.32 kg)
Maximum Working Pressure	500 Psig (34.5 Bar)
Maximum Operating Differential	485 Psig (33.5 Bar)
Operating Temperature	14°F to 122°F (-10°C to 50°C)
Operating Humidity	0% to 95% (Non-condensing)
IN/OUT Fittings	Brass, 1/4" SAE male
Refrigerant Compatibility*	All common CFC, HFC, HCFC refrigerants and blends
Approvals	FCC, IC, CE
Warranty	1 Year

*Not for use with Ammonia refrigerant. Nitrogen and CO₂ must be regulated.

AUTOMATIC CHARGE (2 Wireless Methods)

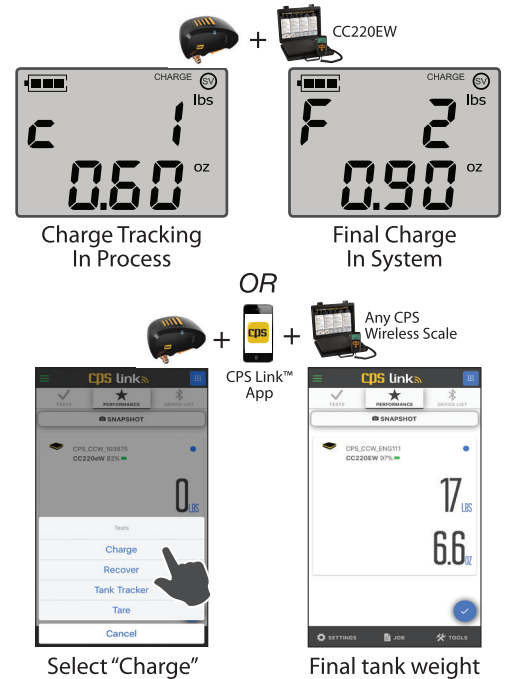

AUTOMATIC RECOVERY (2 Wireless Methods)

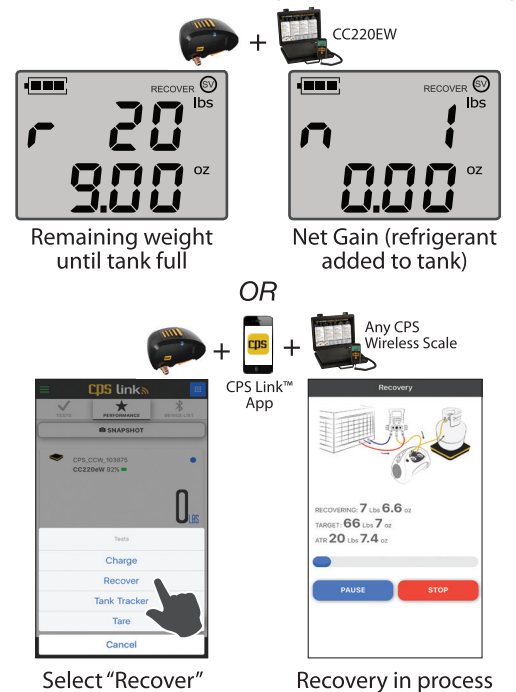

PACKAGING

	H x W x D, Inches	Weight, Lbs(kg)	Product Qty Per	Bar Code
Individual Packaging (LWH)	3.5" x 3.5" x 7.6"	.71 lb (.32 kg)	1	750377116384
Master Carton (LWH)	11.25" x 7.5" x 8"	6.23 lbs (2.82 g)	6	n/a

Includes color retail box, owner's manual and double wall, cloth embroidered storage pouch with zipper closure.



Color Box



Cloth Storage Pouch

LTSW-0518A