

CT-LS SERIES

5 A Secondary Current Transformers

5 A Secondary Current Transformers offer a compact, cost-effective means of measuring primary current. These current transformers provide an easy-to-install method to measure AC current, producing a 0–5 amp output proportional to the current flowing through the sensing window. The CT-LS series offers a large sensing window and a split-core design for easy installation.



Current Transformer Applications

Serves as current input for use with APT and APN series KW transducers.

- Saves space in control panels by remotely locating the sensing of the current closer to the load.
- The current transformer secondary can be connected to the NK CTC-05A-420-24L-DIN to produce a loop powered, 4–20 mA signal proportional to the current through the CT.

Current Transformer Features

- Split-core case for convenient installation over large wires or bus bars.
- 5 A secondary is compatible with standard power monitors and panel meters designed for the 5 A input.
- LS series with large sensing window (3.42" x 2.30") available to measure current from 0–800 to 0–1600 A.
- Plated terminals for reliability.
- Designed to meet UL, CUL and CE approval.

Power-Pump Load Monitoring

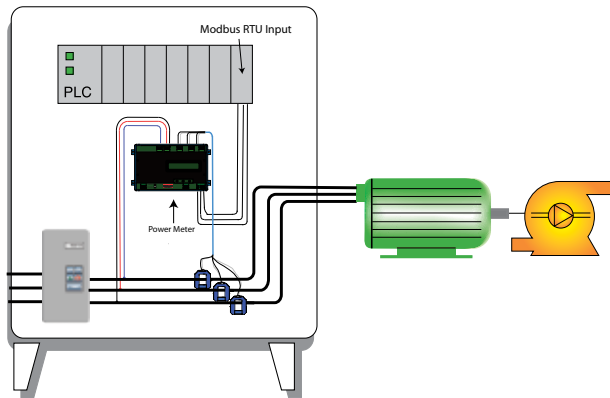

Current Transformer Dimensions

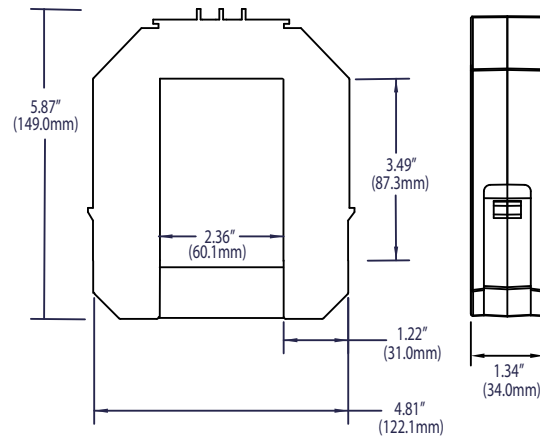

OEMs Test & Evaluation Units for OEMs
Free program expedites evaluation process. See page 1 for details.

Current Transformer Connections

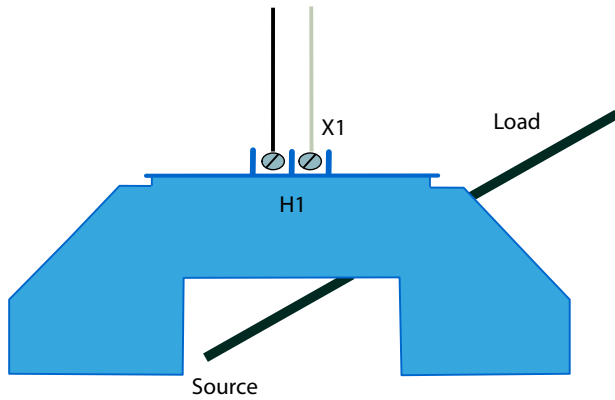

A current transformer (CT) should never be energized (AC current through the sensing window) without a load connected to the output terminals. Best practice is to terminate the current transformer secondary on a terminal block with the ability to short between two points before extending the leads to the load. If it is ever necessary to remove the load from the CT while it is or could become energized, a shorting bar can be placed between the secondary loads, as shown below in the drawing on the right. This will allow the load to be removed safely.

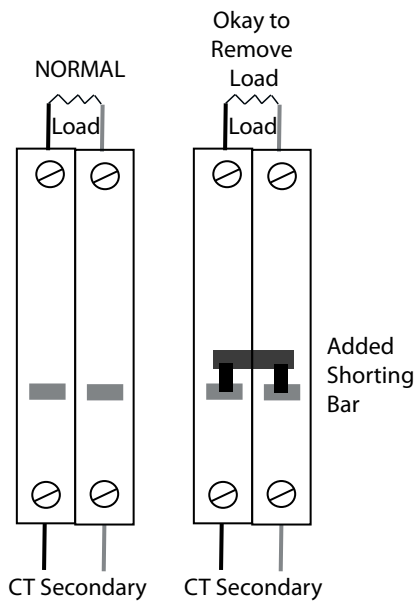

Current Transformer Specifications

Power Supply	None - Self-Powered	
Current Ranges	0–800 through 0–1600 A	
Output Signal	0–5 A (AC)	
Frequency	50–60 Hz	
Insulation Class	0.6 KV BIL, 10 KV full wave	
Accuracy	±1% (10–100% of range) to 50°C	
Linearity	0.5% (10–100% of range)	
Thermal Rating	3.5 W @ 30°C	
Weight	800:5	2.0 lbs.
	1000:5	2.2 lbs.
	1200:5	2.3 lbs.
	1600:5	2.4 lbs.
Allowable Burden	800:5	10 VA
	1000:5	10 VA
	1200:5	10 VA
	1600:5	12.5 VA

Current Transformer Ordering Information

Sample Model Number: CT-0800-5A-LS

Current transformer with 800:5 ratio allowable burden, 5 A secondary output, and large sensing window.



(1) Model

0800	800:5 ratio
1000	1000:5 ratio
1200	1200:5 ratio
1600	1600:5 ratio

(2) Output Signal

5A	5 A secondary
----	---------------

(3) Case Style

LS	Large sensing window
----	----------------------

