

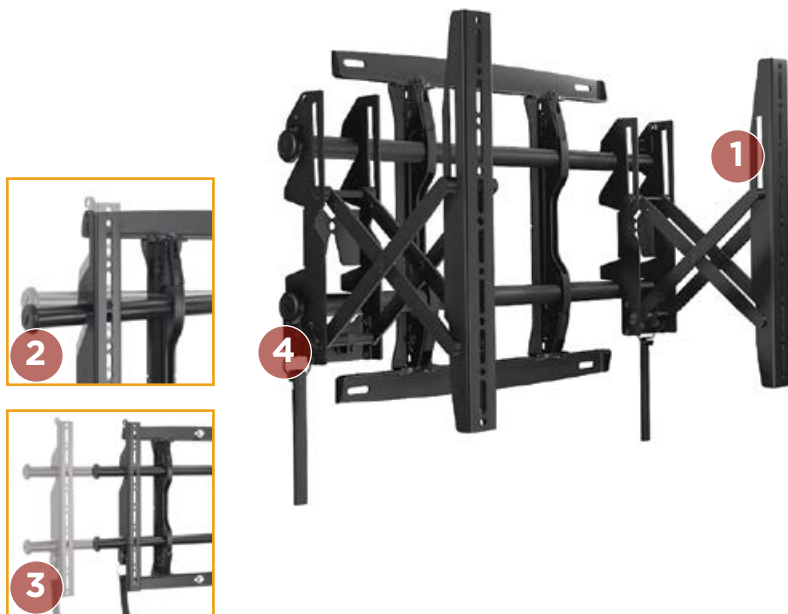

VIDEO WALL MOUNTS

MSMVU 26 - 47" PULL-OUT WALL MOUNT

FUSION® SERIES



FEATURES

- PULL-OUT EXTENSION**
Extends from 3.7" (94 mm) to 10.7" (272 mm) to allow cable access for installation and servicing of video walls and recessed applications.
- CONTROLZONE™ LEVELING**
Industry-first feature allows post-installation fine tuning of height and leveling for perfect screen alignment.
- CENTERLESS™ SHIFT**
Provides up to 14.5" (368 mm) of post-installation lateral shift - 7.25" (184 mm) left/right of uprights - for limitless centering capabilities and screen alignment.
- CLICKCONNECT®**
Hear an audible click when the screen safely engages with the mount. A built-in cable stand provides easy access under the screen.

WHAT YOU NEED TO KNOW

INSTALLATION AND SECURITY

Allows fine-tuning plumb adjustment to ensure screens are perfectly vertical for a seamless install. For additional security, just add a padlock to the integrated locking latch.

MULTI-SCREEN CONFIGURATION

Recommended for 2 x 2 video matrix and larger.

OTHER PRODUCT OPTION



MSMVPU

Portrait Pull-Out Wall Mount

SPECIFICATIONS

Extension	7" (178 mm)
Depth from Wall	3.7" (94 mm)
Plumb Adjust	2.5°
Max Mounting Pattern (H,W)	15.75" (400 mm) 21.3" (540 mm)
Weight Capacity	125 lbs (56.7 kg)
Color	Black

RECOMMENDED ACCESSORIES



FCA100 ■ CAT 5/Surge CPU Adapter

TECHNICAL DRAWINGS

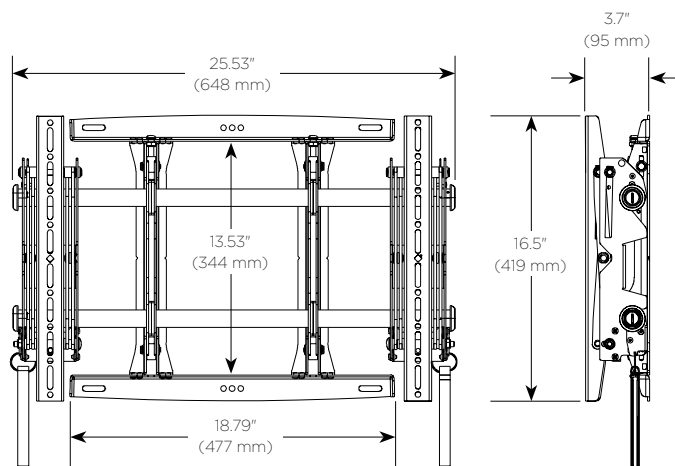

Touchboards

205 Westwood Ave, Long Branch, NJ 07740
Phone: 866-94 BOARDS (26273) / (732)-222-1511
Fax: (732)-222-7088 | E-mail: sales@touchboards.com

For a complete list of FUSION accessories see pages 86 - 88.