



CONEN[®] *mounts*

workITdesk

Designed for **EPSON[®]** BrightLink[®] Pro

Touchboards

205 Westwood Ave, Long Branch, NJ 07740
Phone: 866-94 BOARDS (26273) / (732)-222-1511
Fax: (732)-222-7088 | E-mail: sales@touchboards.com



Installation guide for workITdesk interactive table
for **EPSON[®]** BrightLink[®] Pro

Mounting the table unit

1

Unpack boxes 1 of 4 (Mobile base) and 2 of 4 (Motorized center column) and attach base to column using the 4 x M8 x 40 (1/3" x 1.6") Allen screws + 4 washers.

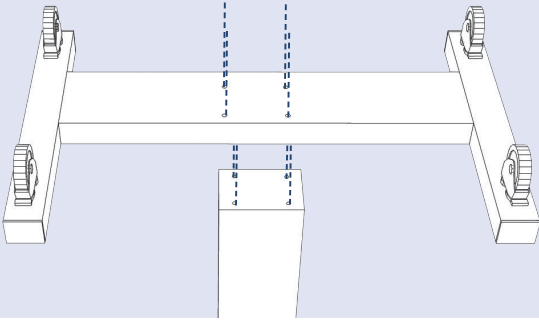

2

Unpack box 3 of 4 (Board frame w. tilt actuator) and attach frame to column using the 4 x M8 x 40 (1/3" x 1.6") Allen screws + 4 washers.

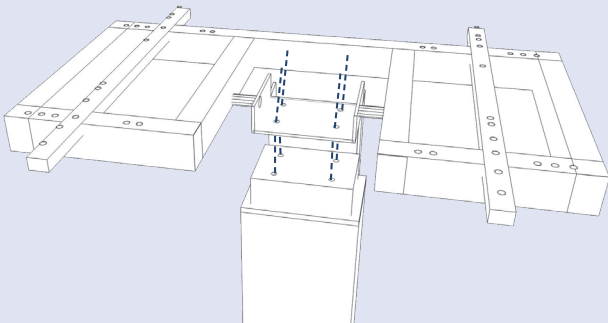

Make sure to run the two cables exiting the column through the cut out of the board frame before securing the 4 bolts.



3

Unpack box 4 of 4 (50" x 67" table top) and hang the board onto the frame.

Secure the board to the frame using the 4 x M6 x 70 (0.23" x 2.75") Allen head screws. They need to be inserted in the outer most holes on top and bottom of the frame.



4

Release the two bolts on the brackets on the back of the board and slide in the projector arm. Align the stripe on the arm, 6.8" from the top, with the upper edge of the top bracket. Secure the arm by tightening the bolts on both top and bottom bracket.

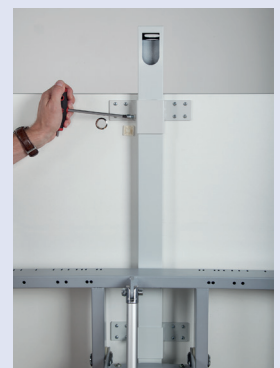

Attach Control Pad & Finger Touch Unit and feed cables (parts supplied with projector)

5

Attach Finger Touch Unit with 3 x Phillips head screws (0.165" x 1.25").



6

Attach Touch Panel with 4x Phillips head screws (0.165" x 0.63").



7

Feed the cable, which links FTU to the projector, through the opening in the board and plug in the connector.



8

Plug in both cables into the Control Pad (USB + 3.5mm audio).



9

Feed all cables to the projector through the projector arm (from bottom to top of the arm).

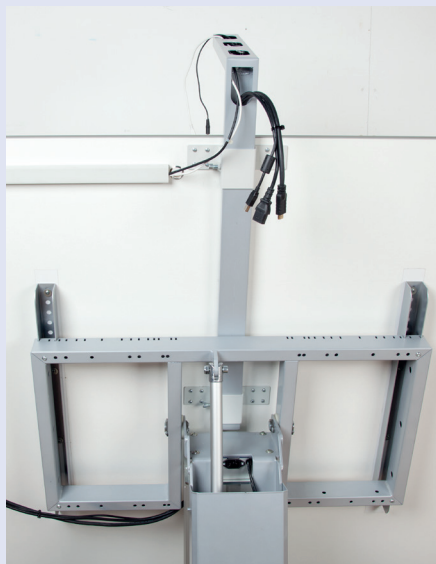

Power up the unit

10



Put the plug of the external actuator into the connector marked with the yellow dot.



Plug in the remote control into the remaining connector.

Note the different numbers of pins on both plugs!



User guide for electrical height adjustable unit

Pressing knob raises lift unit

Pressing knob lowers lift unit

Pressing knob moves frame unit to the horizontal position (tiltable units only)

Pressing knob moves frame unit to the horizontal position (tiltable units only)



Use of the remote control

For moving the unit up or down just press the buttons on the control unit. Releasing the button will immediately stop the movement. In case of emergency just unhand the control unit (watch dog switch). For further information your dealer will be at your disposal.

Mount the projector

11



4 x distance tube 20 mm
4 x rubber buffer 13 mm
4 x washer 8 mm

Mount the projector plate to the projector. Start by placing the 0.8" plastic spacers on all 4 inserts. Place the 0.5" rubber buffers on top of the plastic spacers and finally put the washers on top.

12



Carefully place the projector plate on top of the spacers and washers and secure the plate with 4 x allen head screws M4 x 45 (0.15" x 1.8").

Attach the bracket, which will hold the projector to the projector arm, to the projector plate with 4 x allen head screws M6 x 10 (0.24" x 0.39").

Do not tighten the screws yet.

13



Attach the projector to the arm and tighten the screws.

14

Adjust the projector

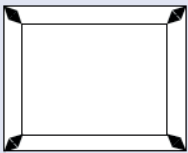

Picture is too small or too big:

To increase picture size loosen the adapter **E** and slide it over the tube away from the board. To decrease picture size move the projector towards the board. Tighten all screws securely afterwards.

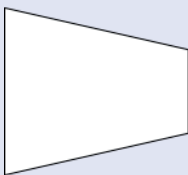

Horizontal keystone correction:

Loosen the adapter **E** and turn the projection to the right side if the picture is too small in the right side. Turn the projector the other way around, if the picture is too small in the left side.

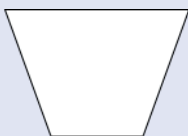

Vertical keystone correction:

If the picture is bigger at the top than at the bottom, secure the screws **C** and **D** or loosen the screws **A** and **B** at the same time. If the picture is smaller in the top than in the bottom, tighten **A** and **B** or loosen **C** and **D**.



Picture is not centered:

Loosen the screws **A**, **B**, **C** and **D**. Move the projector in the right direction. Tighten all screws again.

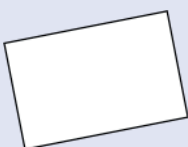

Picture is not straight:

If the picture does fall down the left side, tighten the screws **A** and **C** and loosen the screws **B** and **D**. If the picture does fall down the right side, tighten the screws **B** and **D** or loosen the screws **A** and **C**.

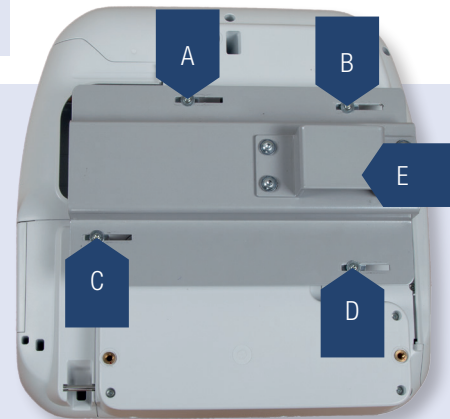

Important hazard and safety notes

Please carefully read the below hazard and safety notes before using the hight adjustment unit.

Electrical safety



Connect unit to a free accessible 110 – 230 V / 50 Hz grounded power outlet only. Make sure, the unit can be immediately separated from the power outlet.
Only use unit in dry rooms, protect unit from water and other liquids.
Clean center column with dry cloth only.
Do not open lift unit. **RISK OF ELECTRIC SHOCK.** There are no serviceable parts inside.
In case of malfunction unplug unit from power outlet and call your dealer.
Do not overrun the power cord or damage it in any other way. Replace damaged power cord immediately.



Ensure easy access of wall socket and power strip attached to the unit.



The device is not water proof.
Do not place liquids on the table.

General hints for mechanical safety



Max. load capacity of the lift unit is 300 lbs. Do not add any additional weight to the system, other than the components described in this manual. Do not sit, hang or lie on the table!
! VERY HEAVY UNIT.
Severe risk of injury when unit tips over due to improper use. Before adjusting height or tilt of the table, ensure no person or object is within 20 cm from the moving parts of the table, in order to avoid getting trapped or squeezed. In case of accident immediately release the button on the remote.
This will immediately stop the unit.

Special hints for moveable und free standing units



Only operate unit on plane and stable floors. Move unit on plane floors only.
Beware when moving the unit; risk of tipping over when overrunning floor unevenness, wdoor sils or similar.
! VERY HEAVY UNIT.
Severe risk of injury when unit tips over.
Lock brakes of front wheels when operating unit.

Instructions for disposal



Do not dispose to consumer waste.