



CONEN



INSTALLATION GUIDE

FOR WALLMOUNTED AND MOBILE ELECTRICAL
HEIGHT ADJUSTABLE „LITE“ SYSTEMS FOR
USE WITH 42 – 84" DISPLAYS

CONTENT

Important hazard and safety notes	5
EC-Declaration of conformity	6 – 7
Assembly instructions	10 – 11
Systems with floor panel	10
Wall mounted systems	10
Mobile systems	10
„Lite“ frame installation	11
Operating unit for height adjustment	11



Thank you for purchasing our electrical height adjustable units. Please carefully read all provided informations before assembling and usage. Assembly is uncomplicated but should be done by trained personal only.

General hints for startup

Before connecting the unit to the power supply please check that up/down movement of the unit will not be blocked by any table, chair, other furniture etc. Please also read attached hazard and safety notes.

Limitation of usage

This unit must not be equipped / used with other components (i.e. trolley, frame unit for interactive components, etc.) but those, which are certified by us.

We cannot take over any warranty for safety and proper function for third party components.

Hint

Changes made to components, which serve to technical progress, can be put into effect without prior notice.

Important hazard & safety notes

Please carefully read the below hazard and safety notes before using the height adjustment unit. This adds to make the unit work failure-free and avoids accidents.

Electrical safety



Connect unit to a free accessible 110 – 230 V / 50 Hz grounded power outlet only. Make sure, the unit can be immediately separated from the power outlet.
Only use unit in dry rooms, protect unit from water and other liquids. Only wipe unit with dry cloth. Do not open lift unit. **RISK OF ELECTRIC SHOCK.** There are no serviceable parts inside.
In case of disfunction unplug unit from power outlet and call an authorised technical service person. Do not overrun line cord or damage in any other way. Replace damaged line cords immediately with new one from same type.



The socket connections of the unit and the wall socket must be easily accessible.



The device is not dripping or splash water protected.
Do not place objects filled with liquids on or spray the device.

General hints for mechanical safety



Do not improperly load unit. Do not mount other than original parts (whiteboard, wings, interactive board, interactive monitor, projector) in conjunction with original mounting parts. Do not hang on unit.
VERY HEAVY UNIT.
Severe risk of injury when unit falls over due to improper usage. Only use original mounting parts provided with the system. Max load of lift unit is 150 kg/ 330 lbs. Do not exceed.
Assure installation of unit by authorized service person only.
Before moving the unit up or down ashure at least a safety distance of 20 cm/ 7.9 from any part of the unit to any other fitment in order to avoid shear traps or squeezing points.
In case of accident please release operating panel. Movement of unit will stop immediately.

Special hints for moveable und free standing units



Only operate unit on plane and stable floors. Move unit on plane floors only.
Risk of tilting when overrunning floorunevennesses, door sills and similar.
VERY HEAVY UNIT.
Severe risk of injury when unit falls over. Lock brakes of front wheels when operating unit.

Special hints for wall mounted units



Use appropriate wall mounting material only. Choose douwels and screws according to the wall type and material. Using improper mounting material may result in tilting of the unit and severe risk of injury.
Wall mounting must be done by experienced personal only.

Instructions for disposal



Do not dispose to consumer waste.

EC-DECLARATION OF CONFORMITY in accordance with European directive 2006/42/EG, part II A

We hereby certify that the machine described hereafter, in its design and construction and in the model put into circulation, complies with all relevant health and safety requirements of the EC machinery directive 2006/42/EG. Any modification to our product, without our written consent, will result in this declaration to become void.

Manufacturers name or of his representative	Conen Produkte GmbH, D - 54497 Morbach-Gonzerath
Description of the machine	Motorized lift system for displays and (interactive) boards
Part-No.	SCETA (-L) / SCETA-W(L) / SCETTA/ SCETAVLI / CCELW-AF
European directive(s)	EC-machinery directive (2006/42/EG) EMC directive (2014/30/EU) WEEE-Directive 2012/19/EU WEEE-Registration-Nr 12204025
European standards	EN 14434:2010-04 / EN 60335-1:2012 / EN 62233:2008 EN 61000-3-2:2006+A1:2009 EN 61000-3-3:2008 EN 61000-6-1:2007 EN 61000-6-3:2007 EN 55024:2010 / 55014-1:2006+A1:2009+A2:2011
National standards and specifications	ROHS Directive 2011/65/EU IEC 61558-1 und 2:2009 C/US Authorisation to Mark „ETL“
Person in charge for document collection	Jürgen Heesen
Declaration signed by	Marcus Staudt
Position	Product development
Date and signature	10.08.2018, 

MOBILE SYSTEMS

FOR V-STAND

Connect the trolley to the column.

- 4 x lens head Allen screw with flange
M8 x 40 mm



Stirling Communications Supply Co| 29 Poplar Drive, Stirling NJ 07980 | 908-604-9360|
sales@stirlingcomm.com | www.stirlingcomm.com

SYSTEMS WITH FLOOR PANEL

FOR FLOOR PANEL

Connect the floor panel to the column.

- 4 x countersunk Allen head screw
M8 x 40 mm



WALL MOUNTED SYSTEM

1.

Fix 2 x Z-bracket to the wall.

Wallmounting material is not included.

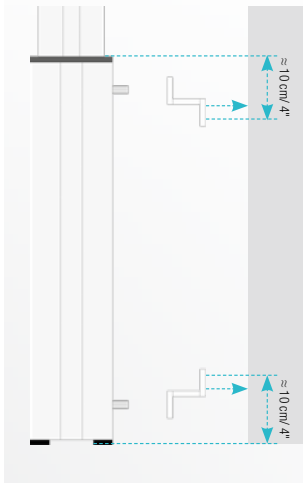

2.

- 1 Put 2 sliding blocks into the rail
- 2 Connect it to the Z-bracket
- 3 Screw the floor leveling feet against the floor

- 2 x selflocking nut M8
- 2 x washer 8 mm

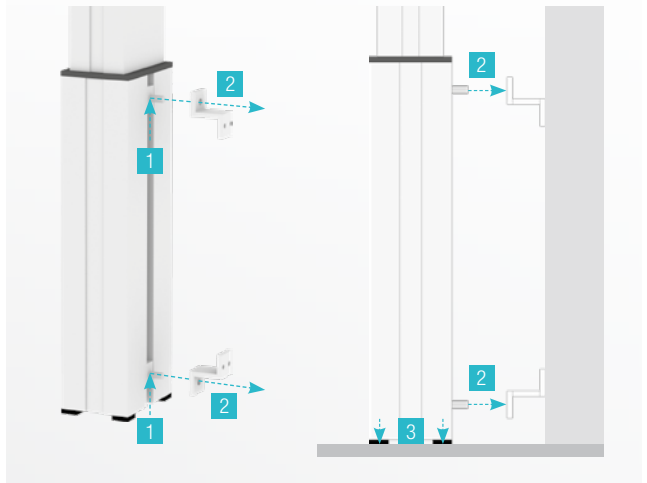

„LITE“ FRAME INSTALLATION

1.

- 1 Attach upper bar using 2 x lens head Allen screw with flange M8 x 85 (long) and ensure the slotted holes facing upwards and towards the screen.
- 2 Attach lower bar using 2 x M6 x 30 (short) screws and ensure the slotted holes facing floor and towards the screen.

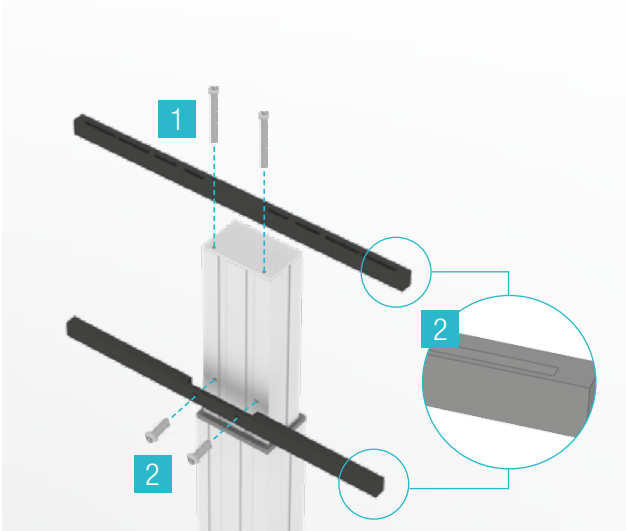

2.

Secure “lift & lock”-brackets to the display, before attaching to mount.

To attach the display to the mount use the included 4 x M8 x 16 mm or 4 x M6 x 16 mm lens head Allen screw with flange.

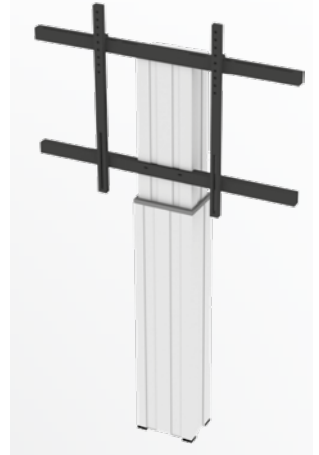

OPERATING UNIT FOR HEIGHT ADJUSTMENT

1.

For moving the unit up or down just press and hold the buttons on the control unit. Releasing the button will immediately stop the movement. So in case of emergency just unhand the control unit (watchdog switch).

Height adjustable

A Up

B Down

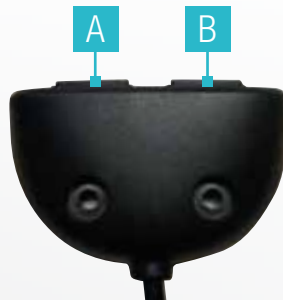

2.



Connect the 5-pole plug of the cable remote control to the column.

3.

Connect the power cable to the column.

