

500MHz 10x Fixed Passive Voltage Probe – Deluxe

● CT3288ARA – IMPROVED –

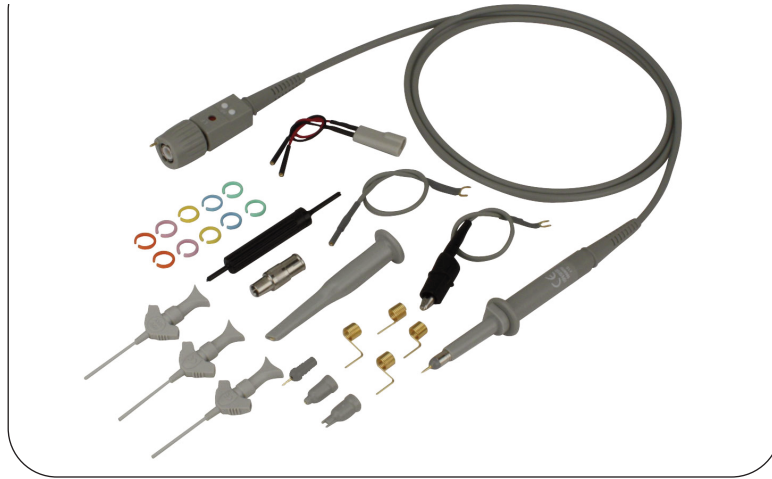

FEATURES:

- Updated Accessory Complement
- 500MHz bandwidth (-3dB)
- Readout Actuator Pin (Sense Pin)
- Slim, stylish body
- Meets IEC61010-031 CAT II
- Snap-Locking sprung hook
- Advanced accessory selection

HIGH-PERFORMANCE PROBE FAMILY PROVIDES THE BEST OF BOTH WORLDS WHEN SELECTING A REPLACEMENT PROBE:

The **improved** model CT3288ARA Passive Voltage Probe offers both high performance and cost effectiveness when used with your high frequency oscilloscopes and now a new expanded offering of connection accessories. Featuring a 500MHz bandwidth with fixed 10x attenuation, the probe is compatible with popular scopes from Agilent®, LeCroy, and Tektronix®.

The probe is ideal for electronic, industrial or control applications. Model CT3288ARA includes a readout actuator pin (sense pin) which makes it compatible with oscilloscopes that automatically detect and display the probe attenuation factor.

As with other members of High-Performance probe family, the CT3288ARA features a low noise figure, quality construction, and a unique "snap-locking" sprung hook.

For additional product information, cross-reference, or probe accessories, visit our web site at www.caltestelectronics.com.

SPECIFICATIONS:

- Attenuation ratio - 10x (10:1)
- Bandwidth - DC to 500 MHz
- Rise time - 0.7 nS
- Compensation range - 9 to 18 pF
- Input resistance - 10 MΩ
- Input capacitance - 12 pF
- Max. input voltage - 600 V CAT I
300 V CAT II
(DC + Peak)
- Derated with frequency
- Working temperature - +55° C
- Cable length - 1.2 m
- Safety - Meets EN61010-031 CAT II

ORDER INFORMATION:

CT3288ARA

10x, 500MHz Oscilloscope Probe – IMPROVED

Kit Includes:

Probe and accessories listed below. (Replaces CT3288RA)

KIT CONTENTS:

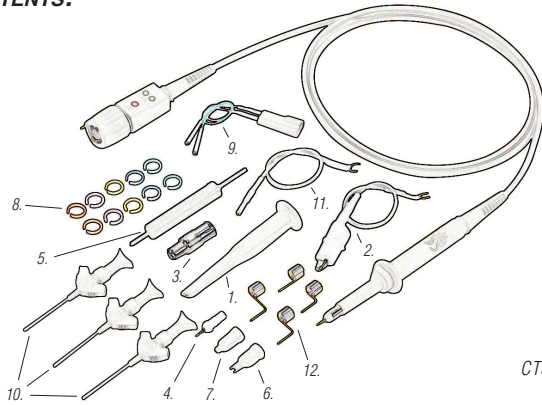

CT3288ARA pictured

Itm.	Description	Model	Qty.
1.	Sprung Hook, 5 mm, Grey	CT2709A-8	1
2.	GND Lead w/Alligator Clip	CT2710-12-8	1
3.	BNC Adapter, 5 mm	CT2708	1
4.	Replacement tip, Grey	CT2711A-8	1
5.	Deluxe Trimmer Tool	CT3648	1
6.	IC Tip Insulator, 5 mm, Grey	CT2713A-8	1
7.	Tip Insulator, 5 mm, Grey	CT2712A-8	1
8.	Identifier Rings (5 x 2 colors)	CT3662	1
9.	Twin Lead Adapter, 5mm	CT3679 ⁽¹⁾	1 New
10.	SMT IC Test Clip, Grey	CT3659-8	3 New
11.	GND Lead w/0.6 mm Jack	CT3669-15-8	1 New
12.	Probe Tip GNDs (0.1, 0.2, 0.3 & 0.4")	CT3668 ⁽³⁾	1 New

CONTACT INFO:

Toll Free: 888-256-2246 (US Only)

Phone: 714-221-9330

Fax: 714-921-9849

22820 Savi Ranch Pkwy

Yorba Linda, CA 92887-4610 USA

www.caltestelectronics.com

(1) Twin Lead Adapter includes two SMT IC Test Clips.

(2) Kit consists of Probe Tip Grounds (0.1, 0.2, 0.3 & 0.4").

VOLTAGE DERATING CURVE:

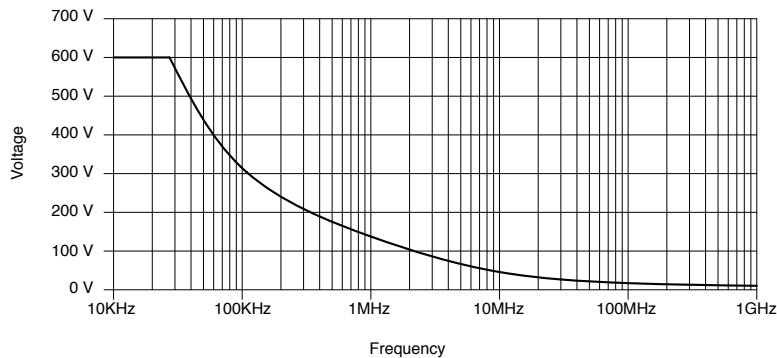

Specifications and appearance subject to change without notice
 P3288ARA 120208

2 - www.caltestelectronics.com

Copyright © 2008, Cal Test Electronics, Inc. All rights reserved. Information in this publication supersedes that in all previously published material. Trade names referenced are the service marks, trademarks or registered trademarks of their respective companies.

