

Enliven Presentations, Capture Ideas



The big ideas that drive business happen in real time, but even the most monumental thoughts can be lost if they aren't communicated effectively and captured as they happen.

eBeam Edge for Business is the premier corporate interactive whiteboard solution, allowing businesses to communicate and capture ideas.

Unlike conferencing solutions, which are limited in their two-way interaction, eBeam Edge gives business users the ability to effectively collaborate, efficiently capture and clearly communicate ideas in person, over the web or anywhere in between – in real time.

eBeam Workspace™ software provides an intuitive user interface and tight integration with many of today's most familiar business software such as Microsoft PowerPoint to ensure that eBeam Edge can be installed in minutes and used by virtually anyone who walks into a conference room.

The combination of a simple hardware setup, streamlined software and free meeting sharing keeps the focus on what matters: communicating and capturing ideas.



Highlights

- Turn any surface into a collaborative workspace
- Bring your presentations to life by annotating in PowerPoint™ on-the-fly
- Collaborate with worldwide colleagues using free and secure meeting sharing
- Create multi-page brainstorm sessions that can be saved or resumed at any time
- Manipulate whiteboard content by moving and resizing your drawings and imported images
- Markup any content on your computer: Office documents, webpages, images, and more
- Easy-to-use interface
- Easy and flexible installation
- Ultra-responsive sensor for realistic writing and drawing experience
- Measures less than 8 inches
- Weighs less than 4 ounces
- Portable enough to carry in a laptop bag
- Mounts easily to any surface
- Allows for placement along any “edge” of the board
- Active surface area up to 9' x 5'
- One-button access to calibration
- Free software and firmware updates
- Seven year limited warranty*

*Contingent upon meeting Luidia requirements

Specifications

Windows®

- At least a Pentium™ IV processor, 1.4GHz, with 512 MB RAM
- Windows 2000/XP/Tablet PC or Vista
- 40 MB available hard drive space
- Available USB or Bluetooth® port

Positional Accuracy

- +/- 1.5mm

Bluetooth

- Radio range: up to 33 ft (10 m)

Components

- (1) USB or USB/Bluetooth eBeam Edge receiver
- (2) Mounting plates
- (1) eBeam stylus
- (1) AAA battery
- (1) eBeam LiveWire™ with Workspace
- (1) CD with eBeam Workspace software
- (1) 16' (5m) USB cable
- Power adapter (BT version)
- USB Bluetooth adapter w/ software (BT version)

How It Works

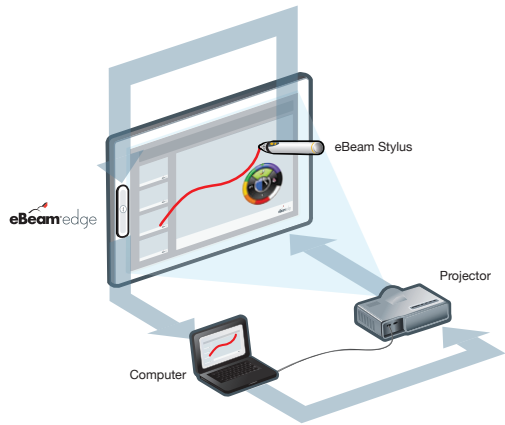

USB

Bluetooth®

Luidia 

www.luidia.com

Touchboards

205 Westwood Ave, Long Branch, NJ 07740
Phone: 866-94 BOARDS (26273) / (732)-222-1511
Fax: (732)-222-7088 | E-mail: sales@touchboards.com

Luidia, Inc. is a global provider of innovative idea-capturing systems for education, distance learning, conferencing, audio/visual and office products markets. Industry leaders such as 3M, Alfher, edding®, Acco®, NEC and Uchida incorporate Luidia's eBeam Enabled™ technology into their interactive product lines. © 2010 Luidia, Inc. All rights reserved. eBeam and the eBeam logo are trademarks or registered trademarks of Luidia, Inc. Other product names and logos may be trademarks or registered trademarks of their respective owners.