

Touchboards

205 Westwood Ave, Long Branch, NJ 07740
Phone: 866-94 BOARDS (26273) / (732)-222-1511
Fax: (732)-222-7088 | E-mail: sales@touchboards.com

eBeam[®]edge
for business

Get Your Point Across



The big ideas that drive business happen in real time, but even the most monumental thoughts can be lost if they aren't communicated effectively and captured as they happen.

eBeam Edge for Business is the premier corporate interactive whiteboard, allowing businesses to cultivate a world of ideas that drive success anytime, anywhere, and from anyone. Unlike conferencing solutions, which are limited in their two-way interaction, eBeam Edge gives any business the ability to effectively collaborate, efficiently capture, and clearly communicate big ideas in person, over the web, or anywhere in between—in real time.

The included eBeam Workspace™ software provides an intuitive user interface and tight integration with many of today's most familiar business software applications to ensure that eBeam Edge can be used by virtually anyone who walks into a conference room.

The combination of a simple hardware setup and streamlined software eliminates the hassle from starting a meeting and keeps the focus on what matters: what's happening in the meeting.

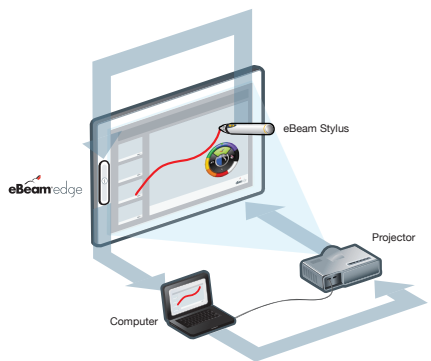

Highlights

- Turn any surface into a collaborative workspace
- Bring your presentations to life by annotating in PowerPoint on-the-fly
- Collaborate with colleagues across the web using free and secure meeting sharing
- Create multi-page brainstorm sessions that can be saved or resumed at any time
- Manipulate whiteboard content by moving and resizing your drawings and imported images
- Markup any content on your computer: Office documents, webpages, images, and more
- Innovative and easy-to-use interface
- Easy and flexible installation
- Ultra-responsive sensor for realistic writing and drawing experience
- Measures less than 8 inches
- Weighs less than 4 ounces
- Portable enough to carry in a laptop bag
- Mounts easily to any surface
- Allows for placement along any “edge” of the board
- Activates surface area of up to a 9' x 5'
- One-button access to calibration
- Free software and firmware updates
- Two year limited warranty

Specifications

Windows®

- At least a Pentium™ IV processor, 1.4GHz, with 512 MB RAM
- Windows 2000/XP/Tablet PC or Vista
- 40 MB available hard drive space
- Available USB or Bluetooth® port

Positional Accuracy

- +/- 1.5mm

Bluetooth

- Radio range: up to 33 ft (10 m)

Components

- (1) USB or USB/Bluetooth eBeam Edge receiver
- (2) Mounting plates
- (1) eBeam stylus
- (1) AAA battery
- (1) eBeam LiveWire™ with Workspace
- (1) CD with eBeam Workspace software
- (1) 16' (5m) USB cable
- Power adapter (BT version)
- USB Bluetooth adapter w/software (BT version)



USB



Bluetooth



Windows®



www.luidia.com

Touchboards

205 Westwood Ave, Long Branch, NJ 07740

Phone: 866-94 BOARDS (26273) / (732)-222-1511

Fax: (732)-222-7088 | E-mail: sales@touchboards.com

Luidia, Inc. is a global provider of innovative idea-capturing systems for education, distance learning, conferencing, audio/visual and office products markets. Industry leaders such as 3M, Alther, edding®, Acco®, NEC and Uchida incorporate Luidia's eBeam Enabled™ technology into their interactive product lines. © 2009 Luidia, Inc. All rights reserved. eBeam and the eBeam logo are trademarks or registered trademarks of Luidia, Inc. Other product names and logos may be trademarks or registered trademarks of their respective owners.