



American Hakko Products, Inc.

PRODUCT BULLETIN

Bulletin No: PB317

Issue Date: 8-16-2011

Available: 9-6-2011

Product Description:

Hakko FM-2030 Heavy Duty Soldering Iron and Tips

Part No:

FM2030-01, FM2030-02, T22-xx

Specification:

Hand Piece Specifications	
Model	FM-2030
Part No.	FM2030-xx
Power Consumption	140W 24VAC
Tip-to-Ground	< 2 Ω
Leak Voltage	< 2 mV
Length (w/o cord)	155 mm (6.1 in.)
Weight (w/ cord)	32 g (0.07 lb)
Reach	1.3 m (4.3 ft)
Tips	T22 Series (Not Included)

FM2030-02 Contents	
Part No.	Description
FM2030-01	FM-2030 Handpiece
FH200-01	Sleep Holder
B3253	Connecting Cable
B2300	Heat Resistant Pad

IMPORTANT:

The FM-2030 can only be attached to the FM-203 D port, or FM-206 CH2 or CH3 ports. If you attach the iron to any other port, a grip error or connector error (C-E) will occur.



Comment:

The Hakko FM-2030 Heavy Duty Soldering Iron is a new soldering iron handpiece that is compatible with the Hakko FM-203* Soldering Station and Hakko FM-206 High Performance 3-port Rework System.

The FM-2030 provides a higher mass tip with double the power of conventional T15 tips making this iron the ideal solution where soldering is difficult due to heavy ground planes or high heat sink applications.

The FM-2030 uses T22 Series Tips.

For more information, visit us at www.HakkoUSA.com

*NOTE: FM-203 Stations with serial numbers before 0220311002129 will require the purchase of an upgrade. Due to the upgrade process requirements, upgrades cannot be performed in the field. Stations must be returned to American Hakko under an RMA for this upgrade, at which time the upgrade (PN: FM203-UPGR) can be purchased with the FM2030-02 kit and your selection of T22 tips.

For additional information:

- End-User Customers – Call Customer Support at 1-800-88-HAKKO (42556)
- Authorized Distributors – Call Distributor Support at 661-294-0090





American Hakko Products, Inc.

T22 Series Tips

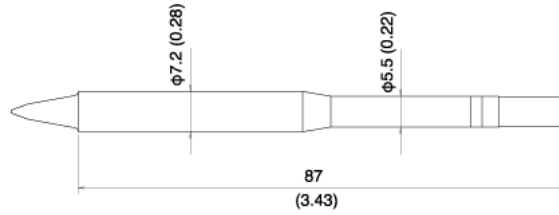

Unit : mm (in.)

T22-BL SHAPE-BL

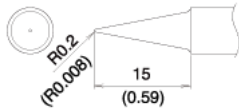

T22-BL2 SHAPE-2BL

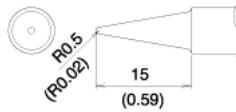

T22-BC2 SHAPE-2BC

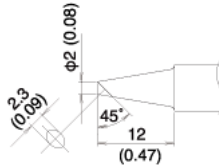

T22-C3 SHAPE-3C

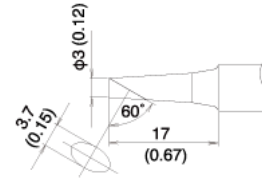

T22-C5 SHAPE-5C

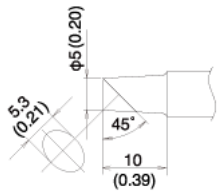

T22-C6 SHAPE-6C

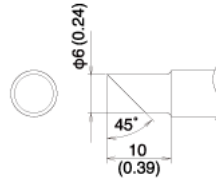

T22-D08 SHAPE-0.8D

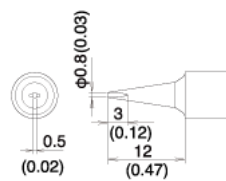

T22-D12 SHAPE-1.2D

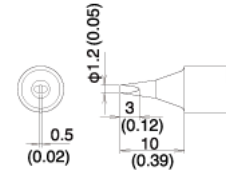

T22-D16 SHAPE-1.6D

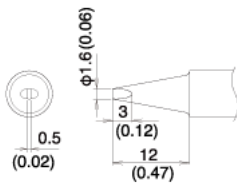

T22-D24 SHAPE-2.4D

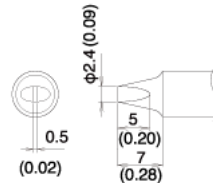

T22-D32 SHAPE-3.2D

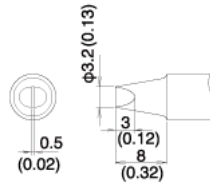

T22-D45 SHAPE-4.5D

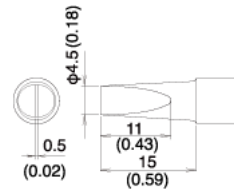

T22-D52 SHAPE-5.2D

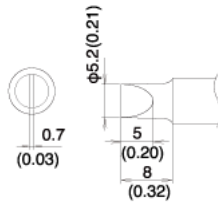

T22-J02 SHAPE-0.2J

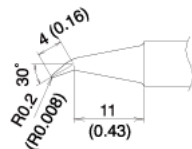

T22-JD08 SHAPE-0.8JD

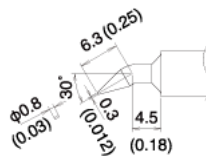

T22-K SHAPE-K

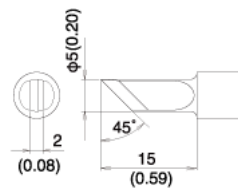

For additional information:

- End-User Customers – Call Customer Support at 1-800-88-HAKKO (42556)
- Authorized Distributors – Call Distributor Support at 661-294-0090

