

# 9770, 9771 PIN TYPE LEAD Replacing the Pin

When you receive the new pin base of the 9770 or the 9771 PIN TYPE LEAD, replace the old one as follows.

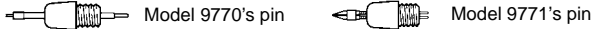

1. Turn off power of the device, and disconnect the pin type lead.
2. Unscrew the cable lock to unlock the cable.  
(The cable is locked by screwing the cable lock.)

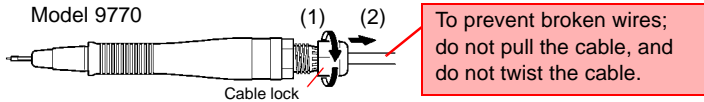

3. Hold the pin base so that the cable won't rotate, and then rotate the grip to loosen it.

Beware of injury.  
The tip has a sharp point.

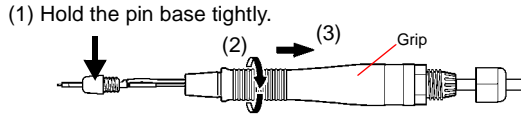

4. Pull off the connector and remove the pin.

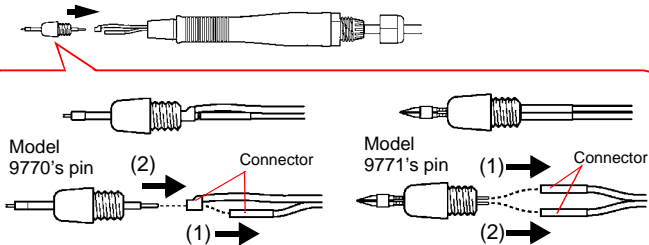

Do not apply a load to the cable to prevent broken wires.

5. Fasten a new pin. Press the tip of the pin against a desk so that the pin won't spring out, and push the connector onto the pin.

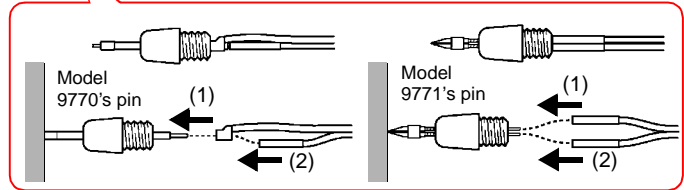
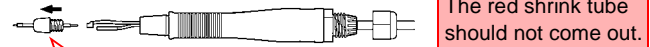

6. Assemble the pin type lead in the reverse order of disassembling.  
Do not pull or twist the cable.

7. To avoid broken wires and contact failures, after tightening the cable lock, gently tug and twist the cable to check it is firmly held.

8. Check the performance. Measure an object with a known resistance. Make sure that the measured resistance is correct before using the pin type lead.

## NOTE

If the grips are detached, reassemble by referring to the picture below.

