

IN3900 (SERIES)

InFocus
Bright Ideas Made Brilliant



The smart alternative
to interactive whiteboards.

Interactive learning just got more affordable.

Touchboards

205 Westwood Ave, Long Branch, NJ 07740
Phone: 866-94 BOARDS (26273) / (732)-222-1511
Fax: (732)-222-7088 | E-mail: sales@touchboards.com

IN3900 (SERIES)

IN3900 Series Interactive Projector

These short throw projectors with breakthrough LiteBoard™ interactive technology let teachers and other professionals interact with the projected image – turning any surface into an engaging, collaborative interactive workspace.

It's like an interactive whiteboard without the board.

Use wand as a mouse to draw, write and click

Control all your favorite PC or Mac applications with the wireless LiteBoard Wand just as you would with your mouse.

- The LiteBoard Wand has left-click and right-click buttons, a scroll wheel, and more
- Draw and annotate on the visuals you're projecting
- Quickly undo your markups with the wand's Undo button
- Easily advance and reverse your presentation slides
- No special software is needed: it works with the software you use today

Interact up close or away for maximum accessibility

Anyone can participate and interact because they don't need to touch the image – just point and click the wand. You can't do that with an interactive whiteboard.

- Teachers can interact with the images while out in the class with the students
- Ordinary business meetings turn into collaboration sessions
- People of any height, including wheelchair users, can interact with all parts of the image
- The visually-impaired benefit from ultra-large images



Hold the wand like a pen for drawing or writing, or hold it like a remote control – whichever is more comfortable.



The LiteBoard Wand

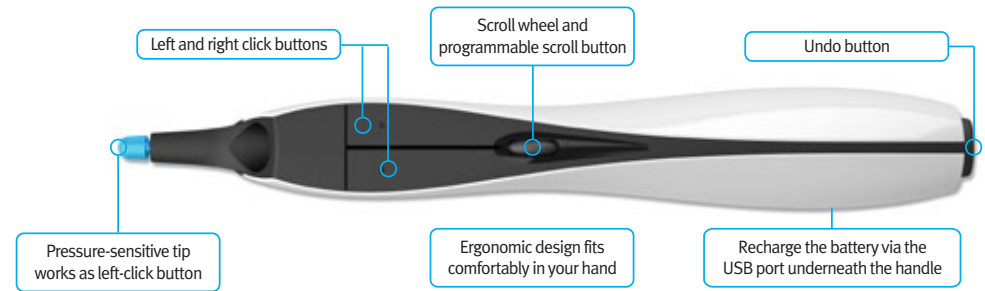

Compare to an interactive whiteboard

	IN3900 Series	Interactive Whiteboard
Interaction	At the image or away	At the image only
Accessibility	Touch is not required so the entire image is accessible to anyone	Top of the image can be hard to reach
Image size (Diagonal)	Up to 150"/3.81 m wide	Up to 82"/2.1 m wide
Cost	One low-priced projector is all you need	High cost for a board and a projector
Size and mobility	Easily move or install	Big and hard to move
Calibration	None	Required
Drivers	None	Required

Connect your collaboration and classroom tools

Easily connect your PC or Mac, DVD player, or document reader via a multitude of inputs. The IN3916 model even lets you present from a USB thumb drive and includes HDMI, networking (LAN), and RS232 ports.

- Display over USB port sends audio and video in one cable (IN3916 only)
- IT administrators can control the projector remotely via the LAN port (IN3916 only)
- Connect wirelessly with optional 802.11 b/g wireless module (IN3916 only)

Room-filling audio

Get your message across from the front row to the back with the IN3900 projector's clear and powerful audio system – one of the best you'll hear in this price range.

- Integrated 20-watt stereo speakers (2 × 10 w)
- Preserve your voice with dedicated dynamic microphone input
- Narration feature lets your voice be heard over the audio of your presentation/video
- Advanced audio processor shapes the sound for best performance

Minimal shadow interference

Get big images when the IN3900 short throw projector is close to the wall to reduce shadows, free up space and reduce ambient noise.

- Project a 5 feet (1.5 m) wide interactive image from only 2.6 feet (0.8 m) away (IN3916 model)
- Interact with an image that can be up to 150" (3.8 m) wide (diagonal)
- Install on wall or ceiling or place on a tabletop or media cart
- Display 3D video and images created in the top emerging 3D standards

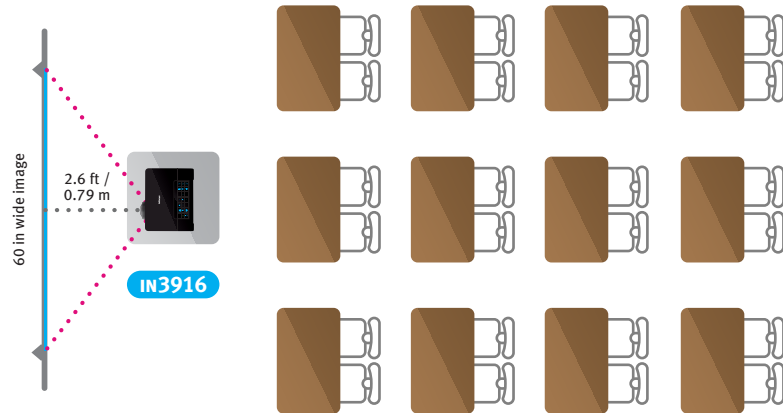

“... As transformative for education as early interactive boards were – maybe more.”

– Scholastic Administr@tor Tech Tools



IN3916 Back Panel

Software that makes interacting easy and fun

- Education version includes drawing, math, geography, literacy and curriculum-building tools
- Business version includes annotation, productivity and screen capture tools
- Works on top of your web browser and other favorite applications
- PC and Mac compatible



WizTech InFocus Edition software

Control the display of multiple PCs

A presenter or teacher can connect up to 32 computers to one projector (via a network or optional wireless connection) and control who presents from one web page.

- Connect up to 32 computers and select the one(s) you want to project
- Display up to 4 computer screens simultaneously
- Works with the IN3916 only

Computer Name	Play Control	IP Address
sbailey	⏮ 1 2 3 4 ⏭	192.168.3.101
mkruger	⏮ 1 2 3 4 ⏭	192.168.3.117
rkent	⏮ 1 2 3 4 ⏭	192.168.3.142
rdeiwie	⏮ 1 2 3 4 ⏭	192.168.3.125
dbaldoni	⏮ 1 2 3 4 ⏭	192.168.3.098
rburdick	⏮ 1 2 3 4 ⏭	192.168.3.104
lokerle	⏮ 1 2 3 4 ⏭	192.168.3.057
sneisen	⏮ 1 2 3 4 ⏭	192.160.3.150

Moderator control panel



Project up to 4 computer screens at the same time

Specifications*

IN3914

IN3916

Resolution (native)	XGA 1024 × 768	WXGA 1280 × 800
LiteBoard Wand	Standard	
Brightness	2700 lumens	
Connections (Input)	VGA × 2, Composite, RCA audio, 3.5 mm (mic), 3.5 mm (audio)	
	HDMI 1.3, USB (for display), USB (for wireless LAN or USB thumb drive), LAN	
Connections (Output)	Monitor out: VGA, Variable audio out: 3.5 mm, Power out: 5V × 2 amp (for accessories)	
	Wireless-ready Port via USB for 802.11b/g dongle	
Control	RS232, USB mini-B	RS232, USB mini-B, LAN (RJ-45)
Aspect ratio (native)	4:3	16:10
Throw ratio	0.61:1	0.52:1
Image size (width)	48.4 - 106.3" (1.23 - 2.7 m)	56.7 - 124.8" (1.44 - 3.17 m)
Image offset	7.5 %	2.5 %
Power consumption	280 watts (Eco Mode); 330 watts (Bright); < 1 watt (Standby)	300 watts (Eco Mode); 350 watts (Bright); < 1 watt (Standby)
Audio	20 w (2 × 10 w), voice and multimedia modes	
Warranty	5 Years	
Standard accessories	VGA cable, Remote control, Wand Kit (includes LiteBoard Wand, wand dock, power charger and USB cables), WizTeach InFocus Edition software	

Optics

Maximum contrast ratio: 3200:1
Supported aspect ratio: 4:3, 5:4, 16:9, 16:10
Zoom ratio: 1.35× (Digital)
Projection distance: 29.5 - 65" (0.75 - 1.65 m)
Projection methods: Front, ceiling, rear
Keystone correction: ±30%
Video compatibility: 480i/p, 576i/p, 720p, 1080i/p,
NTSC/NTSC4.43/PAL/PAL-M/PAL-N/SECAM
H-Sync range: 31.4 - 91.1 KHz
V-Sync range: 23.5 - 85 Hz
3D projector: Yes

LiteBoard Wand

Wand operation: Up to 40 ft. (12 m) from projector, 45° pen to image angle
Battery: ~40 hours life on full charge, rechargeable via USB using included power supply or other USB power source

Operation

Lamp life: 4000 hours (Eco Mode), 2500 hours (Bright)
Lamp power: 2700 lumens, 220 watts
Power supply: 90 - 264 VAC, 50/60 Hz
Audible noise: 30 dB (Eco Mode), 35 dB (Bright)
Operating temperature: IN3914: 5 - 40° C; IN3916: 5 - 35° C
Altitude (max): 7500 ft at 104° F (2286 m at 40° C), 10000 ft at 95° F (3048 m at 35° C)
Menu languages: Danish, Dutch, English, Finnish, French, German, Italian, Korean, Norwegian, Polish, Portuguese, Russian, Simplified Chinese, Spanish, Swedish, Traditional Chinese, Turkish

Physical

Product dimensions: 5 × 12.6 × 9.9" (125 × 320 × 251 mm)
Product weight: 9.9 lbs (4.5 kg)
Shipping dimensions:
IN3914: 16.3 × 11.2 × 15.2" (415 × 285 × 387 mm),
IN3916: 18.7 × 11 × 15" (476 × 281 × 383 mm)
Shipping weight: IN3914: 13 lbs (5.9 kg),
IN3916: 14.5 lbs (6.6 kg)
Security: Kensington® lock
Lamp (particle) containment:
Tested to contain particles larger than 0.8 mm
Approvals: UL & CUL (USA and Canada), FCC (USA), CE (Europe), C-Tick Mark (Australia), NOM & COFETEL (Mexico)

Warranty

Product warranty: 5 years limited
Lamp warranty: 6 months
Accessory warranty: 90 days

System Requirements

LiteBoard: OS compatibility: Windows (XP, Vista, 7), Mac, Linux
USB display (IN3916 only): OS compatibility: Windows (XP Service Pack, Vista 32/64 bit, Win 7 32/64 bit)
LAN display, WiFi display, Quad View display (IN3916 only): OS compatibility: Windows (XP Service Pack, Vista 32/64 bit, Win 7 32/64 bit), Mac (10.4 and higher)
LitePort USB thumb drive port (IN3916 only):
USB 2.0/1.1, JPEG or PtG file
Presentation to Go (PtG) Converter (IN3916 only):
Pentium-M1.5G or higher, Windows (XP Service Pack, Vista 32/64 bit, Win 7 32/64 bit), MS Office 2003 or 2007

Optional Accessories

Replacement Lamp (SP-LAMP-062)
Universal Ceiling Mount (SP-CEIL-UNIV)
Wall Arm (SP-WALLARM-01)
LiteBoard Wand Kit (HW-LBWAND-01)
802.11 b/g Wireless Module (SP-WIFIUSB)
DisplayLink Extender (SP-DOUSB-EXTENDER)
Cables & Adapters
Extended warranties
Alternate remote controls

For more information, visit:
www.infocus.com/Accessories.aspx

Warranty

The IN3900 interactive projector series comes standard with a 5-year limited factory warranty (including parts¹ and labor²), a 6-month limited lamp replacement warranty and a 5-year DLP warranty. Extended product and lamp warranty programs are also available.

For more information, visit:
www.infocus.com/Support/Warranty.aspx



Touchboards

205 Westwood Ave, Long Branch, NJ 07740
Phone: 866-94 BOARDS (26273) / (732)-222-1511
Fax: (732)-222-7088 | E-mail: sales@touchboards.com

LiteBoard™
interactive

InFocus
Bright Ideas Made Brilliant

©2011 InFocus Corporation. All rights reserved. Specifications are subject to change without further notice.
InFocus and InFocus Bright Ideas Made Brilliant are either trademarks or registered trademarks of InFocus Corporation in the United States and other countries. DLP, the DLP logo, and the DLP medallion are trademarks of Texas Instruments. All trademarks are used with permission or are for identification purposes only and are the property of their respective companies.
¹Excludes power supply, fans, color wheel and light tunnel which are covered for two (2) years. ²Labor is covered for two (2) years from date of proof of purchase.
InFocus_IN3900_DS_EN_20FEB11. Part Number: MMINFOCUS-0204.