

 **Optoma**[®]







Touchboards

205 Westwood Ave, Long Branch, NJ 07740
Phone: 866-94 BOARDS (26273) / (732)-222-1511
Fax: (732)-222-7088 | E-mail: sales@touchboards.com

MOBILE LED PROJECTOR
USER'S MANUAL



EYE SAFETY WARNINGS

-  Avoid staring/facing directly into the projector beam at all times. Keep your back to the beam as much as possible.
-  A stick or laser pointer is recommended to avoid the need for the user to enter the beam.
-  When projector is used in a classroom, adequately supervise students when they are asked to point out something on the screen.
-  In order to minimize power, use room blinds to reduce ambient light levels.

A.2.9.31 GLOSS OF HOUSING OF PERIPHERAL DEVICES (15TH / 22 MEETING AG1 EK1):

The requirements for the gloss of housing apply to peripheral devices used at the visual display workplace according to BildscharbV. Peripheral devices intended for use outside the visual display workplace can receive a GS-Mark if the scope is indicated in the User's Manual as well as the certificate.

That means the following wording is possible in situations where the use within the field of view is not intended and where sufficient hints are given in the User's Manual for the avoidance of such situations to ensure that display work is not affected.

Wording in the certificate: "This device is not intended for use in the direct field of view at visual display workplaces. To avoid incommoding reflexions at visual display workplaces this device must not be placed in the direct field of view."

REGULATION & SAFETY NOTICES

This appendix lists the general notices of your Projector.

FCC notice

This device has been tested and found to comply with the limits for a Class B digital device pursuant to Part 15 of the FCC rules. These limits are designed to provide reasonable protection against harmful interference in a residential installation. This device generates, uses, and can radiate radio frequency energy and, if not installed and used in accordance with the instructions, may cause harmful interference to radio communications.

However, there is no guarantee that interference will not occur in a particular installation. If this device does cause harmful interference to radio or television reception, which can be determined by turning the device off and on, the user is encouraged to try to correct the interference by one or more of the following measures:

- Reorient or relocate the receiving antenna.
- Increase the separation between the device and receiver.
- Connect the device into an outlet on a circuit different from that to which the receiver is connected.
- Consult the dealer or an experienced radio/television technician for help.

Notice: Shielded cables

All connections to other computing devices must be made using shielded cables to maintain compliance with FCC regulations.

Caution

Changes or modifications not expressly approved by the manufacturer could void the user's authority, which is granted by the Federal Communications Commission, to operate this device.

Operation conditions

This device complies with Part 15 of the FCC Rules. Operation is subject to the following two conditions:

1. This device may not cause harmful interference, and
2. This device must accept any interference received, including interference that may cause undesired operation.

Notice: Canadian users

This Class B digital apparatus complies with Canadian ICES-003.

Remarque à l'intention des utilisateurs canadiens

Cet appareil numérique de la classe B est conforme à la norme NMB-003 du Canada.

Declaration of Conformity for EU countries

- EMC Directive 2004/108/EC (including amendments)
- Low Voltage Directive 2006/95/EC
- R & TTE Directive 1999/5/EC. (if product has RF function)

IMPORTANT SAFETY INSTRUCTION

1. Do not block any ventilation openings. To ensure reliable operation of the projector and to protect from over heating, it is recommended to install the projector in a location that does not block ventilation. As an example, do not place the projector on a crowded coffee table, sofa, bed, etc. Do not put the projector in an enclosure such as a book case or a cabinet that restricts air flow.
2. Do not use the projector near water or moisture. To reduce the risk of fire and/or electric shock, do not expose the projector to rain or moisture.
3. Do not install near heat sources such as radiators, heaters, stoves or any other apparatus such as amplifiers that emits heat.
4. Do not use the projector in direct sunlight.
5. Do not use near any appliance generating a strong magnetic field.
6. Do not use the projector in areas susceptible to excessive dust and dirt.
7. Turn off the product before cleaning.
8. Turn off the product before removing the battery.
9. Disconnect the battery if the product is not being used for a long period of time.
10. Ensure that the ambient room temperature is within 5-35°C.
11. Relative Humidity is 5 - 35°C, 80% (Max.), non-condensing.
12. Do not expose the battery to temperatures above +60°C (+140°F)
13. New or idle batteries can have short-term reduced capacity. Fully charge the battery before initial use.
14. Do not put the battery into your mouth.
15. Do not let the battery contacts touch another metal object.
16. Do not drop, throw or try to bend your product.
17. May explode if disposed of in fire.
18. Clean only with dry cloth.
19. Only use attachments/accessories specified by the manufacturer.
20. Do not use the unit if it has been physically damaged or abused. Physical damage/abuse would be (but not limited to):
 - Unit has been dropped.
 - Charger or plug has been damaged.
 - Liquid has been spilled on to the projector.
 - Projector has been exposed to rain or moisture.
 - Something has fallen in the projector or something is loose inside.
 Do not attempt to service the unit yourself. Opening or removing covers may expose you to dangerous voltages or other hazards. Please contact your local reseller or service center before you send the unit for repair.
21. Do not let objects or liquids enter the projector. They may touch dangerous voltage points and short out parts that could result in fire or electric shock.
22. See projector enclosure for safety related markings.
23. The unit should only be repaired by appropriate service personnel.
24. Do not touch the projector for a long time while the projector is used.
25. CAUTION: Risk of Explosion if Battery is replaced by an Incorrect Type.
26. Dispose of Used Batteries According to the Instructions.

DISPOSAL OF OLD ELECTRICAL & ELECTRONIC EQUIPMENT

(Applicable throughout the European Union and other European countries with separate collection programs)

This symbol found on your product or on its packaging, indicates that this product should not be treated as household waste when you wish to dispose of it. Instead, it should be handed over to an applicable collection point for recycling of electrical and electronic equipment. By ensuring this product is disposed of correctly, you will help prevent potential negative consequences to the environment and human health, which could otherwise be caused by inappropriate disposal of this product. The recycling of materials will help to conserve natural resources.



This symbol is only valid in the European Union.

If you wish to discard this product, please contact your local authorities or dealer and ask for the correct method of disposal.

PRODUCT OVERVIEW

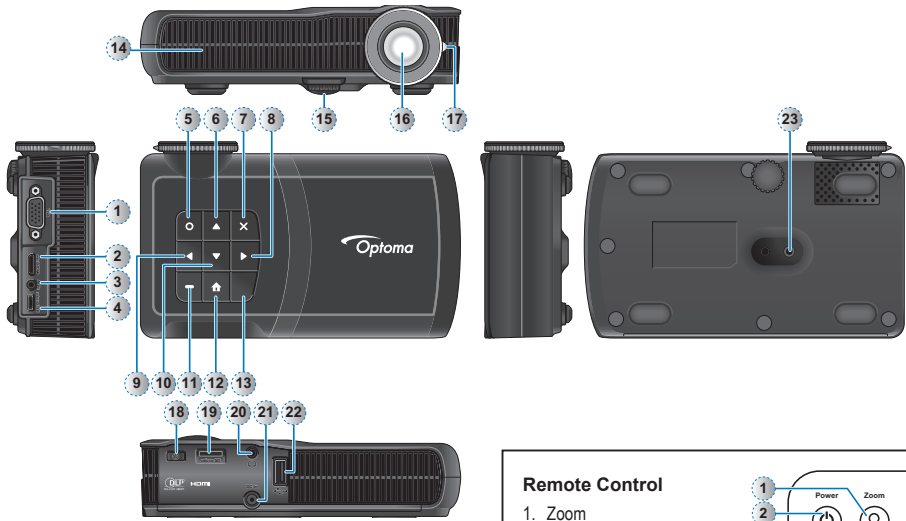

- 1. VGA Connector
- 2. Mini HDMI Connector
- 3. AV Input Connector
- 4. Micro USB Port
- 5. OK Button (O)
- 6. Up Button (▲)
- 7. Cancel / ESC Button (X)
- 8. Right Button (▶)
- 9. Left Button (◀)
- 10. Down Button (▼)
- 11. LED Indicator
- 12. Home Button (⬆)
- 13. IR Receiver
- 14. Speaker
- 15. Elevator Foot
- 16. Lens
- 17. Focus Dial
- 18. Power Button (⏻)
- 19. MicroSD Card Slot
- 20. Audio Out Connector
- 21. DC Input
- 22. USB Type A Port
- 23. Screw Hole for Tripod

Remote Control

- 1. Zoom (for external input only)
- 2. Power
- 3. Up/Volume Up
- 4. OK
- 5. Left
- 6. Down/Volume Down
- 7. Home
- 8. WiFi Display
- 9. USB Display
- 10. VGA
- 11. Video Mute
- 12. Cancel / ESC
- 13. Right
- 14. LED Mode
- 15. Video
- 16. HDMI

<Note>
When the projector is in playback mode, pressing items 8 or 9 will bring up the Home menu.

<Note>
Items 5-10 and 12 are also function buttons. Functions vary depending on the current mode.

PACKAGE OVERVIEW

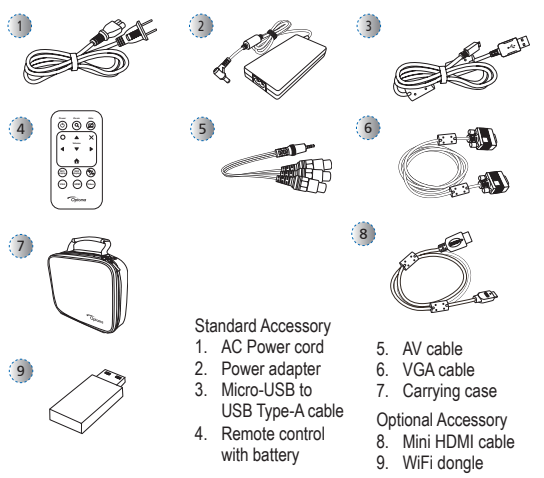

- Standard Accessory**
- 1. AC Power cord
 - 2. Power adapter
 - 3. Micro-USB to USB Type-A cable
 - 4. Remote control with battery
 - 5. AV cable
 - 6. VGA cable
 - 7. Carrying case
- Optional Accessory**
- 8. Mini HDMI cable
 - 9. WiFi dongle

<Note>

- The standard accessories may vary in each region due to different applications.
- The included power cord varies by region.

POWER ON / OFF

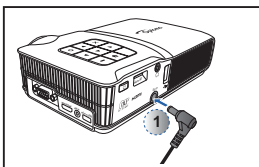

1. Connect the power adapter to the DC IN input jack on the rear of the projector. (①)
2. Insert one end of the AC power cord into the power adapter. (②)
3. Insert the other end of the AC power cord into a power outlet. (③)
The LED indicator blinks red in standby mode.

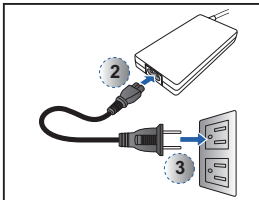

4. Press the Power button (⏻) to turn the projector on or off. (④)
The LED indicator turns off when the projector is turned on.

For first time use, the Language screen appears.

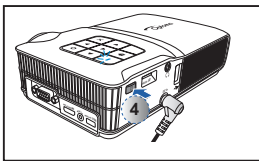

1. Highlight the desired language. (▲▼◀▶)
2. Select the item. (O)

ADJUST PROJECTED IMAGE HEIGHT

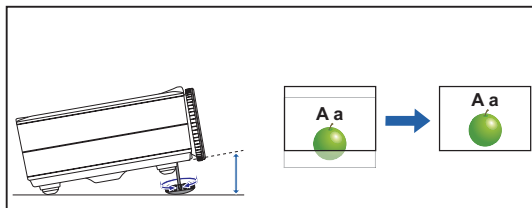

The projector is equipped with an elevator foot for adjusting the projected image height.

To adjust the height:
Turn the elevator foot to adjust the projected image position to the desired height.

<Note>
After a few seconds, if there is no changes, the projector will automatically adjust the image display via Auto Image Adjust function.

ADJUST THE PROJECTED IMAGE

Projection Distance (A)	Screen Size - Width (B)		Screen Size - Height (C)		Screen Diagonal (D)		
	Meter	inch	(mm)	(inch)	(mm)	(inch)	
0.5	21.62	366.2	14.4	228.9	9.0	432	17
1.0	38.16	646.2	25.4	403.9	15.9	762	30
1.6	63.60	1077.0	42.4	673.1	26.5	1270	50
1.9	76.32	1292.3	50.9	807.7	31.8	1524	60
2.6	101.76	1723.1	67.8	1077.0	42.4	2032	80
3.2	127.20	2153.9	84.8	1346.2	53.0	2540	100
3.9	152.64	2584.7	101.8	1615.4	63.6	3048	120
4.8	190.80	3230.9	127.2	2019.3	79.5	3810	150
5.8	228.96	3877.0	152.6	2423.2	95.4	4572	180

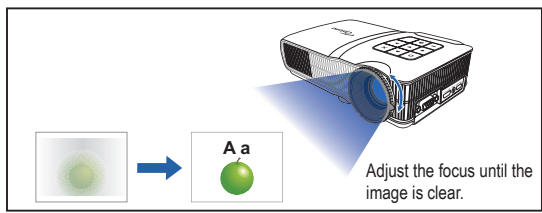
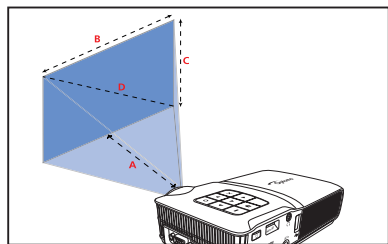

CONNECT INPUT SOURCE - VGA / HDMI

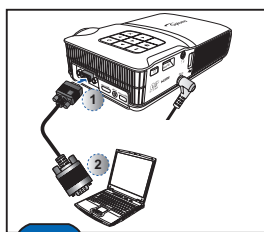

Connect the VGA / HDMI device using an appropriate cable. (①~②)
The Projector will automatically detect the source. For more information, see "How to use external input source" on page 19.

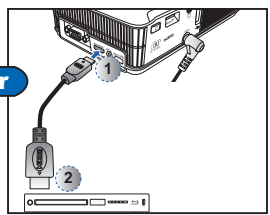
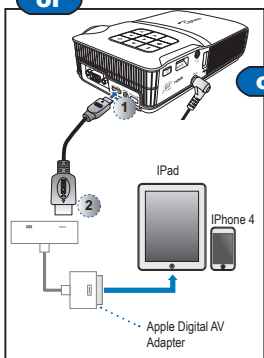

CONNECT INPUT SOURCE - COMPOSITE AV IN

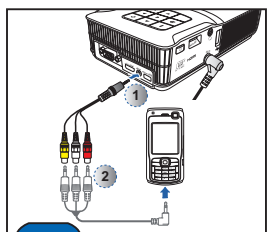

Connect the AV input source. (①~②)
The Projector will automatically detect the source. For more information, see "How to use external input source" on page 19.

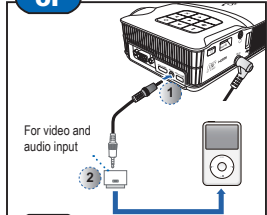

<Note>

- All other brand and product names are trademarks or registered trademarks of their respective companies.
- The cables connecting the video output devices are not supplied, please contact the device vendor or Optoma.
- iPod nano/iPod touch/iPhone/iPod classic (version 5 and above)
- Designed for iPod/iPhone/Mobile phone/ PMP with TV out functions. Using devices with audio signal voltage > 0.9Vrms is not recommended.

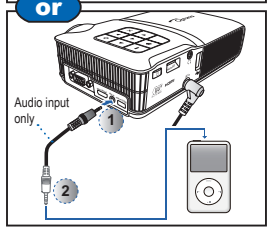

CONNECT COMPUTER FOR USB DISPLAY

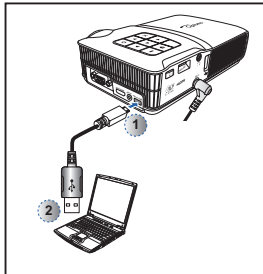

You can project the computer display using the projector's micro USB port.

1. Connect a laptop or PC using the supplied USB to micro USB cable.
2. Turn on the projector. See "USB Display Mode" on page 24.

CONNECT COMPUTER FOR DATA TRANSFER

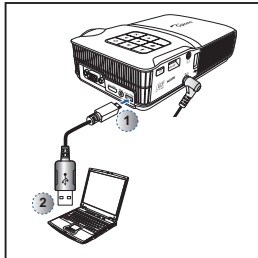

You can transfer data to the projector internal memory or the microSD card.

1. Connect a laptop or PC using the supplied USB to micro USB cable.
2. Turn on the projector. See "Data Transfer Mode" on page 24.

<Note>

The laptop/PC can only detect the input source when the projector is switched on. The projection will stop when this connection is made.

INSERT DATA SOURCE - MICROSD CARD

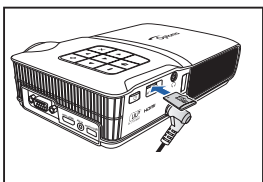

By default, the projector displays from the internal memory. However if a microSD card is inserted, the projector reads from the microSD card first.

Insert a microSD card into the slot with the gold contacts facing down.

<Note>

- To remove the microSD card, push the card to eject it from the slot.
- Do not remove the microSD card while the projector is projecting image from the card. This can cause data loss or damage the card.
- Supports microSD card size up to 32GB.
- The microSD card is not included in the package.

The projector projects media files directly from data sources: internal memory, microSD card, or external source (USB).

INSERT DATA SOURCE - USB (EXTERNAL SOURCE)

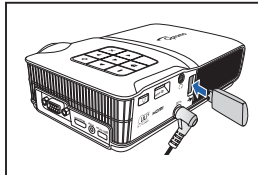

The projector reads data from the USB flash drive first if one is inserted.

Plug a USB flash drive into the USB Type A port at the back of projector.

<Note>

Support USB flash drive with FAT32 format.

USE A TRIPOD STAND



Screw a standard tripod into the screw hole on the projector.

<Note>

The tripod is an optional accessory.

HOW TO USE THE MENU

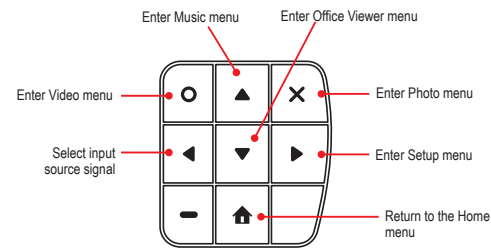

- Press the corresponding button of the desired option.
- Press **X** to go back a previous screen.

<Note>
A button guide appears on the lower left corner of most screens (see below). The guide varies depending on the current mode. Press the corresponding button to select the option or operation.

Home menu



Press the corresponding button of the menu item that you want to access. For example, to access Video, press **O**.

Submenu



Data source icon
The projector reads from memory sources in the following order:
External source (USB) » microSD card » internal memory.

External source Internal memory
MicroSD card

Button guide
Press the corresponding button to select the option or operation.

Submenu Items



Video menu

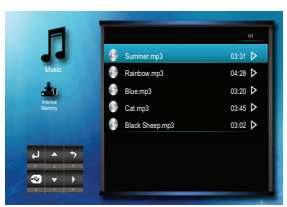

Music menu



Photo menu



Office Viewer menu



Input menu



Setup menu

Playing Videos from the Internal Memory, microSD Card, or External Source

If an external source (USB) is inserted, the external memory is read first. If you want to read data from the microSD card or internal memory, press ◀ in the appropriate screen to change the data source. See steps below.

1. Select "Video"

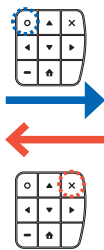

2. Select Data Source

The screen, the source icon on the button guide, and the sequence in which screens appear vary depending on the available data source. If the external source or microSD card is not inserted, its screen is skipped when ◀ is pressed and the source icon on the button guide is not shown.



Change data source



Change data source

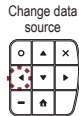
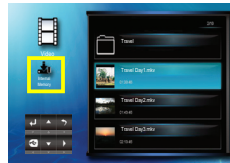

3. Select Video File



<Note>
The displayed screen may vary depending on the selected data source on the previous step.

4. Playback File

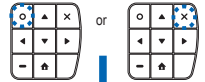

If the selected video file is unfinished from a previous playback.

No
Yes

Playback from start

Video Playback mode (see page 8)

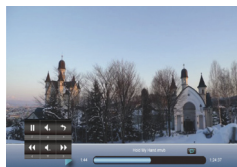

Yes

Playback from start

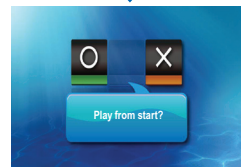

No



Playback from last point

HOW TO PLAY VIDEOS - VIDEO PLAYBACK MODE

<Note>
The button guide disappears when the keypad is not used for 3 seconds.
To display the button guide, press any key except **Home**.

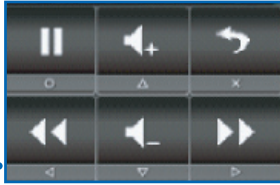
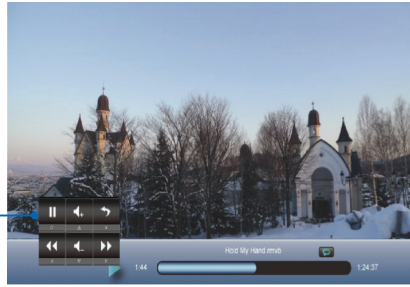

Adjust volume		Rewind	
Pause/Play		Back to previous screen	
Fast forward		Return to Home menu	

Repeat Icons

	Repeat all
	Repeat one
	Repeat off

<Note>
To change repeat settings, see Video Settings below.

VIDEO SETTINGS

1. Select "Setup"



2. Select "Video Setting"



3. Adjust Settings



	Repeat all
	Repeat one
	Repeat off
	Browser display: list view
	Browser display: thumbnail view

Playing Music from the Internal Memory, microSD Card, or External Source

If an external source (USB) is inserted, the external memory is read first. If you want to read data from the microSD card or internal memory, press ◀ in the appropriate screen to change the data source. See steps below.

1. Select "Music"

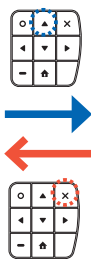

2. Select Data Source

The screen, the source icon on the button guide, and the sequence in which screens appear vary depending on the available data source. If the external source or microSD card is not inserted, its screen is skipped when ◀ is pressed and the source icon on the button guide is not shown.

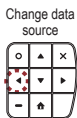
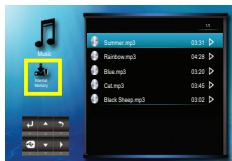
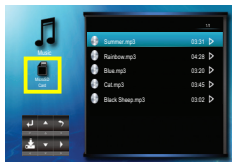
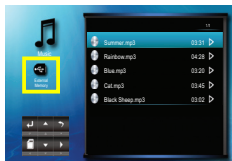

3. Select Music File

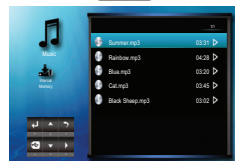

<Note>
The displayed screen may vary depending on the selected data source on the previous step.

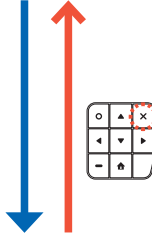

4. Playback File

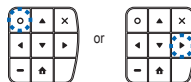

Music Playback mode (see page 10)



HOW TO PLAY MUSIC - PLAYBACK MODE

<Note>
The button guide disappears when the keypad is not used for 3 seconds.
To display the button guide, press any key except **▲**.

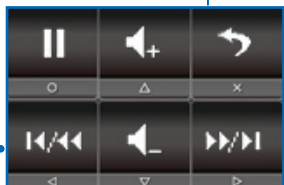

Adjust volume		Back to previous screen	
Pause/Play		Fast forward (press and hold)	
Next track		Rewind (press and hold)	
Previous track		Return to Home menu	

Repeat / Shuffle Icons

	Repeat all
	Repeat one
	Repeat off
	Shuffle on
	Shuffle off

<Note>
To change repeat or shuffle settings, see Music Settings below.

MUSIC SETTINGS

1. Select "Setup"



2. Select "Music Setting"



3. Adjust Settings



	Repeat all
	Repeat one
	Repeat off
	Shuffle on
	Shuffle off

Viewing Photos from the Internal Memory, MicroSD Card, or External Source

If an external source (USB) is inserted, the external memory is read first. If you want to read data from the microSD card or internal memory, press ◀ in the appropriate screen to change the data source. See steps below.

1. Select "Photo"



2. Select Data Source

The screen, the source icon on the button guide, and the sequence in which screens appear vary depending on the available data source. If the external source or microSD card is not inserted, its screen is skipped when ◀ is pressed and the source icon on the button guide is not shown.



Change data source



Change data source

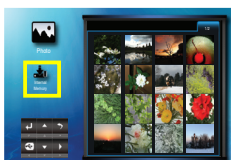

Change data source



3. Select Page



Page indicator



<Note>
The displayed screen may vary depending on the selected data source on the previous step.

4. Enter Current Page



5. Browse Thumbnails



6. Preview File

Full Screen mode (see page 12)



HOW TO VIEW PHOTOS - FULL SCREEN MODE / SLIDESHOW MODE

<Note>
The button guide disappears when the keypad is not used for 3 seconds.
To display the button guide, press any key except .

<Note>
• To change slideshow interval settings and enable/disable background music, see Slideshow Settings below.
• Make sure that background music setting is "On" to enable this feature.
• Save the music files (*.mp3 format) under the "Slideshow Music" folder in the internal memory.
• Only music files stored in the internal memory "Slideshow Music" folder can be played as background music.

Full screen mode

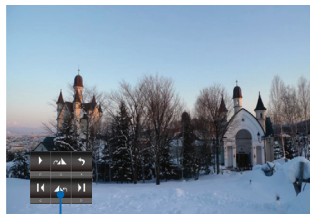

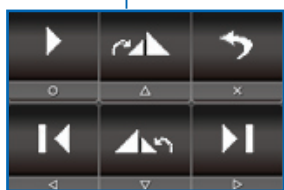
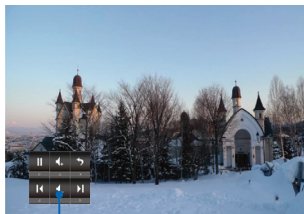

Slideshow mode





- Enter slideshow mode 

- Next photo 

- Previous photo 

- Back to previous screen 

- Rotate 90° clockwise 

- Rotate 90° counter-clockwise 

- Return to Home menu 

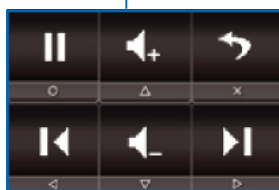



- Play/Pause slideshow 

- Next photo 

- Previous photo 

- Exit slideshow 

- Volume up 

- Volume down 

- Return to Home menu 

SLIDESHOW SETTINGS

1. Select "Setup"

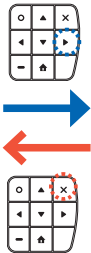



2. Select "Slideshow"





3. Adjust Settings



-  Timer: 2-second interval

-  Timer: 5-second interval

-  Timer: 10-second interval

-  Background music on

-  Background music off

<Note>
The photo slideshow interval time may not be completed due to processing of each photo file.

Viewing Documents from the Internal Memory, microSD Card, or External Source

If an external source (USB) is inserted, the external memory is read first. If you want to read data from the microSD card or internal memory, press ◀ in the appropriate screen to change the data source. See steps below.

1. Select "Office Viewer"



2. Select Data Source

The screen, the source icon on the button guide, and the sequence in which screens appear vary depending on the available data source. If the external source or microSD card is not inserted, its screen is skipped when ◀ is pressed and the source icon on the button guide is not shown.

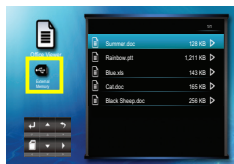

Change data source

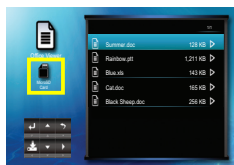

Change data source

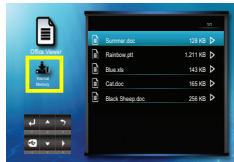

Change data source



3. Select File

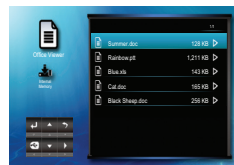

<Note>
The displayed screen may vary depending on the selected data source on the previous step.



4. View File

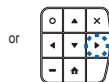

View mode (see page 14)



HOW TO VIEW DOCUMENTS - VIEW MODE

<Note>

The button guide disappears when the keypad is not used for 3 seconds. To display the button guide, press any key except **Home**.

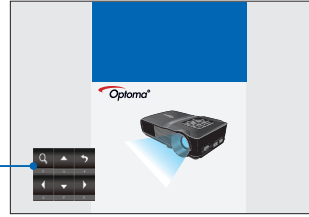

Zoom in 1x - 4x		Move left	
Page up		Move right	
Page down		Exit View mode	
Pan up, down, left, right (in zoom mode)		Return to Home menu	

DISPLAY SETTINGS

1. Select "Setup"

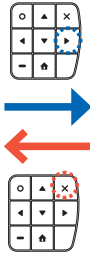

2. Select "Display Setting"



3. Adjust Settings



	LED Mode: Bright		Gamma: Presentation
	LED Mode: Cinema		Gamma: Movie
	LED Mode: Photo		Gamma: Bright
	LED Mode: PC		Gamma: Standard
	Color Mode: Extended		Projection: Front Desktop
	Color Mode: Standard		Projection: Front Inverted
	Aspect Ratio: 4:3		Projection: Rear Desktop
	Aspect Ratio: 16:9		Projection: Rear Inverted
	Aspect Ratio: 16:10		
	Aspect Ratio: Auto		

<Note>

The Aspect Ratio menu allows you to adjust the aspect ratio in Video mode. To adjust the aspect ratio of VGA, HDMI, AV input source, use the aspect ratio settings on page 20.

1. Select "Setup"

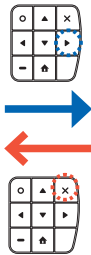

2. Select "System"

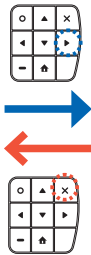

3. Select "Language"

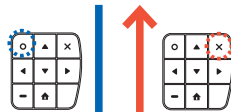

4. Select Language

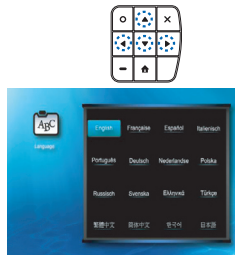

5. Confirm language / Return to Home menu

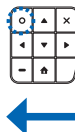

Select your preferred menu language.
Options are: English, French, Spanish, Portuguese (Brazilian), German, Italian, Russian, Polish, Dutch, Swedish, Greek, Traditional Chinese, Simplified Chinese, Korean, Japanese, Turkish

1. Select "Setup"



2. Select "System"



3. Select "Information"

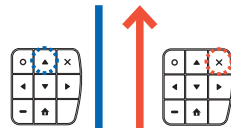

5. Return to Home Menu

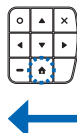

4. View Information



- MicroSD card capacity
- Internal memory capacity
- External memory (USB) capacity

UPGRADE FIRMWARE

Software updates can be obtained from the OPTOMA website
(www.optoma.com / www.optoma.eu / www.optoma.com.tw).

1. On your computer, create a folder named "upgrade".
2. Download the latest firmware from www.optoma.com and save it in the "upgrade" folder.
3. Copy the "upgrade" folder to the root folder of the microSD card.
4. Insert the microSD card into the microSD card slot of the projector.
5. Follow the steps below.

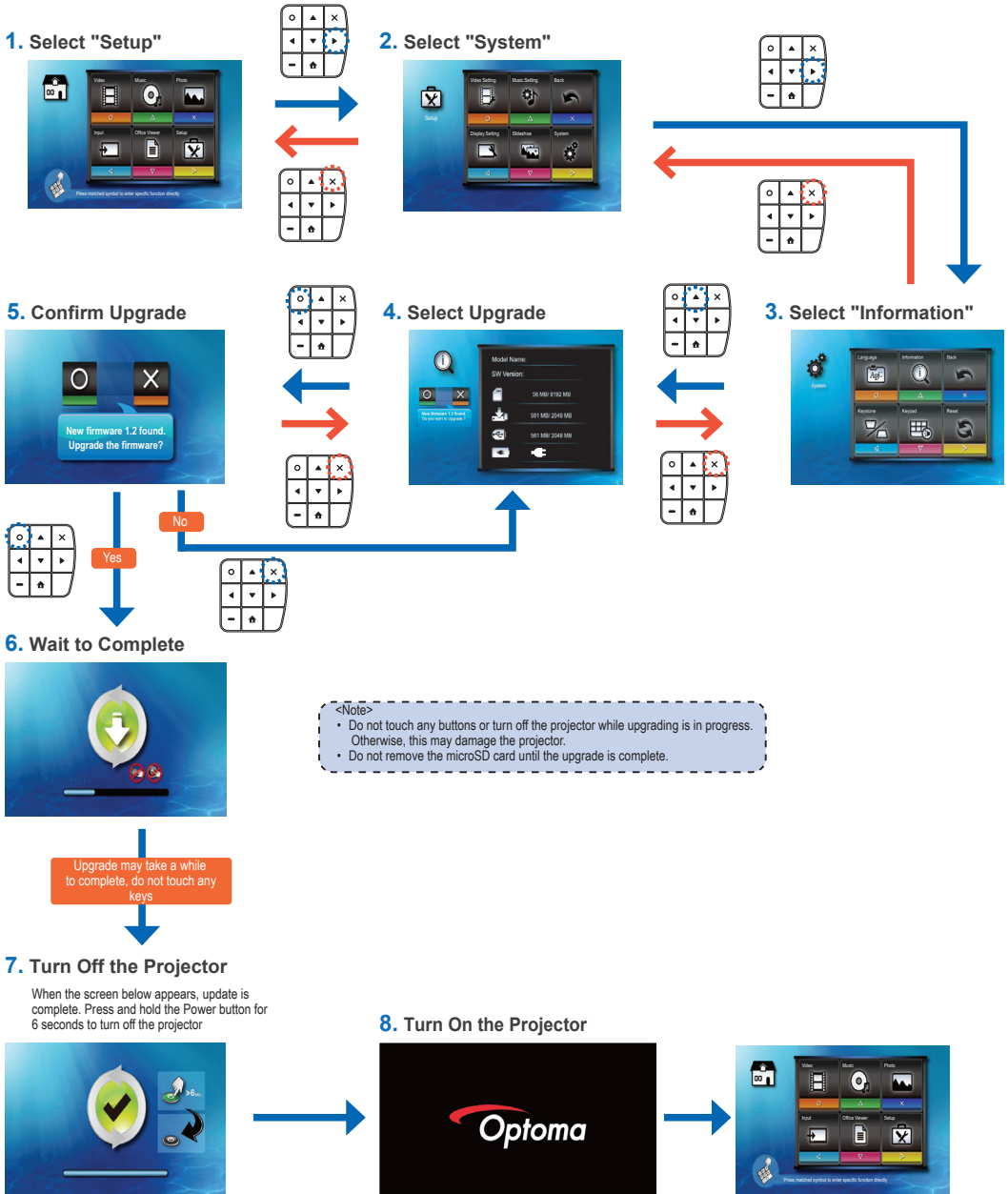

Auto Image Adjust

1. Select "Setup"

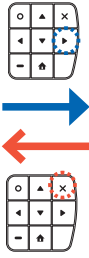

2. Select "System"



3. Select "Keystone"

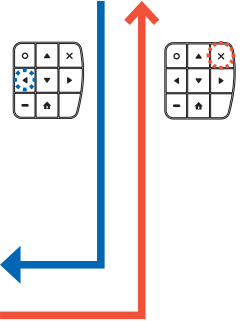

5. Confirm Auto Image Adjust

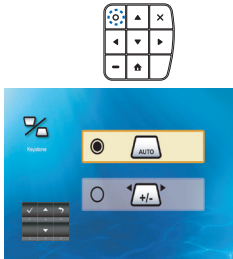

4. Select "Auto Image Adjust"

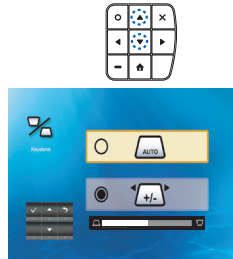

Manual Keystone

1. Select "Setup"

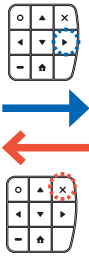

2. Select "System"

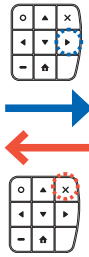

3. Select "Keystone"

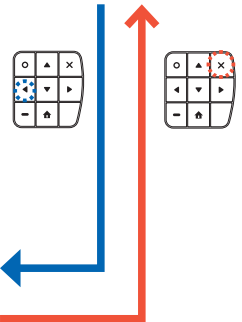

5. Adjust Image Display

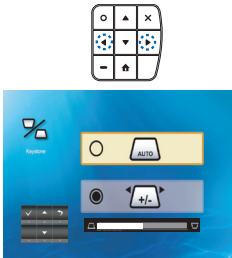

4. Select "Manual Keystone"

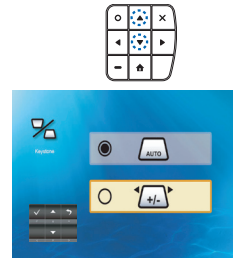

RESET THE SYSTEM

Resetting the System by Reset Menu

<Note>

When the system is reset, all files stored in the internal memory will be deleted. Ensure all files are backed up before resetting.

1. Select "Setup"

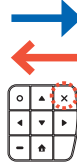

2. Select "System"



3. Select "Reset"

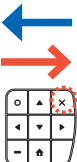

4. Confirm Reset

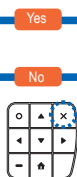
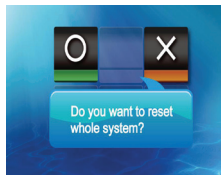

Reboot the projector



Select language



How to Use External Input Source: VGA/COMPOSITE/AV/HDMI/USB DISPLAY/WiFi DISPLAY

Selecting Input Source Manually

If more than one external devices are connected to the projector or the projector cannot automatically detect the external device. You have to manually select the input source. To do this, perform the following steps below.

1. Select "Input"



2. Select Input Source



3. Enter Display Mode

Display mode



or

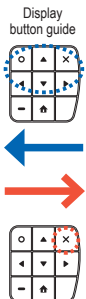
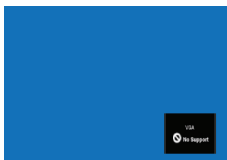

4. Adjust Settings View Source Content

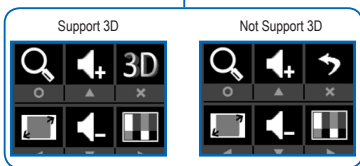
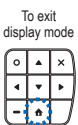

5. Exit Display Mode

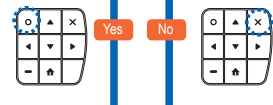

<Note>
The signal message box briefly appears on screen; its label varies depending on the selected input signal.

- Zoom in
- Volume up
- Volume down
- Aspect ratio
- Not support 3D: Hide button guide
- Support 3D: Enter 3D menu
- Settings
- Return to Home menu

INPUT SOURCE SETTINGS

Changing Aspect Ratio Settings

1. View Source Content

Display mode

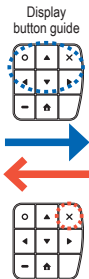

2. Select "Aspect Ratio"

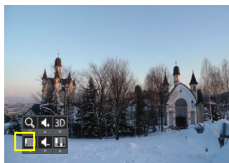

3. Scroll Aspect Ratio Setting

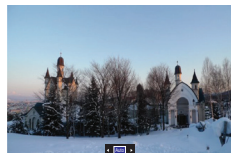

4. Confirm Setting

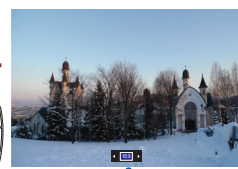
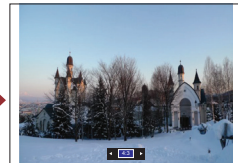
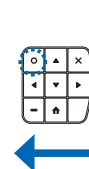

<Note>
When no key is pressed within 10 seconds, the aspect ratio icon automatically disappears and its setting is applied.

Adjusting Contrast Settings

1. View Source Content

Display mode

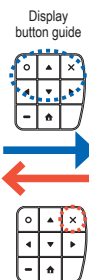

2. Select "Settings"



3. Select "Contrast"



4. Adjust Setting

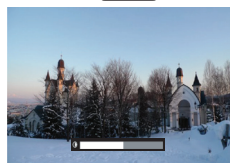

Exit contrast settings

Scroll other settings: Sharpness, Color, LED, Brightness

Return to Home menu

<Note>
When no key is pressed within 10 seconds, the contrast icon automatically disappears and its setting is applied.

INPUT SOURCE SETTINGS

Adjusting Brightness Settings

1. View Source Content

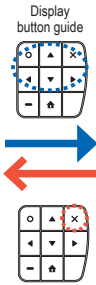
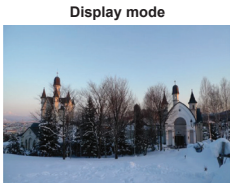

2. Select "Settings"



3. Select "Brightness"



4. Adjust Setting



Exit brightness settings

Scroll other settings: Contrast, Sharpness, Color Mode, LED Mode, Brightness

Return to Home menu

<Note>
When no key is pressed within 10 seconds, the brightness icon automatically disappears and its setting is applied.



Selecting LED Mode Settings

1. View Source Content

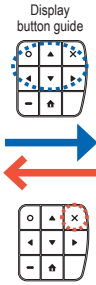

2. Select "Settings"



3. Select "LED Mode"

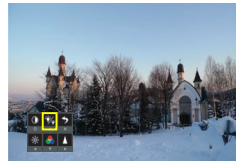

4. Adjust Setting



Exit LED mode settings

Scroll other settings: Brightness, Contrast, Sharpness, Color Mode, LED Mode

Return to Home menu

<Note>
When no key is pressed within 10 seconds, the LED mode icon automatically disappears and its setting is applied.

LED Mode settings

Bright Photo

Cinema PC

1. View Source Content

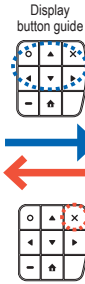

2. Select "Settings"



3. Select "Color Mode"

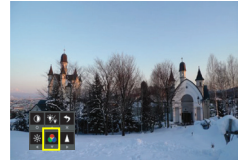

4. Adjust Setting

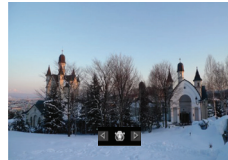

Exit color mode settings

Scroll other settings: LED Mode, Brightness, Contrast, Sharpness, Color, LED

Return to Home menu

<Note>
When no key is pressed within 10 seconds, the color mode icon automatically disappears and its setting is applied.

Color Mode settings

- Extended: Use to project more vibrant colored pictures
- Standard: Use to project standard colored pictures

1. View Source Content

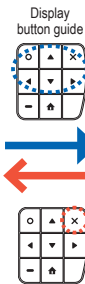

2. Select "Settings"



3. Select "Sharpness"



4. Adjust Setting



Exit sharpness setting mode

Scroll other settings: Color Mode, LED Mode, Brightness, Contrast, Sharpness

Return to Home menu

<Note>
When no key is pressed within 10 seconds, the sharpness icon automatically disappears and its setting is applied.



3D INPUT SOURCE SETTINGS

Changing 3D Mode Settings

1. View Source Content

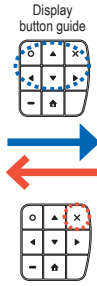

2. Select "3D"

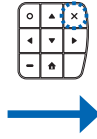

3. Select "3D Mode"

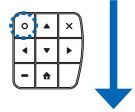
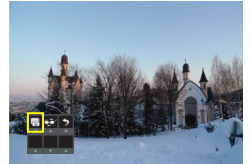

4. Scroll 3D Mode Setting

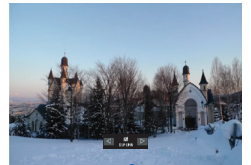
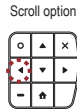

Synchronizing 3D Display

1. View Source Content

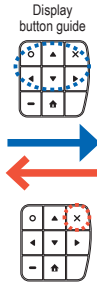

2. Select "3D"



3. Select "3D Sync"



Invert 3D sync once



USB MODE

Data Transfer Mode

When a computer is connected via USB, the projector automatically detects the connection and the message below appears on screen.

1. Select "Data Transfer"

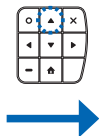

2. Confirm Transfer

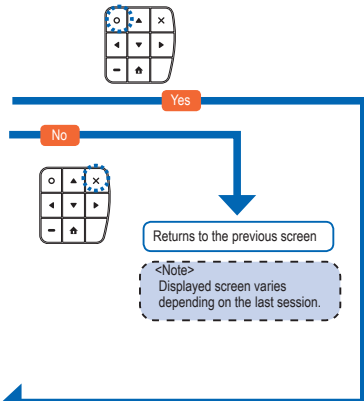
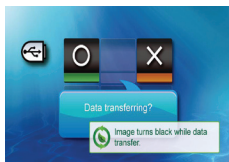

4. Unplug the USB Cable



<Note>
Check your computer for the upload status. When upload is complete, you must unplug the USB cable to display the Home menu.

3. Upload Files by Computer



or



<Note>
The screen turns black after 60 seconds for power saving. Press **Home** to wake up the display.

USB Display Mode

<Note>
When using USB Display function for the first time:
1. From the Windows desktop, browse for "USB Display V1.0.1" drive and double-click "dlusb_launcher.exe", see "Data Transfer Mode" above.
2. USB display is not MAC compatible.

1. Select "USB Display"

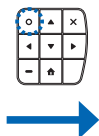

2. Connect to PC

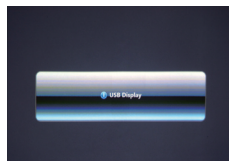

3. View PC Display



4. Unplug the USB Cable



<Note>

When using Wi-Fi Display function for the first time, install "MirrorOp Lite" software into your PC:

1. From the Windows desktop, double-click "setupMirrorOpSender.exe". Follow the on-screen instructions to complete the software installation.
2. See the WiFi Dongle User Manual for more details.

1. Plug in the Wi-Fi Dongle

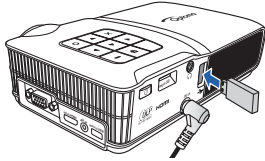

<Note>

This projector is only compatible with "Optoma Wireless Dongle". Contact Optoma Service for details.

2. Select "Input"



3. Select "Wi-Fi Display"



5. On the Wireless Connection on your PC, select "Optoma-Display" and run MirrorOp Lite software.

<Note>

See the WiFi Dongle User Manual for more instructions.

4. View Wi-Fi Display Information



Timing Table

Mode	Resolution	V-Sync (Hz)
VGA	640 x 480	60
	800 x 600	60
	1024 x 768	60
	1280 x 720	60
YPbPr, HDMI	1280 x 800	60
	480i / 480P	60
	576i / 576P	50
	720P	50 / 60
	1080i / 1080P	50 / 60

Timing Table (3D source)

I/O	Timing	Default of 3D model
RGB/DVI	800 x 600 @ 120Hz	"DLP-LINK (On)"
	1024 x 768 @ 120Hz	
HDMI	800 x 600 @ 120Hz	"DLP-LINK (On)"
	1024 x 768 @ 120Hz	

The projector uses Pictsel File Viewer to open and view Microsoft® office files and Adobe® PDF files.

Supported Versions

Office Version
Microsoft® Office 95
Microsoft® Office 97
Microsoft® Office 2000
Microsoft® Office 2003
Microsoft® Office 2007
Microsoft® Office 2010

Compatible Document Format

Microsoft® Office Application	File Extension
Word	*.doc *.docx
Power Point	*.ppt *.pptx
Excel	*.xls *.xlsx
Text	*.txt
Adobe PDF	*.pdf



MEDIA FILE SUPPORT LIST: VIDEO

Video

File Format (Ext name)	Video Format	Maximum Resolution	Frame Rate	Profile
MPG MPEG	MPEG1	1280 x 800	30 fps	-
AVI MOV MP4 3GP	H.264	1280 x 800	30 fps	Baseline
AVI 3GP mov wmv	MPEG4	1280 x 800	30 fps	Simple Profile
AVI wmv	Xvid	1280 x 800	30 fps	Baseline
FLV	Sorenson Spark	1280 x 800	30 fps	Baseline
mp4	H.264	-	-	-
AVI mov	MJPEG	1280 x 800	30 fps	Baseline
MKV	-	-	-	-

<Note>
Video format does not support content with B-Frame function.

Image

File Format	File Extension
JPEG JPG	*.jpg, *.jpeg
BMP	*.bmp

Audio

File Format (Ext name)	Sample Rate (KHz)	Bit Rate (Kbps)
AAC	8-48	8-256
MP3	8-48	8-320
PCM	8-48	128-1536
ADPCM	8-48	32-384
WMA	22-48	5-320

If you experience a problem with your projector, please refer to the following information. If a problem persists, please contact your local retailer or service center.

Image Problems

- [?] No image appears on-screen**
 - Ensure the power cord is correctly and securely connected.
 - Ensure the pins of connectors are not crooked or broken.
 - Make sure the projector is switched on.
- [?] Image is out of focus**
 - Adjust the Focus Dial.
 - Make sure the projection screen is between the required distance 21.62 to 228.96 inches (0.5 to 5.8 meters) from the projector. See page 4.
- [?] Image is too small or too large**
 - Move the projector closer to or further from the screen.
- [?] Image is reversed**
 - Select "Setup --> Display --> Projection" from the OSD and set the projection direction.

Audio Problems

- [?] No sound**
 - During music playback, press ▲ or ▼.

LED Indicator

LED Color	Description
No light	In operation
Red	Standby

<Note>

When the projector temperature reaches 85°C, the projector automatically shuts down due to the built-in temperature protection. This is not a malfunction. Let the projector cool down before switching it on again.

Clause for Office / Document Viewer

The copyright is owned by Pícsel to avoid rights violated by end customer and third parties.

1. All IPR, including but not limited to copyright, in the Pícsel Products is owned by Pícsel or its supplier.
2. The End User may not:
 - make copies of the Pícsel Products or make them available for use by third parties.
 - reverse engineer, disassemble, reverse translate, or in any way decode the Pícsel Products or any copy or part of it in order to derive any source code. Save only as is permitted by any applicable law.
3. Pícsel makes no representations or warranties whether express or implied (by statute or otherwise) relating to the performance, quality, merchantability, or fitness for a particular purpose of the Pícsel Products or otherwise and all such representations or warranties are specifically disclaimed and excluded.
4. Pícsel agrees and acknowledges that Pícsel and the Pícsel Products will not be specifically mentioned in the end user license agreement.

Copyright © Optoma Company Limited.
All rights reserved.

Optoma reserves the right to make technical changes. Optoma assumes no liability for damages incurred directly or indirectly from errors, omissions, or discrepancies between the device and this documentation.

Other brands or logos are trademarks or registered trademarks of their respective companies.

This device is not intended for use in the direct field of view at visual display workplaces.

For service or support please contact your local office.

USA3178 Laurelview Ct.
Fremont, CA 94538, USA
www.optomausa.com☎ 888-289-6786
☎ 510-897-8601
✉ services@optoma.com**Canada**2420 Meadowpine Blvd., Suite #105
Mississauga, ON, L5N 6S2, Canada
www.optoma.ca☎ 888-289-6786
☎ 510-897-8601
✉ services@optoma.com**Latin America**3178 Laurelview Ct.
Fremont, CA 94538, USA
www.optomausa.com☎ 888-289-6786
☎ 510-897-8601
✉ services@optoma.com**Europe**42 Caxton Way, The Watford Business
Park Watford, Hertfordshire,
WD18 8QZ, UK
www.optoma.eu☎ +44 (0) 1923 691 800
☎ +44 (0) 1923 691 888
✉ service@tsc-europe.com

Service Tel: +44 (0)1923 691865

Benelux BVRandstad 22-123
1316 BW Almere
The Netherlands
www.optoma.nl☎ +31 (0) 36 820 0253
☎ +31 (0) 36 548 9052**France**Bâtiment E
81-83 avenue Edouard Vaillant
92100 Boulogne Billancourt, France☎ +33 1 41 46 12 20
☎ +33 1 41 46 94 35
✉ savoptoma@optoma.fr**Spain**C/ José Hierro,36 Of. 1C 28522
Rivas VaciaMadrid,
Spain☎ +34 91 499 06 06
☎ +34 91 670 08 32**Deutschland**Wiesenstrasse 21 W
D40549 Düsseldorf,
Germany☎ +49 (0) 211 506 6670
☎ +49 (0) 211 506 66799
✉ info@optoma.de**Scandinavia**Lerpeveien 25
3040 Drammen
Norway☎ +47 32 98 89 90
☎ +47 32 98 89 99
✉ info@optoma.noP.O.BOX 9515
3038 Drammen
Norway**Korea**WOOMI TECH.CO.,LTD.
4F, Minu Bldg. 33-14, Kangnam-Ku,
Seoul,135-815, KOREA☎ +82+2+34430004
☎ +82+2+34430005**Japan**東京都足立区綾瀬3-25-18
株式会社オーエスエム
ポートセンター: 0120-46-5040✉ info@osscreen.com
www.os-worldwide.com**Taiwan**5F., No. 108, Minchuan Rd.
Shindian City,
Taipei Taiwan 231, R.O.C.
www.optoma.com.tw☎ +886-2-2218-2360
☎ +886-2-2218-2313
✉ services@optoma.com.tw
asia.optoma.com**Hong Kong**Unit A, 27/F Dragon Centre
79 Wing Hong Street,
Cheung Sha Wan,
Kowloon, Hong Kong☎ +852-2396-8968
☎ +852-2370-1222
www.optoma.com.hk**China**5F, No. 1205, Kaixuan Rd.,
Changning District
Shanghai, 200052, China☎ +86-21-62947376
☎ +86-21-62947375
www.optoma.com.cn205 Westwood Ave, Long Branch, NJ 07740
Phone: 866-94 BOARDS (26273) / (732)-222-1511
Fax: (732)-222-7088 | E-mail: sales@touchboards.com