

ProVax™ DIAGRAM

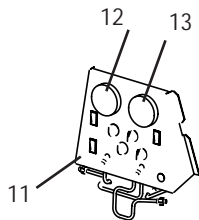

Control Panel
(Section 2)

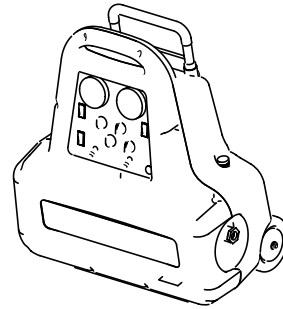
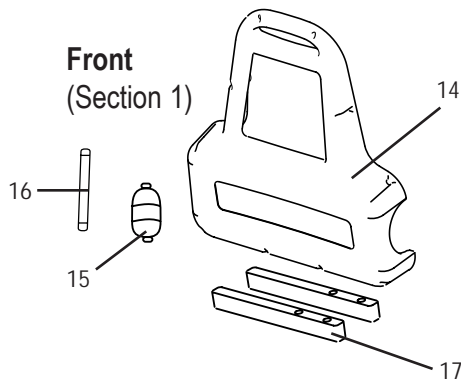
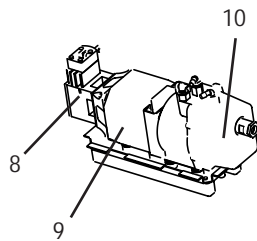

Motor/Compressor/Pump

(Section 3) (Note: For compressor Repair Kits see page 17)

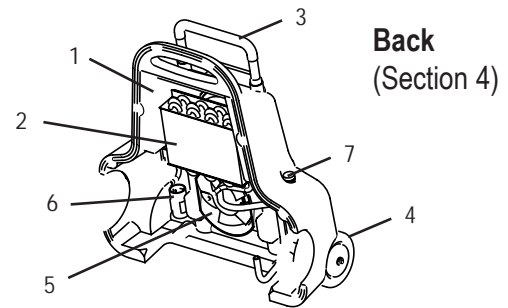

Back
(Section 4)

Section 1 - ProVax Front:

Item.#	Part#	Description
(14)	527075	Front & Rear Case, plastic (set)
(15)	100343	Filter Drier
(16)	100345	4" Blue Hose
(17)	527374	Rubber Foot

Section 2 - ProVax Control Panel:

Item.#	Part#	Description
(11)	527080	Front Panel
(12)	GA1500	Pressure Gauge, 500 Psi
(13)	GA0800	Pressure Gauge, 800 Psi
N/S	GA1000	Gauge Lens
N/S	528160	Inlet & outlet Fitting 45 degree
N/S	NB6501	Inlet & outlet Fitting Protection Cap
N/S	EL1309	Start Switch, momentary
N/S	EL1310	ON-OFF Switch
N/S	527376ASM	Manifold Assembly
N/S	EL2800	Pressure Sensor (400psi)
N/S	EL2802	High Pressure Sensor (500psi)
N/S	113726	Vacuum Switch (13in Hg)
N/S	120106	Vacuum Protection Switch
N/S	100122	Black Knob
N/S	100123	Blue Knob
N/S	100124	Red Knob
N/S	527845	Yellow Knob

Section 3 - ProVax Motor/Compressor/Vacuum Pump:

Item.#	Part#	Description
(8)	527835ASM	Compressor Assembly
(9)	525935	Motor, 115V, 60Hz
(10)	527834ASM	Vacuum Pump Assembly
N/S	527069ASM	Vacuum Pump Clutch Assy
N/S	528167ASM	Compressor Clutch Assy.
N/S	527086	Vacuum Pump & Motor "Vibration" Mount

Section 4 - ProVax Back:

Item.#	Part#	Description
(1)	527075	Front & Rear Case, plastic (set)
(2)	100478	Condenser
(3)	527073	Handle
(4)	527074	Wheel
N/S	529931	Retaining ring, wheel
N/S	527077	Axle, wheel
(5)	EL1817	Axial Fan
(6)	EL1412	Start Capacitor
(7)	110969	Oil Filler Cap
N/S	NB6501	Oil Drain Cap
N/S	EL1500	Relay
N/S	527084	Compressor Grill
N/S	527085	Vacuum Pump Grill
N/S	527076	Fan Grill
N/S	529925	Bumper
N/S	111443	Power Cord, 115V/60Hz

REPLACEMENT KITS

PART#	DESCRIPTION
13119	PREMIUM HIGH VACUUM PUMP OIL, PINT BOTTLE (case of 12)
15367	VACUUM PUMP SEAL REPLACEMENT KIT
KT3302	PISTON SEAL REPLACEMENT (middle section of compressor)
KT3303	VALVE REPLACEMENT KIT (top section of compressor)
KT3307	COMPRESSOR REPAIR KIT (all three sections of compressor)
KT3308	SHAFT REPLACEMENT KIT (bottom section of compressor)

RECOMMENDED ACCESSORIES

PART#	DESCRIPTION
KT-5002	80% CAPACITY TANK SENSING KIT
RGT30	30 LB RECOVERY TANK (350 psi working pressure) with capacity sensor
RGT30NS	SAME AS RGT30, WITHOUT SENSOR
RGT50	50 LB RECOVERY TANK (350 psi working pressure) with capacity sensor
RGT50NS	SAME AS RGT50, WITHOUT SENSOR
RGT50HP	50 LB RECOVERY TANK, HIGH PRESSURE (400 psi working pressure) with capacity sensor
10994	HEATER BLANKET
ADS-100	REFRIGERANT SCALE, 200LB CAPACITY, WITH REMOVABLE PLATFORM
41670	HIGH PRESSURE MANIFOLD SET, 60" COLOR CODED HOSES, FOR R410A
416330	TWO WAY MANIFOLD SET, 72" COLOR CODED HOSES, FOR R22 AND R134a
14830A	THERMISTOR VACUUM GAUGE
16910	REFRIGERANT IDENTIFIER
16440	CORDLESS RECHARGEABLE 30-LED LIGHT
4650	MIRROR AND MAGNET SET
TIFZX-1	HEATED PENTODE™ REFRIGERANT LEAK DETECTOR

NOTE: For details see: www.AdvancedTestProducts.com