

Digital Force Gauges

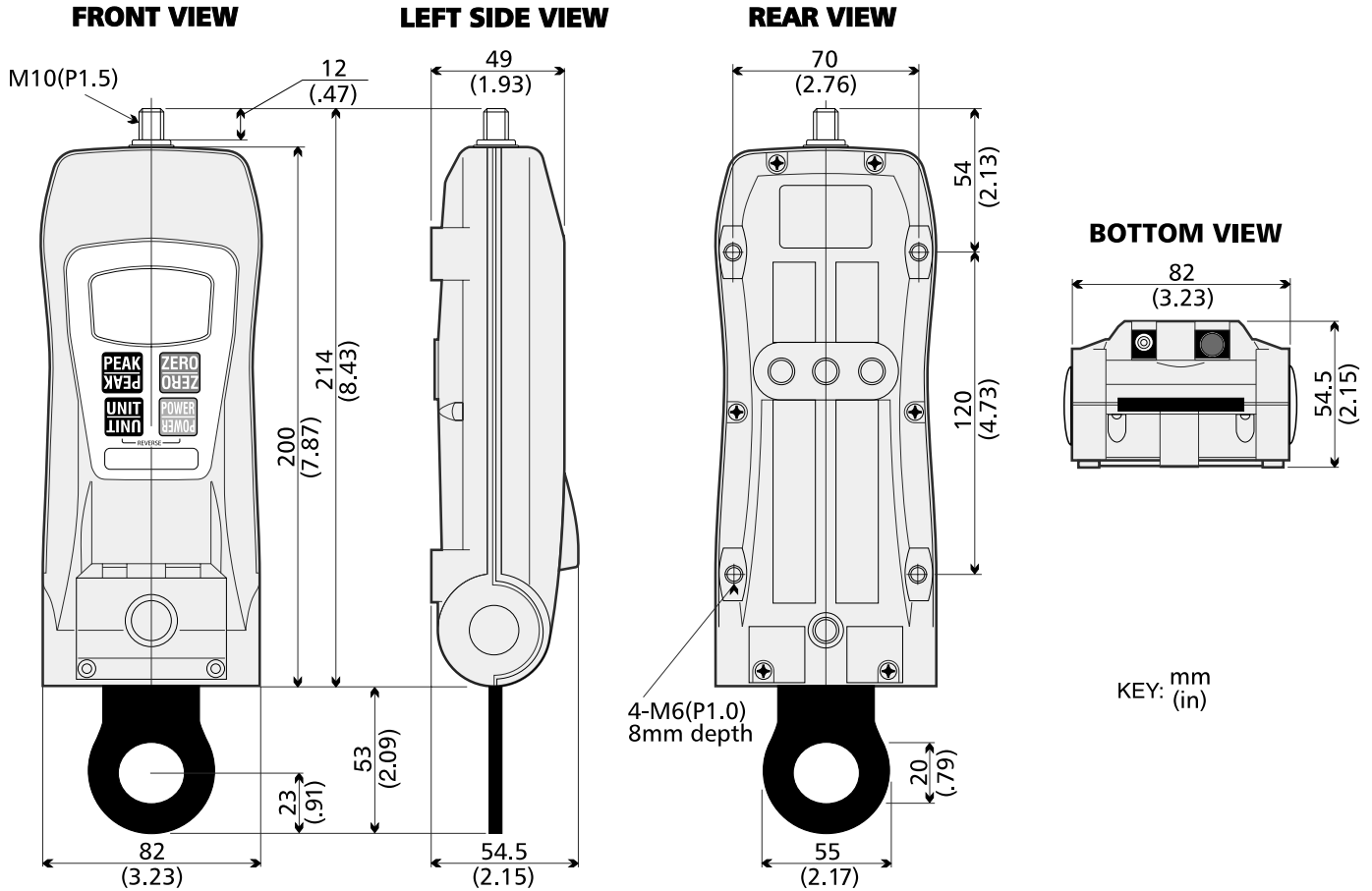

FGV - HX & FGE - HX SPECIFICATIONS

Model	FGE-200HX	FGE-500HX	FGV-200HX	FGV-500HX
Capacity	200 lb 100 Kg 1000 N	500 lb 250 Kg 2500 N	200 lb 100 Kg 1000 N	500 lb 250 Kg 2500 N
Resolution	0.1 lb/0.1 Kg/1 N			
Accuracy	±0.2% F.S.			
Display	Four digit LCD, .47" high (12 mm) with various indicators including tension and low battery indication (reversible)			
Average/Peak Mode	Selectable			
Display Update	0.05, 0.1, 0.2, 0.3, 0.5, 1 sec			
Sampling Rate	1000 times per second			
Overload Capacity	200% of F.S.	150% of F.S.	200% of F.S.	150% of F.S.
Power	Rechargeable Ni-Cad batteries (included) or AC adapter/charger (included)			
Auto Power Shut-Off	Yes (not active if adapter/charger is in use)			
Temperature Range	32° - 104°F (0° - 40°C)			
Dimension / Weight	8.43" L x 3.23" W x 2.15" H (214 mm x 82 mm x 54.5 mm) / 2 lb (900 g)			
Standard Accessories	AC adapter/charger, carrying case, 2 handles, inch adapter and attachments (flat head, hook, chisel, notched head, cone head, extension rod) FGV-RS232CABLE is included with FGV-HX series only			
Approvals	CE approved			
OPTIONAL	NIST certs with data			

FGV - HX OUTPUT SPECIFICATIONS

RS232C Output Port	Selectable baud rate: 2400, 4800, 9600, 19,200bps Data length: 8 bits Stop bit: 1 bit Parity: none Software flow control: none
Analog Output Port	±1 VDC output (through a 12 bit D/A converter)
Overload Output	One NPN OC transistor for tension, one NPN OC transistor for compression