

Weller[®]

WHA900

 Operating Instructions



**205 Westwood Ave
Long Branch, NJ 07740
1-877-742-TEST (8378)
Fax: (732) 222-7088
salesteam@Tequipment.NET**

Table of Contents

Page

WHA900 Detail View	1
Technical Data	1
1. Cautions! / Warnings!	2
2. Description	2
3. Placing Into Operation	2
4. Operating Guidelines	3
5. Accessories	3
6. Packing List	3
7. Nozzles	4,5,6

WHA900 Detailed View

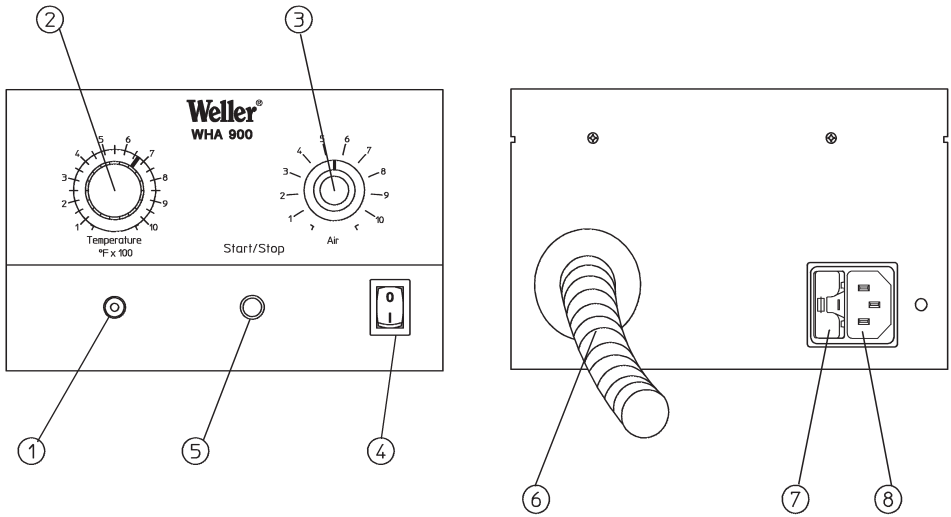

1. LED Heater Control
2. Variable Temperature Control; Range 100°F and 1000°F
3. Air Flow Control; Range 5 to 50 l/minute
4. Power Switch
5. Start / Stop Push Button
6. Hot Air Pencil and Hose Assembly
7. Fuse T 10 Amp
8. Receptacle 120 VAC

Technical Data:

Dimensions:	8 3/16" L; 6 5/8" W; 4 1/4" H
Main Voltage:	120 VAC
Power consumption:	750 WATTS
Hot Air Pencil output:	700 WATTS
Fuse:	T 10 AMP
Temperature Control:	Variable between 100°F and 1000°F
Temperature Control accuracy:	± 54°F
Flow Control:	Variable between 5 - 50 l/min
Noise Level:	56dB(A) distance 1m at max. airflow level

Thank you for placing your trust in our company by purchasing the Weller WHA900 Hot Air Station. This product meets or exceeds the requirements established by Weller for superior performance, versatility and quality.



1. Cautions! / Warnings!

Please read these Operating Instructions and the attached Safety Information carefully prior to initial operation. Failure to observe the safety warnings may result in accident, injury, or risk to health.

The manufacturer shall not be liable for damage resulting from misuse of the machine or unauthorized alterations.

Warning: This product when used for soldering and similar applications, produces chemicals known to the State of California to cause cancer and birth defects or other reproductive harm.

Safety Information:

- Always place the soldering iron in its original holder
- Remove all inflammable objects from the proximity of the hot soldering tool.
- Use suitable protective clothing to prevent the risk of burns associated with molten solder.
- Never leave a hot soldering iron unattended.
- Never work on electrically live circuits or components.
- Always wear eye protection when working with soldering and desoldering applications.

The Weller WHA900 Hot Air Station corresponds to the EC Declaration of Conformity in accordance with the basic safety requirements of Directives 89/336/EEC and 73/23EEC.

2. Description

The WHA900 hot air station was developed for general soldering re-work on Surface Mount components. The temperature of the hot air is controlled electronically and is variable between 100°F and 1000°F. 120 VAC (8) is required to operate the unit. The air flow is variable electronically within the range of approximately 5-50 l/minute and is generated by a self contained pump. The hot air is activated using the Start/Stop Push Button, (5) at the front of the unit.

The WHA900 is grounded through the 120 VAC three wire power cord.

Standby mode:

This unit has a power-on function to activate a Standby Mode (or secondary temperature airflow setting). Before switching on the unit, choose the Temperature and the Airflow settings that you would prefer to use for the Standby Mode of operation.

Activating Standby:

Adjust the Temperature and Airflow control to the desired Standby setting. Depress the Start/Stop push button and hold while switching on the unit. Keep the button depressed for approximately 5 seconds after turning the unit on. The pump will start and the Standby function is activated. When the unit is switched on, the Temperature and the Airflow will be set to the Standby values. When you depress the Start/Stop push button, the Airflow and Temperature will go to the actual "Set" values. The actual "Set" values should be set at a normal Temperature and Airflow settings capable of performing the rework application. Depress the button again and the unit will go back to the Standby values.

Note: To change the Standby settings, you must first Deactivate Standby Mode as described below.

Deactivating Standby:

If the Standby function is activated, depress the Start/Stop push button while switching on the unit. Keep the button depressed for about 5 seconds. The unit is now in the original operating mode. Repeat the "Activating Standby" directions to assign new preferred settings.

3. Placing Into Operation

Note: Safety rest must be formed before tool use.

Place the hot air pencil in the formed safety rest with the nozzle in a raised position to prevent damage to work bench. Check to be sure the supply voltage is consistent with the information on the station label. Before connecting to the 120 VAC power source, set the desired temperature (2) and the air flow on (3) and switch on the unit at the power switch (4). The LED will flash slowly to indicate the unit has reached the Set Temperature.

The Airflow and Temperature are activated after depressing the Start/Stop Push Button. Heat-up time of the nozzle depends primarily on the size of the nozzle and the air flow.

Warning: Do not direct the hot air pencil at people or inflammable objects.

Temperature Offset

1. With the WHA900 off and the heater cooled down. Place Measuring Nozzle (0058736875) on to the end of the Hot Air Pencil and fasten it with the set screw.
2. Insert the 0.5mm Type "K" Thermocouple, (0058736786) into the hole of the Measuring Nozzle and place the Hot Air Pencil in the safety rest. Switch the device on.
3. Choose the temperature you want to adjust with the temperature knob.
4. Activate the unit with the Start / Stop push button. Set the Airflow Knob to 4. Wait approximately 5 minutes before continuing.
5. Read the temperature value indicated on the measuring instrument.
6. If the temperature has to be corrected, depress and hold the Start / Stop push button for approximately 15 seconds while the hot air is activated. The green LED (1) will light continuously.
7. While the green LED (1) is continuously lit, immediately turn the temperature knob slightly beyond center and rotate back to the center position (550 °F). This will be your "zero" point for adjustments. Rotate clockwise for positive and counterclockwise for negative adjustments.
- 8 Adjust the temperature knob until the desired setting is indicated on the measuring device and has stabilized. Depress the Start / Stop push button to confirm.
9. The Temperature Offset function is now complete. You may adjust the temperature knob to your original setting.
10. Repeat steps 3-9 if additional Offset is required.

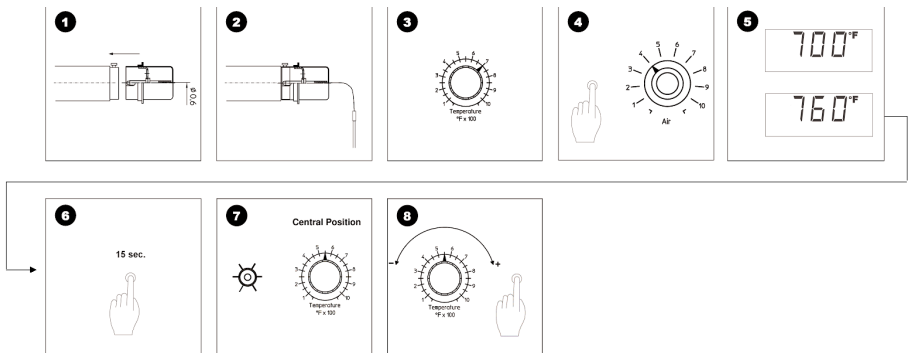

4. Operating guidelines

Changing the nozzles;

The hot air nozzles are fixed to the heating element with a set/attachment screw. Loosen the set/attachment screw to remove nozzles.

5. Accessories

For Nozzle range see " Hot Air Nozzles ".

0051504899 - Multiple Rest for six nozzles.

0051504999 - Nozzle Exchange Tool

2.5 mm Hex Wrench

6. Packing List

WHA900 Control Unit

Power Cord

Safety Rest

(1) Set / Attachment Screw

Operating Instructions

Safety Information

Subject to technical change without notice!

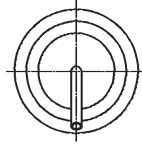
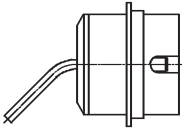

NR02

Ø 1,7 x 45° mm
Ø .067 x 45° in
0058736882

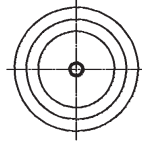
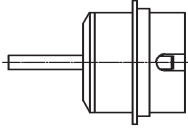

NR04

Ø 2.5 mm
Ø .098 in
0058736881

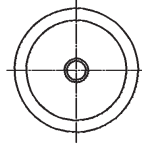
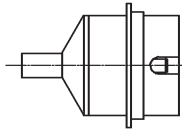

NR05

Ø 4 mm
Ø .157 in
0058736867

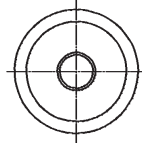
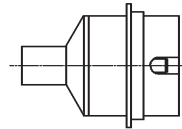

NR10

Ø 7 mm
Ø .280 in
0058736870

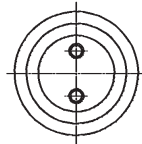
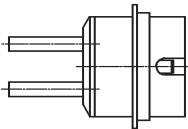

DR05



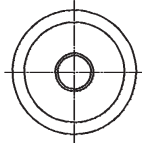
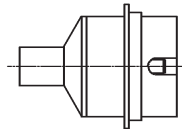

Ø 2,5 x 9,5 mm
Ø .098 x .374 in
0058736883

Made to
Order

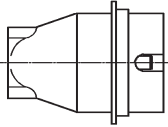
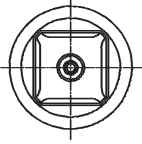
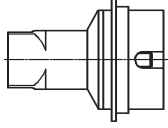
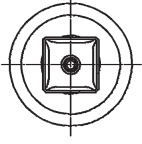
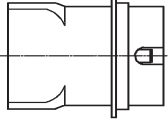
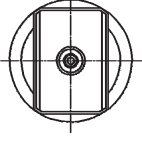
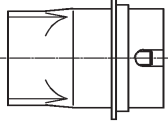
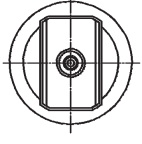
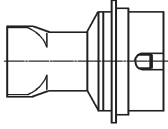

RD11

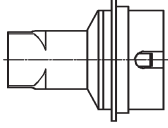
Ø 11.5 mm
Ø .453 in
0058736836

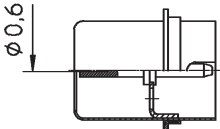
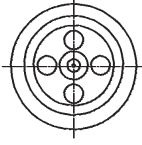
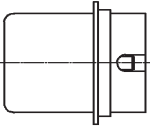
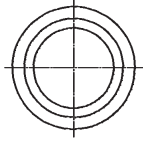
		NQ10	14,8 x 14,8 mm .583 x .583 in 0058736818
		NQ05	11 x 11 mm .433 x .433 in 0058736839
		ND20	21,5 x 14,8 mm .846 x .583 in 0058736840
		ND15	19 x 12 mm .748 x .472 in 0058736841
		ND10	14 x 10 mm .551 x .394 in 0058736842
		ND05	10 x 8 mm .394 x .315 in 0058736843
		NA20	Measuring Nozzle 0058736875
		NA10	Adapter 0058750722

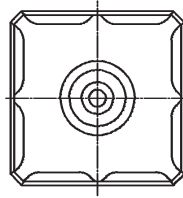
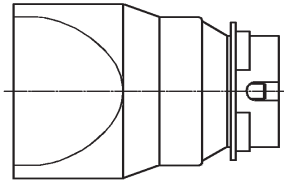

NQ45

31.3 x 31.3 mm
1.23 x 1.23 in
0058736833

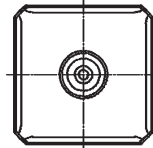
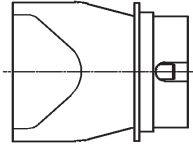

NQ40

26 x 26 mm
1.024 x 1.024 in
0058736804

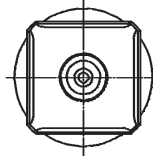
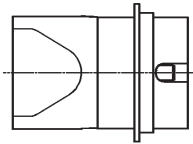

NQ35

20.5 x 20.5 mm
.807 x .807 in
0058736807

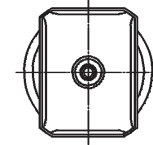
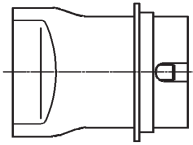

NQ30

17.5 x 23.5 mm
.689 x .925 in
0058750721

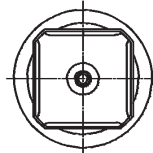
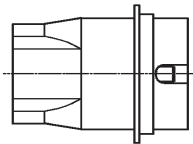

NQ25

18 x 18 mm
.709 x .709 in
0058736814

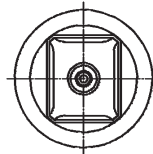
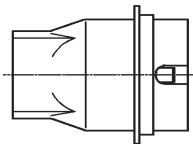

NQ20

15.5 x 13 mm
.610 x .512 in
0058736837

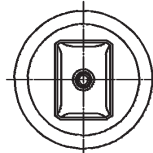
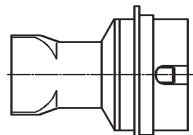

NQ15

14 x 10 mm
.551 x .394 in
0058736838

Made To Order Nozzles (Contact for Quote)

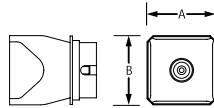

24 x 12 mm
.945 x .472 in
0058736880

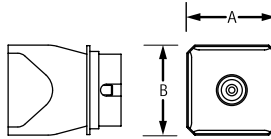

43 x 43 mm
1.693 x 1.693 in
0058736890

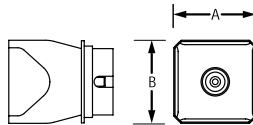

36 x 36 mm
1.417 x 1.417 in
0058736891

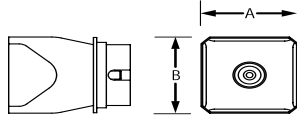

27 x 14 mm
1.063 x .551 in
0058736892

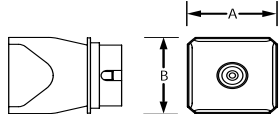

29 x 17 mm
1.142 x .669 in
0058736877

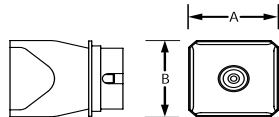

35.5 x 23 mm
1.398 x .906 in
0058736998

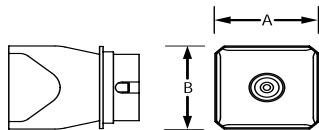

48.5 x 30.5 mm
1.909 x 1.201 in
0058736999

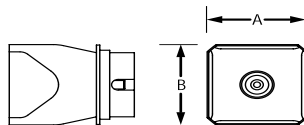

44 x 32 mm
1.732 x 1.260 in
0058736858

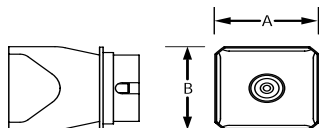

48.5 x 38 mm
1.909 x 1.496 in
0058750709

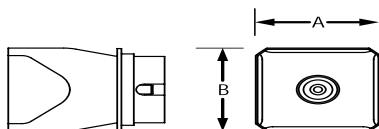

61 x 38 mm
2.402 x 1.496 in
0058750714

Made To Order Nozzles (Contact for Quote)

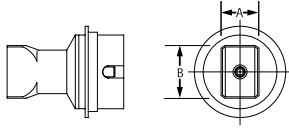

12 x 27 mm
.472 x 1.063 in
0058736880

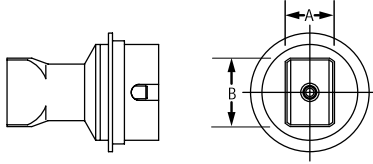

38 x 38 mm
1.496 x 1.496 in
0058736890

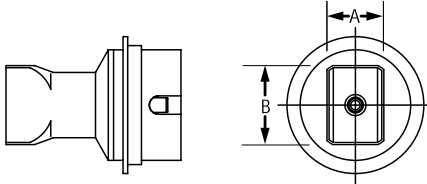

40 x 40 mm
1.575 x 1.575 in
0058736891

Tequipment
NET



205 Westwood Ave
Long Branch, NJ 07740
1-877-742-TEST (8378)
Fax: (732) 222-7088
salesteam@Tequipment.NET

U.S Mailing Address:

Cooper Hand Tools
P.O. Box 728
Apex, NC 27502-0728

U.S Shipping Address:

1000 Lufkin Road
Apex, N.C. 27539
Tel: (919) 387-0099
Fax: (919) 387-2379
For inquiries concerning Technical /
Customer Service please call:
(800) 476-3030 Ext. 1

Canada Shipping Address:

Cooper Tools
164 Innisfil Street
Barrie, Ontario
Canada L4N 3B7
Attn: Repairs
Fax: 1-800-403-TOOL (8665)
Phone: 705-728-5564 Ext. 2026

Weller is a registered Trademark and registered Design of Cooper Industries, Inc.