

Pro5000sL

5000 Lumen Digital Projector

*No Lens Included



BRIGHTNESS

5000 Lumens (Standard)

4000 Lumens (Economy)

RESOLUTION

1024x768 XGA (Native)

1280x1024 SXGA (Supported)

DISPLAY TYPE

0.79" LCD MLA x 3

CONTRAST RATIO

500 :1

ASPECT RATIO

4:3 Native

16:9 Compatible

THROW RATIO

1.8-2.3 Pro5000SL-911

2.3-2.9 Pro5000SL-912

3.1-4.1 Pro5000SL-913

PROJECTION LENS

Manual Zoom & Focus

ZOOM RATIO

1.27 Standard

1.25 Medium

1.26 Long

DIAGONAL IMAGE SIZE

40" - 300"

THROW DISTANCE

4' - 30'

KEystone

+/- 30° Vertical

LAMP

330 watt NSH

LAMP LIFE

2000 (Standard)

3000 (Economy)

INPUTS

DVI-I w/3.5 mm Audio

VGA w/3.5 mm Audio

S-Video

Component

Composite Video

Audio (3.5 mm)

RCA R/L Audio

OUTPUTS

VGA w/ 3.5mm Audio

PROJECTOR CONTROLS

USB

RS232 (9-pin)

RJ45 (LAN Control)

COMPATIBILITY

VGA,SVGA,XGA,SXGA,MAC

EDTV / SDTV / HDTV

480i/p, 525i/p, 576i/p, 625i/p,

720p,1080i

FCC CERTIFICATION

FCC-B, UL, TUV-CB, c-UL, CB, CE,

CCC

VIDEO COMPATIBILITY

NTSC, NTSC 4.43, PAL B/G/H/I/M/N 60,

SECAM

AUDIO

1 x 8w Mono Speaker

DECIBEL RATING

40 dB (Standard)

35 dB (Economy)

H-SCAN FREQUENCY

15-107 kHz

V-REFRESH RATE

43-120 kHz

POWER SUPPLY

AC 100-240 Volts (50/60 Hz)

POWER CONSUMPTION

430 Watts (Typical)

DIMENSIONS (WxDxH)

18.9" x 14.2" x 5.7" Inches

WEIGHT

15 lbs (with no lens)

WARRANTY

3 year parts & labor / 90 day lamp

Pro5000SL Product Highlights:

- 3 optional lenses from 1.8 to 4.1 throw ratio.
- Advanced LAN control including email monitoring and online web access and scheduling
- Easy installation function, auto key stone, and auto ceiling mount detection.
- Long lasting Hepa filtration system with upgradable smoke control option.
- Auto brightness detection to extend lamp life and out put only what is needed.

Choose from 3 lens options:



Standard Throw Lens
1.8-2.3 throw ratio
1.27 zoom



Medium Throw Lens
2.3-2.9 throw ratio
1.25 zoom



Long Throw Lens
3.1-4.1 throw ratio
1.26 zoom

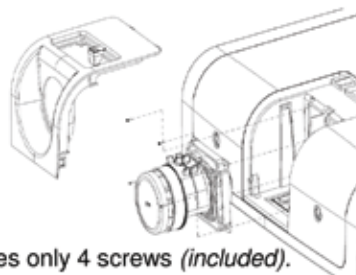

Easy optional lens installation requires only 4 screws (included).

- (5) Speaker
- (11) Filter cover
The air filter is inside.
- (14) AC inlet
- (15) S-VIDEO port
- (16) AUDIO L/R port
- (17) VIDEO port
- (18) COMPUTER IN1 port
- (19) COMPUTER IN2 / DVI port
- (20) USB port
- (21) AUDIO 1 IN port
- (22) AUDIO 2 IN port
- (23) AUDIO OUT port
- (24) MONITOR OUT port
- (25) YPbPr port
- &(26) L-AUDIO IN-R port
- (28) RS-232C port
- (29) LAN port

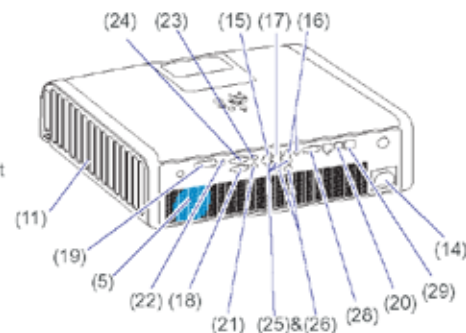

Touchboards

205 Westwood Ave, Long Branch, NJ 07740
Phone: 866-94 BOARDS (26273) / (732)-222-1511
Fax: (732)-222-7088 | E-mail: sales@touchboards.com

