

# LCD PROJECTOR

## LENS REPLACEMENT AND INSTALLATION MANUAL

### CAUTION

When installing or replacing the Projection Lens, refer to this manual. For installation of the lens, use the parts designated in the manual.

### AVAILABLE LENS

This projector applies the Projection Lenses listed below. Use the suitable lens for where the projector is used.

Model NO.	Type	Zoom	Focus
AH-23122	Short Throw Zoom Lens	Motor Driven	Motor Driven
AH-23132	Long Throw Zoom Lens	Motor Driven	Motor Driven
AH-32011	Fixed Short Throw Zoom Lens	Fixed	Manual
AH-24241	Ultra-Long Throw Zoom Lens	Motor Driven	Motor Driven

### NOTES ON LENS INSTALLATION

- Lens installation and replacement should be made by trained sales engineer or qualified service personnel.
- Be sure to install the lens following this procedure precisely.
- Do not touch or remove any parts except the lens and related parts. It may result in malfunctions, electrical shock, fire hazard or other accidents.
- Before installing or replacing the lens, check that the Model No. of the Projection Lens matches to the projector.
- When moving or setting up the projector, be sure to replace the Lens Cover to protect the surface. And be careful not to hold or subject the lens to strong forces. It may damage the lens, cabinet, or mechanical parts.
- For details of the lens and installation, contact the sales dealer where you purchased the projector.

## LENS REPLACEMENT PROCEDURE

Perform the steps 1 to 6 for lens replacement.

First set the lens at the fully lower position with lens shift adjustment.

### 1 REMOVE THE FRONT CABINET

1. Remove 2 Screws-A.
2. Remove the front cabinet

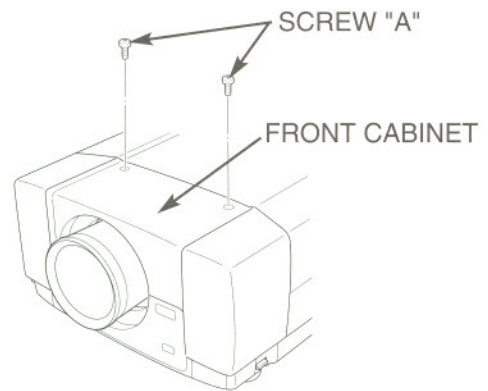

### 2 REMOVE THE LIGHT-BLOCK SHEET BASE AND LIGHT-BLOCK SHEET

1. Slide the light-block sheet base upward and remove it.
2. Remove the light-block sheet from lens.

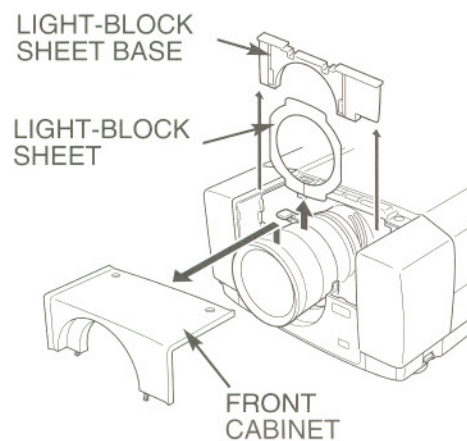

### 3 REMOVE THE LENS

1. Grasp the Lens Lock Lever and turn it fully upward. Remove the Lens into the projector.
2. Disconnect the lens motor lead connector to the socket on the lens attachment.
3. Remove 4 Screws and remove lens attachment.

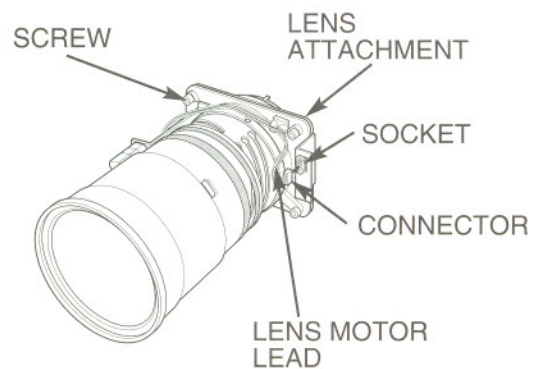
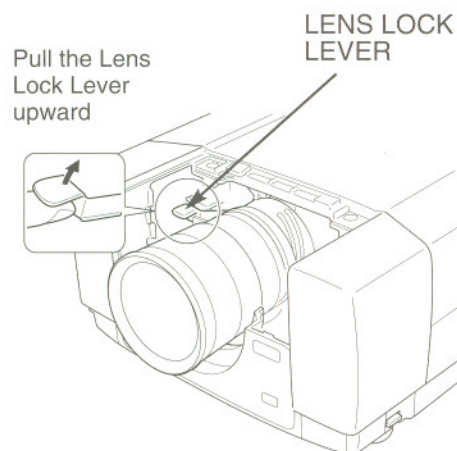

## 4 MOUNT THE LENS

1. Remove protective caps (front and back) on the optional lens.
2. Mount the lens on the lens attachment which removed at step 3 with 4 Screws.
3. Connect the lens motor lead connector to the socket on the lens attachment. (Motor Driven Lens only.)
4. Grasp the Lens Lock Lever and turn it fully upward. Install the Lens into the projector. Turn the Lens Lock Lever fully downward until lever is Locked (clicked position) properly. When installing the Motor Driven Lens, be sure to mount Lens Motor on left-side. After installing the lens, make sure the Lens is not loose and properly installed.

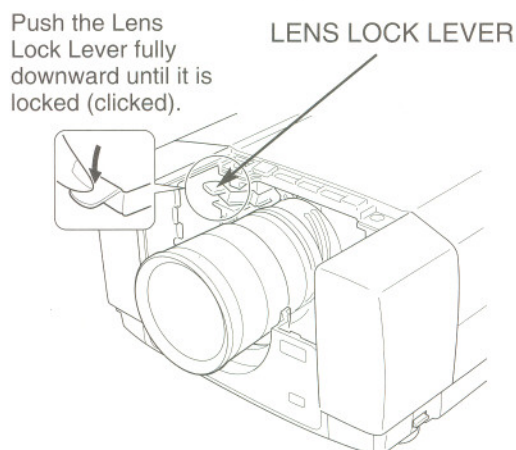
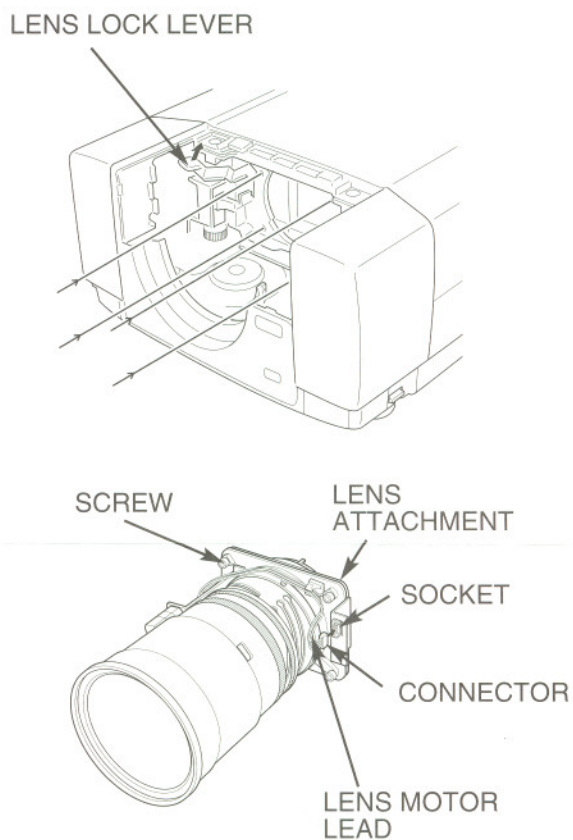
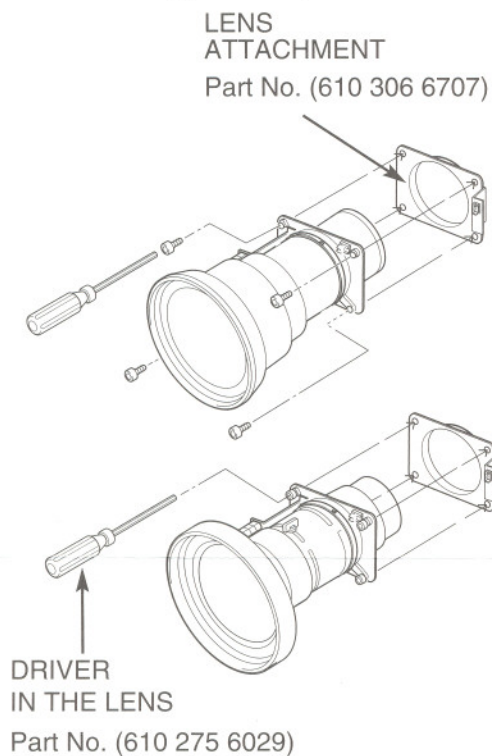



## For AH-23122, AH-23132 and AH-24241

### 5 MOUNT THE LIGHT-BLOCK SHEET AND LIGHT-BLOCK SHEET BASE

1. Mount the light-block sheet on the lens. (In the same position as the removed sheet has been placed). Use the sheet included with the lens.  
Make sure the mark (TOP and BACK) on Light-Block Sheet and set them properly.
2. Mount the light-block sheet base.

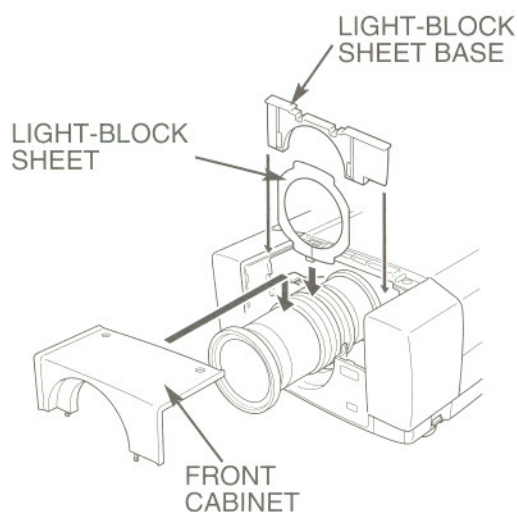

### 6 MOUNT THE FRONT CABINET

1. Mount the front cabinet with 2 screws.

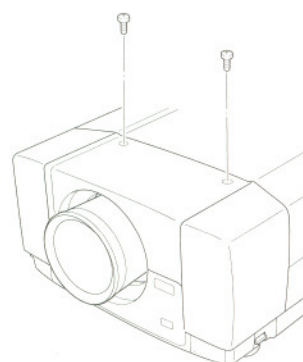

## For AH-32011

※ Light-block sheet base and Light-block sheet are not used.

### 5 MOUNT THE FRONT CABINET

1. Mount the front cabinet with 2 screws.

