

Instruction Sheet

APG100 Replacement Tube and Electronic Housing Calibrating Instructions

1 Introduction

This manual provides the calibration instructions for an APG100. These instructions should be followed whenever a replacement tube or replacement electronics housing is fitted. The replacement tube is supplied inside an empty housing for protection during transit. Please discard this housing before use.

1.1 Replace the gauge tube or electronics housing

Referring to Figure 1:

1. Unplug the electrical cable, vent the vacuum system to atmosphere pressure and remove the gauge from the vacuum system.
2. Pull the retaining clip from side of gauge.
3. Pull the tube from the electronics housing.
4. Fit the replacement tube into electronics housing, noting the correct alignment.
5. Refit the retaining clip.

Whenever a new tube or electronics housing is fitted it is necessary to adjust the gauge at atmosphere and at vacuum as described below.

Figure 1 - Replacement of gauge tube

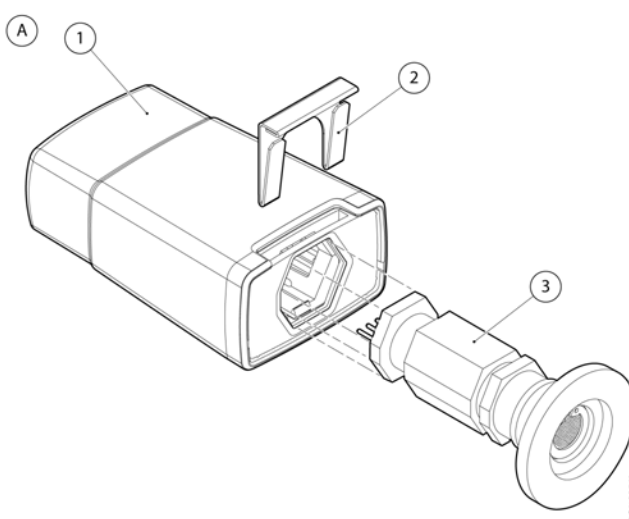

- | |
|---|
| <ol style="list-style-type: none">1. Electronic housing2. Retaining clip3. Gauge tube |
|---|

IA/017/12/08



1.2 Atmosphere adjustment

1. Switch on the power supply to the APG100.
2. With the gauge at atmospheric pressure, press the 'CAL' button and hold it down for longer than 5 seconds. The status LED will begin to flash red/green alternately and the gauge will automatically adjust to match the new tube. This may take several seconds.
3. Allow the gauge to operate at atmospheric pressure for at least 10 minutes and then repeat step 2.

Figure 2 - Adjustment of APG100



1.3 Vacuum adjustment

1. Reduce the system pressure to 1×10^{-5} mbar or below.
2. Allow the gauge to operate for at least 10 minutes.
3. Press the 'CAL' button. The status LED will flash and the gauge will automatically adjust to read vacuum.

1.4 Storage and Disposal

Please refer to the APG100 product manual originally supplied with the product. For printable copies of the HS2 form please contact your supplier or Edwards.