

Specifications

Units:	Imperial	Metric
Maximum Operating Pressure (psi)	10,000	
Capacity Class (tonnage)	12	
Capacity (imperial tons)	12	
Stroke (in)	3.00	
Collapsed Height A (in)	7.25	
Extended Height B (in)	10.25	
Return Type	Single-Acting, Spring Return	
Plunger Type	Center Hole	
Material	Steel	
Cylinder Effective Area (in ²)	2.76	
Oil Capacity Required (in ³)	8.3	
Pressure at Capacity (psi)	8695	
Bolt Circle (in)	2.00	
Thread (in)	5/16 - 18 UNC	
Thread Depth (in)	0.50	
Weight (lbs)	10.0	

- Refer to Base Mounting Table

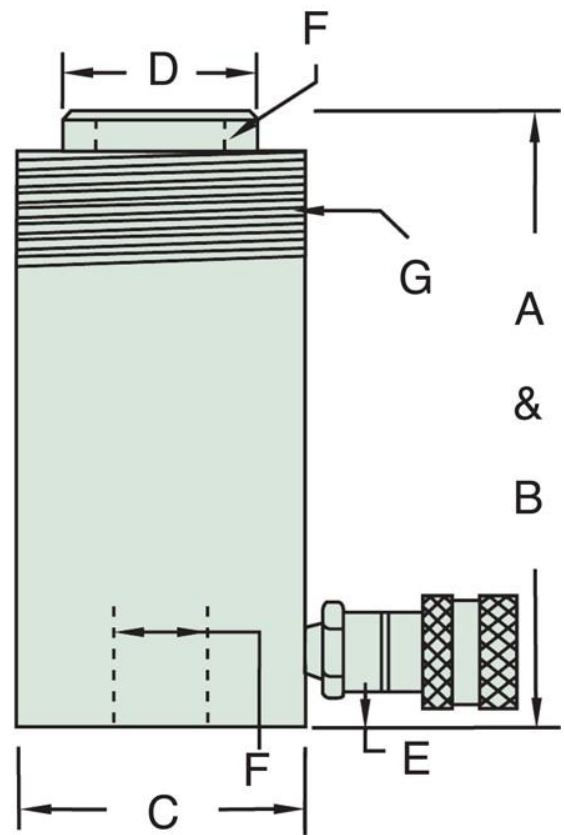
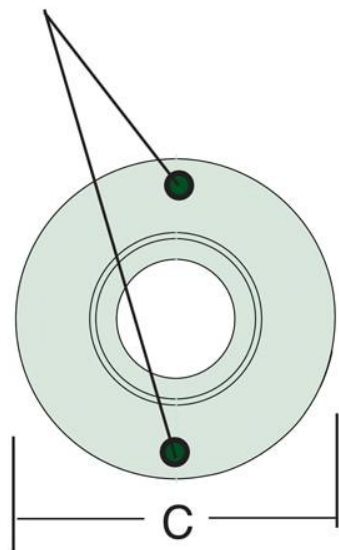

Dimensions

Units:

Imperial

Metric

Collapsed Height A (in)	7.25
Extended Height B (in)	10.25
Body Outside Diameter C (in)	2.75
Piston Outside Diameter D (in)	1.38
Base to Port Center Line E (in)	0.98
Center Hole Diameter F (in)	0.77
Collar Threads G (in)	2 3/4 - 16
Collar Threads Length G (in)	1.19