

## Specifications

---

Units:

**Imperial**

Metric

|  |                              |
|--|------------------------------|
| Maximum Operating Pressure (psi)                   | 10,000                       |
| Capacity Class (tonnage)                           | 15                           |
| Maximum Cylinder Capacity Advance (tons)           | 15.7                         |
| Stroke (in)  | 10                           |
| Collapsed Height A (in)                            | 14.69                        |
| Extended Height B (in)                             | 24.69                        |
| Return Type  | Single-Acting, Spring Return |
| Plunger Type                                       | Solid                        |
| Material   | Steel                        |
| Cylinder Effective Area Advance (in <sup>2</sup> ) | 3.14                         |
| Oil Capacity Advance (in <sup>3</sup> )            | 31.42                        |
| Surface Treatment                                  | Paint                        |
| Coupler  | CR400 Coupler                |
| Weight (lbs)                                       | 21                           |

## Dimensions

Units:

**Imperial**

Metric

|   |                |
|---|----------------|
| Collapsed Height A (in)                                   | 14.69          |
| Optional Tilt Saddle Addition To Collapsed Height A1 (in) | 0.43           |
| Optional Tilt Saddle Diameter J1 (in)                     | 1.38           |
| Extended Height B (in)                                    | 24.69          |
| Outside Diameter D (in)                                   | 2.75           |
| Cylinder Bore Diameter E (in)                             | 2              |
| Plunger Diameter F (in)                                   | 1.63           |
| Base to Advance Port H (in)                               | 1              |
| Saddle Diameter J1 (in)                                   | 1.5            |
| Saddle Protrusion from Plunger K (in)                     | 0.38           |
| Plunger Internal Thread O (in)                            | 1" - 8         |
| Plunger Thread Length P (in)                              | 1              |
| Saddle Maximum Tilt Angle Radius (degrees)                | 5              |
| Base Mounting Holes Bolt Circle U (in)                    | 1.88           |
| Base Mounting Holes Thread V                              | 3/8" - 16 un   |
| Collar Thread Size W                                      | 2 3/4" - 16 un |
| Collar Thread W (in)                                      | 2 3/4" - 16 UN |
| Collar Thread Length X (in)                               | 1.19           |
| Base Mounting Holes Thread Depth Z (in)                   | 0.5            |

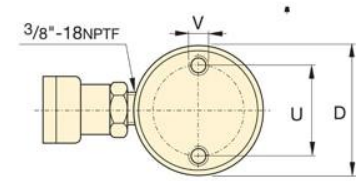
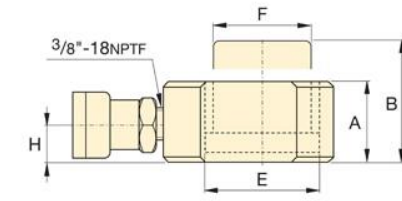
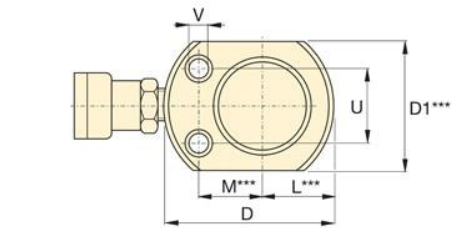
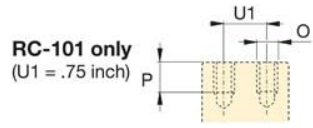
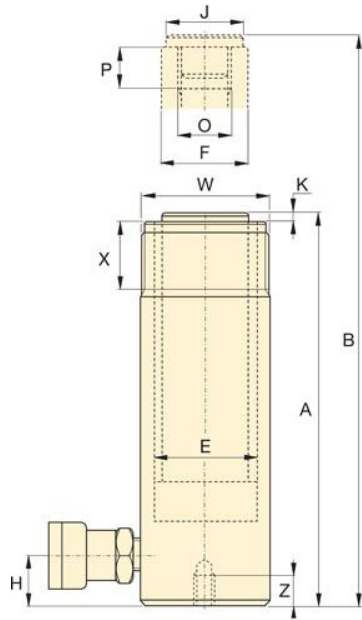

**RC-51 to RC-5013 models**

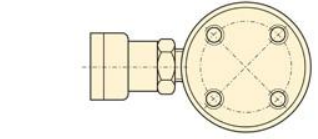

**RC-1006 and RC-10010 models**