

## Specifications

---

Units:

**Imperial**

Metric

Maximum Operating Pressure (psi)	10,000
Capacity Class (tonnage)	15
Maximum Cylinder Capacity Advance (tons)	15.7
Stroke (in)	14
Collapsed Height A (in)	18.69
Extended Height B (in)	32.69
Return Type	Single-Acting, Spring Return
Plunger Type	Solid
Material	Steel
Cylinder Effective Area Advance (in <sup>2</sup> )	3.14
Oil Capacity Advance (in <sup>3</sup> )	43.98
Surface Treatment	Paint
Coupler	CR400 Coupler
Weight (lbs)	26

## Dimensions

Units:  Imperial  Metric

Collapsed Height A (in)	18.69
Optional Tilt Saddle Addition To Collapsed Height A1 (in)	0.43
Optional Tilt Saddle Diameter J1 (in)	1.38
Extended Height B (in)	32.69
Outside Diameter D (in)	2.75
Cylinder Bore Diameter E (in)	2
Plunger Diameter F (in)	1.63
Base to Advance Port H (in)	1
Saddle Diameter J1 (in)	1.5
Saddle Protrusion from Plunger K (in)	0.38
Plunger Internal Thread O (in)	1" - 8
Plunger Thread Length P (in)	1
Saddle Maximum Tilt Angle Radius (degrees)	5
Base Mounting Holes Bolt Circle U (in)	1.88
Base Mounting Holes Thread V	3/8" - 16 un
Collar Thread Size W	2 3/4" - 16 un
Collar Thread W (in)	2 3/4" - 16 UN
Collar Thread Length X (in)	1.19
Base Mounting Holes Thread Depth Z (in)	0.5

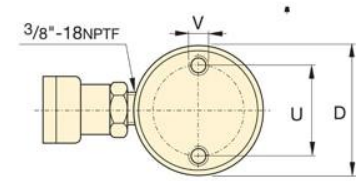
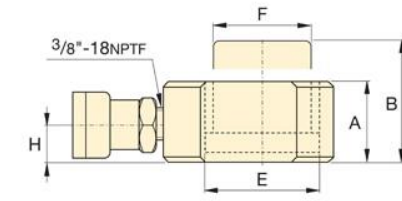
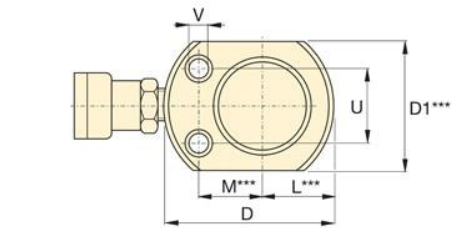
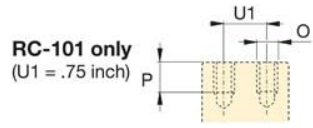
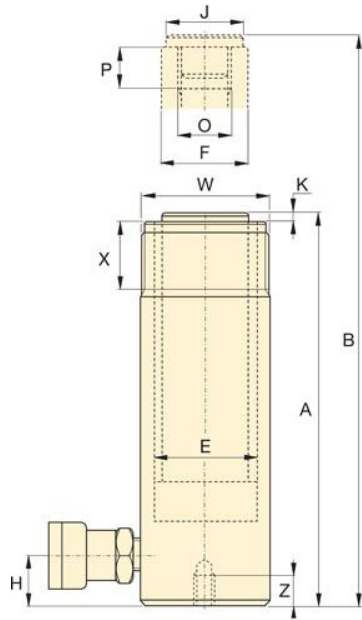

**RC-51 to RC-5013 models**

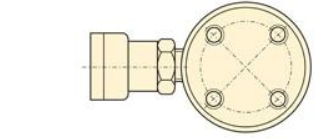

**RC-1006 and RC-10010 models**