

Specifications

Units:

Imperial

Metric

Maximum Operating Pressure (psi)	10,000
Capacity Class (tonnage)	15
Maximum Cylinder Capacity Advance (tons)	15.7
Stroke (in)	4
Collapsed Height A (in)	7.88
Extended Height B (in)	11.88
Return Type	Single-Acting, Spring Return
Plunger Type	Solid
Material	Steel
Cylinder Effective Area Advance (in ²)	3.14
Oil Capacity Advance (in ³)	12.57
Surface Treatment	Paint
Coupler	CR400 Coupler
Weight (lbs)	11

Dimensions

Units: Imperial Metric

Collapsed Height A (in)	7.88
Optional Tilt Saddle Addition To Collapsed Height A1 (in)	0.43
Optional Tilt Saddle Diameter J1 (in)	1.38
Extended Height B (in)	11.88
Outside Diameter D (in)	2.75
Cylinder Bore Diameter E (in)	2
Plunger Diameter F (in)	1.63
Base to Advance Port H (in)	0.75
Saddle Diameter J1 (in)	1.5
Saddle Protrusion from Plunger K (in)	0.38
Plunger Internal Thread O (in)	1" - 8
Plunger Thread Length P (in)	1
Saddle Maximum Tilt Angle Radius (degrees)	5
Base Mounting Holes Bolt Circle U (in)	1.88
Base Mounting Holes Thread V	3/8" - 16 un
Collar Thread Size W	2 3/4" - 16 un
Collar Thread W (in)	2 3/4" - 16 UN
Collar Thread Length X (in)	1.19
Base Mounting Holes Thread Depth Z (in)	0.5

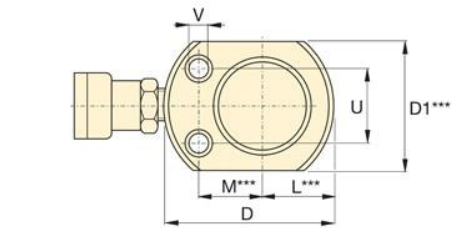
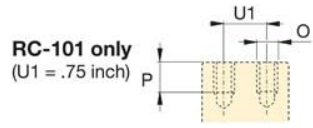
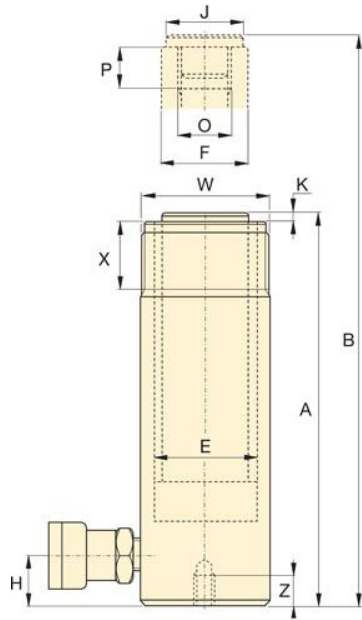

RC-50

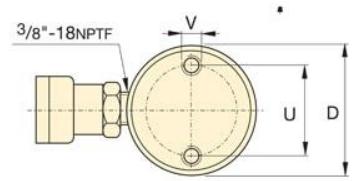

RC-51 to RC-5013 models

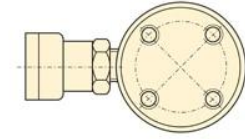

RC-1006 and RC-10010 models